

# Replacement Parts - CA5500 - AG SERIES

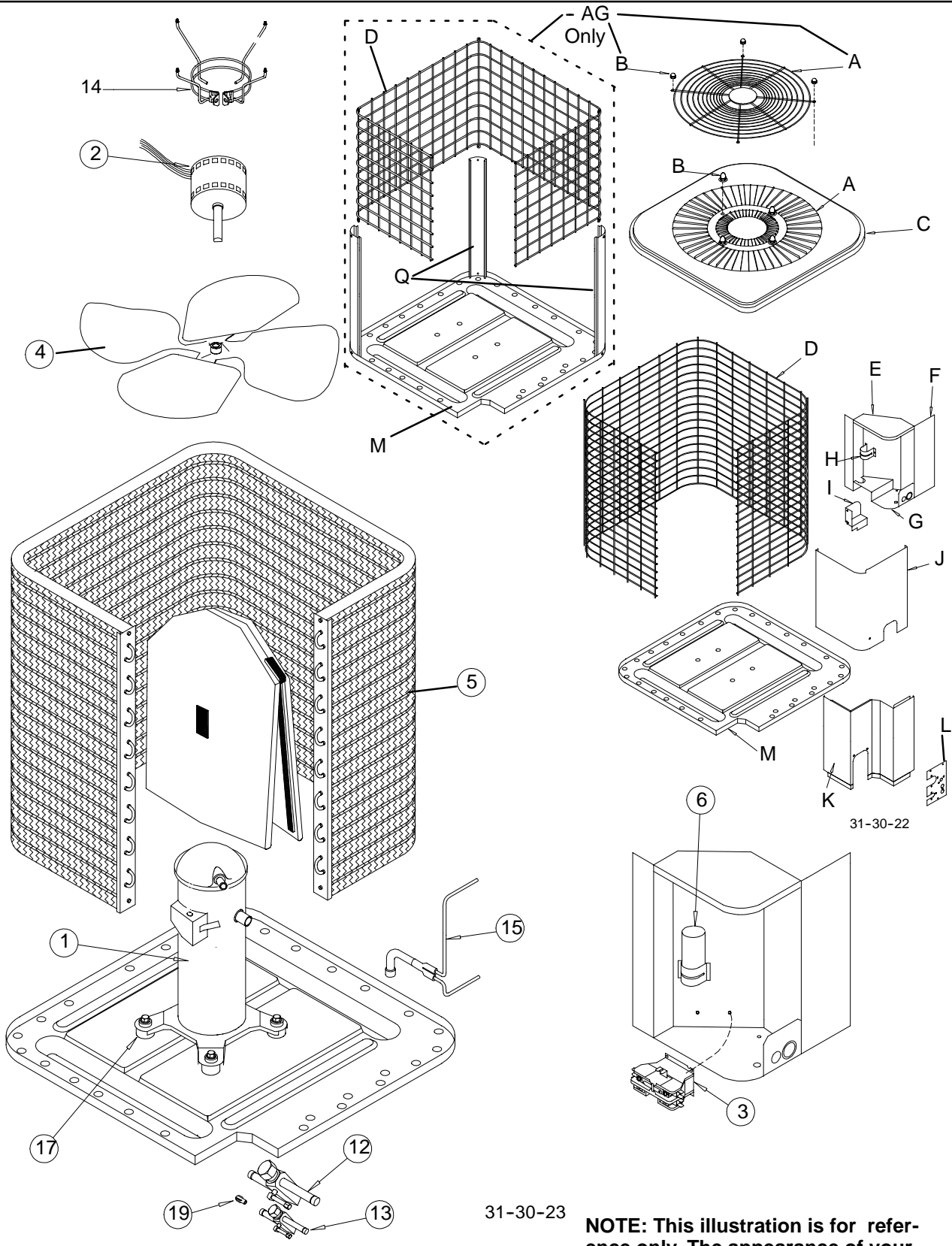

**NOTE: This illustration is for reference only. The appearance of your unit may differ from the unit shown.**

# Replacement Parts - CA5500 - AG SERIES

**Models - CA5518VKD1, CA5518VKD2, CA5524VKD1, CA5524VKD2, CA5530VKD1, CA5536VKD1, CA5542VKD1, CA5548VKD1, CA5560VKD1, AG018GB1, AG018GB2, AG024GB1, AG024GB2, AG030GB1, AG036GB1, AG042GB1, AG048GB1, AG060GB1**

no	DESCRIPTION Functional	Part No.	1	2	3	3	4	4	6	
			8	4	0	6	2	8	0	
1	COMPRESSOR ZR16KCPFV	1080975	1							
	24VKD1/24GB1 ZR22KCPFV	1082504	-	1						
	24VKD2/24GB2 ZR22K3PFV	1082755	-	1						
	ZR28KCPFV	1082500	-	-	1					
	ZR36KCPFV	1082501	-	-	-	1				
	ZR42KCPFV	1082502	-	-	-	-	1			
	ZR45KCPFV	1082503	-	-	-	-	-	1		
	ZR61KCPFV	1069319	-	-	-	-	-	-	1	
	2	MOTOR, FAN	1060771	-						
			1082639	1	1	1	1			
CA55 Only		1064958	-	-	-	-	1	1		
2	MOTOR, FAN - AG Only	1064946	-	-	-	-	1	1		
		1068817	-	-	-	-	-	-	1	
3	CONTACTOR 25AMP	1050699	1	1	1	1				
	35AMP	1050839	-	-	-	-	1	1		
	40AMP	1059574	-	-	-	-	-	-	1	
4	FAN	1080771	1							
		1080775	-	1	-					
		1080796	-	-	1	1				
		1080777	-	-	-	-	1	1		
		1068558	-	-	-	-	-	-	1	
5	CONDENSER	1082565	1							
		1082566	-	1						
		1082567	-	-	1					
		1082568	-	-	-	1				
		1082569	-	-	-	-	1			
		1082570	-	-	-	-	-	1		
		1082571	-	-	-	-	-	-	1	
6	CAPACITOR, 30+3MFD,370V	1082631	1							
	24VKD1/24GB1 35+3MFD,370V	1082632	-	1						
	24VKD2/24GB2 40+3MFD,370V	1082632	-	1						
	35+3MFD,440V	1082636	-	-	1					
	40+3MFD,440V	1082637	-	-	-	1				
	40+5MFD,440V	1094987	-	-	-	-	1			
	40+5MFD,370V	1094980	-	-	-	-	-	1		
	60+5MFD,370V	1095025	-	-	-	-	-	-	1	
12	VALVE, SERVICE SUCTION	1080995	1	1	1	1	1			
		1080996	-	-	-	-	-	1		
		1080997	-	-	-	-	-	-	1	
13	VALVE, SERVICE LIQUID	1080999	1	1	1	1				
		1081000	-	-	-	-	1	1	1	
14	MOUNT, FAN MTR. - CA55 ONLY	1051460	-	-	-	-	1	1	1	
		1082522	-	-	1	1	1			
15	DISTRIBUTOR ASSEMBLY	1082560	-	-	-	-	-	1	1	
		1052060	4	4	4	4	4	4	4	
19	GROMMET, COMPRESSOR RESTRICTOR .051	1053110	1							
	.059	1055236	-	1						
	.065	1093424	-	-	1					
	.072	1069387	-	-	-	1				
	.078	1053112	-	-	-	-	1			
	.079	1053661	-	-	-	-	-	1		
	.089	1057897	-	-	-	-	-	-	1	

no	DESCRIPTION Non-Functional	Part No.	1	2	3	3	4	4	6
			8	4	0	6	2	8	0
A	GRILLE, OUTLET - AG Only	1067519	-	-	-	-	1	1	1
	B NUT, CAP - CA55 Only	1052962	4	4	4	4			
B	NUT, CAP - AG Only	1052963	-	-	-	-	4	4	4
	PANEL, TOP - CA55 Only	1097105	1	1	1	1			
C	PANEL, TOP - AG Only	1052701	-	-	-	-	1	1	1
	GRILLE, INLET - CA55 Only	1097106	1	1	1	1			
D	GRILLE, INLET - AG Only	1069831	-	-	-	-	1	1	1
		1082513	1	1	1				
		1081845	-	-	-	1			
		1082517	-	-	-	-	1		
		1082518	-	-	-	-	-	1	
		1082519	-	-	-	-	-	-	1
		1082512	1	1	1				
E	TOP, CONTROL BOX	1064781	1	1	1	1			
		1064362	-	-	-	-	1	1	1
	BOX, CONTROL	1052677	1	1	1	1			
		1052678	-	-	-	-	1	1	1
G	BOTTOM, CONTROL BOX	1052888	1	1	1	1			
		1064364	-	-	-	-	1	1	1
H	CLAMP, CAPACITOR	1095021	1	1		1		1	
		1064218	-	-	1		1		1
I	DIVIDER, LOW VOLTAGE	1051297	1	1	1	1	1	1	1
	COVER, CONTROL BOX - CA55 Only	1081502	1	1	1	1			
J	COVER, CONTROL BOX - AG Only	1081503	-	-	-	-	1	1	1
	PANEL, CORNER - CA55 Only	1081976	1	1	1	1			
K	PANEL, CORNER - AG Only	1081977	-	-	-	-	1	1	1
		1081535	1	1	1				
		1081539	-	-	-	1			
		1081522	-	-	-	-	1		
		1081528	-	-	-	-	-	1	
		1081530	-	-	-	-	-	-	1
		1081979	1	1	1				
L	PLATE, FITTING	1081981	-	-	-	1			
		1082543	-	-	-	-	1		
		1082544	-	-	-	-	-	1	
		1082545	-	-	-	-	-	-	1
M	BASEPAN - CA55 Only	1052849	1	1	1	1	1	1	1
	BASEPAN - AG Only	1081007	-	-	-	-	-	-	1
Q	POST, CORNER - AG Only	1052699	1	1	1	1			
		1052693	-	-	-	-	1	1	1
		1069833	1	1	1	1			
		1069837	-	-	-	-	1	1	1
		1081997	3	3	3				
		1069733	-	-	-	3			
		1081998	-	-	-	-	3		
)(	PLATE, VALVE MOUNTING	1081838	-	-	-	-	-	3	
	MANUAL, PARTS LIST	1081839	-	-	-	-	-	-	3
	MANUAL, INSTALLATION	1081008	-	-	-	-	-	-	1
)(	MANUAL, USERS	4210411	1	1	1	1	1	1	1
		0201							
		4210111	1	1	1	1	1	1	1
)(	PART NOT ILLUSTRATED	0200							
		4210211	1	1	1	1	1	1	1