

Parts List, Charging Chart, Wiring Diagrams

PHN4 24 - 60 SERIES
1 Phase

R410A PACKAGE HEAT PUMP UNITS



TABLE OF CONTENTS

PARTS LIST	2-5
PARTS DRAWING	6-17
CHARGING CHART	18
WIRING DIAGRAM	19

PHN4 24 - 60 PARTS LIST

KEY NO.	DESCRIPTION	FAST PARTS NO.	PHN424000K00A1	PHN430000K00A1	PHN436000K00A1	PHN442000K00A1	PHN448000K00A1	PHN460000K00A1
01	COMP ZP20K5E-PFV-130	ZP20K5EPFV130	1	*	*	*	*	*
01	COMP ZP25K5E-PFV-130	ZP25K5EPFV130	*	1	*	*	*	*
01	COMP ZP31K5E-PFV-130	ZP31K5EPFV130	*	*	1	*	*	*
01	COMP ZP36K5E-PFV-130	ZP36K5EPFV130	*	*	*	1	*	*
01	COMP ZP39K5E-PFV-130	ZP39K5EPFV130	*	*	*	*	1	*
01	COMP ZP51K5E-PFV-130	ZP51K5EPFV130	*	*	*	*	*	1
02	COIL ASY OUTDOOR 24 AL LF	1177773	1	*	*	*	*	*
02	COIL ASY OUTDOOR 30 AL LF	1177775	*	1	*	*	*	*
02	COIL ASY OUTDOOR 36 AL LF	1177777	*	*	1	*	*	*
02	COIL ASY OUTDOOR 42 AL LF	1177779	*	*	*	1	*	*
02	COIL ASY OUTDOOR 48 AL LF	1177781	*	*	*	*	1	*
02	COIL ASY OUTDOOR 60 AL LF	1177783	*	*	*	*	*	1
03	COIL ASY OUTDOOR 24 AL RT	1177774	1	*	*	*	*	*
03	COIL ASY OUTDOOR 30 AL RT	1177776	*	1	*	*	*	*
03	COIL ASY OUTDOOR 36 AL RT	1177778	*	*	1	*	*	*
03	COIL ASY OUTDOOR 42 AL RT	1177780	*	*	*	1	*	*
03	COIL ASY OUTDOOR 48 AL RT	1177782	*	*	*	*	1	*
03	COIL ASY OUTDOOR 60 AL RT	1177784	*	*	*	*	*	1
04	COIL ASY INDOOR 24	1177770	1	1	*	*	*	*
04	COIL ASY INDOOR 36	1177771	*	*	1	*	*	*
04	COIL ASY INDOOR 42	1176996	*	*	*	1	*	*
04	COIL ASY INDOOR 48	1176997	*	*	*	*	1	*
04	COIL ASY INDOOR 60	1177772	*	*	*	*	*	1
05	MTR BLT 1/230 1 VS 600-1200	1177597	*	*	*	*	1	*
05	MTR BLT 1/230 3/4 VS 600-1200	1177596	*	*	1	1	*	*
05	MTR BLW 1/230 1 600-1200	1177343	*	*	*	*	*	1
05	MTR BLW 1/230 1/2 600-1200	1177014	1	1	*	*	*	*
06	MTR CND 1/230 1/3 1100	1177345	*	*	*	*	*	1
06	MTR CND 1/230 1/4	1171335	*	*	1	*	1	*
06	MTR CND 1/230 1/4 900/1100	1177346	*	*	*	*	1	*
06	MTR CND 1/230 1/8 825	1175625	*	*	*	1	*	*
06	MTR CND 1/230 1/8 825/1	1173699	1	1	*	*	*	*
07	FAN C 22" 3B 1/2" 24 INT	1171220	1	1	*	*	1	*
07	FAN C 22" 3B 1/2" 28 INT	1171219	*	*	1	1	*	1
08	CAP RN RD 370V 45+10 MFD	1173702	*	*	1	*	1	*
08	CAP RN RD 370V 5+35	1172110	1	*	*	*	*	*
08	CAP RN RD 370V 5+40	1172147	*	1	*	*	*	*
08	CAP RN RD 370V 5+45 MFD	1172124	*	*	*	1	*	*
08	CAP RN RD 370V 70+10 MFD	1177750	*	*	*	*	*	1
10	CONTACTOR 1P 25A 24V	1173689	1	1	1	1	*	*
10	CONTACTOR 1P 40A 24V	1173690	*	*	*	*	1	1
13	TRANS 200/230/460>24 75VA	1171496	1	1	1	1	1	1
14	WHEEL 11-10DD CCW	1177025	*	*	1	1	1	1
14	WHEEL DD 10X10 CW	1175970	1	1	*	*	*	*
16	DISTRIBUTOR 4 CIRCUIT R-410A	1174359	1	1	*	*	*	*
16	DISTRIBUTOR 4 CIRCUIT R-410A	1174361	*	*	1	1	*	*

PHN4 24 - 60 PARTS LIST (continued)

KEY NO.	DESCRIPTION	FAST PARTS NO.	PHN42400K00A1	PHN43000K00A1	PHN43600K00A1	PHN44200K00A1	PHN44800K00A1	PHN46000K00A1
16	DISTRIBUTOR 6 CIRCUIT R-410A	1175220	*	*	*	*	1	*
16	DISTRIBUTOR 7 CIRCUIT R-410A	1177785	*	*	*	*	*	1
18	VALVE REV W/COIL 24V	1172618	*	*	*	1	1	*
18	VALVE REV W/COIL 24V	1173708	1	1	1	*	*	*
18	VALVE REV W/COIL 24V	1173709	*	*	*	*	*	1
21	COIL REV VLV 24V	1172619	1	1	1	1	1	1
22	SENSOR DEFROST O65 C32	1173637	1	1	1	1	1	1
23	BOARD DEFROST	1174185	1	1	1	1	1	1
24	DISTRIBUTOR 2 CKT	1177711	2	2	2	*	*	*
24	DISTRIBUTOR 3 CKT	1177712	*	*	*	2	2	*
24	DISTRIBUTOR 4 CKT	1174240	*	*	*	*	*	2
25	PISTON CHATLEFF .032	1176159	2	*	*	*	*	*
25	PISTON CHATLEFF .038	1174858	*	2	*	1	1	*
25	PISTON CHATLEFF .042	1173634	*	*	2	*	*	*
27	PISTON CHATLEFF .040	1173990	*	*	*	1	1	*
27	PISTON CHATLEFF .049	1173868	*	*	*	*	*	2
28	ACCUMULATOR	1172313	*	*	*	*	1	*
28	ACCUMULATOR	1172805	*	*	1	1	*	*
28	ACCUMULATOR 120 3/4 NH	1172018	1	1	*	*	*	*
28	ACCUMULATOR 247 CI 7/8	1173672	*	*	*	*	*	1
32	MOUNTING KIT BLW MTR	1175958	1	1	*	*	*	*
32	MOUNTING KIT BLW MTR	1176088	*	*	1	1	1	1
37	PLUG COMPRESSOR	1177318	1	1	1	1	*	*
37	PLUG COMPRESSOR	1177353	*	*	*	*	1	1
38	HTR CC WP 40W 240V TCH196	1176105	*	*	*	1	1	1
38	HTR CC WP 40W 240V TCH268	1176161	1	1	*	*	*	*
39	SWITCH LOW PRESSURE	1174412	1	1	1	1	1	1
40	DRIER BIFLOW 06 CI 3/8 SWEAT	1172311	1	1	1	1	1	1
41	SWITCH HIGH PRESSURE	1174407	1	1	1	1	1	1
43	VALVE TXV 2 TON	1177736	1	*	*	*	*	*
43	VALVE TXV 3 TON	1176869	*	1	1	*	*	*
43	VALVE TXV 4 TON	1176870	*	*	*	*	1	*
43	VALVE TXV 4 TON	1177748	*	*	*	1	*	*
43	VALVE TXV 5 TON	1176871	*	*	*	*	*	1
45	CIRCUIT BOARD	1177026	1	1	1	1	1	1
AB	CLAMP CAPACITOR ROUND 2.0"D	1095021	1	1	1	1	1	*
AB	CLAMP CAPACITOR ROUND 2.5"D	1064218	*	*	*	*	*	1
AE	SCROLL	1176074	*	*	1	1	1	1
AE	SCROLL FAN	1176010	1	1	*	*	*	*
AF	PLATE ASY FAN	1176011	1	1	*	*	*	*
AF	PLATE ASY FAN SIDE	1176075	*	*	1	1	1	1
AH	PLATE FAN	1176012	1	1	*	*	*	*
AH	PLATE FAN BOTTOM	1176077	*	*	1	1	1	1
AK	GRILLE ASY 14"	1176080	*	*	1	*	*	*
AK	GRILLE ASY 16"	1176174	1	*	*	*	*	*
AK	GRILLE ASY 18"	1177739	*	1	*	*	*	*

PHN4 24 - 60 PARTS LIST (continued)

KEY NO.	DESCRIPTION	FAST PARTS NO.	PHN42400K00A1	PHN43000K00A1	PHN43600K00A1	PHN44200K00A1	PHN44800K00A1	PHN46000K00A1
AK	GRILLE ASY 20"	1176108	*	*	*	1	1	*
AK	GRILLE ASY 24"	1177340	*	*	*	*	*	1
AL	GRILLE ASY 14"	1176078	*	*	1	*	*	*
AL	GRILLE ASY 16"	1176173	1	*	*	*	*	*
AL	GRILLE ASY 18"	1177740	*	1	*	*	*	*
AL	GRILLE ASY 20"	1176106	*	*	*	1	1	*
AL	GRILLE ASY 24"	1177339	*	*	*	*	*	1
AM	GRILLE ASY 18"	1177738	*	1	*	*	*	*
AN	GRILLE ASY 14"	1176079	*	*	2	*	*	*
AN	GRILLE ASY 16"	1176017	2	*	*	*	*	*
AN	GRILLE ASY 18"	1177337	*	1	*	*	*	*
AN	GRILLE ASY 20"	1176107	*	*	*	2	2	*
AN	GRILLE ASY 24"	1177341	*	*	*	*	*	2
AP	PANEL CORNER 14" COND	1176022	*	*	2	*	*	*
AP	PANEL CORNER 16"	1176045	3	*	*	*	*	*
AP	PANEL CORNER 18"	1177347	*	3	*	*	*	*
AP	PANEL CORNER 20" COND	1176109	*	*	*	2	2	*
AP	PANEL CORNER 24" COND	1177350	*	*	*	*	*	2
AQ	BRACKET SUPPORT	1176023	4	4	4	4	4	4
AR	PANEL CORNER 14" HEADER	1176025	*	*	1	*	*	*
AR	PANEL CORNER 16" HEADER	1176046	1	*	*	*	*	*
AR	PANEL CORNER 18" HEADER	1177348	*	1	*	*	*	*
AR	PANEL CORNER 20" HEADER	1176111	*	*	*	1	1	*
AR	PANEL CORNER 24" HEADER	1177351	*	*	*	*	*	1
AS	PARTION COIL EVAP	1176026	1	1	*	*	*	*
AS	PARTITION COIL EVAP	1176081	*	*	1	1	*	*
AS	PARTITION COIL EVAP	1176112	*	*	*	*	1	1
AZ	BARRIER 24V	1176144	1	1	*	*	*	*
AZ	BARRIER 24V 42-60	1176148	*	*	1	1	1	1
BA	PANEL CORNER 14" HEADER	1176082	*	*	1	*	*	*
BA	PANEL CORNER 20" HEADER	1176113	*	*	*	1	1	*
BA	PANEL CORNER 24" HEADER	1177352	*	*	*	*	*	1
BB	SUPPORT BLOWER	1176085	*	*	1	1	1	1
BC	PARTION COIL EVAP	1176783	1	1	*	*	*	*
BC	PARTITION COIL SUPPLY	1176084	*	*	1	1	1	1
BD	SUPPORT BLOWER	1176784	1	1	1	1	1	1
BE	SHEILD BASE PAN	1176086	*	*	1	1	1	1
BE	SHIELD BASEPAN	1176794	1	1	*	*	*	*
BF	INSULATION RETURN DUCT PANEL	1176087	*	*	1	1	1	1
BF	INSULATION RETURN DUCT PANEL	1176151	1	1	*	*	*	*
BG	COMPRESSOR MTG BOLT	1176731	4	4	4	4	4	4
BH	INSULATION COIL PARTITION	1176152	1	1	*	*	*	*
BH	INSULATION COIL PARTITION	1176153	*	*	1	1	1	1
BJ	INSULATION COIL PARTITION	1176785	1	1	*	*	*	*
BJ	INSULATION COIL PARTITION	1176786	*	*	1	1	1	1
BK	GROMMET	1176613	2	2	2	2	2	2

PHN4 24 - 60 PARTS LIST (continued)

KEY NO.	DESCRIPTION	FAST PARTS NO.	PHN42400K00A1	PHN43000K00A1	PHN43600K00A1	PHN44200K00A1	PHN44800K00A1	PHN46000K00A1
BL	PARTITION COIL EVAP	1176114	*	*	*	*	1	1
BM	BLOCKOFF PANEL UPPER	1177319	1	1	*	*	*	*
BM	BLOCKOFF PANEL UPPER	1177326	*	*	1	1	1	1
BN	BLOCKOFF PANEL LOWER	1177323	1	1	*	*	*	*
BN	BLOCKOFF PANEL LOWER	1177325	*	*	1	1	1	1
A	RACEWAY	1171428	1	1	1	1	1	1
B	INSULATION ASY TOP EVAP	1175988	1	1	*	*	*	*
B	INSULATION ASY TOP EVAP	1176083	*	*	1	1	1	1
C	BASE PAN ASY	1175989	1	1	*	*	*	*
C	BASE PAN ASY	1176061	*	*	1	1	1	1
D	DUCT COVER ASY	1175990	2	2	*	*	*	*
D	DUCT COVER ASY	1176062	*	*	2	2	2	2
E	TOP CONDENSER	1175991	1	1	*	*	*	*
E	TOP CONDENSER	1176063	*	*	1	1	1	1
F	PARTITION COIL	1175992	1	1	*	*	*	*
F	PARTITION COIL RETURN	1176064	*	*	1	1	1	1
G	PARTITION FAN	1175993	1	1	*	*	*	*
G	PARTITION FAN	1176065	*	*	1	1	1	1
H	PANEL REAR DUCT	1175994	1	1	*	*	*	*
H	PANEL REAR DUCT	1176066	*	*	1	1	1	1
J	PANEL COMP SIDE	1175995	1	1	*	*	*	*
J	PANEL COMP SIDE	1176067	*	*	1	1	1	1
K	PANEL ACCESS	1175996	1	1	*	*	*	*
K	PANEL ACCESS	1176068	*	*	1	1	1	1
L	INSULATION ACCESS PANEL	1175997	1	1	*	*	*	*
L	INSULATION ACCESS PANEL	1176069	*	*	1	1	1	1
M	INSULATION COMP PANEL	1176070	*	*	1	1	1	1
M	INSULATION PANEL COMP	1175998	1	1	*	*	*	*
N	GRILLE OUTLET	1171267	1	1	1	1	1	1
P	GROMMET COMPRESSOR 1.62"DIA	1171270	4	4	4	4	4	4
R	COVER HEATER OPENING	1176139	1	1	1	1	1	1
S	INSULATION CONTROL PLATE	1176140	1	1	1	1	1	1
X	PANEL SIDE POWER SUPPLY	1176141	1	1	*	*	*	*
X	PANEL SIDE POWER SUPPLY	1176145	*	*	1	1	1	1
Y	INSULATION PANEL SIDE	1176142	1	1	*	*	*	*
Y	INSULATION PANEL SIDE	1176146	*	*	1	1	1	1
Z	PLATE CONTROL	1176143	1	1	1	1	1	1
PARTS NOT SHOWN								
)	HARNESS ASY CONT BOX	1177012	1	1	1	1	1	1

NOTE: This illustration is for reference only. Your unit may differ in appearance or may not include all components shown.

CONTROL BOX ASY

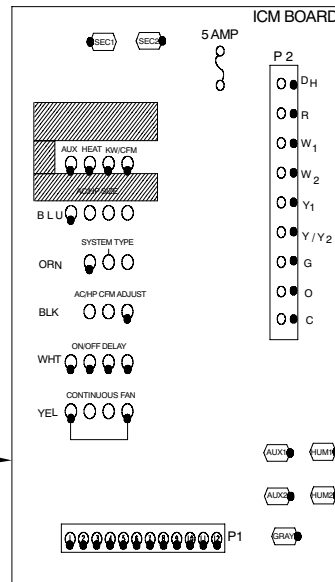
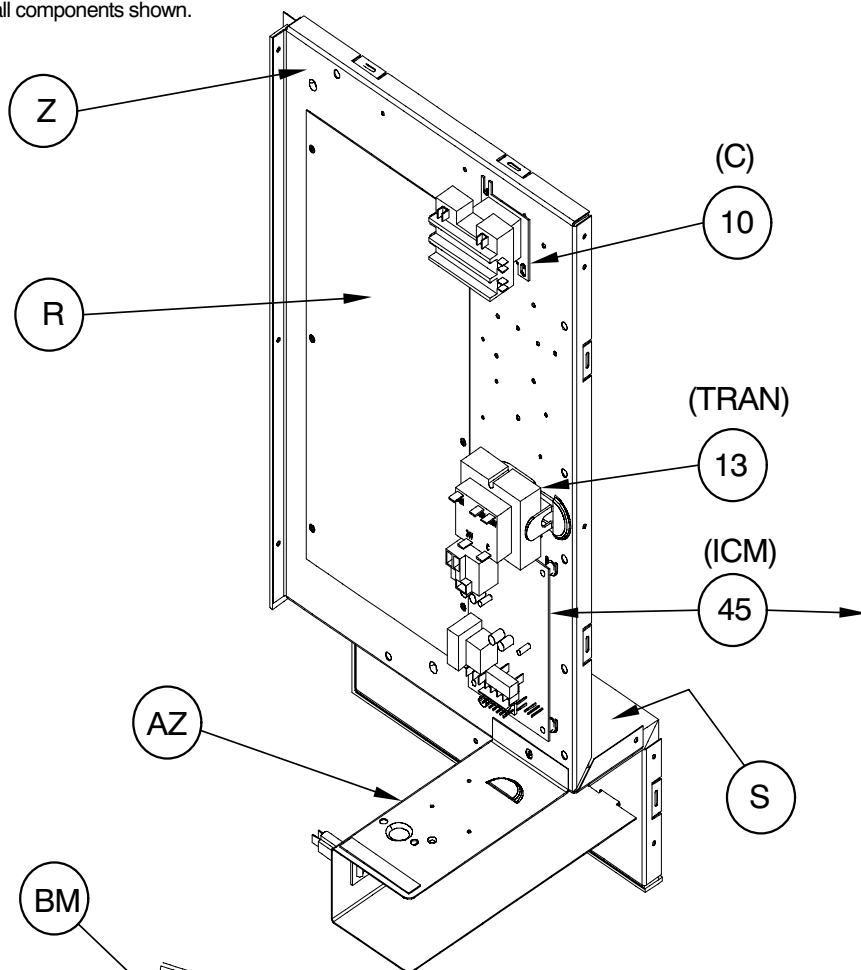

ICM BOARD

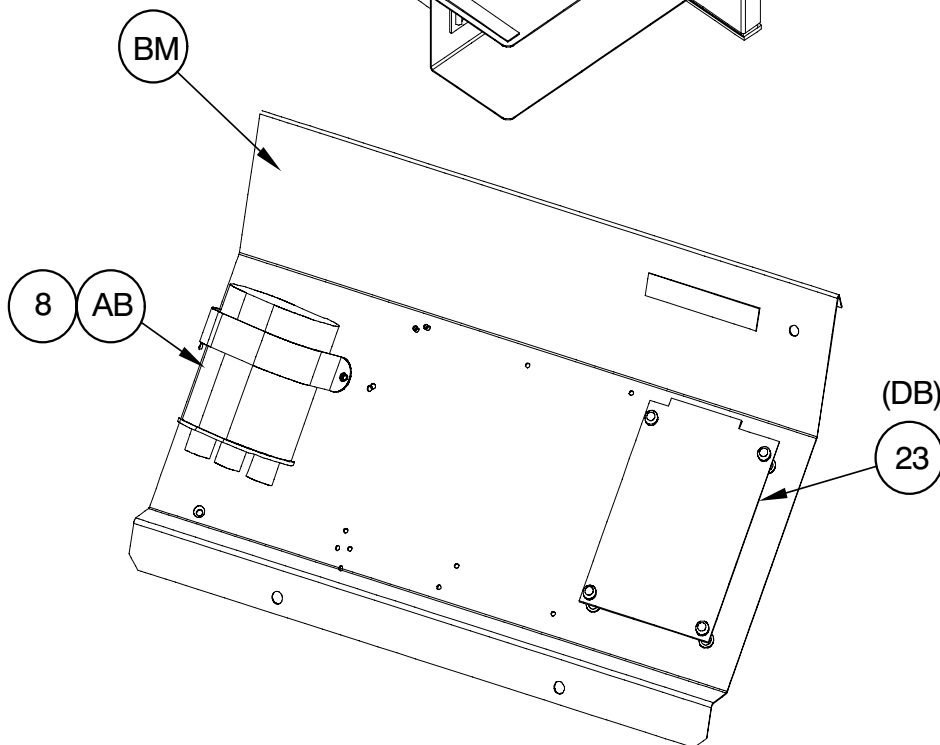

CONTROL PANEL ASY

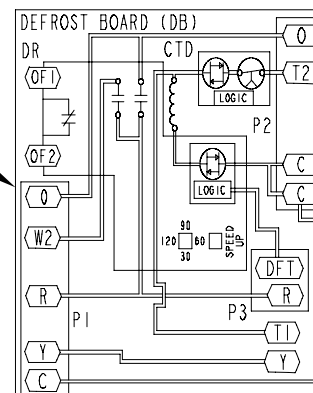

NOTE: This illustration is for reference only. Your unit may differ in appearance or may not include all components shown.

BLOWER ASY

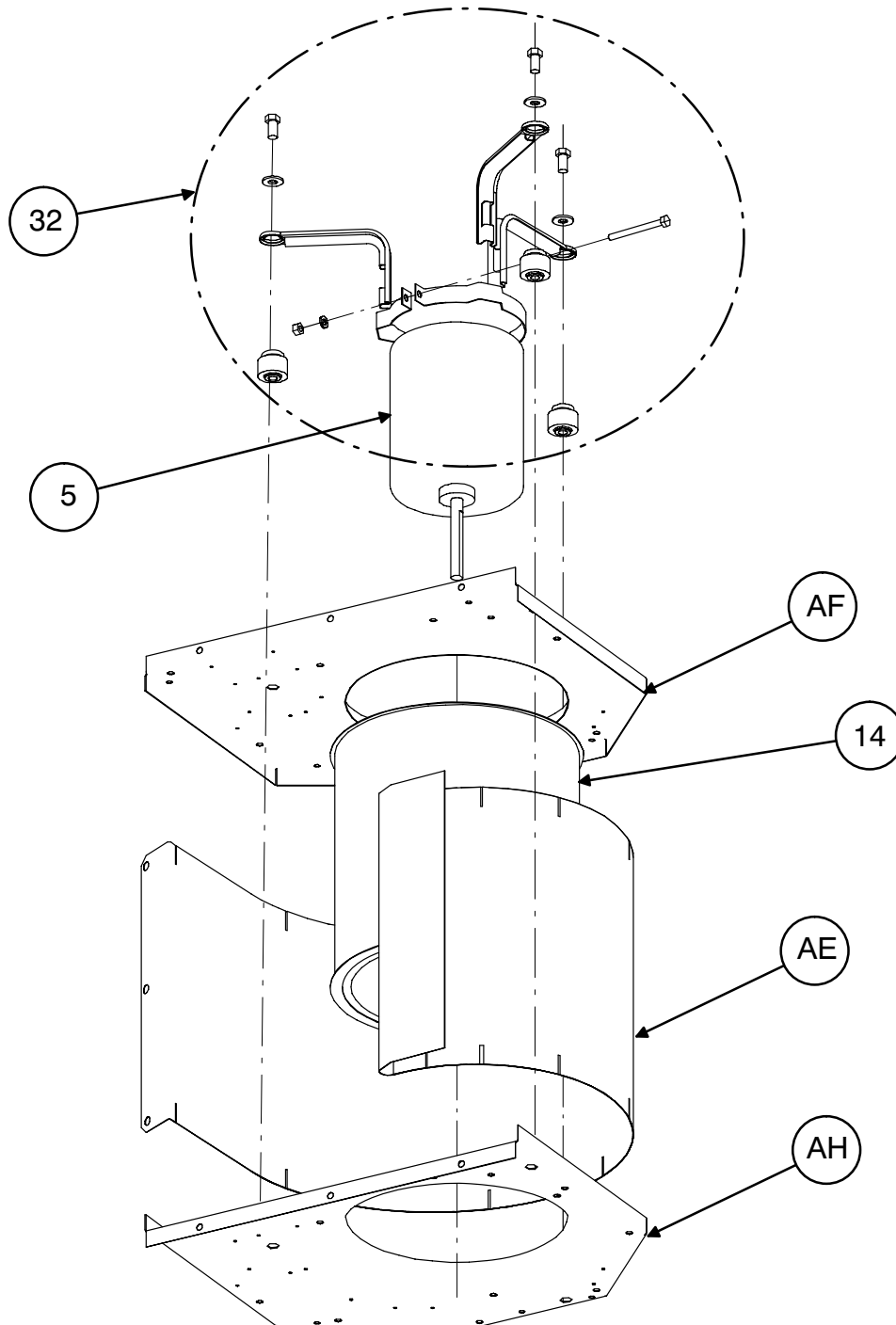

PHN4 24 & 30

NOTE: This illustration is for reference only. Your unit may differ in appearance or may not include all components shown.

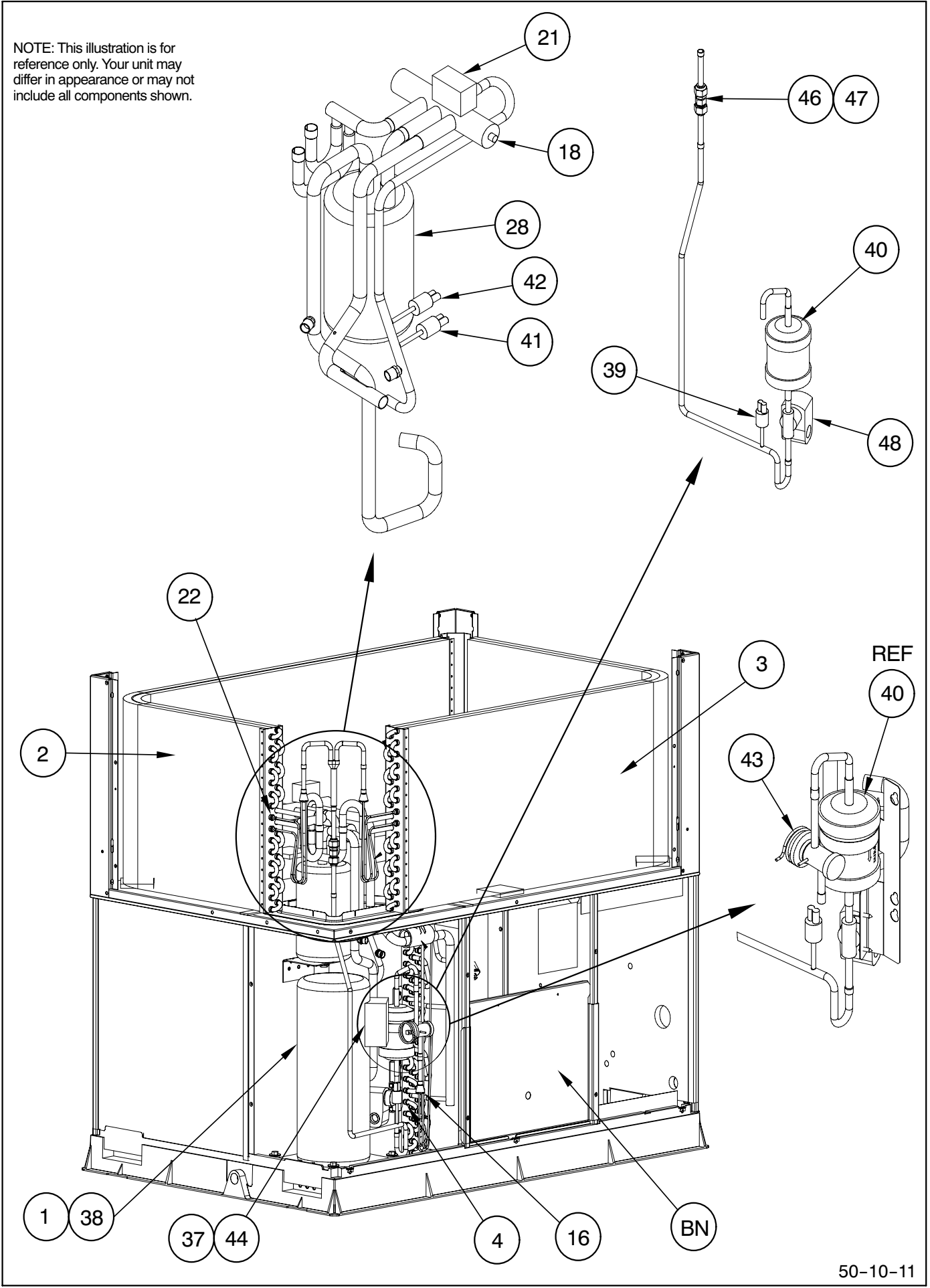

50-10-11

PHN4 24 & 30

NOTE: This illustration is for reference only. Your unit may differ in appearance or may not include all components shown.

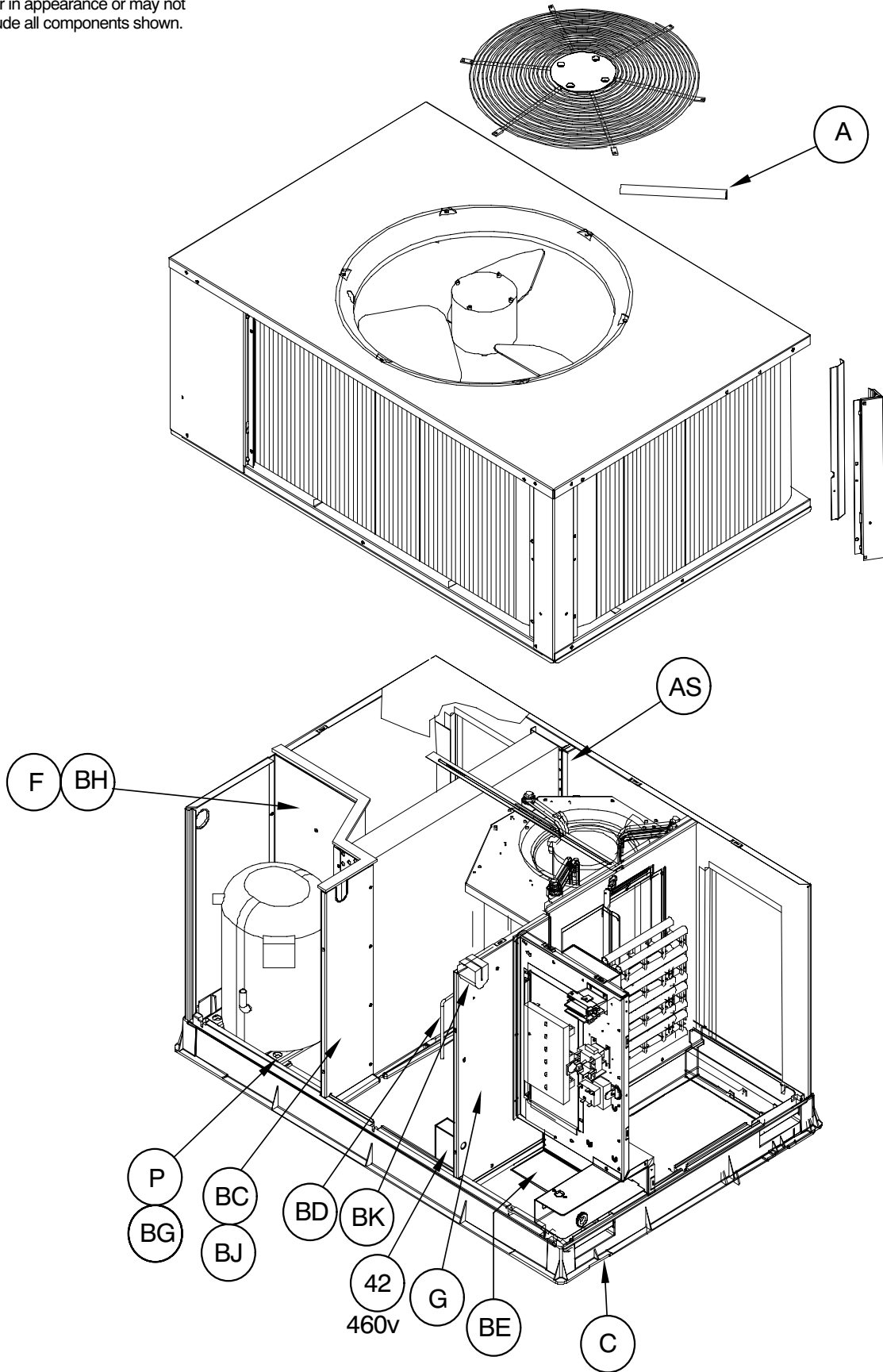

NOTE: This illustration is for reference only. Your unit may differ in appearance or may not include all components shown.

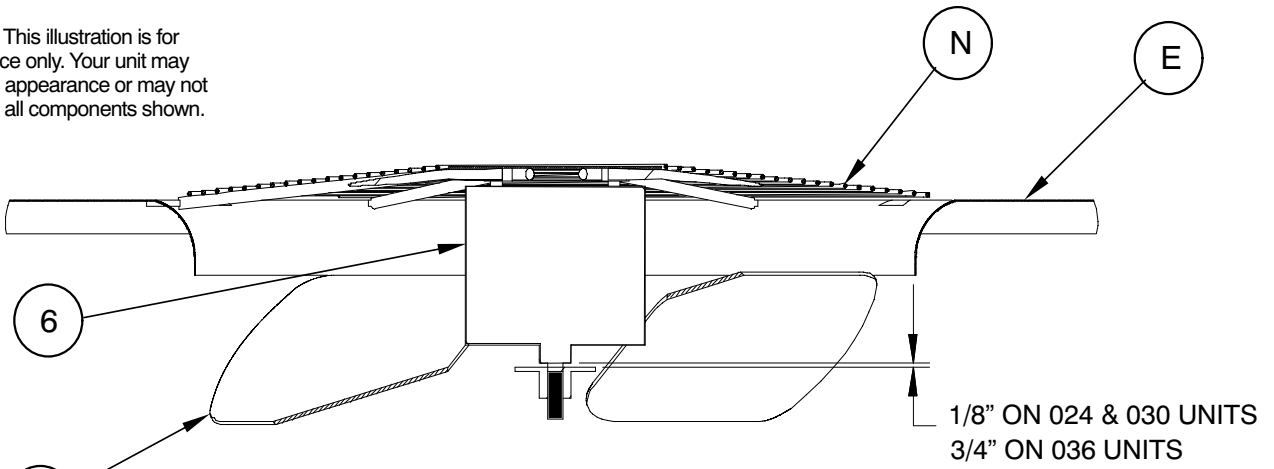

OUTDOOR MOTOR AND FAN GAP

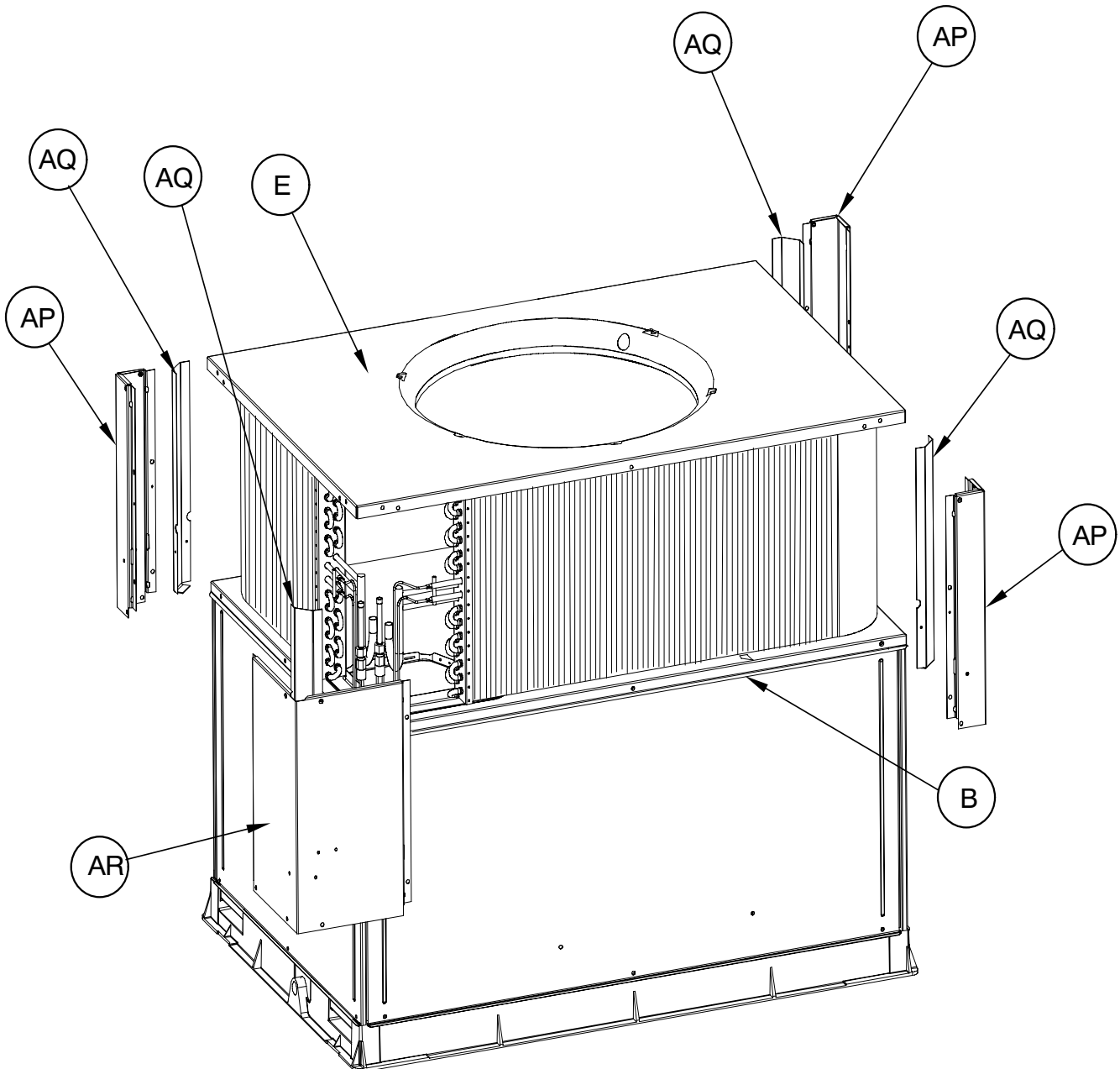

PHN4 24 & 30

NOTE: This illustration is for reference only. Your unit may differ in appearance or may not include all components shown.

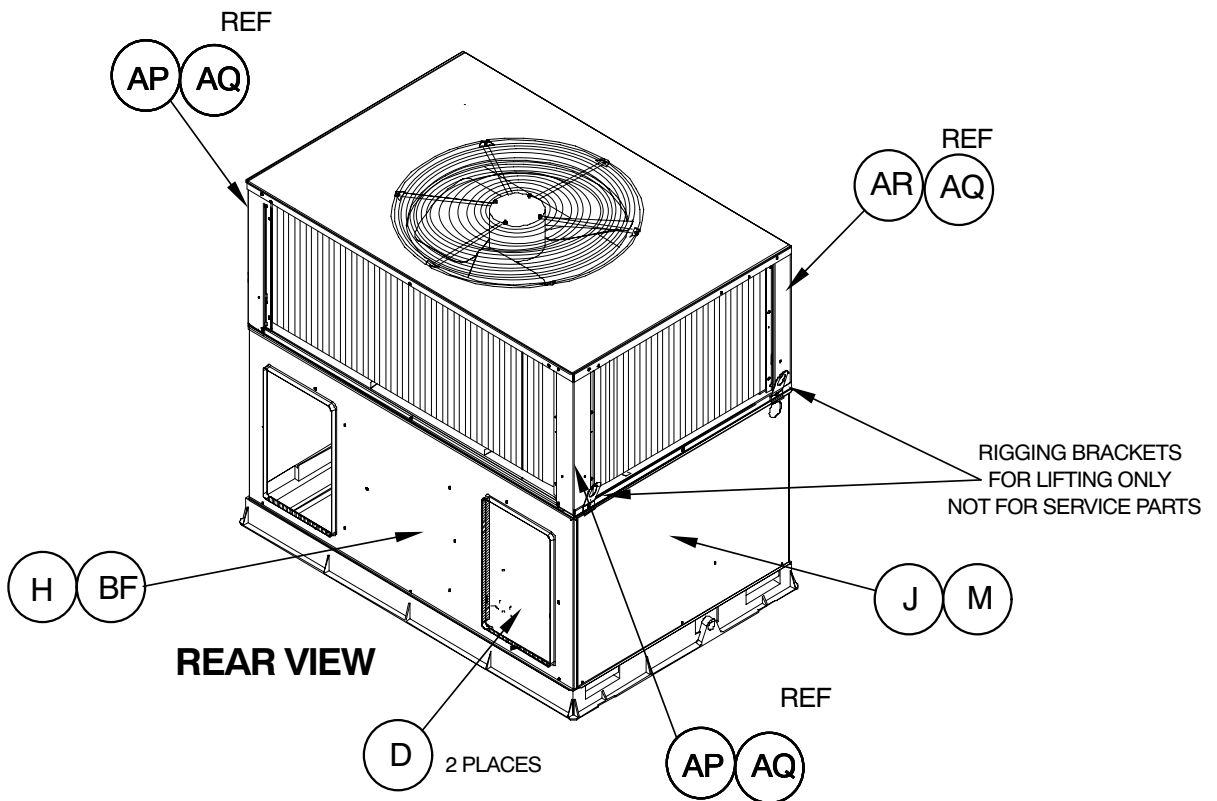
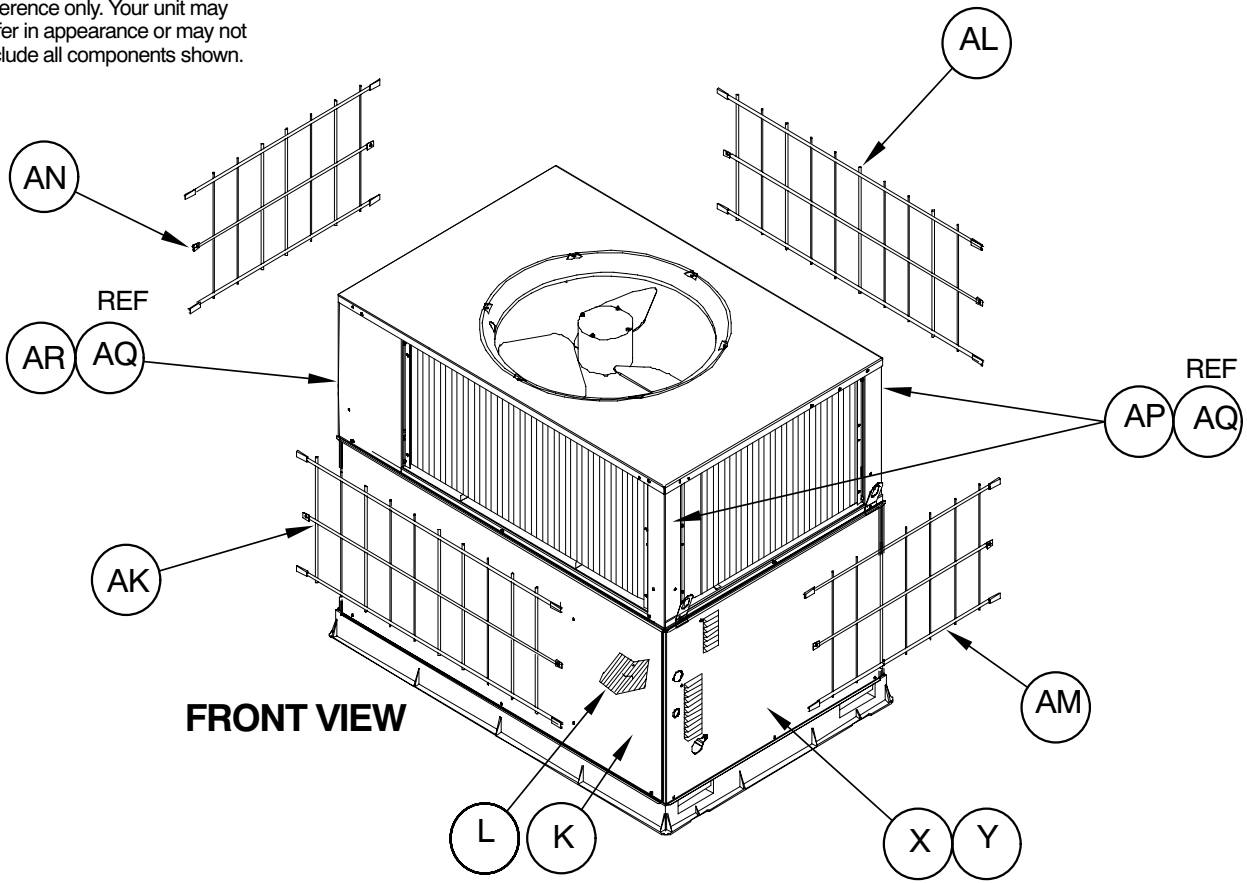

NOTE: This illustration is for reference only. Your unit may differ in appearance or may not include all components shown.

CONTROL BOX ASY

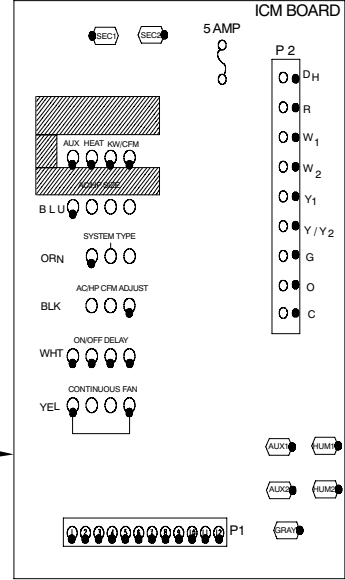
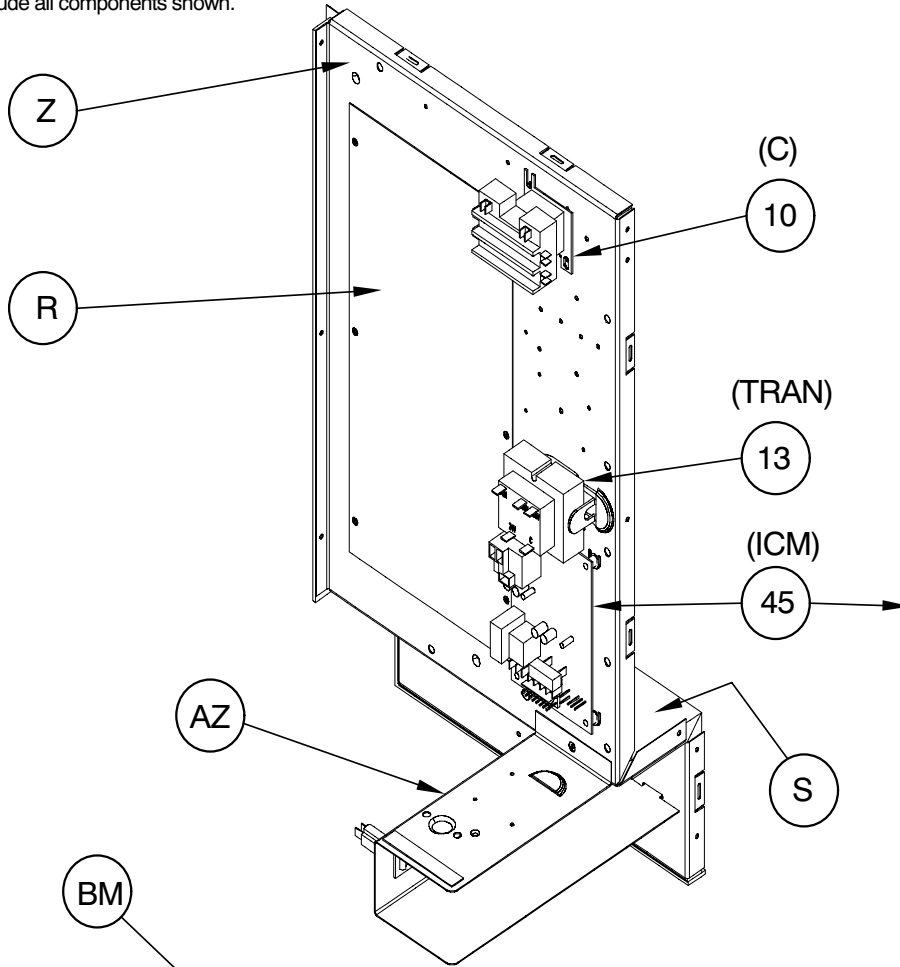

ICM BOARD

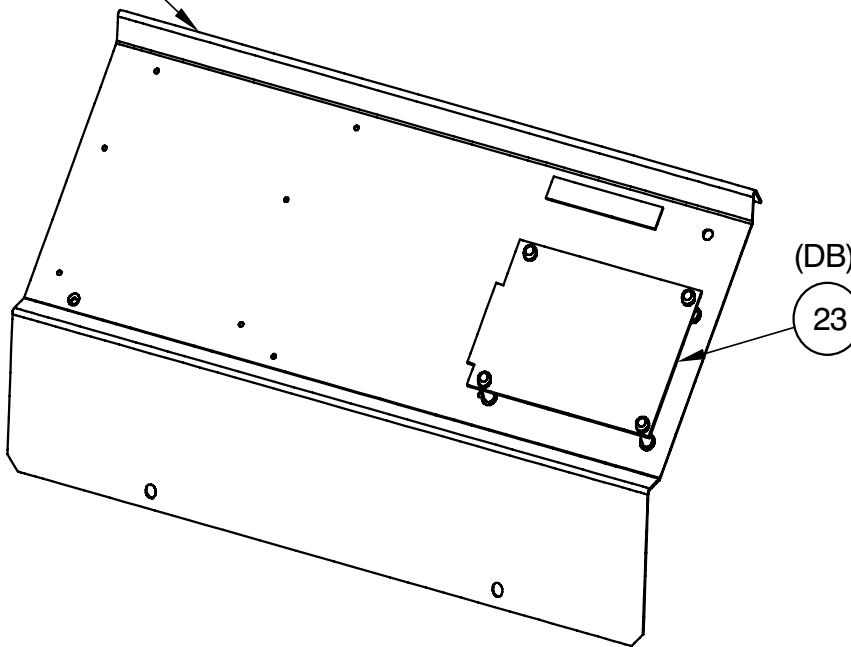

CONTROL PANEL ASY

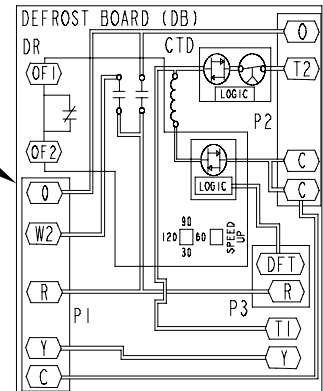

NOTE: This illustration is for reference only. Your unit may differ in appearance or may not include all components shown.

BLOWER ASY

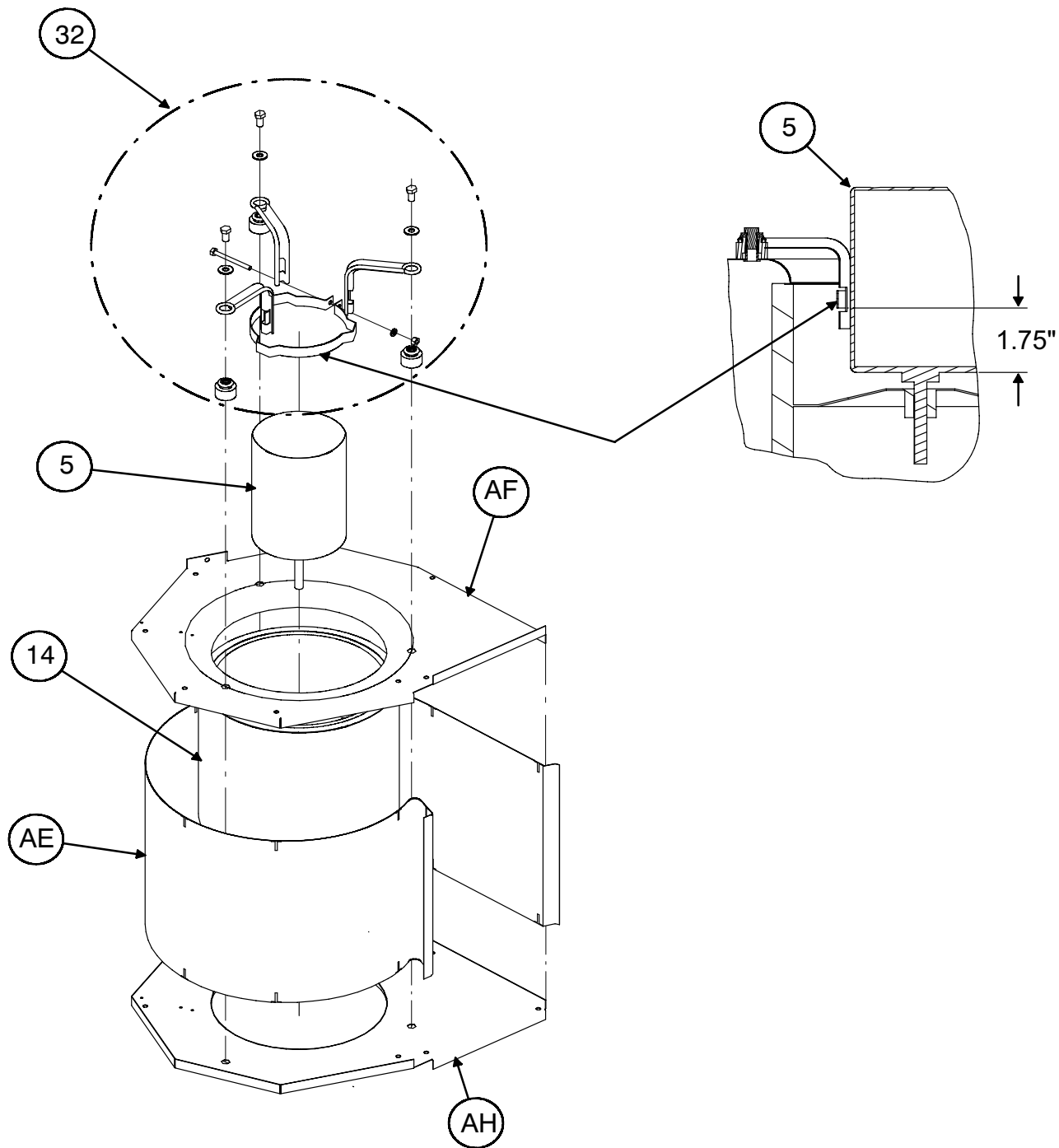

NOTE: This illustration is for reference only. Your unit may differ in appearance or may not include all components shown.

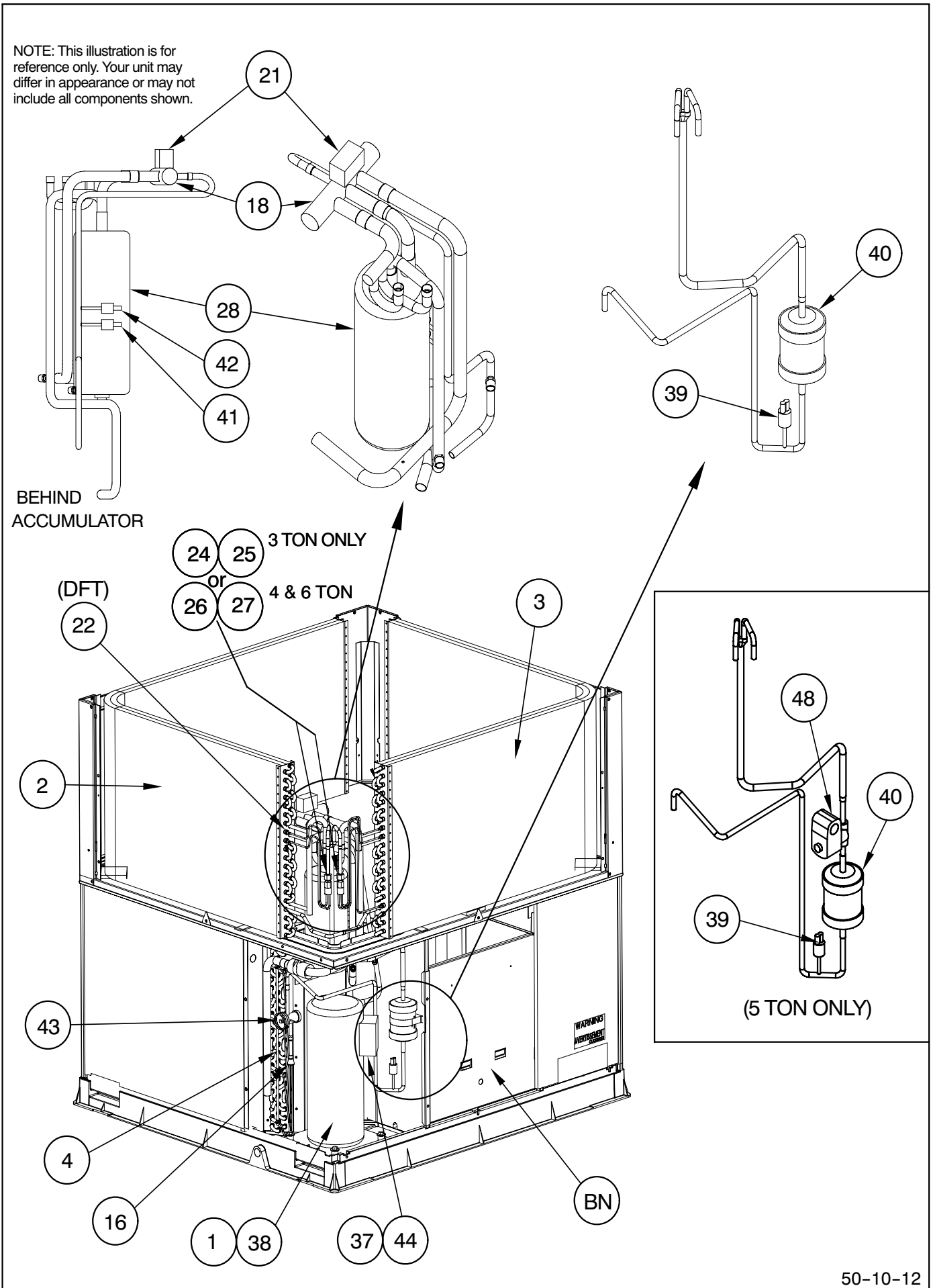

PAN4 36 - 60

NOTE: This illustration is for reference only. Your unit may differ in appearance or may not include all components shown.

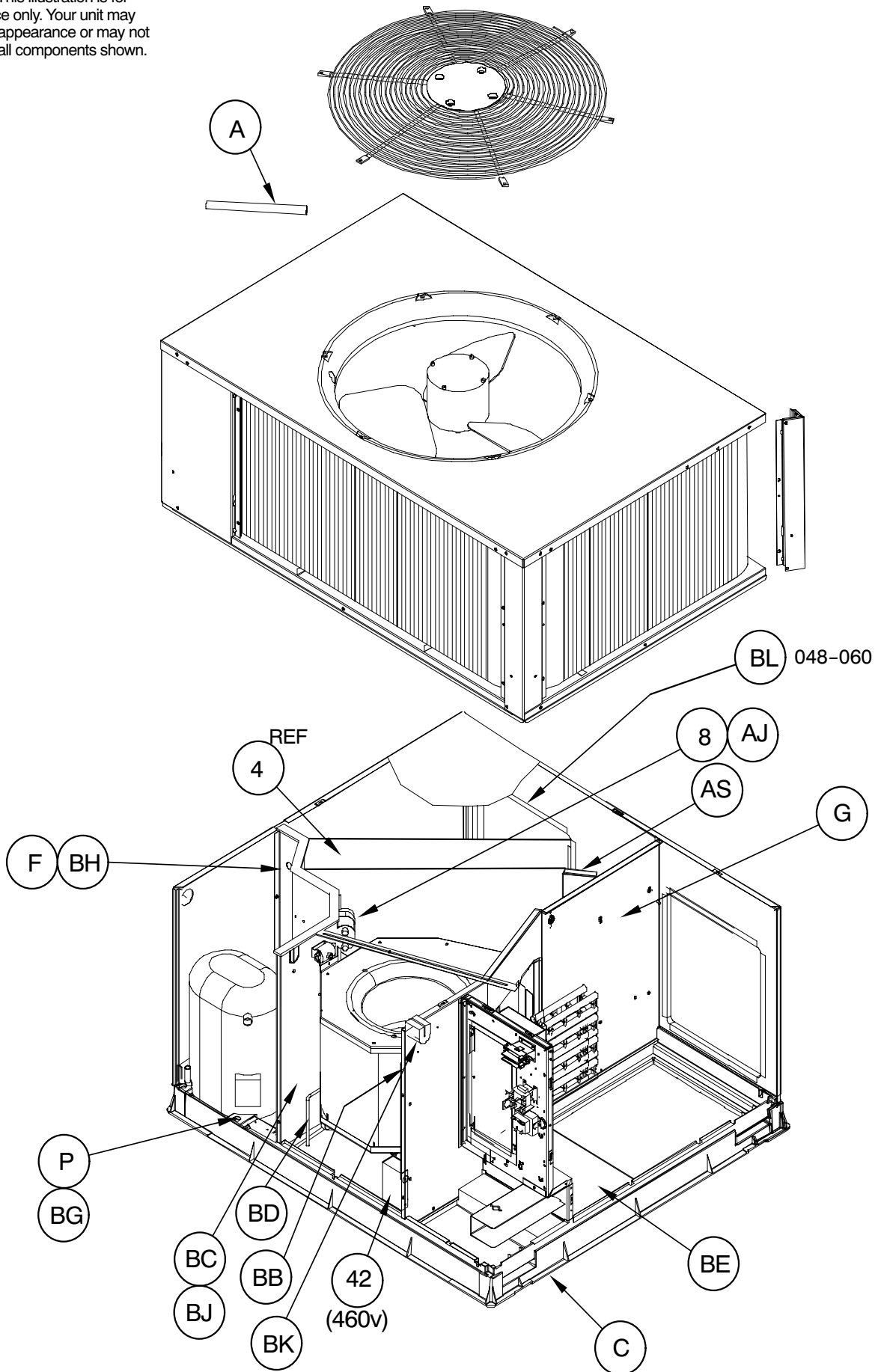

PHD013

NOTE: This illustration is for reference only. Your unit may differ in appearance or may not include all components shown.

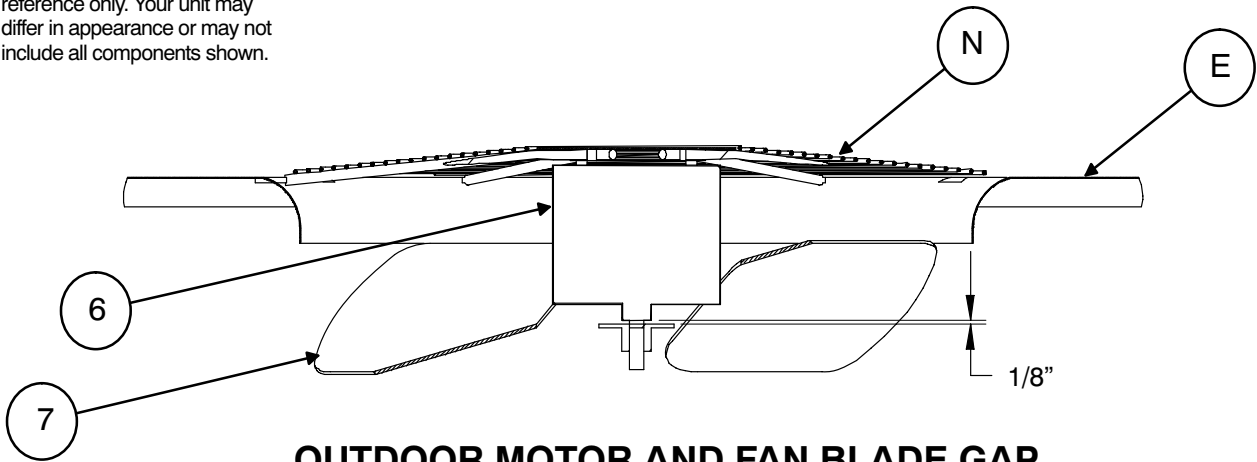

OUTDOOR MOTOR AND FAN BLADE GAP

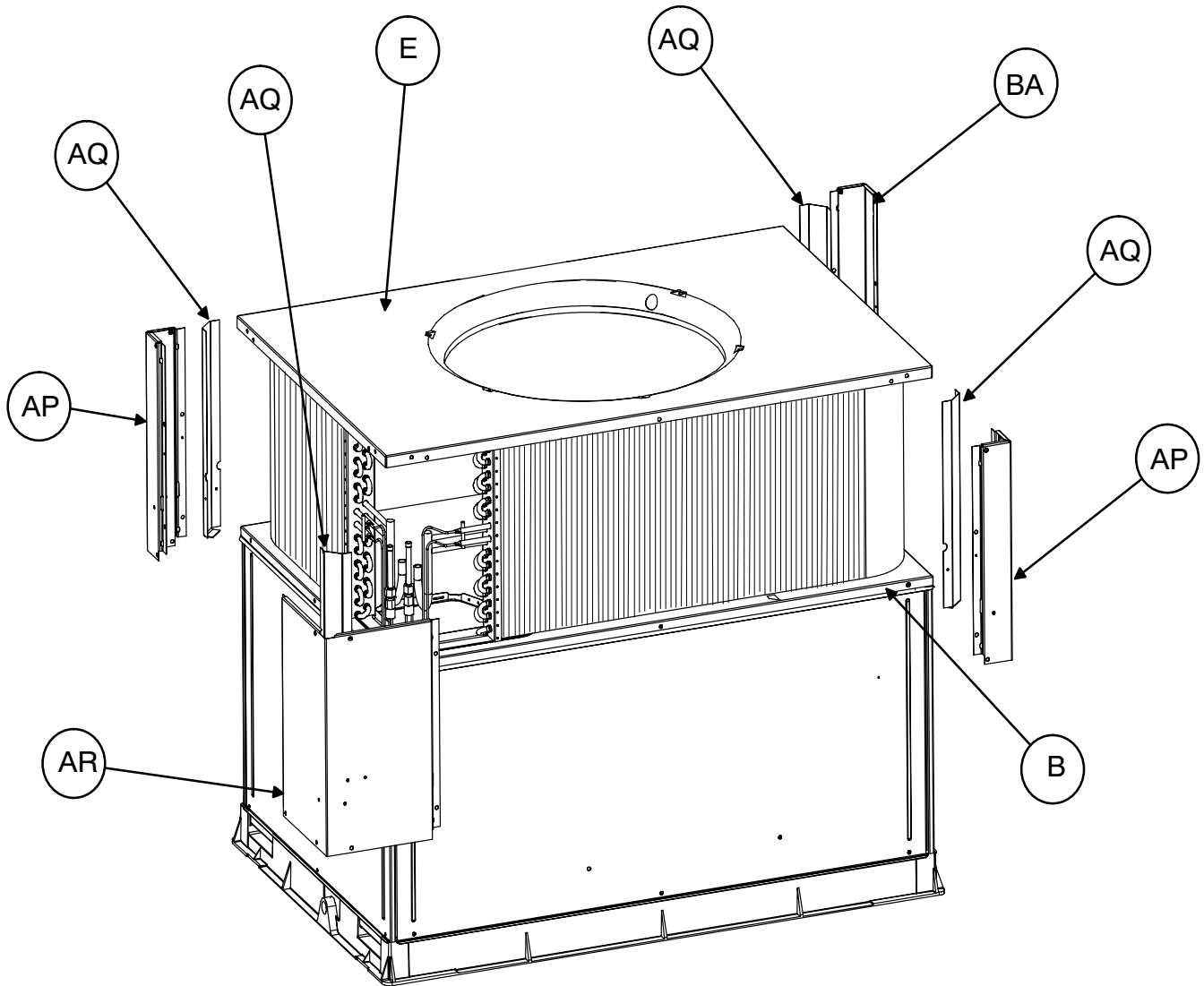

NOTE: This illustration is for reference only. Your unit may differ in appearance or may not include all components shown.

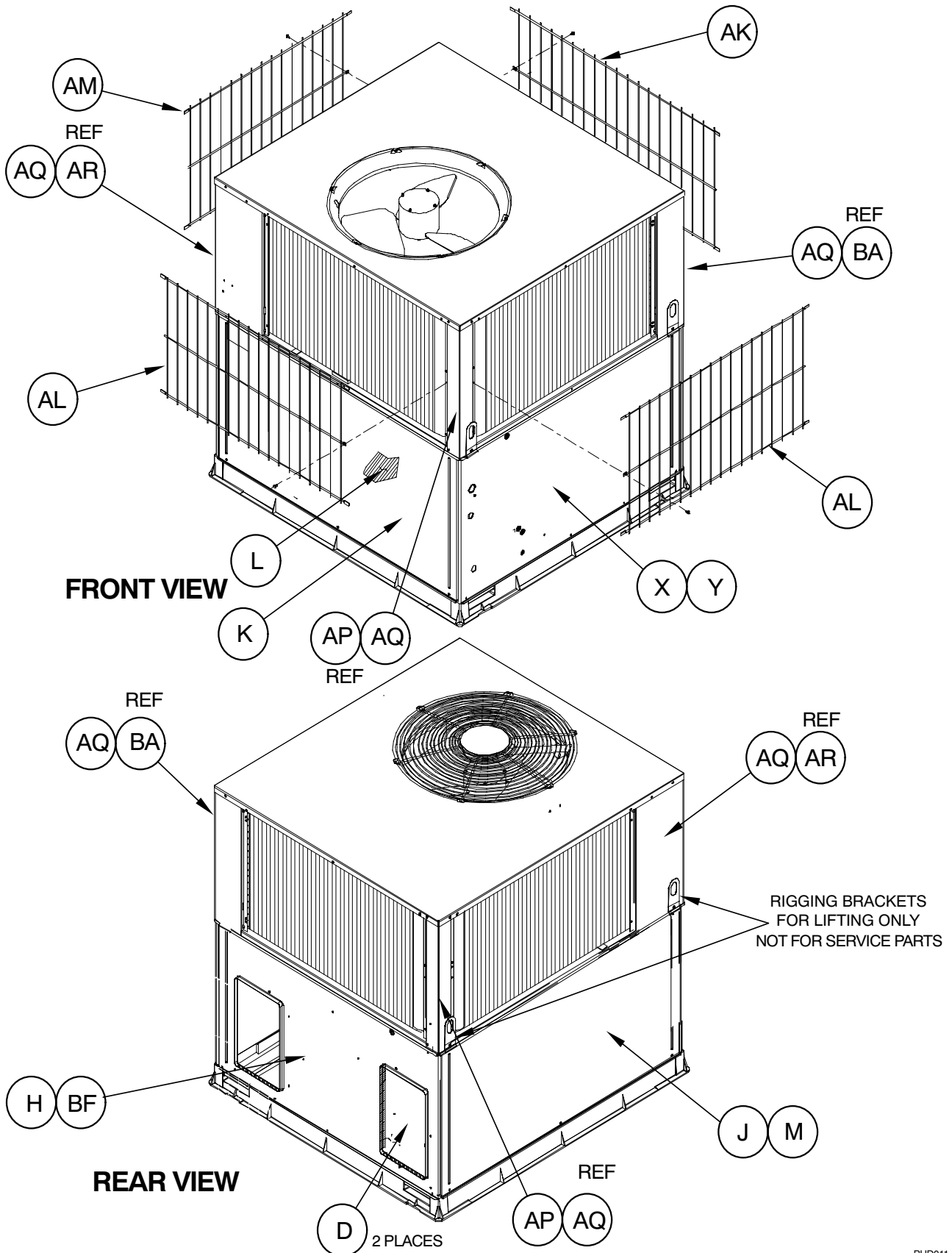

CHARGING CHART PHN4 24 – 60

Charging Procedure

- 1- Measure Discharge line pressure by attaching a gauge to the service port.
- 2- Measure the Liquid line temperature by attaching a temperature sensing device to it.
- 3- Insulate the temperature sensing device so that the Outdoor Ambient doesn't affect the reading.
- 4- Refer to the required Subcooling in the table based on the model size and the Outdoor Ambient temperature.
- 5- Interpolate if the Outdoor ambient temperature lies in between the table values.
- 6- Find the Pressure Value in the table corresponding to the the measured Pressure of the Compressor Discharge line.
- 7- Read across from the Pressure reading to obtain the Liquid line temperature for a required Subcooling
- 8- Add Charge if the measured temperature is higher than the table value.
- 9 - Remove charge if the measured temperature is lower than the table value.

REQUIRED SUBCOOLING °F(°C)					
Model Size	Outdoor Ambient Temperature °F(°C)				
	75 (24)	85 (29)	95 (35)	105 (41)	115 (46)
024	12 (6.7)	12 (6.7)	12 (6.7)	11 (6.1)	11 (6.1)
030	16 (8.9)	15 (8.3)	15 (8.3)	15 (8.3)	14 (7.8)
036	16 (8.9)	15 (8.3)	14 (7.8)	14 (7.8)	13 (7.2)
042	14 (7.8)	14 (7.8)	13 (7.2)	13 (7.2)	13 (7.2)
048	18 (10)	17 (9.4)	17 (9.4)	17 (9.4)	17 (9.4)
060	15 (8.3)	15 (8.3)	14 (7.8)	14 (7.8)	14 (7.8)

Required Liquid Line Temperature for a Specific Subcooling (R-410A)

Pressure (psig)	Required Subcooling (°F)					Pressure (kPa)	Required Subcooling (°C)						
	5	10	15	20	25		3	6	8	11	14		
189	66	61	56	51	46	41	1303	19	16	13	11	8	5
196	68	63	58	53	48	43	1351	20	17	15	12	9	6
203	71	66	61	56	51	46	1399	21	19	16	13	10	8
210	73	68	63	58	53	48	1448	23	20	17	14	11	9
217	75	70	65	60	55	50	1496	24	21	18	15	13	10
224	77	72	67	62	57	52	1544	25	22	19	16	14	11
231	79	74	69	64	59	54	1593	26	23	20	18	15	12
238	81	76	71	66	61	56	1641	27	24	21	19	16	13
245	82	77	72	67	62	57	1689	28	25	22	20	17	14
252	84	79	74	69	64	59	1737	29	26	23	21	18	15
260	86	81	76	71	66	61	1792	30	27	25	22	19	16
268	88	83	78	73	68	63	1848	31	29	26	23	20	17
276	90	85	80	75	70	65	1903	32	30	27	24	21	19
284	92	87	82	77	72	67	1958	33	31	28	25	22	20
292	94	89	84	79	74	69	2013	35	32	29	26	23	21
300	96	91	86	81	76	71	2068	36	33	30	27	24	22
309	98	93	88	83	78	73	2130	37	34	31	28	26	23
318	100	95	90	85	80	75	2192	38	35	32	29	27	24
327	102	97	92	87	82	77	2254	39	36	33	31	28	25
336	104	99	94	89	84	79	2316	40	37	34	32	29	26
345	106	101	96	91	86	81	2378	41	38	35	33	30	27
354	108	103	98	93	88	83	2440	42	39	36	34	31	28
364	110	105	100	95	90	85	2509	43	40	38	35	32	29
374	112	107	102	97	92	87	2578	44	41	39	36	33	30
384	113	108	103	98	93	88	2647	45	42	40	37	34	31
394	115	110	105	100	95	90	2716	46	44	41	38	35	32
404	117	112	107	102	97	92	2785	47	45	42	39	36	33
414	119	114	109	104	99	94	2854	48	46	43	40	37	34
424	121	116	111	106	101	96	2923	49	47	44	41	38	35
434	123	118	113	108	103	98	2992	50	48	45	42	39	36
444	124	119	114	109	104	99	3061	51	48	46	43	40	37
454	126	121	116	111	106	101	3130	52	49	47	44	41	38
464	128	123	118	113	108	103	3199	53	50	48	45	42	39
474	129	124	119	114	109	104	3268	54	51	48	46	43	40
484	131	126	121	116	111	106	3337	55	52	49	47	44	41
494	132	127	122	117	112	107	3406	56	53	50	47	45	42
504	134	129	124	119	114	109	3475	57	54	51	48	46	43
514	136	131	126	121	116	111	3544	58	55	52	49	46	44
524	137	132	127	122	117	112	3612	58	56	53	50	47	45
534	139	134	129	124	119	114	3681	59	56	54	51	48	45

CONNECTION WIRING DIAGRAM
 DANGER: ELECTRICAL SHOCK HAZARD DISCONNECT POWER BEFORE SERVICING

SCHEMATIC
 208/230-1-60

- NOTES:
- IF ANY OF THE ORIGINAL WIRES FURNISHED ARE REPLACED, THEY MUST BE REPLACED WITH THE SAME WIRE OR ITS EQUIVALENT.
 - USE 75 DEG. COPPER CONDUCTORS FOR FIELD INSTALLATION.
 - SEE INSTALLATION INSTRUCTIONS FOR PROPER HEATING AND COOLING CONNECTIONS FOR YOUR UNIT. INDOOR FAN MOTOR PLUGS - "DO NOT DISCONNECT UNDER LOAD"
 - CCH NOT USED ON ALL UNITS.

- LEGEND
- | | | | |
|-------|--|--------|----------------------------|
| △ | FIELD SPLICE | COMP | COMPRESSOR MOTOR |
| ○ | TERMINAL (MARKED) | DB | DEFROST BOARD |
| ○ | TERMINAL (UNMARKED) | DFT | DEFROST TEMPERATURE SWITCH |
| ● | SPLICE | DR | DEFROST RELAY |
| ○ | SPLICE (MARKED) | EQUIP | EQUIPMENT |
| --- | FACTORY WIRING | GND | GROUND |
| --- | FIELD CONTROL WIRING | HPS | HIGH PRESSURE SWITCH |
| --- | FIELD POWER WIRING | HR | HEATER RELAY |
| --- | ACCESSORY OR OPTIONAL WIRING | IFB | INDOOR FAN BOARD |
| --- | TO INDICATE COMMON POTENTIAL ONLY; NOT TO REPRESENT WIRING | IFM | INDOOR FAN MOTOR |
| C | CONTACTOR | LPS | LOW PRESSURE SWITCH |
| CAP 1 | CAPACITOR, COMP | OFM | OUTDOOR FAN MOTOR |
| CCH | CRANK CASE HEATER | RVS | REVERSING VALVE |
| | | TRAN | TRANSFORMER |
| | | T-STAT | THERMOSTAT |

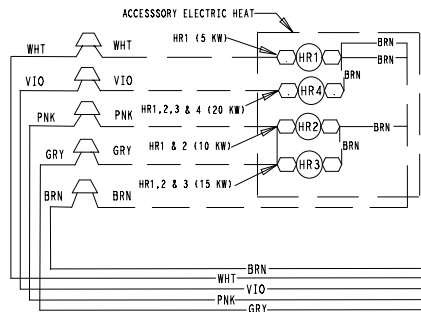
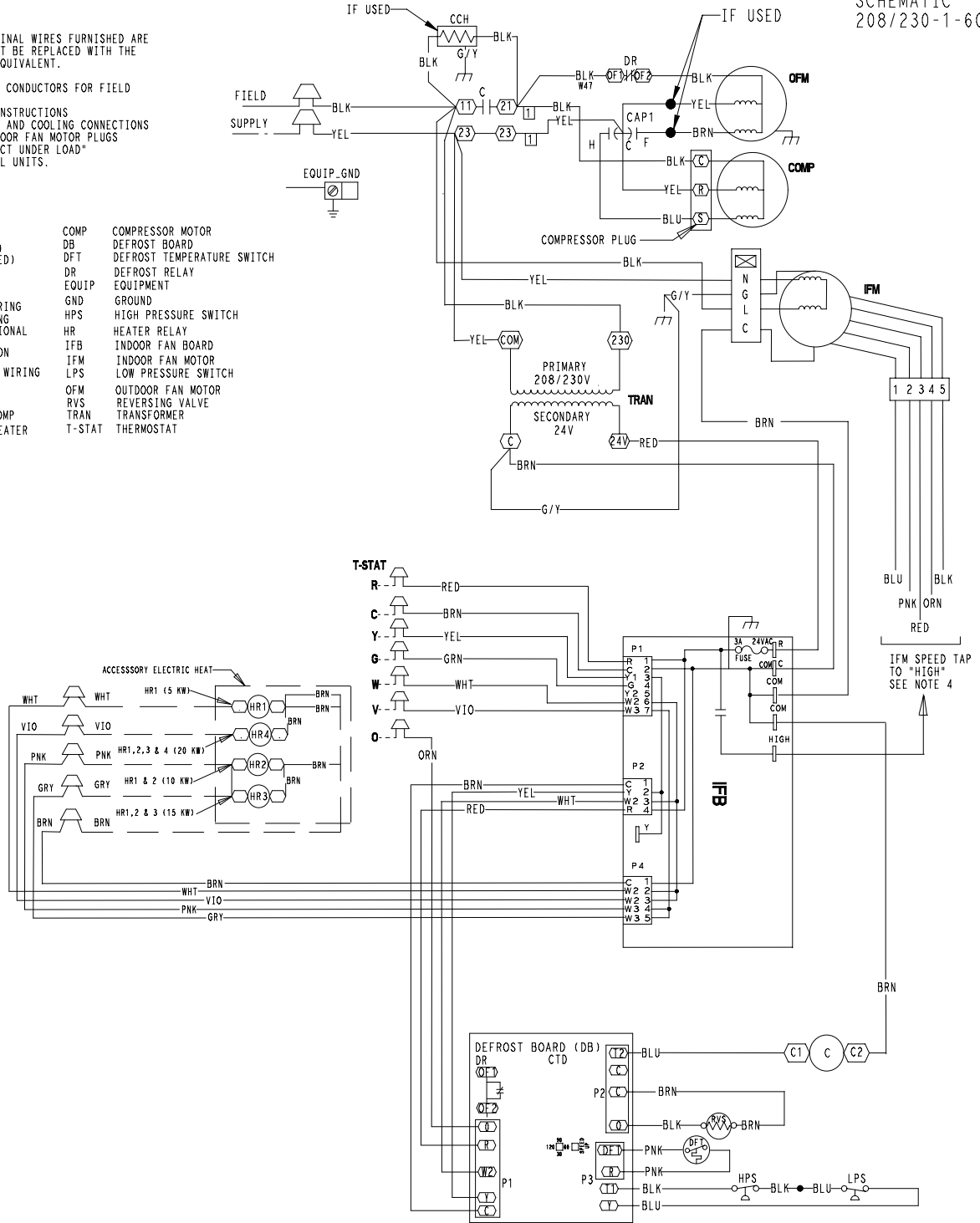

DIP SWITCH SETTINGS

COLOR CODE

- | | |
|-----|--------|
| BLK | BLACK |
| BLU | BLUE |
| BRN | BROWN |
| GRY | GRAY |
| GRN | GREEN |
| ORN | ORANGE |
| PNK | PINK |
| RED | RED |
| VIO | VIOLET |
| WHT | WHITE |
| YEL | YELLOW |

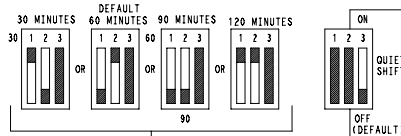
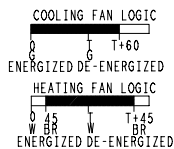

FIELD SELECTABLE OPTIONS FOR TIME PERIOD BETWEEN DEFROST CYCLES (MINUTES)
 THE COMPRESSOR WILL SHUT OFF FOR 30 SEC. ON DEFROST INITIATION AND TERMINATION IN THE "QUIET SHIFT" ON POSITION

- SPEED UP JUMPERED TEST PINS (USE METAL OBJECT) FIELD SPEED-UP CYCLE
- MOMENTARILY SHORT PINS AND RELEASE TO BYPASS COMPRESSOR OFF DELAY.
 - SHORT FOR 5+ SEC. AND RELEASE FOR FORCED DEFROST.
 - PERMANENT SHORT WILL BE IGNORED.
- DEFROST WILL TERMINATE IN 30 SEC. IF DFT OPEN.
 DEFROST WILL TERMINATE NORMALLY IF DFT IS CLOSED.

LADDER WIRING DIAGRAM
 DANGER: ELECTRICAL SHOCK HAZARD DISCONNECT POWER BEFORE SERVICING

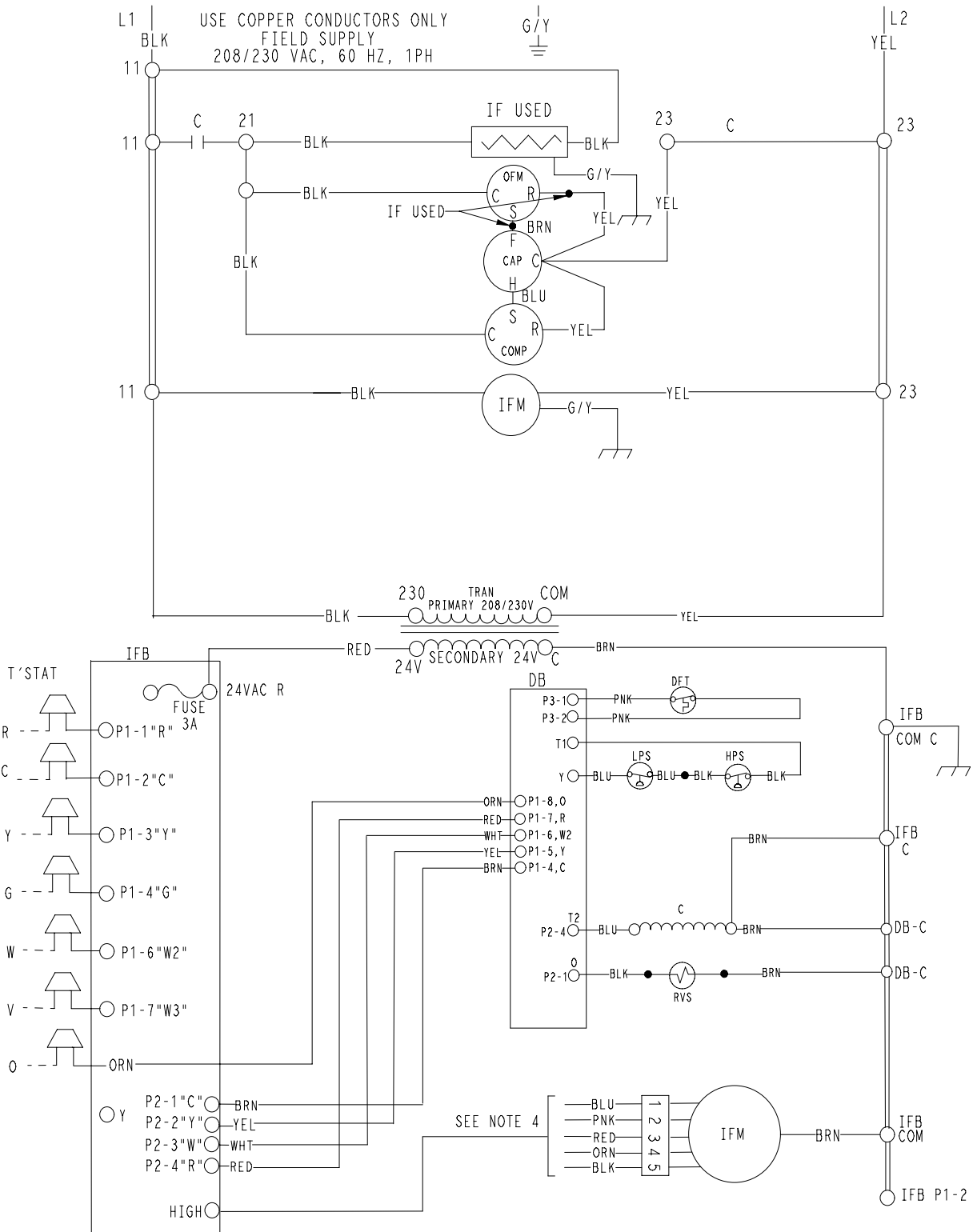

50EZ500160 | 2.0