

Parts List, Charging Chart, Wiring Diagrams

PHH150, PHH180
3 Phase

PACKAGE HEAT PUMP UNITS



TABLE OF CONTENTS

PARTS LIST-----	2 - 5
PARTS DRAWING-----	6 - 16
CHARGING CHARTS-----	17
WIRING DIAGRAMS-----	18 - 25

PHH150, PHH180 3 Phase PARTS LIST

KEY NO.	DESCRIPTION	FAST PARTS NO.	PHH150H0A00AAA	PHH150L0A00AAA	PHH180H0A00AAA	PHH180L0A00AAA
01	BEARING BALL 1-3/16"	1171035	2	2	*	*
01	BEARING PILLOW BLOCK 1-7/16"	1171034	*	*	2	2
02	BELT V B42 45"	1171511	1	1	*	*
02	BELT V B48 51"	1171512	*	*	1	1
03	CAP RN OV 370V 10	1171729	3	3	3	3
04	BREAKER 3.2A 1 POLE 250V	1171114	2	2	2	2
05	BREAKER 34A 3 POLE 600V	1173434	*	1	*	*
05	BREAKER 37A 3 POLE 240V	1173435	*	*	2	*
05	BREAKER 53A 3 POLE 240V	1173433	1	*	*	*
05	BREAKER 55A 3 POLE 240V	1173436	*	*	*	2
06	COIL ASY COND AL/CU	1173449	*	*	1	1
06	COIL ASY COND AL/CU	1173450	1	1	*	*
07	COIL ASY EVAP AL/CU	1173441	*	*	1	1
07	COIL ASY EVAP AL/CU	1173442	1	1	*	*
08	VALVE CHECK	1173563	*	*	4	4
08	VALVE CHECK	1173564	2	2	*	*
09	COMP 06DM8186AC0600	1173458	*	*	*	1
09	COMP 06DM8186AC1200	1173459	*	*	1	*
09	COMP 06DS3286BC3200	1174756	1	*	*	*
09	COMP 06DS3286BC3600	1173457	*	1	*	*
10	VALVE CHECK	1173431	4	4	8	8
11	CONTACTOR 2P 30A 24V	1176523	2	*	1	1
11	CONTACTOR 3P 25A 24V	1173184	*	1	*	*
12	CONTACTOR 3P 40A 24V	1172449	*	1	2	2
12	CONTACTOR 3P 60A 240V	1171162	1	*	*	*
13	STRAINER 1/2" OD X 1/2" ID	1173546	1	1	2	2
14	DRIER 16 CI 1/2"IN & OUT	1171203	1	1	2	2
15	BOARD CONTROL (DEFROST)	1173425	1	1	1	1
16	KIT CRANKCASE HEATER	1173516	1	1	2	*
16	KIT CRANKCASE HEATER	1176565	*	*	*	2
17	FUSE	1173489	*	3	*	3
17	FUSE SC-30 30A 600V	1171255	3	*	3	*
18	FUSE HOLDER HPF 30A 600V	1171258	*	3	*	3
18	FUSE HOLDER HPS-FF 30A 300V	1171259	3	*	3	*
19	KIT COMP MTG HARDWARE	1176540	1	1	2	2
20	RELAY 24V SPDT R8222B1117	1171806	1	1	*	*
20	RELAY DPDT PILOT 24V	1173539	*	*	1	1
21	KEY	1171321	*	*	1	1
21	KEY SHAFT 1/4X1/4X2-1/4	1171320	1	1	*	*
22	MTR BLT 3/208-460 3.5 1725	1171341	1	1	*	*
22	MTR BLT 3/208-460 5.0 1745	1170542	*	*	1	1
23	MTR CND 1/230 1/2	1171342	3	*	3	*
23	MTR CND 1/460 1/2	1171336	*	3	*	3
24	COIL SOLENOID UNL 24V	1173440	1	1	2	2
25	COIL REV VLV 24V	1172619	1	1	2	2
26	FAN C 22" 3B 1/2" 28 INT	1171219	3	3	3	3
27	PULLEY	1170699	*	*	1	1
27	PULLEY	1171421	1	1	*	*
28	PULLEY	1171418	1	1	*	*

PHH150, PHH180 3 Phase PARTS LIST (continued)

KEY NO.	DESCRIPTION	FAST PARTS NO.	PHH150H0A00AAA	PHH150L0A00AAA	PHH180H0A00AAA	PHH180L0A00AAA
28	PULLEY	1171419	*	*	1	1
29	RELAY 24V 3PDT KU93-4267-1	1171433	1	1	2	2
30	RELAY SENSING	1171434	1	1	2	2
31	FAN SHAFT	1171225	*	*	1	1
31	FAN SHAFT	1171451	1	1	*	*
32	SWITCH PRESS HI O426 C320	1172381	1	1	2	2
33	SWITCH PRESS LO O07 C22	1173554	1	1	2	2
34	SENSOR DEFROST O65 C28	1173559	1	1	1	1
35	TERMINAL BOARD	1173591	1	1	1	1
36	TERMINAL BLOCK	1171485	1	1	1	1
37	TRANS 200/230/460>24 75VA	1171498	2	2	2	2
38	BREAKER 15A 3 POLE 480V	1170544	*	*	1	*
38	BREAKER 23A 3 POLE 600V	1170545	*	*	*	1
39	SNUBBER ASY	1173545	1	1	2	2
40	VALVE REVERSING LESS COIL	1173567	*	*	2	2
40	VALVE REVERSING LESS COIL	1173568	1	1	*	*
41	WHEEL BD10x10x1-3/16 REV CV	1171048	2	2	*	*
41	WHEEL BD12x12x1-7/16 REV CV	1171052	*	*	2	2
42	RELAY 24V DPST 9400-03Q228	1171436	1	1	1	1
43	CONTACTOR 2P 30A 24V	1171163	*	*	1	*
43	CONTACTOR 3P 30A 24V	1171164	*	*	*	1
43	RELAY 24V SPST NO	1172422	2	1	*	*
44	ACCUMULATOR	1173417	1	1	2	2
45	KIT COMP SHUT OFF VALVE	1173565	*	*	2	2
45	KIT COMP SHUT OFF VALVE	1176554	1	1	*	*
46	KIT COMP SHUT OFF VALVE	1173566	1	1	2	2
47	GASKET COMP SHUT OFF	1173495	*	*	2	2
47	GASKET COMP SHUT OFF	1173497	1	1	*	*
48	GASKET COMP SHUT OFF	1173496	1	1	2	2
49	VALVE COMP	1173560	1	1	2	2
50	MUFFLER	1173522	*	*	2	2
51	FREEZE STAT O30 C45	1171252	1	1	1	1
A	ANGLE	1171118	1	1	1	1
AA	DECK FAN	1171354	1	1	1	1
AB	DECK FAN	1172136	1	1	*	*
AB	FAN DECK	1171215	*	*	1	1
AC	DECK FAN	1171455	1	1	*	*
AC	FAN DECK	1171310	*	*	1	1
AD	STRAP ACCUMULATOR	1176558	1	1	1	1
AE	FAN UPRIGHT	1171226	*	*	1	1
AF	FILTER PACKAGE	1171235	1	1	1	1
AG	GUARD FAN	1171266	3	3	3	3
AH	HOOD SIDE	1171380	1	1	1	1
AJ	HOOD SIDE	1171381	1	1	1	1
AK	FAN DECK	1171213	*	*	1	1
AK	FAN DECK	1171311	1	1	*	*
AL	INSULATION ASY	1171290	1	1	1	1
AM	INSULATION ASY	1171022	1	1	1	1
AN	PLATE MOTOR ADJ	1171389	1	1	*	*

PHH150, PHH180 3 Phase PARTS LIST (continued)

KEY NO.	DESCRIPTION	FAST PARTS NO.	PHH150H0A00AAA	PHH150L0A00AAA	PHH180H0A00AAA	PHH180L0A00AAA
AP	HEAT BAFFLE	1171283	*	*	1	1
AP	INSULATION ASY	1176557	1	1	*	*
AQ	INSULATION ASY	1171361	1	1	1	1
AR	INSULATION ASY	1171017	1	1	1	1
AS	INSULATION ASY	1171284	1	1	*	*
AS	INSULATION ASY	1171881	*	*	1	1
AT	INSULATION ASY	1171217	1	1	1	1
AU	TOP COVER ASY	1171360	1	1	1	1
AV	INSULATION ASY	1171209	1	1	1	1
AW	INSULATION ASY	1171319	1	1	1	1
AX	LATCH ASY	1171019	8	8	8	8
AY	PANEL ACCESS	1171378	2	2	1	1
AZ	PANEL ACCESS	1171377	2	2	2	2
B	ANGLE BASE RAIL	1171029	2	2	2	2
BA	PANEL ACCESS	1171379	2	2	2	2
BB	PANEL BLOCKOFF	1171042	1	1	1	1
BC	PLATE ASY MOTOR	1171346	*	*	1	1
BC	PLATE BACKING	1171390	1	1	*	*
BD	PLATE BLOCKOFF	1171366	2	2	2	2
BD	PLATE BLOCKOFF	1171366	*	2	2	2
BE	PLATE FANSIDE	1171397	2	*	*	*
BE	PLATE FANSIDE	1171046	*	*	2	2
BE	PLATE FANSIDE	1171397	*	2	*	*
BF	PLATE FANSIDE	1171047	*	*	2	2
BF	PLATE FANSIDE	1171398	2	2	*	*
BG	PLATE MOTOR	1171349	1	1	*	*
BG	PLATE MOTOR	1171400	*	*	1	1
BH	PLATE SPACER	1171459	1	1	1	1
BJ	POST CENTER	1171083	4	4	4	4
BK	POST CONDENSER	1171411	1	1	1	1
BL	POST CONDENSER	1171176	1	1	1	1
BM	POST CORNER	1171171	1	1	1	1
BN	POST CORNER	1171408	1	1	1	1
BP	RAIL BASE	1171030	1	1	1	1
BQ	RAIL BASE	1171028	1	1	1	1
BR	RAIL BASE	1171027	1	1	1	1
BS	RAIL COMPRESSOR	1176556	2	2	2	2
BT	RAIL TOP	1171490	1	1	1	1
BU	ANGLE STOP	1171013	*	*	1	1
BV	SCROLL FAN	1171224	*	*	2	2
BV	SCROLL FAN	1171446	2	2	*	*
BW	SPACER FILTER	1171458	1	1	1	1
BX	STRAP FILTER	1172133	2	2	2	2
BY	STRAP CAPACITOR	1172132	1	1	1	1
BZ	SUPPORT COIL	1172131	1	1	1	1
C	ANGLE FILTER	1171085	1	1	1	1
CA	SUPPORT COIL	1171468	1	1	1	1
CB	SUPPORT DECK	1171189	2	2	2	2
CC	SUPPORT LOWER	1171464	1	1	1	1

PHH150, PHH180 3 Phase PARTS LIST (continued)

KEY NO.	DESCRIPTION	FAST PARTS NO.	PHH150H0A00AAA	PHH150L0A00AAA	PHH180H0A00AAA	PHH180L0A00AAA
CD	SUPPORT TOP	1171465	1	1	1	1
CE	SUPPORT TOP	1171847	1	1	1	1
CF	TRACK FILTER	1171492	3	3	3	3
CG	TRACK FILTER	1171491	1	1	1	1
CH	WELD ASY	1171517	1	1	1	1
CJ	WELD ASY	1171236	1	1	1	1
CK	WELD ASY	1171237	1	1	1	1
CL	WELD ASY	1171292	1	1	1	1
CM	WELD ASY	1171291	1	1	1	1
D	INSULATION ASY	1171178	1	1	1	1
DJ	CONDUIT	1172138	1	1	1	1
DL	FILTER AIR 16X20X2 DISP	1171229	4	4	4	4
DM	FILTER AIR 20X20X2 DISP	1171010	4	4	4	4
DN	FILTER AIR 20X20X1 WASHABLE	1171243	1	1	1	1
DP	FILTER AIR 20X25X1 WASHABLE	1171244	2	2	2	2
E	ANGLE SUPPORT	1171014	1	1	1	1
F	BASE PAN	1171021	1	1	1	1
G	BLOCKOFF	1175397	2	2	2	2
H	BRACE UPPER	1171060	1	1	1	1
J	BRACKET ASY	1171073	2	2	*	*
J	BRACKET BEARING	1171036	*	*	2	2
K	BRACKET	1172141	1	1	1	1
L	RETAINER	1171204	1	1	1	1
M	FAN BRACKET	1171210	*	*	2	2
N	FAN BRACKET	1171211	*	*	1	1
P	FAN BRACKET	1171212	*	*	1	1
Q	MOTOR BRACKET	1171075	*	*	1	1
R	MOTOR BRACKET	1171076	*	*	1	1
S	PANEL DRIP	1171111	1	1	1	1
T	CONDUIT	1172139	3	3	3	3
U	CONTROL BOX	1171167	1	1	1	1
V	COVER ASY	1171184	1	1	1	1
V1	COVER	1171183	1	1	1	1
V2	BRACKET FILTER	1171241	1	1	1	1
V3	ANGLE FILTER	1171015	1	1	1	1
V4	BRACKET FILTER	1171084	1	1	1	1
V5	PAN DRAIN	1171358	1	1	1	1
W	COVER CONTROL	1176555	1	1	*	*
W	COVER CONTROL	1176564	*	*	1	1
X	COVER TOP	1171489	1	1	1	1
Y	COVER WIRE	1171273	1	1	1	1
Z	CUTOFF BLOWER	1171044	*	*	2	2
Z	CUTOFF BLOWER	1171185	2	2	*	*
PARTS NOT SHOWN						
)	HARNESS ASY	1173509	*	*	1	1
)	HARNESS ASY	1173510	1	1	*	*
)	HARNESS ASY	1173511	*	*	1	1
)	HARNESS ASY	1176366	*	*	1	1
)	HARNESS ASY	1176553	1	1	*	*

PHH150, PHH180

NOTE: This illustration is for reference only. Your unit may differ in appearance or may not include all components shown.

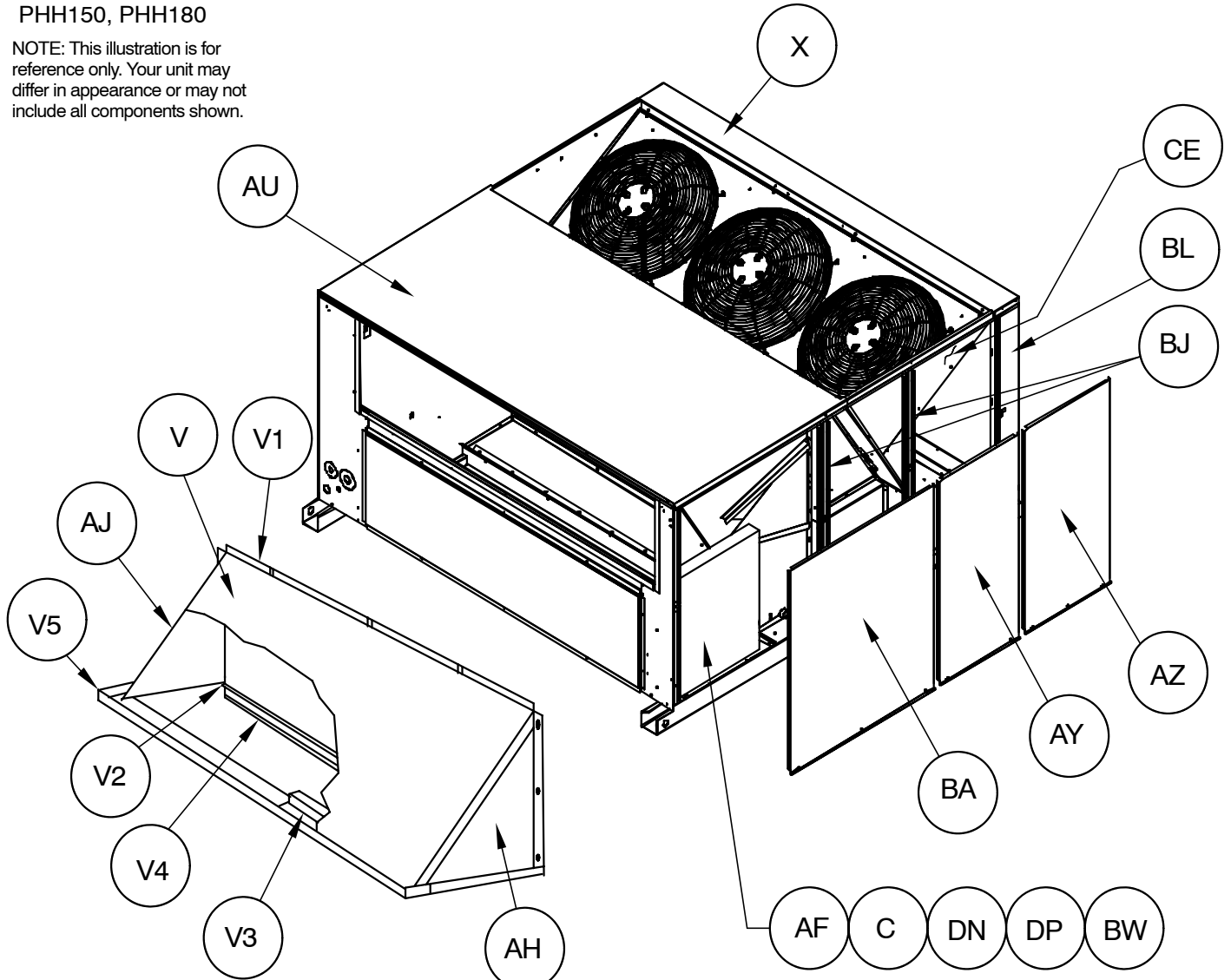

OUTDOOR AIR HOOD

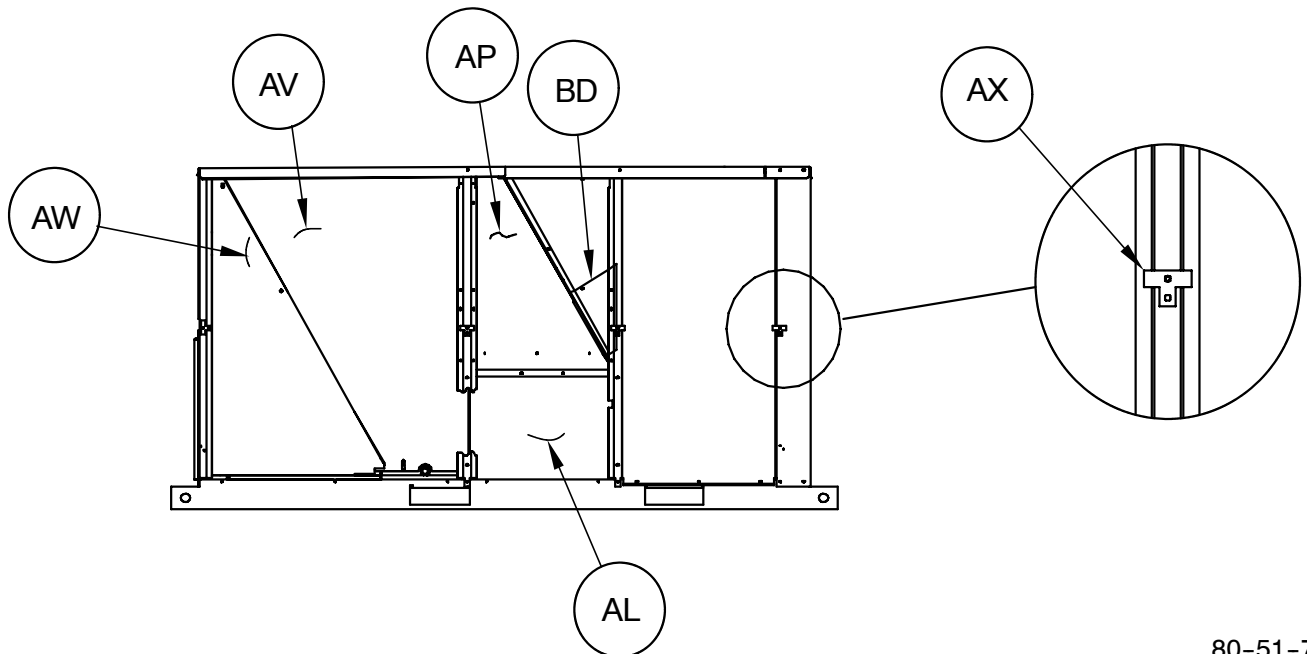

PHH150, PHH180

NOTE: This illustration is for reference only. Your unit may differ in appearance or may not include all components shown.

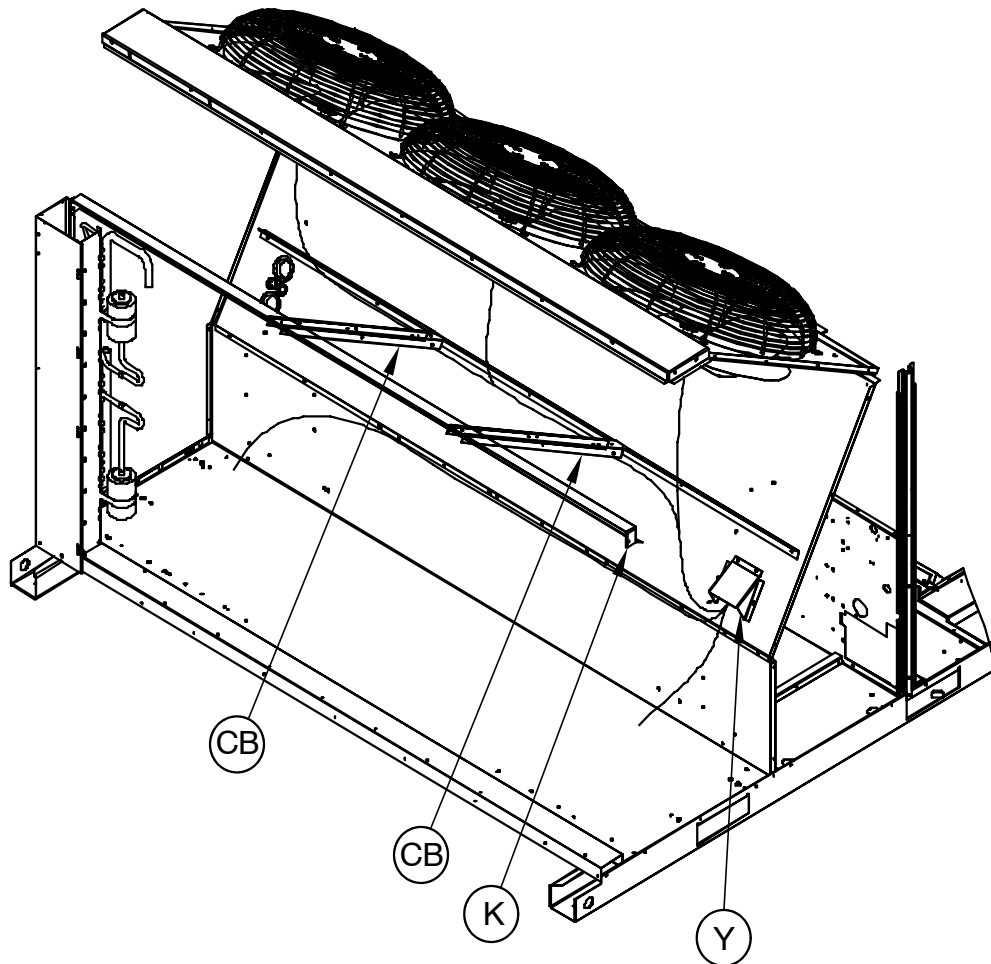
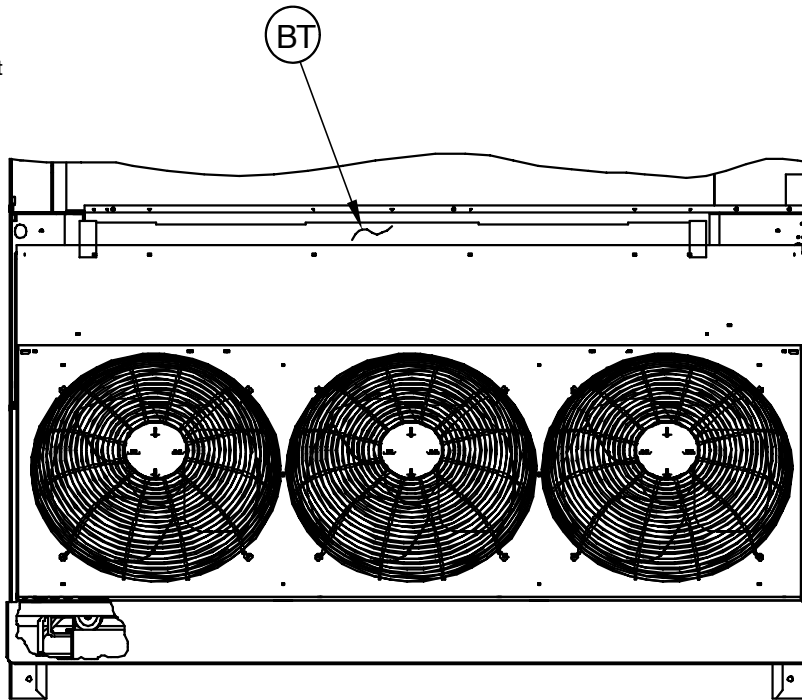

PHH150, PHH180

NOTE: This illustration is for reference only. Your unit may differ in appearance or may not include all components shown.

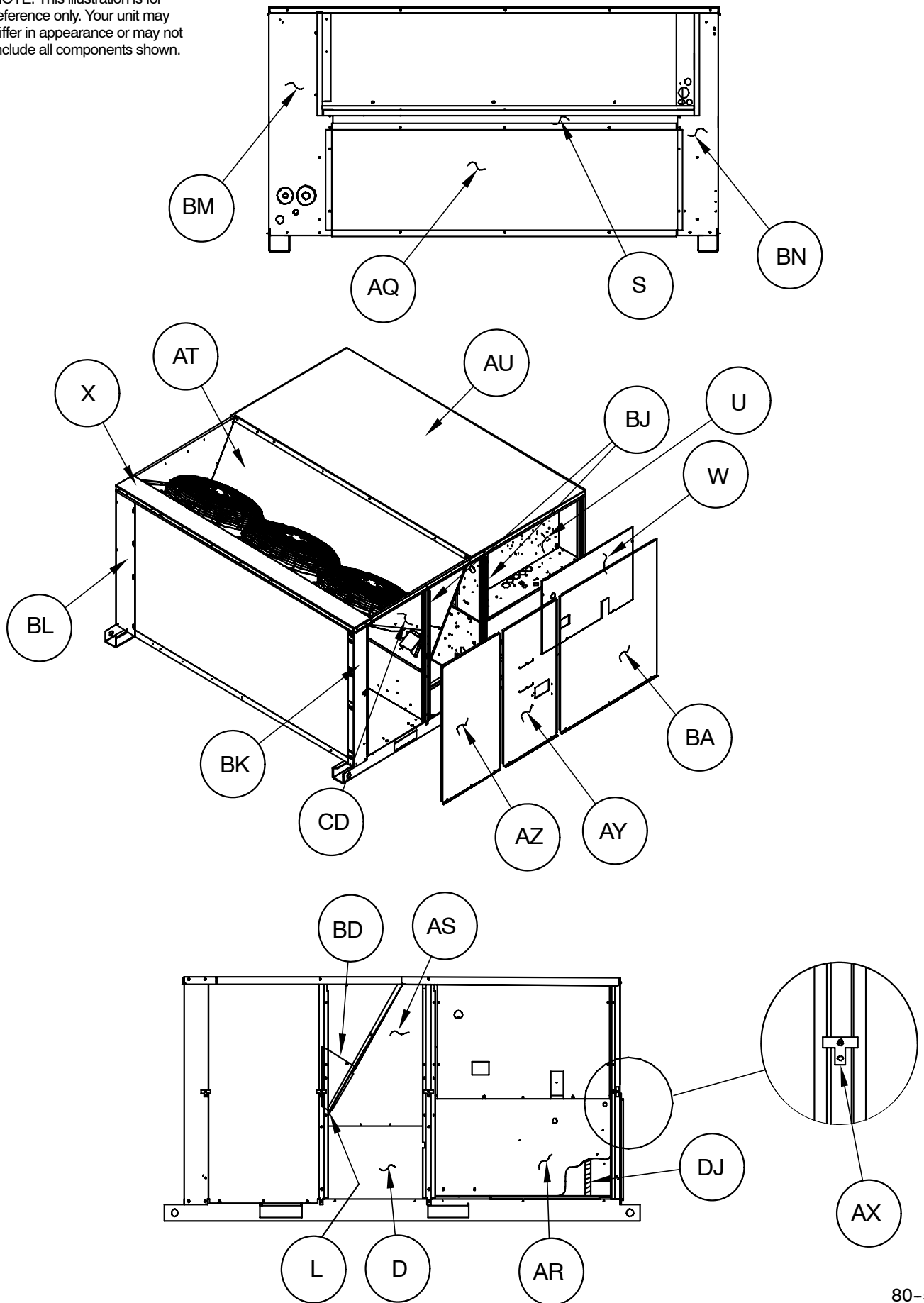

PHH150, PHH180

NOTE: This illustration is for reference only. Your unit may differ in appearance or may not include all components shown.

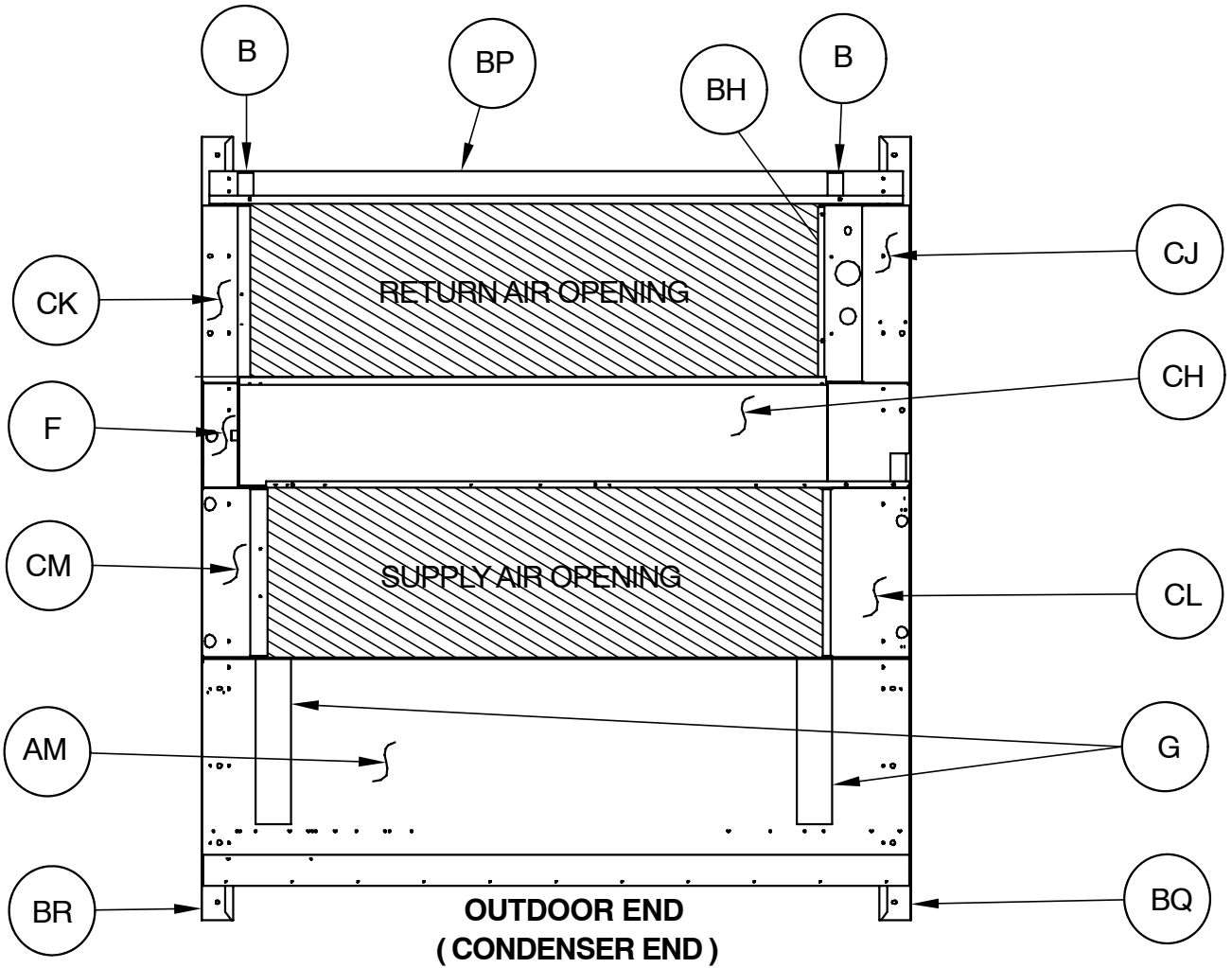
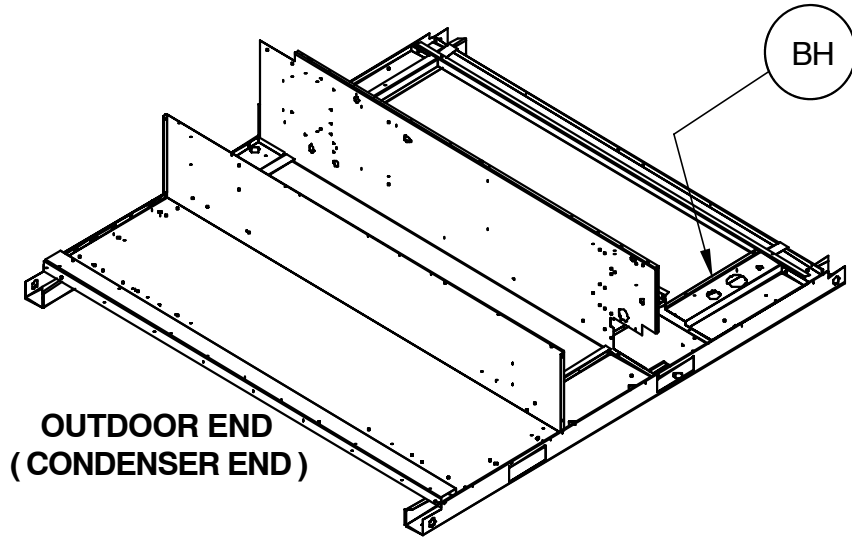

PHH150, PHH180

NOTE: This illustration is for reference only. Your unit may differ in appearance or may not include all components shown.

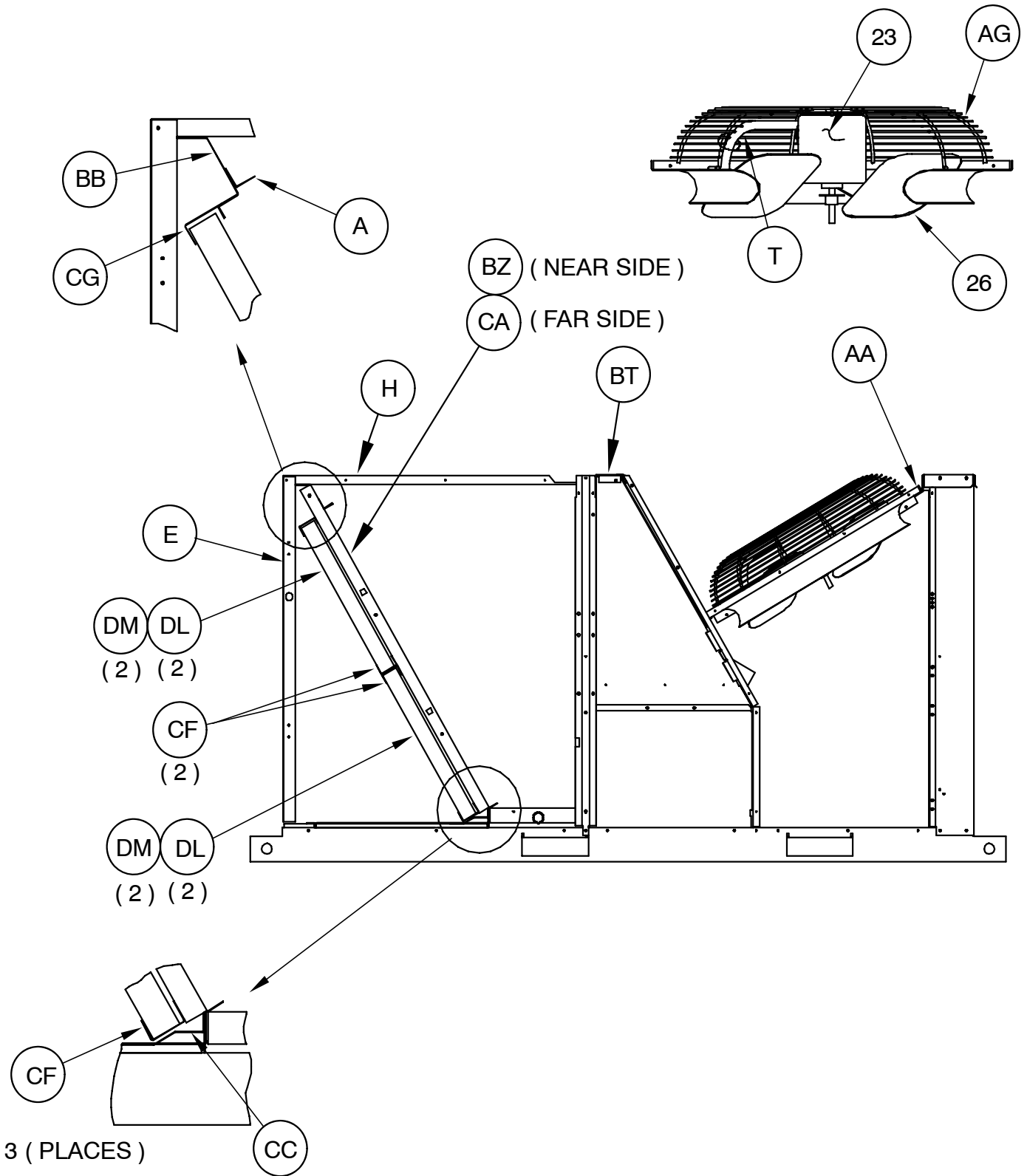

PHH150

NOTE: This illustration is for reference only. Your unit may differ in appearance or may not include all components shown.

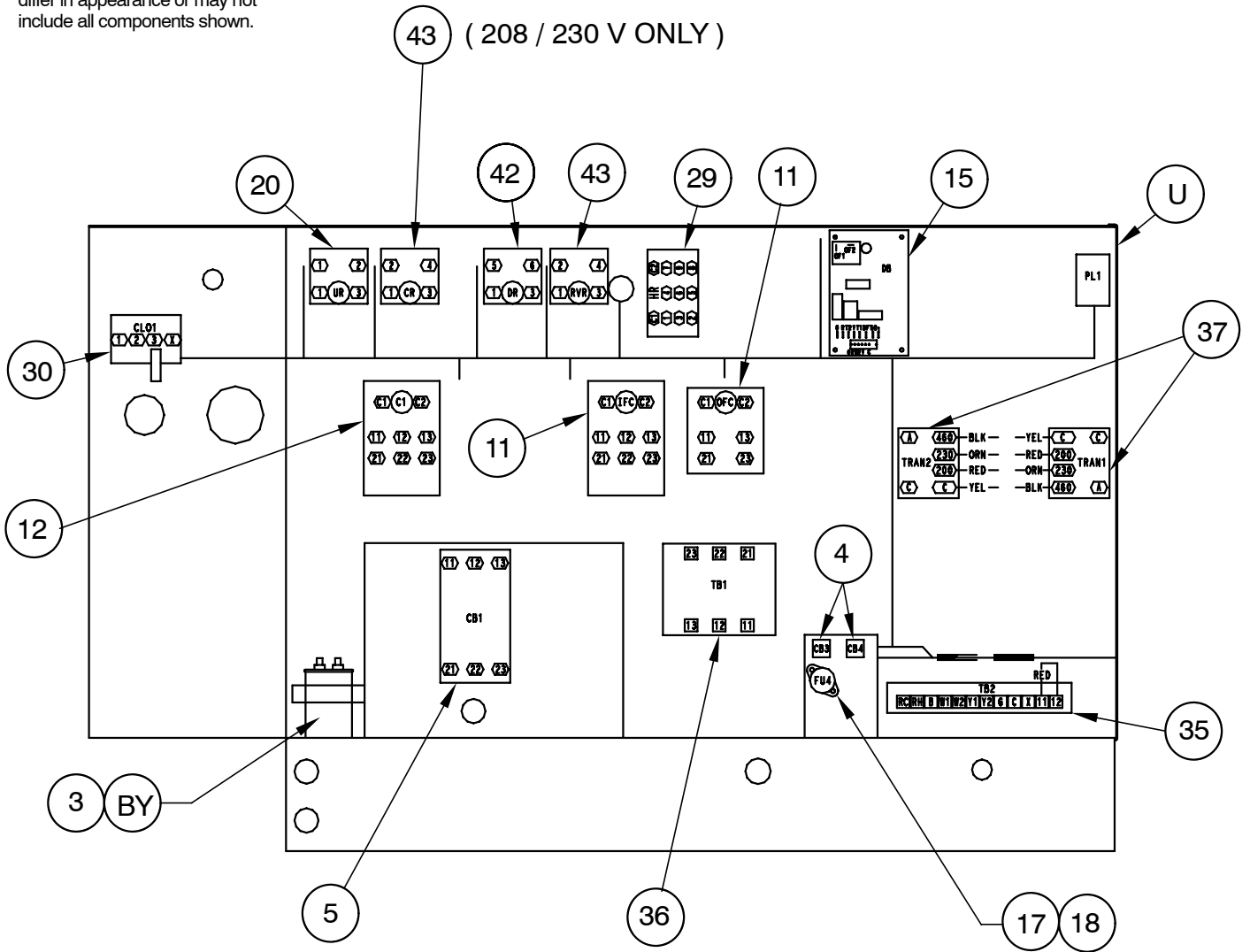

PHH150

NOTE: This illustration is for reference only. Your unit may differ in appearance or may not include all components shown.

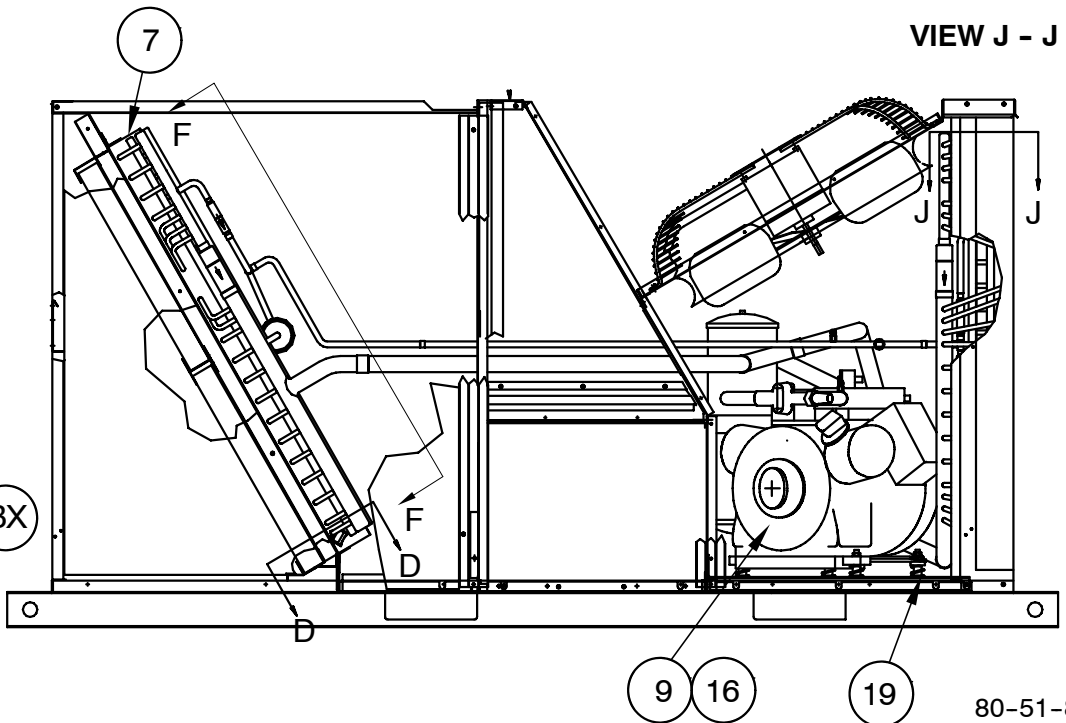
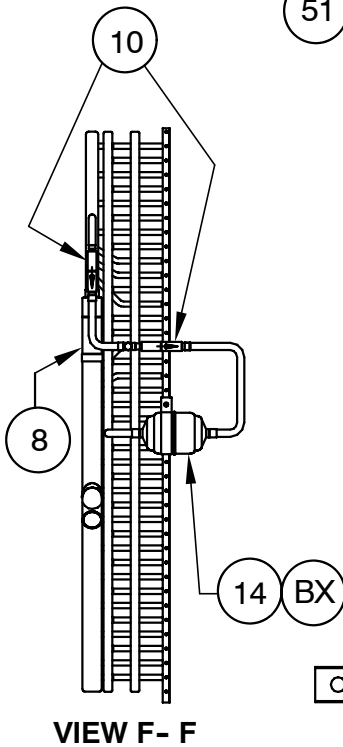
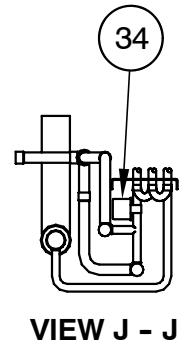
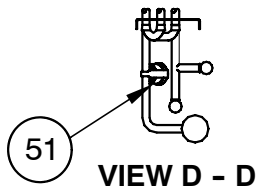
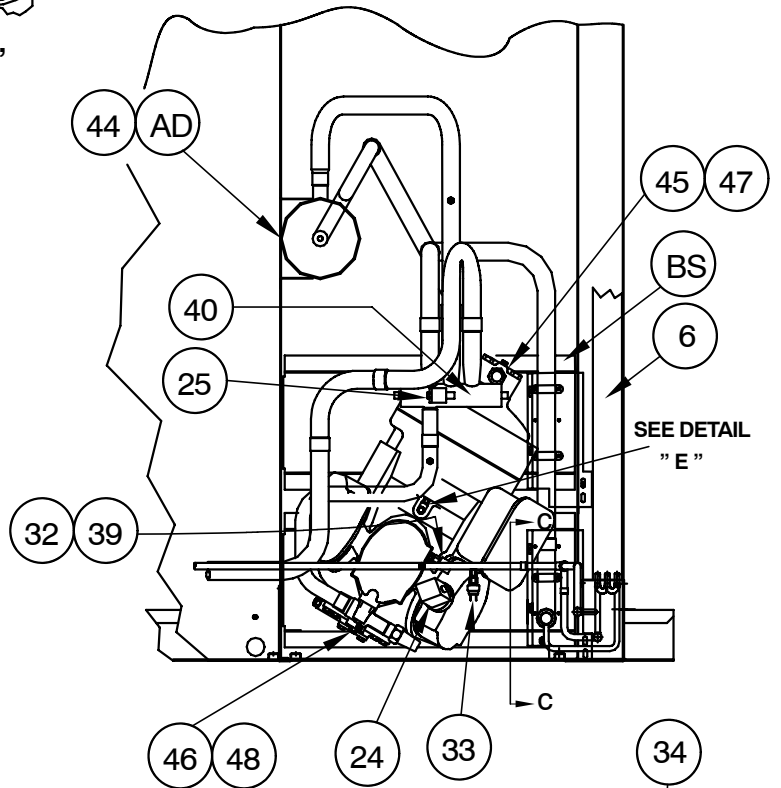
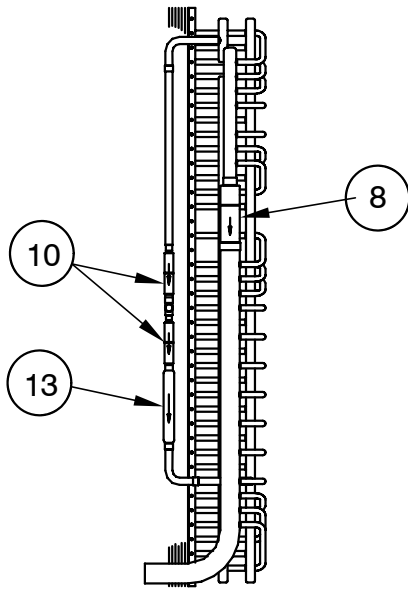
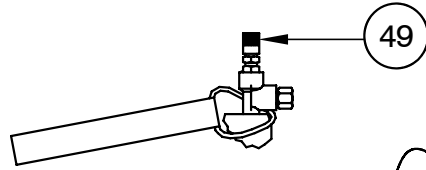

PHH150

NOTE: This illustration is for reference only. Your unit may differ in appearance or may not include all components shown.

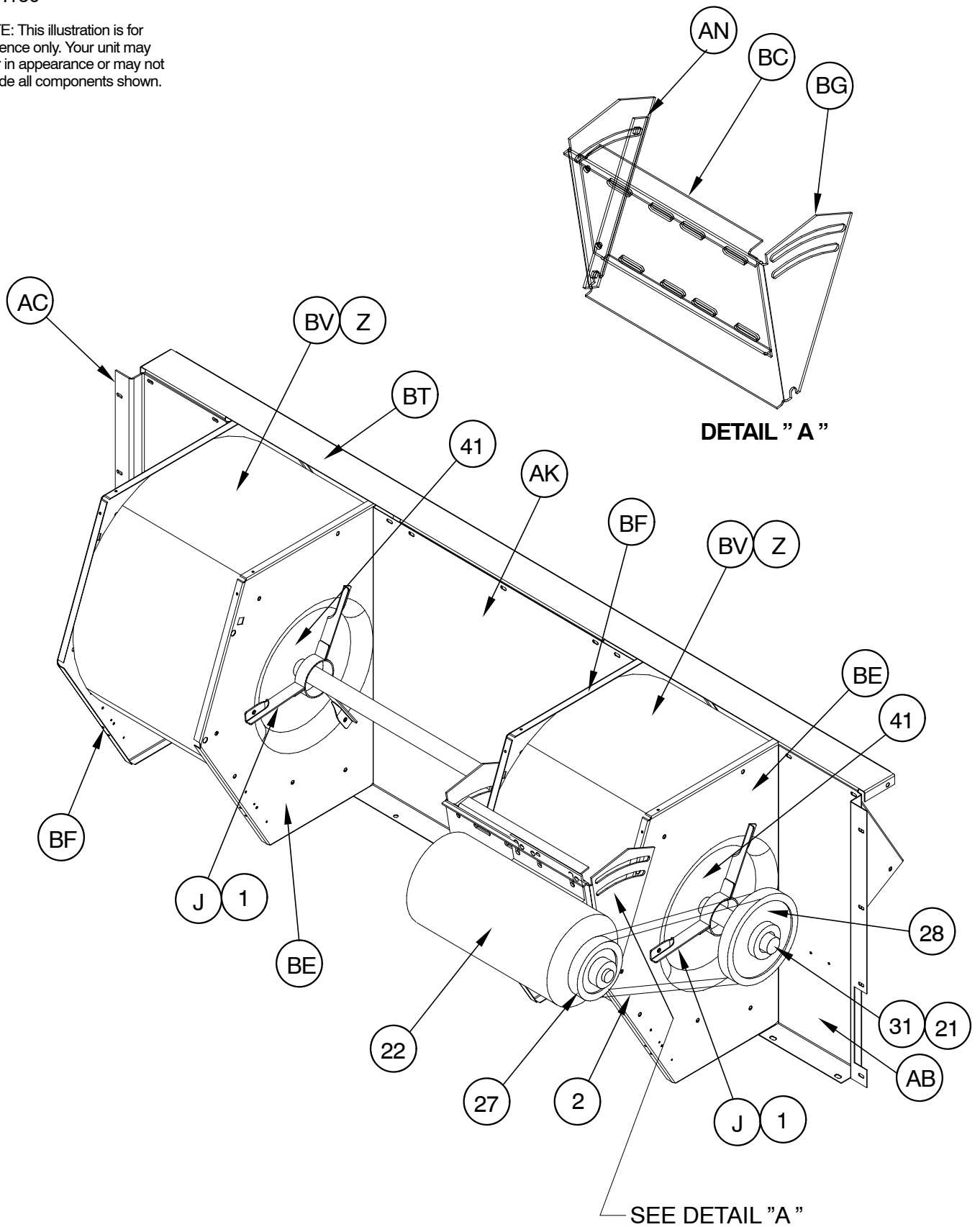

PHH180

NOTE: This illustration is for reference only. Your unit may differ in appearance or may not include all components shown.

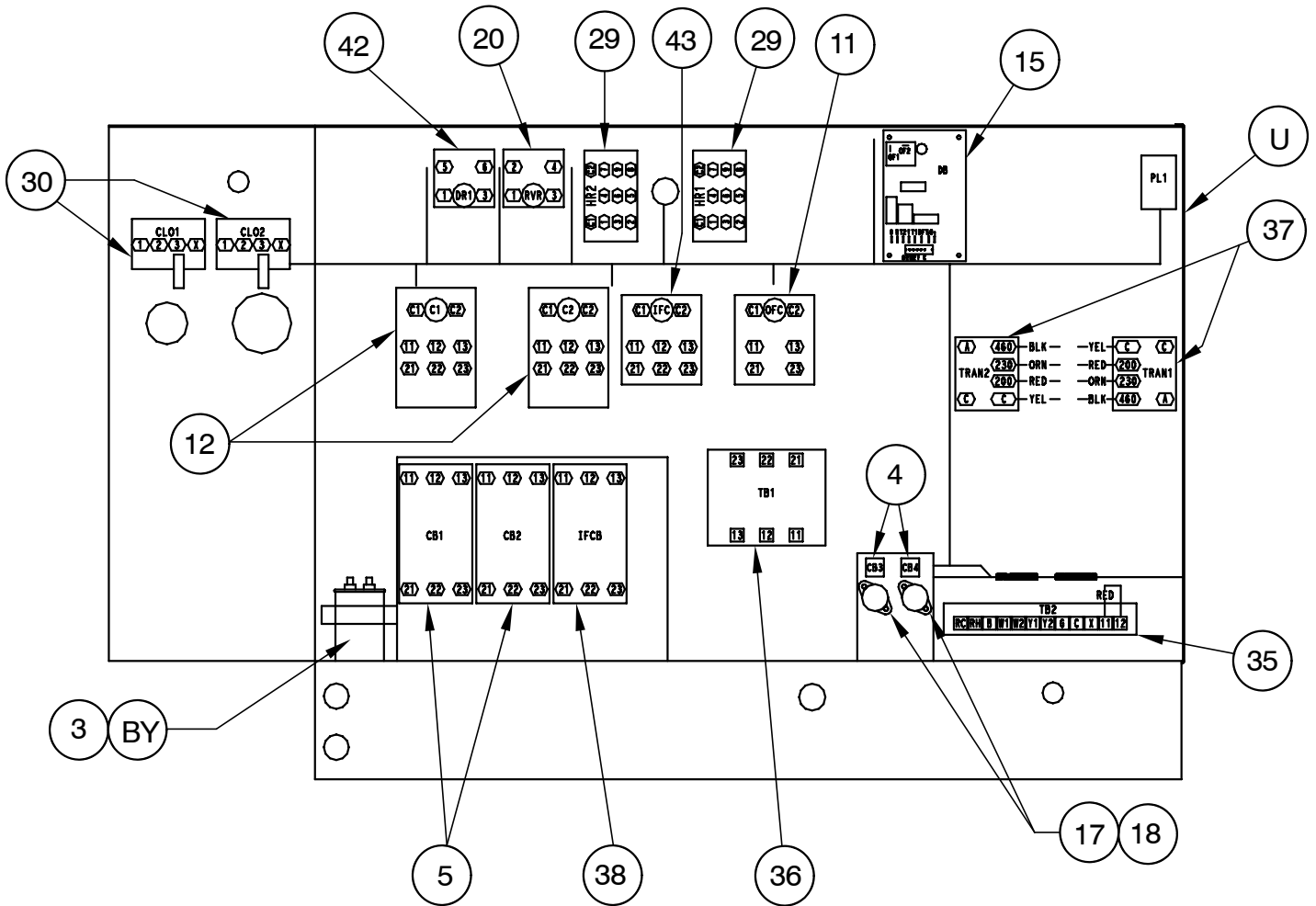

NOTE: This illustration is for reference only. Your unit may differ in appearance or may not include all components shown.

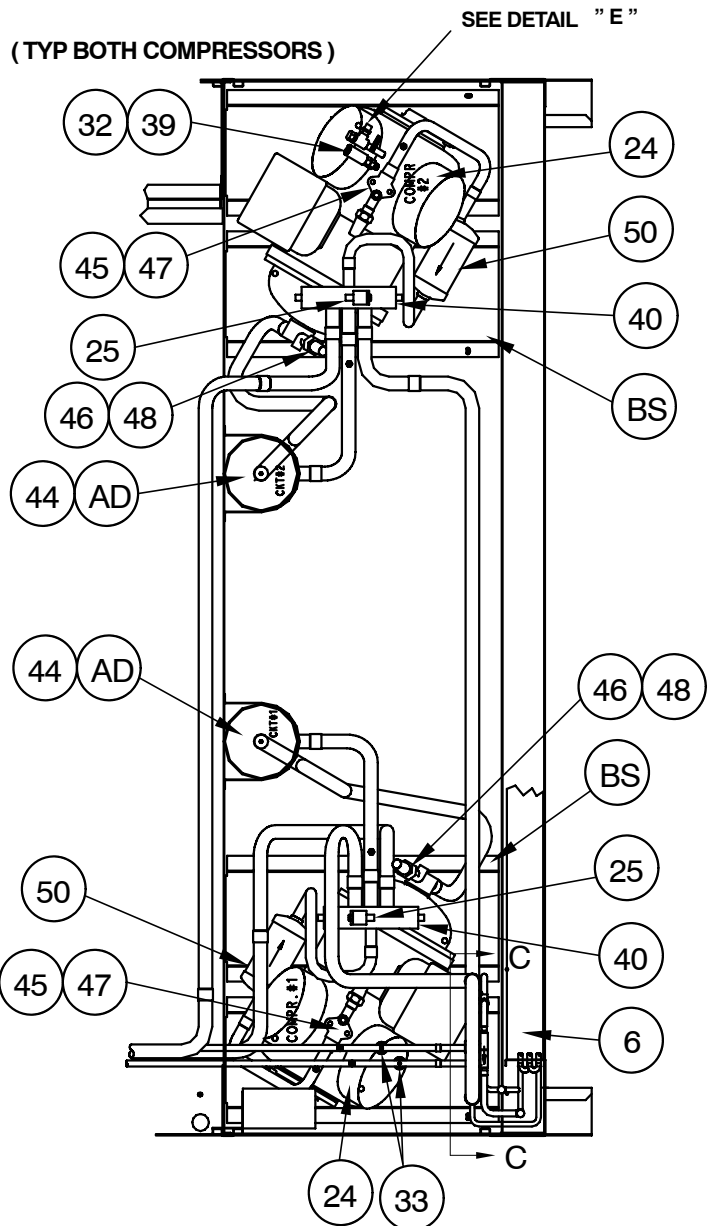
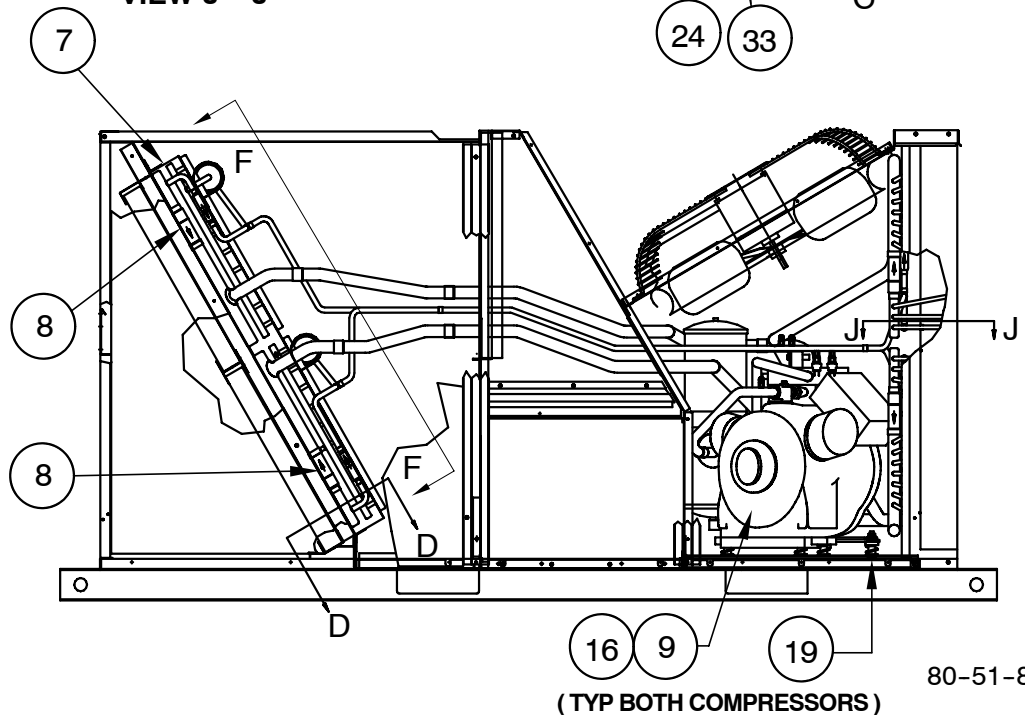
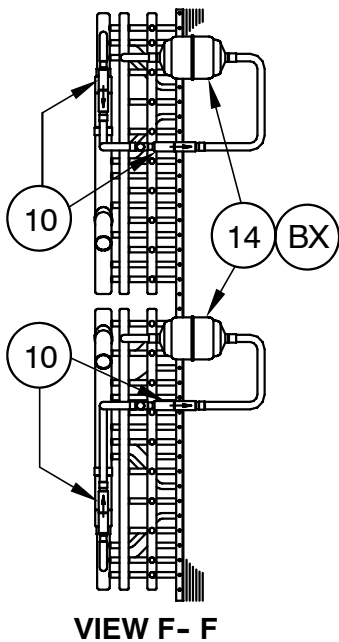
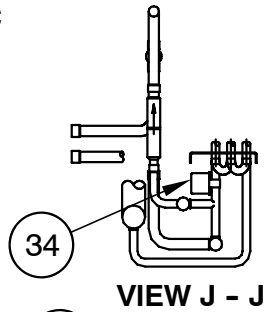
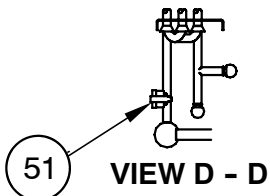
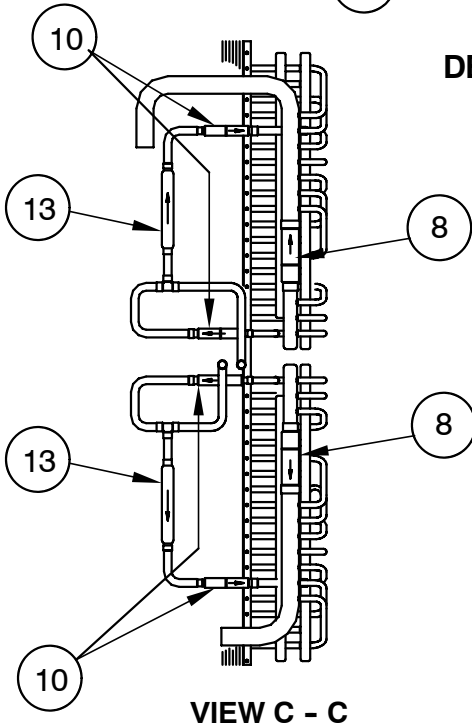
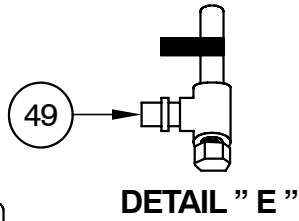

PHH180

NOTE: This illustration is for reference only. Your unit may differ in appearance or may not include all components shown.

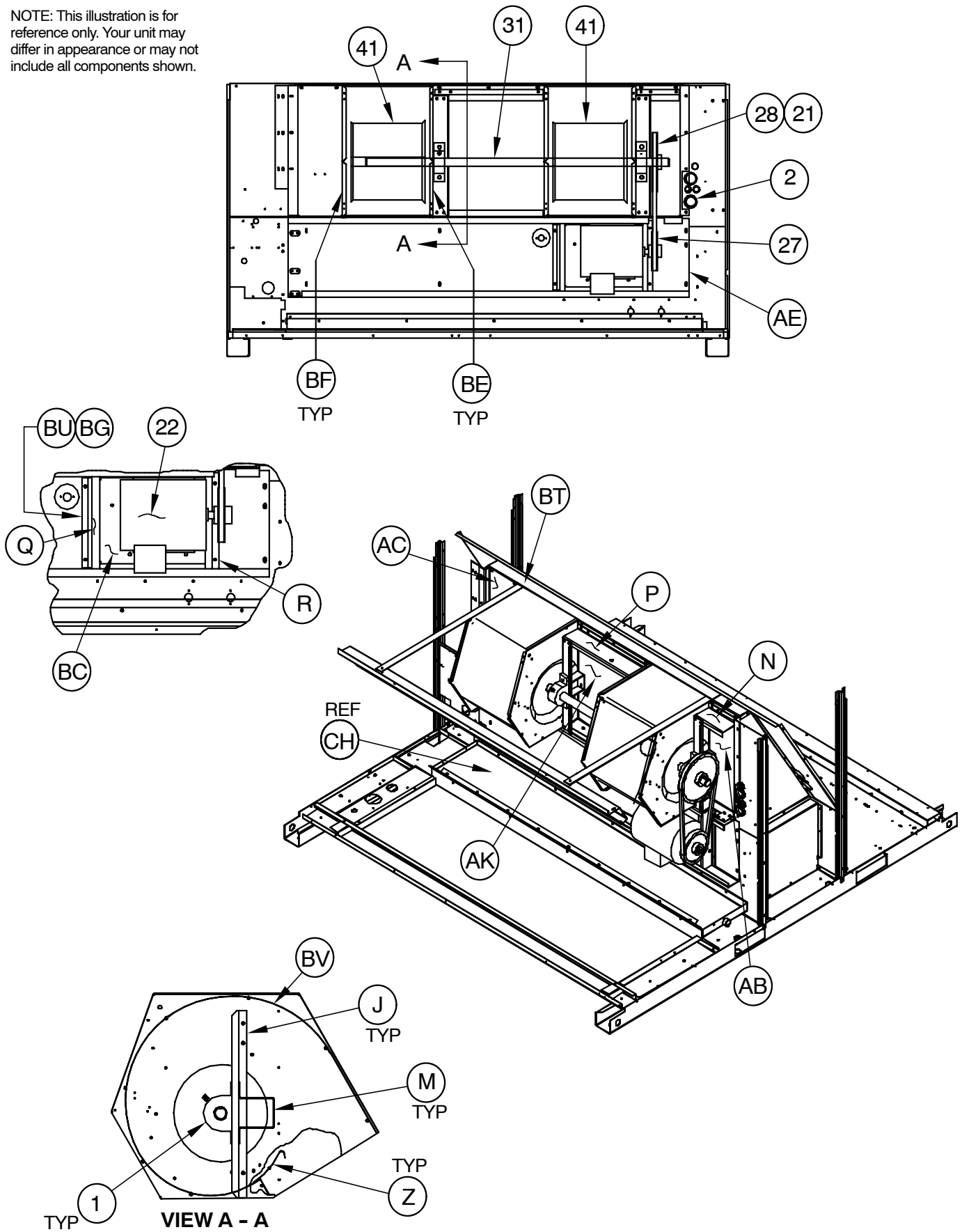

PHH150

12.5 TON CHARGING CHART

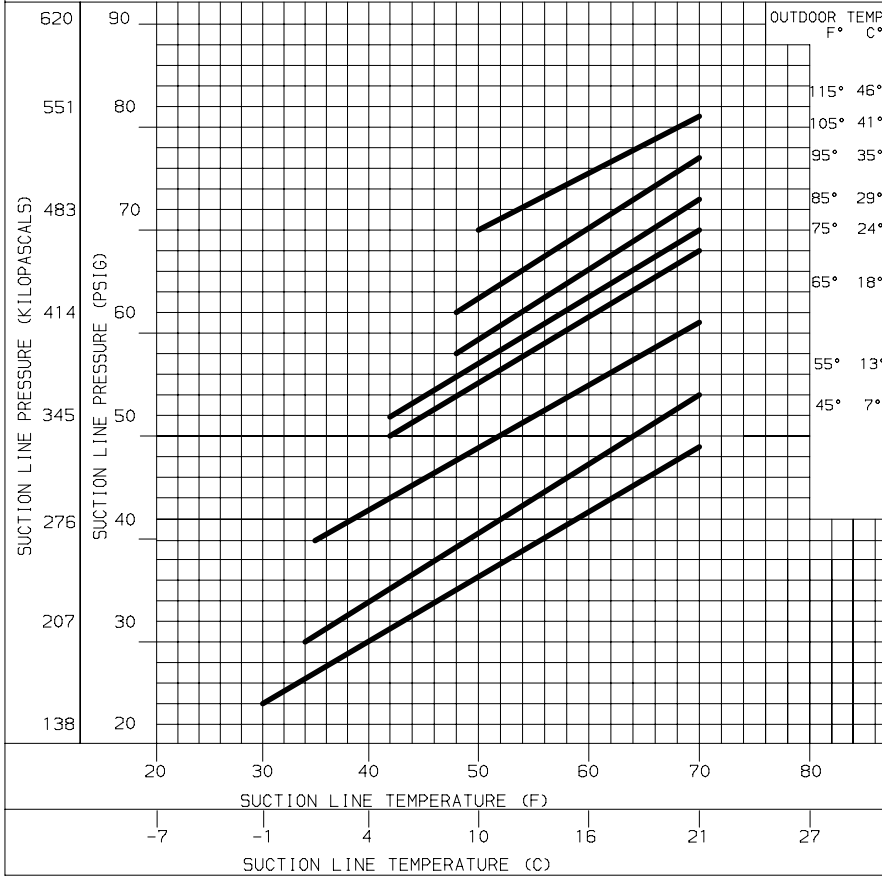

COMPRESSOR OIL
FILL LEVEL

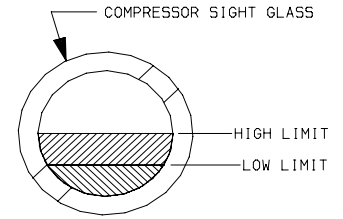

NORMAL COMPRESSOR
SIGHT GLASS OIL LEVEL

NOTE:
THE LEVEL SHOULD BE OBSERVED
IN THE SIGHTGLASS IMMEDIATELY
AFTER COMPRESSOR SHUTDOWN
WHILE OIL IS STILL WARM.
THE LEVEL OBSERVED WHEN
THE SYSTEM IS COLD MAY BE
A MIXTURE OF REFRIGERANT
AND OIL, WHICH WOULD NOT BE
A TRUE INDICATION OF
THE OIL LEVEL.

50HJ502384 -

PHH180

15 TON CHARGING CHART

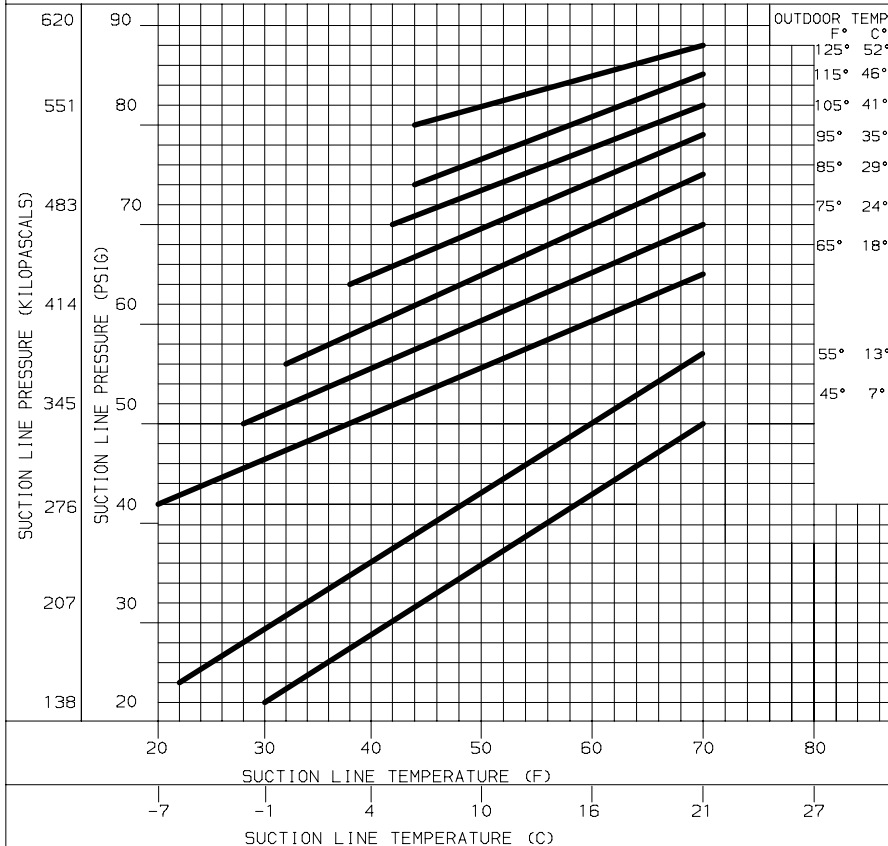

COMPRESSOR OIL
FILL LEVEL

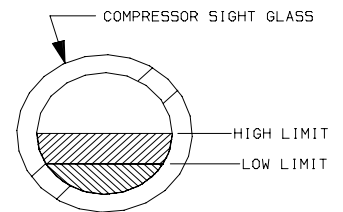

NORMAL COMPRESSOR
SIGHT GLASS OIL LEVEL

NOTE:
THE LEVEL SHOULD BE OBSERVED
IN THE SIGHTGLASS IMMEDIATELY
AFTER COMPRESSOR SHUTDOWN
WHILE OIL IS STILL WARM.
THE LEVEL OBSERVED WHEN
THE SYSTEM IS COLD MAY BE
A MIXTURE OF REFRIGERANT
AND OIL, WHICH WOULD NOT BE
A TRUE INDICATION OF
THE OIL LEVEL.

50HJ502509 -

ELECTRIC HEAT	
208/240V AMPS	208/240V KW
A 39-45	14-18.8
B 72-82	25.7-34.2
C 117-135	42.3-56.1

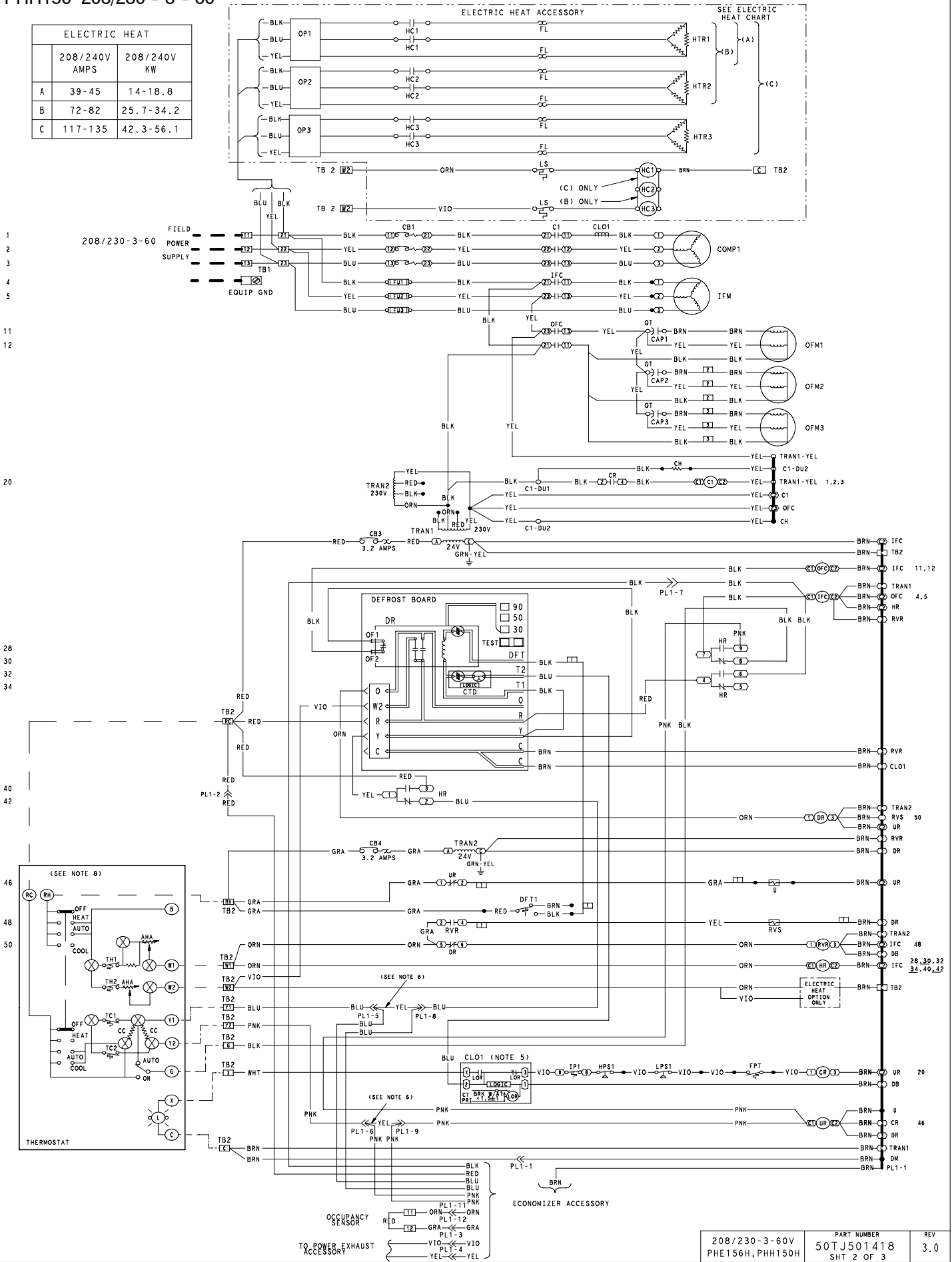

208/230-3-60V PHE156H, PHH150H	PART NUMBER 50TJ501418 SHT 2 OF 3	REV 3.0
-----------------------------------	---	------------

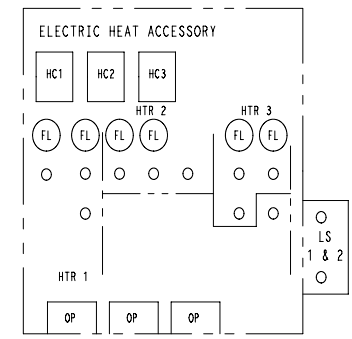
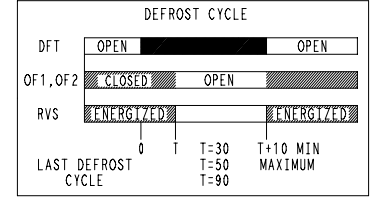
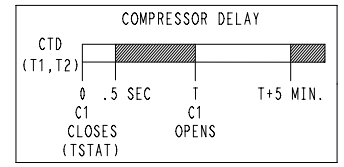
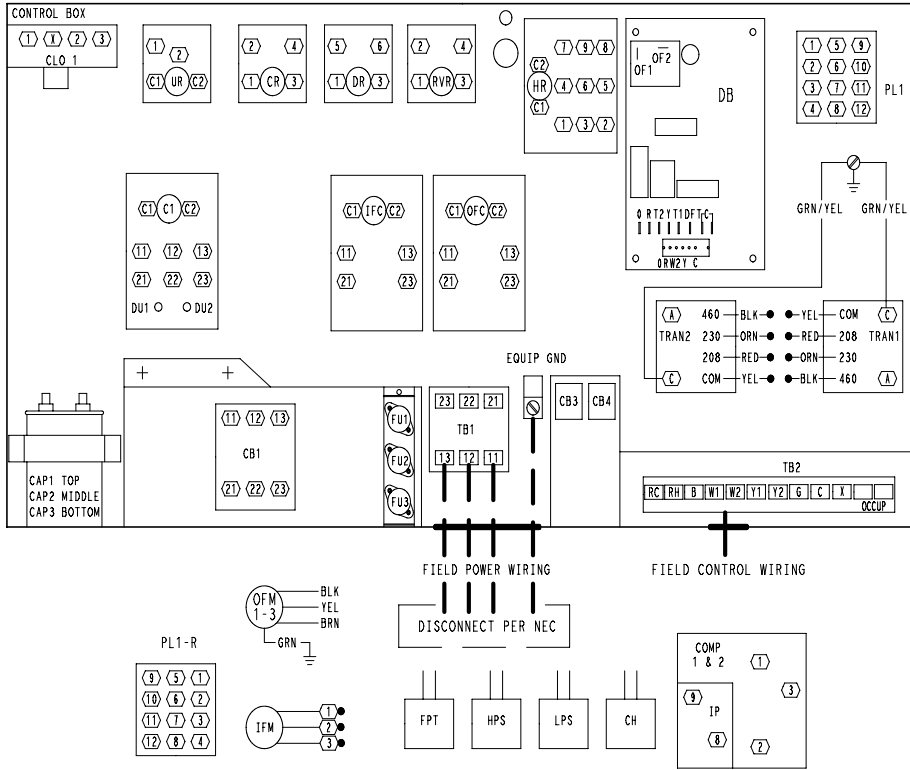

LEGEND

- ◻ TERMINAL (MARKED)
- TERMINAL (UNMARKED)
- ▭ TERMINAL BLOCK
- SPLICE

- FACTORY WIRING
- FIELD WIRING
- OPTION/ACCESSORY WIRING
- TO INDICATE COMMON POTENTIAL ONLY: NOT TO REPRESENT WIRING

NOTES

1. COMPRESSOR AND/OR FAN MOTOR(S) THERMALLY PROTECTED THREE PHASE MOTORS PROTECTED AGAINST PRIMARY SINGLE PHASING CONDITIONS.
2. IF ANY OF THE ORIGINAL WIRE FURNISHED MUST BE REPLACED, IT MUST BE REPLACED WITH TYPE 90°C WIRE OR ITS EQUIVALENT.
3. TRAN1 IS WIRED FOR 230V OPERATION. IF UNIT IS 208V, DISCONNECT THE BLACK WIRES FROM THE ORN TRAN WIRE AND RECONNECT TO THE RED TRAN WIRE, APPLY WIRENUTS TO WIRES.
4. CB1,2 MUST TRIP AMPS ARE EQUAL TO OR LESS THAN 156% FLA, IFCB 140%.
5. THE CLO LOCKS OUT THE COMPRESSOR TO PREVENT SHORT CYCLING ON COMPRESSOR OVERLOAD AND SAFETY DEVICES; BEFORE REPLACING CLO, CHECK THESE DEVICES.
6. JUMPERS ARE OMITTED WHEN UNIT IS EQUIPPED WITH ECONOMIZER.
7. NUMBER(S) INDICATES THE LINE LOCATION OF USED CONTACTS. A BRACKET OVER (2) NUMBERS SIGNIFIES A SINGLE POLE, DOUBLE THROW CONTACT. AN UNDERLINED NUMBER SIGNIFIES A NORMALLY CLOSED CONTACT. PLAIN (NO LINE) NUMBER SIGNIFIES A NORMALLY OPEN CONTACT.
8. REMOVE JUMPER BETWEEN RC & RH.

- | | |
|---|--|
| <p>AHA ADJUSTABLE HEAT ANTICIPATOR</p> <p>BRK W/AT BREAKS WITH AMP TURNS</p> <p>C CONTACTOR, COMPRESSOR</p> <p>CAP CAPACITOR</p> <p>CB CIRCUIT BREAKER</p> <p>CC COOLING COMPENSATOR</p> <p>CH CRANKCASE HEATER</p> <p>CLO COMPRESSOR LOCKOUT</p> <p>CLS COOLING LOCKOUT SWITCH</p> <p>COMP COMPRESSOR MOTOR</p> <p>CTD COMPRESSOR TIME DELAY</p> <p>DAT DISCHARGE AIR THERMISTOR</p> <p>DB DEFROST BOARD</p> <p>DFT DEFROST THERMOSTAT</p> <p>DM DAMPER MOTOR</p> <p>DR DEFROST RELAY</p> <p>DU DUMMY TERMINAL</p> <p>EQUIP EQUIPMENT</p> <p>FL FUSE LINK</p> <p>FPT FREEZE PROTECTION THERMOSTAT</p> <p>FU FUSE</p> <p>GND GROUND</p> <p>HC HEATER CONTACTOR</p> <p>HPS HIGH PRESSURE SWITCH</p> <p>HR HEAT RELAY</p> | <p>HTR HEATER</p> <p>IFC INDOOR FAN CONTACTOR</p> <p>IFCB INDOOR FAN CIRCUIT BREAKER</p> <p>IFM INDOOR FAN MOTOR</p> <p>IFR INDOOR FAN RELAY</p> <p>IP INTERNAL PROTECTOR</p> <p>L LIGHT</p> <p>LPS LOW PRESSURE SWITCH</p> <p>LS LIMIT SWITCH</p> <p>OCCUP OCCUPANCY SENSOR</p> <p>OFC OUTDOOR FAN CONTACTOR</p> <p>OFM OUTDOOR FAN MOTOR</p> <p>OP OVERCURRENT PROTECTOR</p> <p>PL PLUG ASSEMBLY</p> <p>RVR REVERSING VALVE RELAY</p> <p>RVS REVERSING VALVE SOLENOID</p> <p>TB TERMINAL BLOCK</p> <p>TC THERMOSTAT COOLING</p> <p>TH THERMOSTAT HEATING</p> <p>TRAN TRANSFORMER</p> |
|---|--|

208/230-3-60	PART NUMBER	REV
PHE156H, PHH150H	50TJ501418	3.0
	SHT 3 OF 3	

PHH150 460 - 3 - 60

ELECTRIC HEAT		
	480V AMPS	480V KW
A	17.9	14.9
B	39	32.4
C	66	54.9

SCHMATIC

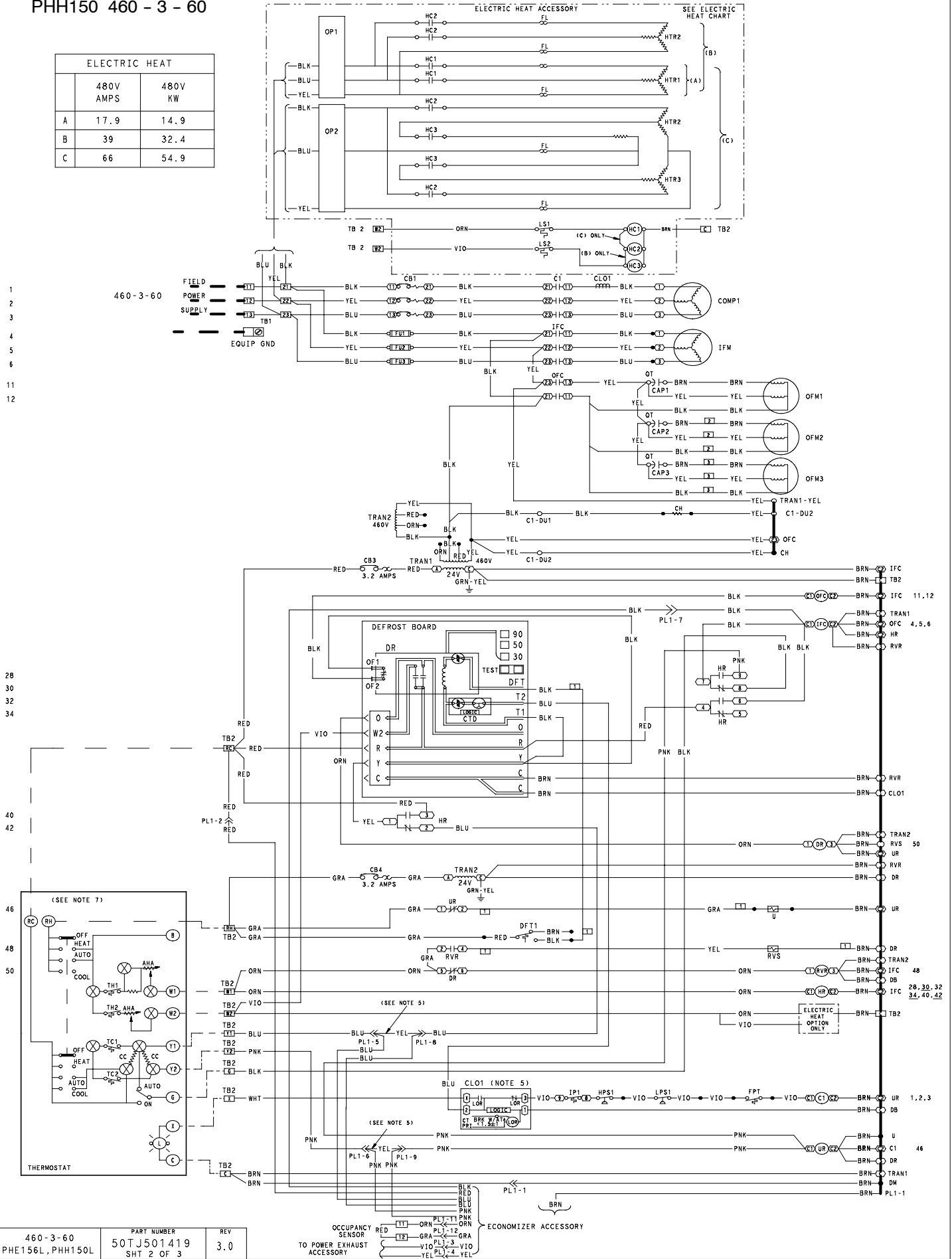

460-3-60 PHE156L, PHH150L	PART NUMBER 50TJ501419 SHT 2 OF 3	REV 3.0
------------------------------	---	------------

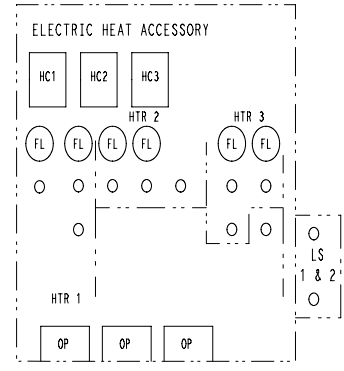
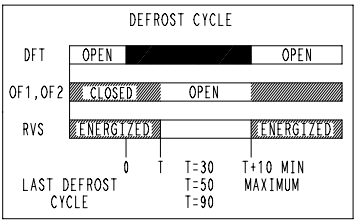
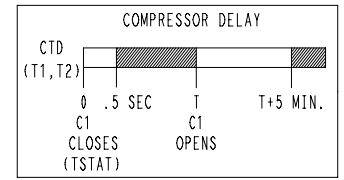
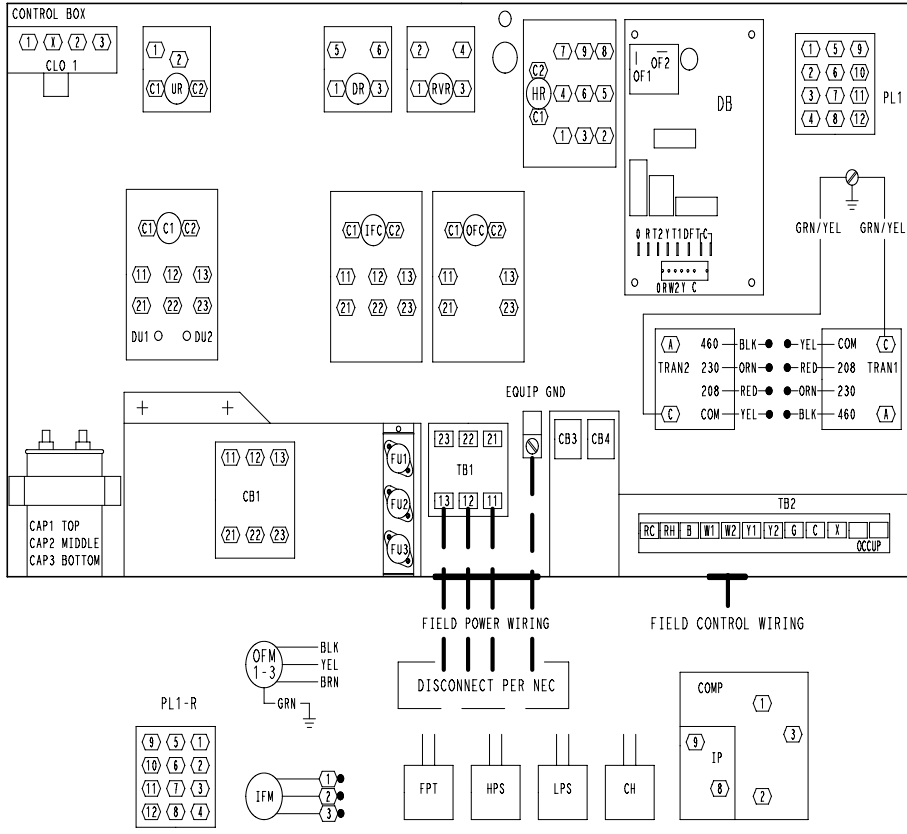

LEGEND

- TERMINAL (MARKED)
- TERMINAL (UNMARKED)
- TERMINAL BLOCK
- SPLICE
- FACTORY WIRING
- FIELD WIRING
- OPTION/ACCESSORY WIRING
- TO INDICATE COMMON POTENTIAL ONLY: NOT TO REPRESENT WIRING

NOTES

1. COMPRESSOR AND/OR FAN MOTOR(S) THERMALLY PROTECTED. THREE PHASE MOTORS PROTECTED AGAINST PRIMARY SINGLE PHASING CONDITIONS.
2. IF ANY OF THE ORIGINAL WIRE FURNISHED MUST BE REPLACED, IT MUST BE REPLACED WITH TYPE 90°C WIRE OR ITS EQUIVALENT.
3. TRAN1 IS WIRED FOR 230V OPERATION. IF UNIT IS 208V, DISCONNECT THE BLACK WIRES FROM THE ORN TRAN WIRE AND RECONNECT TO THE RED TRAN WIRE, APPLY WIRENUTS TO WIRES.
4. CB1, 2 MUST TRIP AMPS ARE EQUAL TO OR LESS THAN 156% FLA, IFCB 140%.
5. THE CLO LOCKS OUT THE COMPRESSOR TO PREVENT SHORT CYCLING ON COMPRESSOR OVERLOAD AND SAFETY DEVICES; BEFORE REPLACING CLO, CHECK THESE DEVICES.
6. JUMPERS ARE OMITTED WHEN UNIT IS EQUIPPED WITH ECONOMIZER.
7. NUMBER(S) INDICATES THE LINE LOCATION OF USED CONTACTS. A BRACKET OVER (2) NUMBERS SIGNIFIES A SINGLE POLE, DOUBLE THROW CONTACT. AN UNDERLINED NUMBER SIGNIFIES A NORMALLY CLOSED CONTACT. PLAIN (NO LINE) NUMBER SIGNIFIES A NORMALLY OPEN CONTACT.
8. REMOVE JUMPER BETWEEN RC & RH.

<p>AHA ADJUSTABLE HEAT ANTICIPATOR</p> <p>BRK W/AT BREAKS WITH AMP TURNS</p> <p>C CONTACTOR, COMPRESSOR</p> <p>CAP CAPACITOR</p> <p>CB CIRCUIT BREAKER</p> <p>CC COOLING COMPENSATOR</p> <p>CH CRANKCASE HEATER</p> <p>CLO COMPRESSOR LOCKOUT</p> <p>CLS COOLING LOCKOUT SWITCH</p> <p>COMP COMPRESSOR MOTOR</p> <p>CTD COMPRESSOR TIME DELAY</p> <p>DAT DISCHARGE AIR THERMISTOR</p> <p>DB DEFROST BOARD</p> <p>DFT DEFROST THERMOSTAT</p> <p>DM DAMPER MOTOR</p> <p>DR DEFROST RELAY</p> <p>DU DUMMY TERMINAL</p> <p>EQUIP EQUIPMENT</p> <p>FL FUSE LINK</p> <p>FPT FREEZE PROTECTION THERMOSTAT</p> <p>FU FUSE</p> <p>GND GROUND</p> <p>HC HEATER CONTACTOR</p> <p>HPS HIGH PRESSURE SWITCH</p> <p>HR HEAT RELAY</p>	<p>HTR HEATER</p> <p>IFC INDOOR FAN CONTACTOR</p> <p>IFCB INDOOR FAN CIRCUIT BREAKER</p> <p>IFM INDOOR FAN MOTOR</p> <p>IFR INDOOR FAN RELAY</p> <p>IP INTERNAL PROTECTOR</p> <p>L LIGHT</p> <p>LPS LOW PRESSURE SWITCH</p> <p>LS LIMIT SWITCH</p> <p>OCCUP OCCUPANCY SENSOR</p> <p>OFC OUTDOOR FAN CONTACTOR</p> <p>OFM OUTDOOR FAN MOTOR</p> <p>OP OVERCURRENT PROTECTOR</p> <p>PL PLUG ASSEMBLY</p> <p>RVR REVERSING VALVE RELAY</p> <p>RVS REVERSING VALVE SOLENOID</p> <p>TB TERMINAL BLOCK</p> <p>TC THERMOSTAT COOLING</p> <p>TH THERMOSTAT HEATING</p> <p>TRAN TRANSFORMER</p>
---	--

460-3-60 PHE156L, PHH150L	PART NUMBER 50TJ501419 SHT 3 OF 3	REV 3.0
------------------------------	---	------------

PHH180 208/230 - 3 - 60

ELECTRIC HEAT		
	208/240V AMPS	208/240V KW
A	72-82	25.7-34.2
B	117-135	42.3-56.1

SCHEMATIC

1
2
3
4
5
6
8
9
11
12

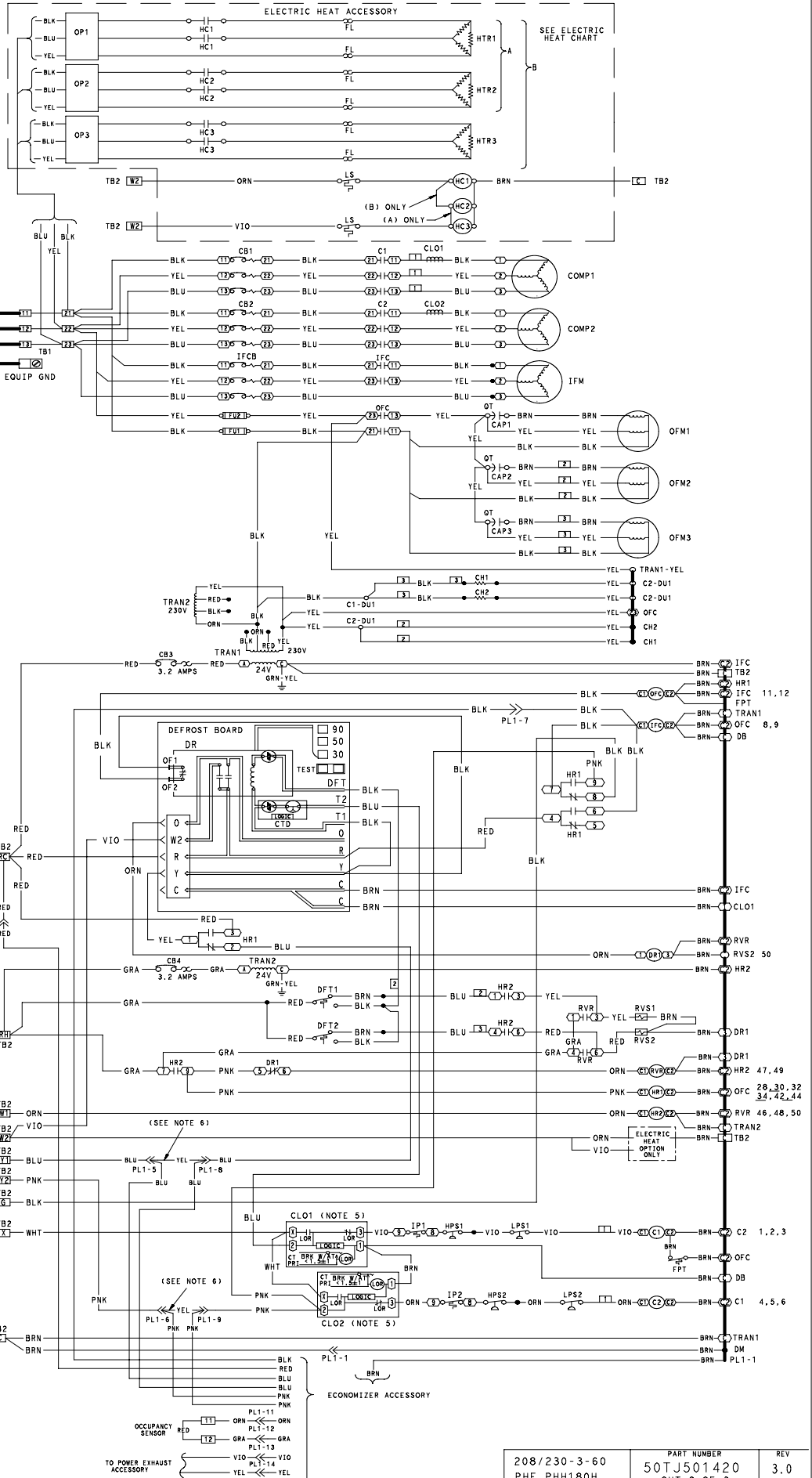
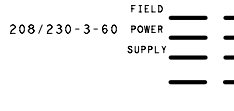

28
30
32
34

42
44

46
47
48
49
50

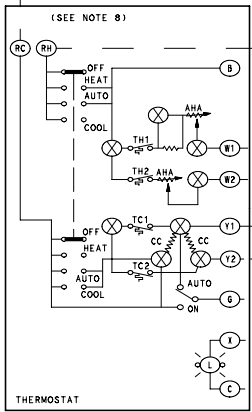

208/230-3-60 PHE, PHH180H	PART NUMBER 50TJ501420 SHT 2 OF 3	REV 3.0
------------------------------	---	------------

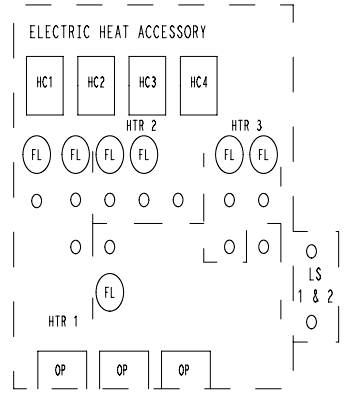
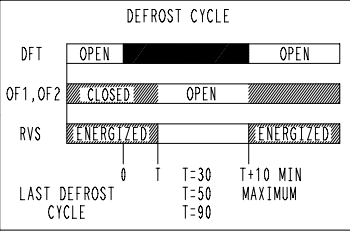
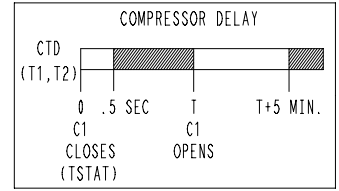
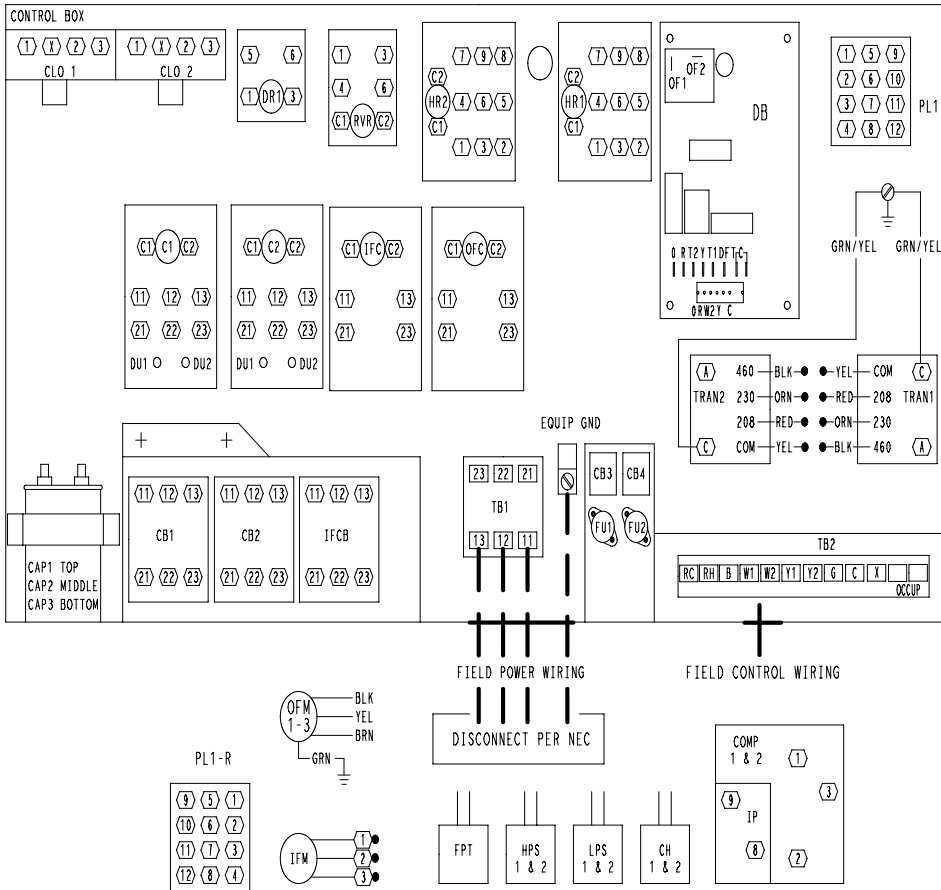

LEGEND

- TERMINAL (MARKED)
- TERMINAL (UNMARKED)
- TERMINAL BLOCK
- SPLICE

- FACTORY WIRING
- - - FIELD WIRING
- · - OPTION/ACCESSORY WIRING
- TO INDICATE COMMON POTENTIAL ONLY:
NOT TO REPRESENT WIRING

NOTES

1. COMPRESSOR AND/OR FAN MOTOR(S) THERMALLY PROTECTED. THREE PHASE MOTORS PROTECTED AGAINST PRIMARY SINGLE PHASING CONDITIONS.
2. IF ANY OF THE ORIGINAL WIRE FURNISHED MUST BE REPLACED, IT MUST BE REPLACED WITH TYPE 90°C WIRE OR ITS EQUIVALENT.
3. TRAN1 IS WIRED FOR 230V OPERATION. IF UNIT IS WIRED FOR 208V, DISCONNECT THE BLACK WIRES FROM THE ORN TRAN WIRE AND RECONNECT TO THE RED TRAN WIRE, APPLY WIRENUTS TO WIRES.
4. CB1, 2 MUST TRIP AMPS ARE EQUAL TO OR LESS THAN 156% FLA, IFCB 140%.
5. THE CLO LOCKS OUT THE COMPRESSOR TO PREVENT SHORT CYCLING ON COMPRESSOR OVERLOAD AND SAFETY DEVICES; BEFORE REPLACING CLO, CHECK THESE DEVICES.
6. JUMPERS ARE OMITTED WHEN UNIT IS EQUIPPED WITH ECONOMIZER.
7. NUMBER(S) INDICATES THE LINE LOCATION OF USED CONTACTS. A BRACKET OVER (2) NUMBERS SIGNIFIES A SINGLE POLE, DOUBLE THROW CONTACT. AN UNDERLINED NUMBER SIGNIFIES A NORMALLY CLOSED CONTACT. PLAIN (NO LINE) NUMBER SIGNIFIES A NORMALLY OPEN CONTACT.
8. REMOVE JUMPER BETWEEN RC & RH.

AHA	ADJUSTABLE HEAT ANTICIPATOR	HTR	HEATER
BRK W/AT	BREAKS WITH AMP TURNS	IFC	INDOOR FAN CONTACTOR
C	CONTACTOR, COMPRESSOR	IFCB	INDOOR FAN CIRCUIT BREAKER
CAP	CAPACITOR	IFM	INDOOR FAN MOTOR
CB	CIRCUIT BREAKER	IFR	INDOOR FAN RELAY
CC	COOLING COMPENSATOR	IP	INTERNAL PROTECTOR
CH	CRANKCASE HEATER	L	LIGHT
CLO	COMPRESSOR LOCKOUT	LPS	LOW PRESSURE SWITCH
CLS	COOLING LOCKOUT SWITCH	LS	LIMIT SWITCH
COMP	COMPRESSOR MOTOR	OCUPP	OCCUPANCY SENSOR
CTD	COMPRESSOR TIME DELAY	OF1	OUTDOOR FAN CONTACTOR
DAT	DISCHARGE AIR THERMISTOR	OF2	OUTDOOR FAN CONTACTOR
DB	DEFROST BOARD	OFM	OUTDOOR FAN MOTOR
DFT	DEFROST THERMOSTAT	OP	OVERCURRENT PROTECTOR
DM	DAMPER MOTOR	PL	PLUG ASSEMBLY
DR	DEFROST RELAY	RVR	REVERSING VALVE RELAY
DU	DUMMY TERMINAL	RVS	REVERSING VALVE SOLENOID
EQUIP	EQUIPMENT	TB	TERMINAL BLOCK
FL	FUSE LINK	TC	THERMOSTAT COOLING
FPT	FREEZE PROTECTION THERMOSTAT	TH	THERMOSTAT HEATING
FU	FUSE	TRAN	TRANSFORMER
GND	GROUND		
HC	HEATER CONTACTOR		
HPS	HIGH PRESSURE SWITCH		
HR	HEAT RELAY		

208/230-3-60 PHE, PHH180H	PART NUMBER	REV
	50TJ501420 SHT 3 OF 3	3.0

PHH180 460 - 3 - 60

ELECTRIC HEAT		
	480V AMPS	480V KW
A	39	32.4
B	66	54.9

SCHMATIC

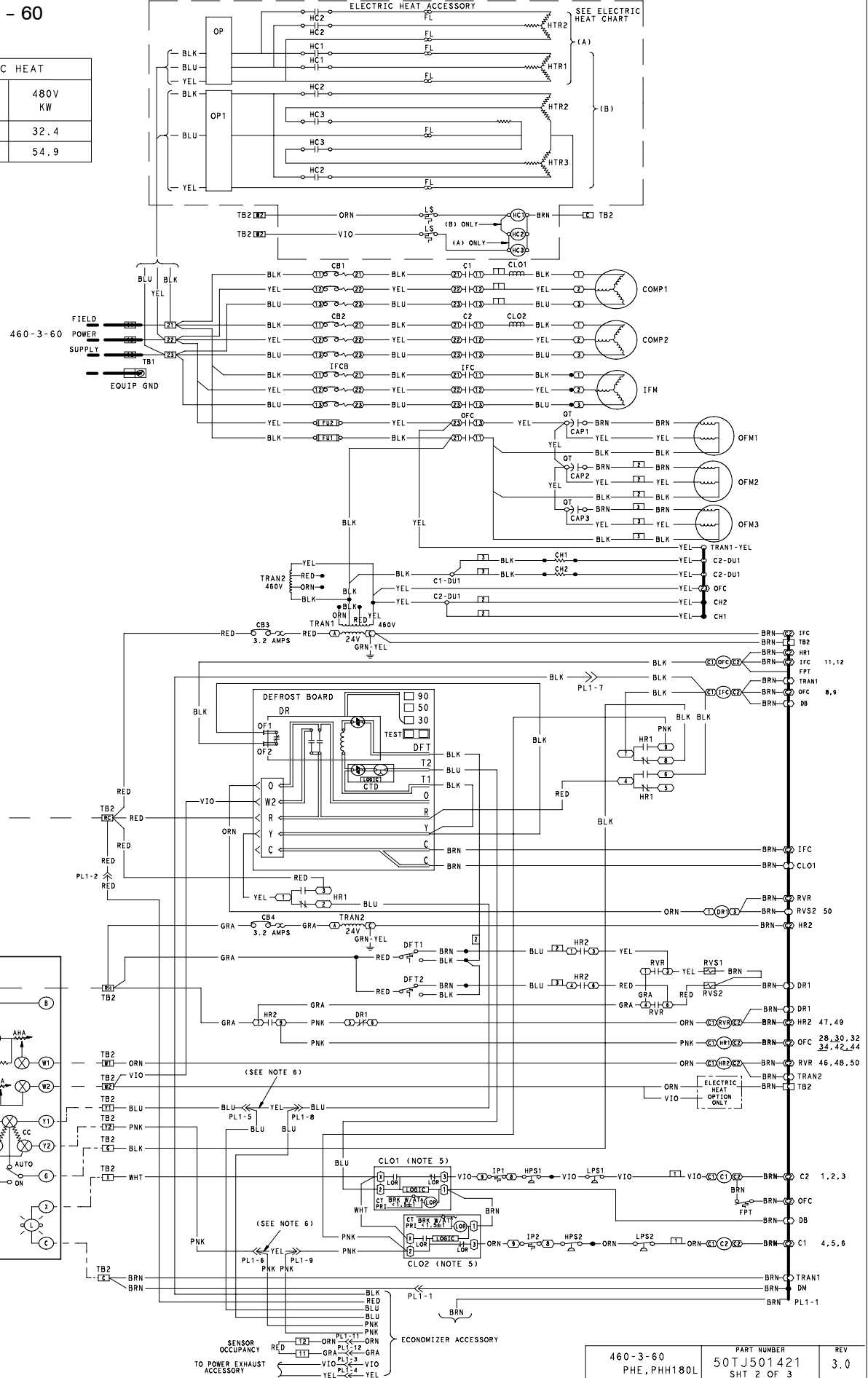

1
2
3
4
5
6
8
9
10
11
12

28
30
32
34

42
44

46
47
48
49
50

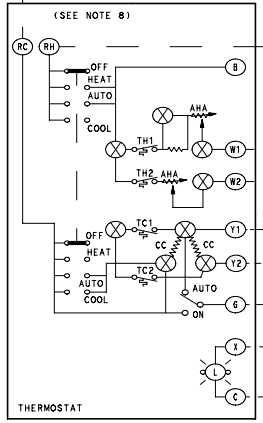

460-3-60 PHE, PHH180L	PART NUMBER 50TJ501421 SHT 2 OF 3	REV 3.0
--------------------------	---	------------

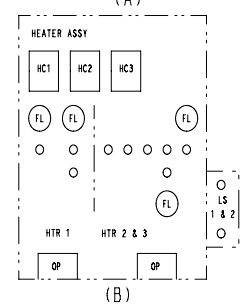
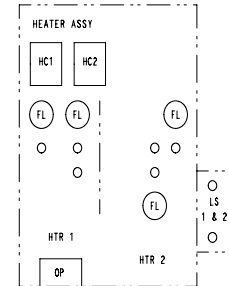
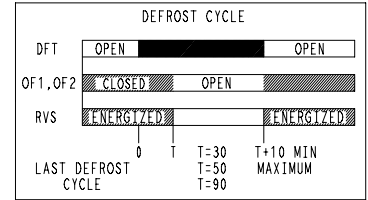
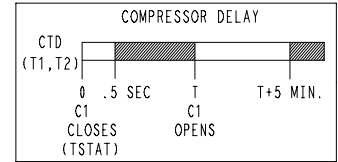
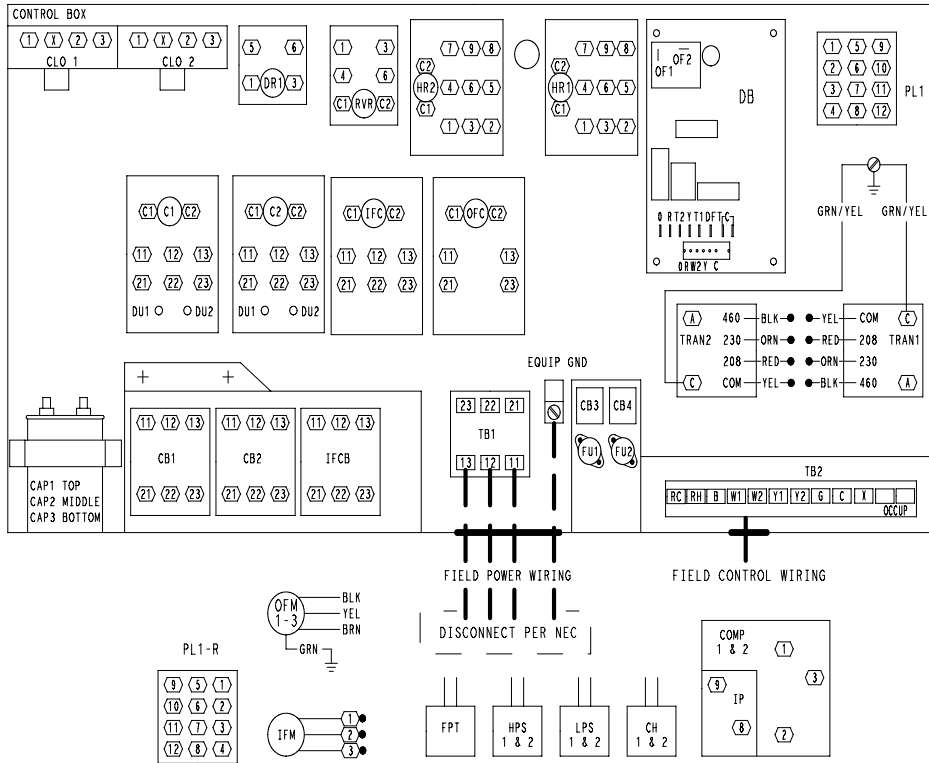

LEGEND

- ◻ TERMINAL (MARKED)
- TERMINAL (UNMARKED)
- TERMINAL BLOCK
- SPLICE

- FACTORY WIRING
- FIELD WIRING
- - - OPTION/ACCESSORY WIRING
- TO INDICATE COMMON POTENTIAL ONLY:
NOT TO REPRESENT WIRING

NOTES

1. COMPRESSOR AND/OR FAN MOTOR(S) THERMALLY PROTECTED THREE PHASE MOTORS PROTECTED AGAINST PRIMARY SINGLE PHASING CONDITIONS.
2. IF ANY OF THE ORIGINAL WIRE FURNISHED MUST BE REPLACED, IT MUST BE REPLACED WITH TYPE 90°C WIRE OR ITS EQUIVALENT.
3. TRAN1 IS WIRED FOR 230V OPERATION. IF UNIT IS 208V, DISCONNECT THE BLACK WIRES FROM THE ORN TRAN WIRE AND RECONNECT TO THE RED TRAN WIRE, APPLY WIRENUTS TO WIRES.
4. CB1,2 MUST TRIP AMPS ARE EQUAL TO OR LESS THAN 156% FLA, IFCB 140%.
5. THE CLO LOCKS OUT THE COMPRESSOR TO PREVENT SHORT CYCLING ON COMPRESSOR OVERLOAD AND SAFETY DEVICES; BEFORE REPLACING CLO, CHECK THESE DEVICES.
6. JUMPERS ARE OMITTED WHEN UNIT IS EQUIPPED WITH ECONOMIZER.
7. NUMBER(S) INDICATES THE LINE LOCATION OF USED CONTACTS. A BRACKET OVER (2) NUMBERS SIGNIFIES A SINGLE POLE, DOUBLE THROW CONTACT. AN UNDERLINED NUMBER SIGNIFIES A NORMALLY CLOSED CONTACT. PLAIN (NO LINE) NUMBER SIGNIFIES A NORMALLY OPEN CONTACT.
8. REMOVE JUMPER BETWEEN RC & RH.

AHA	ADJUSTABLE HEAT ANTICIPATOR	HTR	HEATER
BRK W/AT	BREAKS WITH AMP TURNS	IFC	INDOOR FAN CONTACTOR
C	CONTACTOR, COMPRESSOR	IFCB	INDOOR FAN CIRCUIT BREAKER
CAP	CAPACITOR	IFM	INDOOR FAN MOTOR
CB	CIRCUIT BREAKER	IFR	INDOOR FAN RELAY
CC	COOLING COMPENSATOR	IP	INTERNAL PROTECTOR
CH	CRANKCASE HEATER	L	LIGHT
CLO	COMPRESSOR LOCKOUT	LPS	LOW PRESSURE SWITCH
CLS	COOLING LOCKOUT SWITCH	LS	LIMIT SWITCH
COMP	COMPRESSOR MOTOR	OCCUP	OCCUPANCY SENSOR
CTD	COMPRESSOR TIME DELAY	OFC	OUTDOOR FAN CONTACTOR
DAT	DISCHARGE AIR THERMISTOR	OFM	OUTDOOR FAN MOTOR
DB	DEFROST BOARD	OP	OVERCURRENT PROTECTOR
DFT	DEFROST THERMOSTAT	PL	PLUG ASSEMBLY
DM	DAMPER MOTOR	RVR	REVERSING VALVE RELAY
DR	DEFROST RELAY	RVS	REVERSING VALVE SOLENOID
DU	DUMMY TERMINAL	TB	TERMINAL BLOCK
EQUIP	EQUIPMENT	TC	THERMOSTAT COOLING
FL	FUSE LINK	TH	THERMOSTAT HEATING
FPT	FREEZE PROTECTION THERMOSTAT	TRAN	TRANSFORMER
FU	FUSE		
GND	GROUND		
HC	HEATER CONTACTOR		
HPS	HIGH PRESSURE SWITCH		
HR	HEAT RELAY		

460-3-60	PART NUMBER	REV
PHE, PHH180L	50TJ501421	3.0
	SHT 3 OF 3	