

# Parts List, Tech Labels, Wiring Diagrams

**PHF3 SERIES**

## **PACKAGE AIR CONDITIONER UNITS**



### TABLE OF CONTENTS

|                     |       |
|---------------------|-------|
| PARTS LIST .....    | 2 - 3 |
| PARTS DRAWING ..... | 4     |
| TECH LABELS         |       |
| PHF324 - 30 .....   | 5     |
| PHF336 - 42 .....   | 6     |
| PHF348 - 54 .....   | 7     |
| WIRING DIAGRAMS     |       |
| PHF324 - 42 .....   | 8     |
| PHF348 .....        | 9     |



| KEY NO. | DESCRIPTION  | FAST NUMBER   | PHF32400K00A1 | PHF33000K00A1 | PHF33600K00A1 | PHF34200K00A1 | PHF34800K00A1 |
|---------|--|---------------|---------------|---------------|---------------|---------------|---------------|
| 1       | COMPRESSOR (R-22, 22,000 BTU, 208/230V-1 PH)   | ZR22K4PFV830  | 1             | *             | *             | *             | *             |
|         | COMPRESSOR (R-22, 28,000 BTU, 208/230V-1 PH)   | ZR28K3PFV830  | *             | 1             | *             | *             | *             |
|         | COMPRESSOR (R-22, 34,000 BTU, 208/230V-1 PH)   | ZR34K3PFV830  | *             | *             | 1             | *             | *             |
|         | COMPRESSOR (R-22, 36,000 BTU, 208/230V-1 PH)   | ZR36K3PFV830  | *             | *             | *             | 1             | *             |
|         | COMPRESSOR (R-22, 43,000 BTU, 2 STAGE, 208/230V-1 PH)  | ZRS43K4PFV830 | *             | *             | *             | *             | 1             |
| 2       | MOTOR, CONDENSER FAN (1/8 HP, 208/230V-1 PH)   | 1173699       | 1             | 1             | *             | *             | *             |
|         | MOTOR, CONDENSER FAN (1/8 HP, 208/230V-1 PH)   | 1173700       | *             | *             | 1             | 1             | 1             |
| 3       | FAN, CONDENSER (20" DIA.)  | 1173706       | 1             | 1             | 1             | 1             | 1             |
| 4       | COIL, EVAPORATOR -MANIFOLDS INCLUDED-  | 1174221       | 1             | *             | *             | *             | *             |
|         |  | 1174222       | *             | 1             | *             | *             | *             |
|         |  | 1174223       | *             | *             | 1             | *             | *             |
|         |  | 1174224       | *             | *             | *             | 1             | *             |
|         |  | 1174225       | *             | *             | *             | *             | 1             |
| 5       | FLOW RESTRICTER, EVAPORATOR (.063")  | 1174003       | 1             | *             | *             | *             | *             |
|         | FLOW RESTRICTER, EVAPORATOR (.073")  | 1174017       | *             | 1             | *             | *             | *             |
|         | FLOW RESTRICTER, EVAPORATOR (.082")  | 1173870       | *             | *             | 1             | *             | *             |
| 6       | TAILPIECE KIT, EVAPORATOR<br>(INCLUDES: BRASS HEX NUT, TEFLON WASHER, PISTON<br>RETAINER WITH 3/8 TAILPIECE AND STAINER) | 1174325       | 1             | 1             | 1             | *             | *             |
| 7       | DISTRIBUTOR, EVAPORATOR (R-22)   | 1174240       | 1             | *             | *             | *             | *             |
|         |  | 1174241       | *             | 1             | *             | *             | *             |
|         |  | 1174242       | *             | *             | 1             | *             | *             |
|         |  | 1174243       | *             | *             | *             | 1             | 1             |
| 8       | PAN, DRAIN (EVAPORATOR)  | 1172243       | 1             | 1             | 1             | 1             | 1             |
| 9       | KIT, BLOWER MOTOR MOUNTING   | 1174295       | 1             | 1             | 1             | 1             | 1             |
| 10      | WHEEL, BLOWER (10-8DD)   | 1173813       | 1             | 1             | *             | *             | *             |
|         | WHEEL, BLOWER (11-9DD)   | 1171742       | *             | *             | 1             | 1             | *             |
|         | WHEEL, BLOWER (11-10DD)  | 1173815       | *             | *             | *             | *             | 1             |
| 11      | MOTOR, BLOWER (208-230 VAC, 4.1A, 1 PHASE, 1/2 HP)   | 1173816       | 1             | 1             | *             | *             | *             |
|         | MOTOR, BLOWER (208-230 VAC, 6A, 1 PHASE, 3/4 HP)   | 1173817       | *             | *             | 1             | 1             | *             |
|         | MOTOR, BLOWER (208-230 VAC, 7.6A, 1 PHASE, 1 HP)   | 1173819       | *             | *             | *             | *             | 1             |
| 12      | CAPACITOR (35 + 5 MFD, 370V)   | 1172110       | 1             | *             | *             | *             | *             |
|         | CAPACITOR (45 + 5 MFD, 370V)   | 1172124       | *             | 1             | *             | *             | 1             |
|         | CAPACITOR (50 + 5 MFD, 370V)   | 1172111       | *             | *             | 1             | 1             | *             |
| 13      | CONTACTOR (SPST, NO, 25A, 24VAC )  | 1173689       | 1             | 1             | 1             | *             | *             |
|         | CONTACTOR (SPST, NO, 40A, 24VAC )  | 1173690       | *             | *             | *             | 1             | 1             |
| 14      | CIRCUIT BREAKER (250VAC, 3.2 A)  | 1171114       | 1             | 1             | 1             | 1             | 1             |
| 15      | TRANSFORMER (230/460V-24V 75VA)  | 1171496       | 1             | 1             | 1             | 1             | 1             |
| 16      | CONTROL BOARD (MOTOR)  | 1173692       | 1             | 1             | 1             | 1             | *             |
|         |  | 1173693       | *             | *             | *             | *             | 1             |
| 17      | COIL, CONDENSER -MANIFOLDS INCLUDED-   | 1174326       | 1             | *             | *             | *             | *             |
|         |  | 1174327       | *             | 1             | *             | *             | *             |
|         |  | 1174328       | *             | *             | 1             | *             | *             |
|         |  | 1174329       | *             | *             | *             | 1             | *             |
|         |  | 1174330       | *             | *             | *             | *             | 1             |
| 18      | PLUG, COMPRESSOR   | 1173826       | 1             | 1             | 1             | 1             | 1             |
| 19      | PLUG, SOLENOID   | 1173827       | *             | *             | *             | *             | 1             |
| 20      | VALVE, SERVICE (HI/LO PORT)  | 1083939       | 1             | 1             | 1             | 1             | 1             |
| 21      | HARNESS, WIRE (SINGLE CAPACITY PHP)  | 1174245       | 1             | 1             | 1             | 1             | *             |
|         | HARNESS, WIRE (DUAL CAPACITY PHP)  | 1174239       | *             | *             | *             | *             | 1             |
| 23      | HEATER, CRANKCASE (40W, 240V)  | 1173824       | 1             | *             | *             | *             | *             |
|         |  | 1173825       | *             | 1             | 1             | 1             | 1             |

| KEY NO. | DESCRIPTION   | FAST NUMBER  | PHF32400K00A1 | PHF33000K00A1 | PHF33600K00A1 | PHF34200K00A1 | PHF34800K00A1 |
|---------|---|--------------|---------------|---------------|---------------|---------------|---------------|
| 25      | SWITCH, HIGH PRESSURE   | 1173712      | *             | *             | *             | 1             | 1             |
| 26      | VALVE, EXPANSION (4 TON)  | 1173834      | *             | *             | *             | *             | 1             |
|         | VALVE, EXPANSION (3 TON)  | 1173833      | *             | *             | *             | 1             | *             |
| 27      | SWITCH, TEMPERATURE   | 1173821      | 1             | 1             | 1             | 1             | 1             |
| 47      | CONTROL BOARD (DEFROST)   | 1174185      | 1             | 1             | 1             | 1             | 1             |
| 48      | SWITCH, LOW PRESSURE  | 1173698      | 1             | 1             | 1             | 1             | 1             |
| 49      | ACCUMULATOR   | 1173714      | 1             | *             | *             | *             | 1             |
|         |   | 1172018      | *             | 1             | 1             | *             | *             |
|         |   | 1173713      | *             | *             | *             | 1             | *             |
| 50      | VALVE, REVERSING  | 1173708      | 1             | 1             | 1             | *             | *             |
|         |   | 1172618      | *             | *             | *             | 1             | 1             |
| 51      | FLOW RESTICTOR, CONDENSER (.049")   | 1173868      | 1             | *             | *             | *             | *             |
|         | FLOW RESTICTOR, CONDENSER (.057")   | 1173658      | *             | 1             | *             | *             | *             |
|         | FLOW RESTICTOR, CONDENSER (.059")   | 1173871      | *             | *             | 1             | *             | *             |
|         | FLOW RESTICTOR, CONDENSER (.065")   | 1173873      | *             | *             | *             | 1             | *             |
|         | FLOW RESTICTOR, CONDENSER (.070")   | 1173869      | *             | *             | *             | *             | 1             |
| 52      | TAILPIECE KIT, CONDENSER<br>(INCLUDES: BRASS HEX NUT, TEFLON WASHER, PISTON<br>RETAINER WITH 3/8 TAILPIECE AND STAINER) | 1174325      | 1             | 1             | 1             | 1             | 1             |
| 53      | DISTRIBUTOR, CONDENSER (R-22)   | 1174241      | 1             | *             | *             | *             | *             |
|         |   | 1174242      | *             | 1             | *             | 1             | *             |
|         |   | 1174245      | *             | *             | 1             | *             | *             |
|         |   | 1174239      | *             | *             | *             | *             | 1             |
| 54      | SOLENOID, LIQUID LINE   | New required | 1             | *             | *             | *             | *             |
| A       | PANEL, TOP  | 1174264      | 1             | 1             | 1             | 1             | 1             |
| B       | GRILLE, OUTLET (20" FAN)  | 1173832      | 1             | 1             | 1             | 1             | 1             |
| C       | GRILLE, INLET   | 1097527      | 1             | *             | *             | *             | *             |
|         |   | 1097528      | *             | 1             | 1             | 1             | 1             |
| D       | NUT, LOCK   | 1172740      | 4             | 4             | 4             | 4             | 4             |
| E       | PANEL, ACCESS COMPRESSOR  | 1114518      | 1             | *             | *             | *             | *             |
|         |   | 1111015      | *             | 1             | 1             | 1             | 1             |
| F       | PLATE, HI/LO PORT   | 1085473      | 1             | 1             | 1             | 1             | 1             |
| G       | HOUSING, BLOWER   | 1174166      | 1             | 1             | *             | *             | *             |
|         |   | 1174167      | *             | *             | 1             | 1             | *             |
|         |   | 1174168      | *             | *             | *             | *             | 1             |
| H       | BOX, BLOWER   | 1174265      | 1             | 1             | 1             | 1             | 1             |
| N       | PANEL, REAR   | 1114517      | 1             | *             | *             | *             | *             |
|         |   | 1111014      | *             | 1             | 1             | 1             | 1             |
| P       | COVER, DUCTS  | 1114525      | 1             | 1             | 1             | 1             | 1             |
| Q       | PANEL, ACCESS CENTER  | 1114520      | 1             | *             | *             | *             | *             |
|         |   | 1111017      | *             | 1             | 1             | 1             | 1             |
| R       | PANEL, ACCESS CONTROL BOX   | 1114524      | 1             | *             | *             | *             | *             |
|         |   | 1111019      | *             | 1             | 1             | 1             | 1             |
| S       | PANEL ACCESS, BLOWER  | 1114522      | 1             | *             | *             | *             | *             |
|         |   | 1111018      | *             | 1             | 1             | 1             | 1             |
| T       | POST, CORNER  | 1098761      | 1             | *             | *             | *             | *             |
|         |   | 1098762      | *             | 1             | 1             | 1             | 1             |

# PHF3 Series

NOTE: This illustration is for reference only. Your unit may differ in appearance or may not include all components shown.

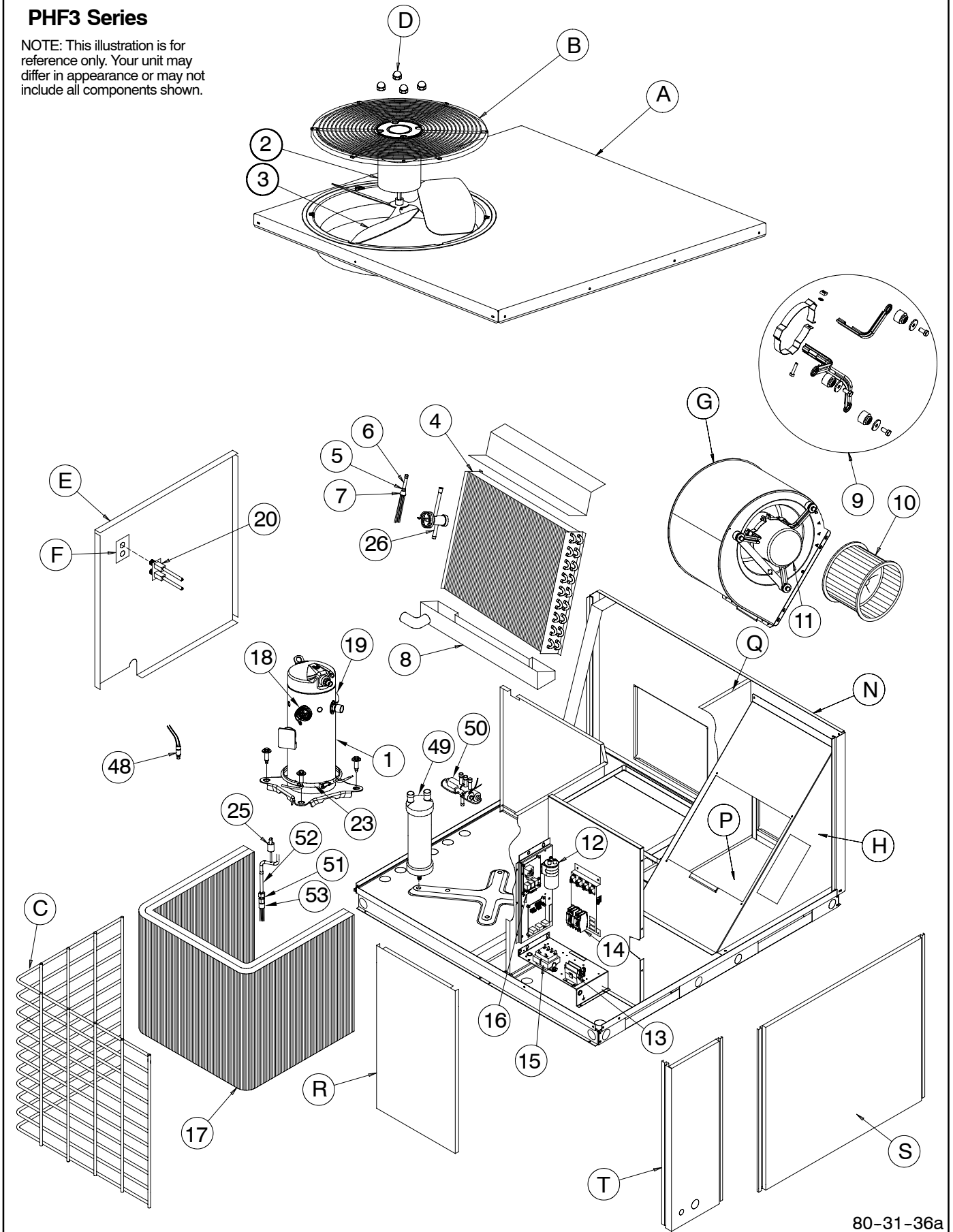

80-31-36a

|  |                      | PHF32400K00A1                                     |      |      |      |      |      |      |      |      |      |      |      |      |      |      |
|--|----------------------|---|------|------|------|------|------|------|------|------|------|------|------|------|------|------|
|  |                      | 700   |      |      |      |      | 800  |      |      |      |      | 900  |      |      |      |      |
| OD Ambient<br>(°F) db  | ID Airflow<br>(SCFM) | Entering Indoor Temperature - Degrees F, Wet Bulb |      |      |      |      |      |      |      |      |      |      |      |      |      |      |
|  |                      | 57  | 62   | 63 † | 67   | 72   | 57   | 62   | 63 † | 67   | 72   | 57   | 62   | 63 † | 67   | 72   |
| 75   | MBh†                 | 22.1  | 23.0 | 23.5 | 25.2 | 26.5 | 23.3 | 23.8 | 24.1 | 25.5 | 26.6 | 24.3 | 24.3 | 24.4 | 25.8 | 27.4 |
|  | S/T                  | 1.00  | 0.91 | 0.73 | 0.70 | 0.52 | 1.00 | 0.96 | 0.76 | 0.73 | 0.53 | 1.00 | 0.99 | 0.80 | 0.77 | 0.53 |
|  | AMPS*                | 7.4   | 7.4  | 7.4  | 7.4  | 7.5  | 7.7  | 7.7  | 7.7  | 7.7  | 7.8  | 8.0  | 8.0  | 8.0  | 8.1  | 8.1  |
|  | HI PR                | 167   | 167  | 168  | 171  | 174  | 168  | 168  | 169  | 172  | 174  | 169  | 169  | 170  | 173  | 174  |
|  | LO PR                | 68  | 70   | 71   | 75   | 78   | 71   | 72   | 73   | 76   | 78   | 74   | 74   | 74   | 77   | 78   |
| 85   | MBh†                 | 21.3  | 22.0 | 22.5 | 24.5 | 26.3 | 22.5 | 22.7 | 23.1 | 25.1 | 26.4 | 23.5 | 23.5 | 23.7 | 25.5 | 27.1 |
|  | S/T                  | 1.00  | 0.93 | 0.74 | 0.71 | 0.52 | 1.00 | 0.98 | 0.77 | 0.74 | 0.55 | 1.00 | 0.99 | 0.81 | 0.78 | 0.56 |
|  | AMPS*                | 8.2   | 8.2  | 8.2  | 8.2  | 8.3  | 8.5  | 8.5  | 8.5  | 8.5  | 8.6  | 8.9  | 8.9  | 8.9  | 8.9  | 9.0  |
|  | HI PR                | 194   | 195  | 195  | 197  | 201  | 195  | 196  | 196  | 198  | 202  | 196  | 196  | 196  | 199  | 203  |
|  | LO PR                | 69  | 71   | 72   | 79   | 84   | 73   | 73   | 75   | 80   | 85   | 76   | 76   | 76   | 82   | 85   |
| 95   | MBh†                 | 20.5  | 20.9 | 21.4 | 22.9 | 26.0 | 21.6 | 21.6 | 22.0 | 23.0 | 26.1 | 22.6 | 22.6 | 22.5 | 24.5 | 26.8 |
|  | S/T                  | 1.01  | 0.96 | 0.75 | 0.72 | 0.52 | 1.00 | 0.99 | 0.79 | 0.76 | 0.55 | 1.00 | 1.00 | 0.83 | 0.80 | 0.56 |
|  | AMPS*                | 9.0   | 9.0  | 9.0  | 9.2  | 9.2  | 9.4  | 9.4  | 9.4  | 9.5  | 9.5  | 9.8  | 9.8  | 9.8  | 9.8  | 9.9  |
|  | HI PR                | 223   | 223  | 224  | 227  | 230  | 225  | 225  | 225  | 227  | 231  | 226  | 226  | 226  | 228  | 232  |
|  | LO PR                | 71  | 72   | 73   | 80   | 88   | 75   | 75   | 75   | 82   | 89   | 78   | 78   | 77   | 84   | 90   |
| 105  | MBh†                 | 19.6  | 19.8 | 20.2 | 22.1 | 24.9 | 20.7 | 20.7 | 20.8 | 22.7 | 25.5 | 21.6 | 21.6 | 21.2 | 23.2 | 26.0 |
|  | S/T                  | 1.00  | 0.99 | 0.77 | 0.74 | 0.53 | 1.00 | 0.99 | 0.81 | 0.78 | 0.55 | 1.00 | 1.00 | 0.85 | 0.82 | 0.57 |
|  | AMPS*                | 10.0  | 10.0 | 10.0 | 10.1 | 10.2 | 10.3 | 10.3 | 10.3 | 10.4 | 10.5 | 10.7 | 10.7 | 10.7 | 10.8 | 10.9 |
|  | HI PR                | 255   | 255  | 255  | 259  | 262  | 257  | 257  | 256  | 260  | 263  | 259  | 259  | 257  | 260  | 263  |
|  | LO PR                | 73  | 73   | 74   | 81   | 89   | 77   | 77   | 76   | 83   | 91   | 80   | 80   | 78   | 84   | 93   |
| 115  | MBh†                 | 18.6  | 18.7 | 19.0 | 20.9 | 23.6 | 19.6 | 19.7 | 19.5 | 21.4 | 24.2 | 20.5 | 20.5 | 19.9 | 21.9 | 24.6 |
|  | S/T                  | 1.00  | 1.00 | 0.79 | 0.76 | 0.54 | 1.00 | 0.99 | 0.84 | 0.80 | 0.56 | 1.00 | 0.99 | 0.88 | 0.85 | 0.58 |
|  | AMPS*                | 11.0  | 11.0 | 11.0 | 11.1 | 11.3 | 11.4 | 11.4 | 11.4 | 11.5 | 11.7 | 11.8 | 11.8 | 11.7 | 11.8 | 12.0 |
|  | HI PR                | 289   | 289  | 289  | 293  | 297  | 291  | 291  | 290  | 295  | 298  | 293  | 293  | 291  | 296  | 298  |
|  | LO PR                | 75  | 76   | 75   | 82   | 90   | 79   | 79   | 77   | 83   | 92   | 82   | 82   | 78   | 85   | 94   |
| 125  | MBh†                 | 17.5  | 17.6 | 17.6 | 19.4 | 22.1 | 18.5 | 18.6 | 18.0 | 20.0 | 22.7 | 19.4 | 19.4 | 18.4 | 20.4 | 23.1 |
|  | S/T                  | 1.00  | 0.99 | 0.82 | 0.79 | 0.55 | 1.00 | 1.00 | 0.87 | 0.83 | 0.57 | 1.00 | 1.00 | 0.91 | 0.88 | 0.60 |
|  | AMPS*                | 12.1  | 12.1 | 12.1 | 12.3 | 12.4 | 12.5 | 12.5 | 12.4 | 12.6 | 12.8 | 12.9 | 12.9 | 12.8 | 13.0 | 13.2 |
|  | HI PR                | 326   | 326  | 325  | 330  | 336  | 329  | 329  | 326  | 332  | 336  | 331  | 331  | 327  | 333  | 337  |
|  | LO PR                | 78  | 78   | 76   | 83   | 91   | 81   | 81   | 78   | 84   | 93   | 84   | 84   | 79   | 86   | 95   |
| Air Delivery in CFM - Dry Coil - No Filter (Add .05 Static Press for Wet Coil) |                      |   |      |      |      |      |      |      |      |      |      |      |      |      |      |      |
| Speed Tap  |                      | External Static Pressure (Inch Water Col)         |      |      |      |      |      |      |      |      |      |      |      |      |      |      |
|  |                      | 0.1   | 0.2  | 0.3  | 0.4  | 0.5  | 0.6  | 0.7  | 0.8  | 0.9  | 1.0  |      |      |      |      |      |
| 1  |                      | 891   | 845  | 804  | 758  | 707  | 649  | 582  | 509  | -    | -    |      |      |      |      |      |
| 2  |                      | -   | -    | -    | -    | -    | -    | -    | -    | -    | -    |      |      |      |      |      |
| 3  |                      | 1136  | 1098 | 1056 | 1020 | 980  | 920  | 785  | 569  | 318  | -    |      |      |      |      |      |
| 4  |                      | -   | -    | -    | -    | -    | -    | -    | -    | -    | -    |      |      |      |      |      |
| 5  |                      | -   | -    | -    | -    | -    | -    | -    | -    | -    | -    |      |      |      |      |      |

Notes: When the required data fall between the published data, interpolation may be performed. Extrapolation is not an acceptable practice.  
† Total capacities are net capacities. Blower heat has been subtracted  
†† At TVA rating indoor condition (75°F db/ 63°F wb), All other indoor air temperatures are at 80°F db  
\* System amps is total unit amps

50CU500266 - 2.0

|  |                      | PHF33000K00A1                                     |      |      |      |      |      |      |      |      |      |      |      |      |      |      |
|--|----------------------|---|------|------|------|------|------|------|------|------|------|------|------|------|------|------|
|  |                      | 875   |      |      |      |      | 1000 |      |      |      |      | 1125 |      |      |      |      |
| OD Ambient<br>(°F) db  | ID Airflow<br>(SCFM) | Entering Indoor Temperature - Degrees F, Wet Bulb |      |      |      |      |      |      |      |      |      |      |      |      |      |      |
|  |                      | 57  | 62   | 63 † | 67   | 72   | 57   | 62   | 63 † | 67   | 72   | 57   | 62   | 63 † | 67   | 72   |
| 75   | MBh†                 | 27.0  | 28.2 | 28.9 | 30.7 | 32.0 | 28.7 | 29.1 | 29.5 | 31.1 | 32.9 | 29.9 | 29.9 | 29.9 | 31.3 | 33.1 |
|  | S/T                  | 0.99  | 0.91 | 0.72 | 0.70 | 0.50 | 0.99 | 0.96 | 0.75 | 0.74 | 0.49 | 0.99 | 0.99 | 0.79 | 0.78 | 0.49 |
|  | AMPS*                | 9.1   | 9.1  | 9.1  | 9.2  | 9.3  | 9.4  | 9.4  | 9.5  | 9.5  | 9.6  | 9.8  | 9.8  | 9.8  | 9.9  | 9.9  |
|  | HI PR                | 171   | 171  | 172  | 175  | 178  | 172  | 172  | 173  | 176  | 178  | 173  | 173  | 174  | 177  | 178  |
|  | LO PR                | 70  | 72   | 73   | 77   | 80   | 73   | 74   | 75   | 78   | 80   | 76   | 76   | 76   | 79   | 80   |
| 85   | MBh†                 | 25.7  | 26.4 | 27.1 | 30.0 | 32.4 | 27.3 | 27.4 | 28.0 | 30.7 | 32.7 | 28.7 | 28.8 | 28.8 | 31.2 | 32.9 |
|  | S/T                  | 0.99  | 0.94 | 0.74 | 0.70 | 0.52 | 0.99 | 0.99 | 0.77 | 0.74 | 0.54 | 0.99 | 0.99 | 0.81 | 0.78 | 0.56 |
|  | AMPS*                | 10.0  | 10.0 | 10.0 | 10.1 | 10.2 | 10.4 | 10.4 | 10.4 | 10.4 | 10.5 | 10.7 | 10.7 | 10.7 | 10.8 | 10.9 |
|  | HI PR                | 198   | 199  | 199  | 201  | 205  | 199  | 200  | 200  | 202  | 206  | 200  | 200  | 200  | 203  | 207  |
|  | LO PR                | 71  | 73   | 74   | 81   | 86   | 75   | 75   | 76   | 82   | 87   | 78   | 78   | 78   | 83   | 87   |
| 95   | MBh†                 | 24.5  | 24.8 | 25.4 | 28.1 | 31.7 | 25.9 | 26.0 | 26.2 | 29.0 | 32.3 | 27.2 | 27.3 | 26.9 | 29.7 | 32.6 |
|  | S/T                  | 0.99  | 0.97 | 0.76 | 0.72 | 0.52 | 0.99 | 0.99 | 0.79 | 0.76 | 0.54 | 0.99 | 0.99 | 0.83 | 0.80 | 0.56 |
|  | AMPS*                | 10.9  | 10.9 | 10.9 | 11.1 | 11.2 | 11.3 | 11.3 | 11.3 | 11.5 | 11.5 | 11.7 | 11.7 | 11.7 | 11.8 | 11.9 |
|  | HI PR                | 227   | 227  | 228  | 231  | 234  | 229  | 229  | 229  | 231  | 235  | 230  | 230  | 230  | 232  | 236  |
|  | LO PR                | 73  | 74   | 75   | 82   | 89   | 77   | 77   | 77   | 84   | 91   | 80   | 80   | 79   | 85   | 92   |
| 105  | MBh†                 | 23.2  | 23.3 | 23.7 | 26.3 | 30.0 | 24.6 | 24.7 | 24.5 | 27.1 | 30.9 | 25.8 | 25.8 | 25.0 | 27.7 | 31.6 |
|  | S/T                  | 0.99  | 0.99 | 0.78 | 0.75 | 0.53 | 0.99 | 0.99 | 0.82 | 0.79 | 0.55 | 0.99 | 0.99 | 0.86 | 0.83 | 0.57 |
|  | AMPS*                | 12.0  | 12.0 | 12.0 | 12.1 | 12.4 | 12.3 | 12.3 | 12.3 | 12.5 | 12.6 | 12.8 | 12.8 | 12.7 | 12.9 | 13.0 |
|  | HI PR                | 259   | 259  | 259  | 263  | 266  | 261  | 261  | 260  | 264  | 267  | 263  | 263  | 261  | 264  | 267  |
|  | LO PR                | 75  | 75   | 76   | 83   | 91   | 79   | 79   | 78   | 85   | 93   | 82   | 82   | 80   | 86   | 95   |
| 115  | MBh†                 | 21.8  | 21.9 | 21.9 | 24.4 | 28.0 | 23.2 | 23.3 | 22.6 | 25.1 | 28.9 | 24.3 | 24.4 | 23.1 | 25.7 | 29.5 |
|  | S/T                  | 0.99  | 0.99 | 0.81 | 0.77 | 0.54 | 0.99 | 0.99 | 0.85 | 0.82 | 0.56 | 0.99 | 0.99 | 0.90 | 0.86 | 0.59 |
|  | AMPS*                | 13.1  | 13.1 | 13.1 | 13.3 | 13.5 | 13.5 | 13.5 | 13.5 | 13.6 | 13.9 | 14.0 | 14.0 | 13.9 | 14.0 | 14.3 |
|  | HI PR                | 293   | 293  | 293  | 297  | 301  | 295  | 295  | 294  | 299  | 302  | 297  | 297  | 295  | 300  | 302  |
|  | LO PR                | 77  | 77   | 77   | 83   | 92   | 81   | 81   | 79   | 85   | 94   | 83   | 84   | 80   | 87   | 96   |
| 125  | MBh†                 | 20.3  | 20.4 | 19.8 | 22.5 | 26.0 | 21.6 | 21.7 | 20.4 | 23.2 | 26.7 | 22.8 | 22.8 | 20.9 | 23.7 | 27.3 |
|  | S/T                  | 0.99  | 0.99 | 0.85 | 0.80 | 0.55 | 0.99 | 0.99 | 0.90 | 0.85 | 0.58 | 0.99 | 0.99 | 0.95 | 0.90 | 0.61 |
|  | AMPS*                | 14.4  | 14.4 | 14.3 | 14.6 | 14.8 | 14.8 | 14.8 | 14.7 | 14.9 | 15.1 | 15.2 | 15.2 | 15.1 | 15.3 | 15.5 |
|  | HI PR                | 330   | 330  | 329  | 334  | 340  | 333  | 333  | 330  | 336  | 340  | 335  | 335  | 331  | 337  | 341  |
|  | LO PR                | 80  | 80   | 78   | 84   | 93   | 83   | 83   | 80   | 86   | 95   | 85   | 86   | 81   | 88   | 96   |
| Air Delivery in CFM - Dry Coil - No Filter (Add .05 Static Press for Wet Coil) |                      |   |      |      |      |      |      |      |      |      |      |      |      |      |      |      |
| Speed Tap  |                      | External Static Pressure (Inch Water Col)         |      |      |      |      |      |      |      |      |      |      |      |      |      |      |
|  |                      | 0.1   | 0.2  | 0.3  | 0.4  | 0.5  | 0.6  | 0.7  | 0.8  | 0.9  | 1.0  |      |      |      |      |      |
| 1  |                      | 986   | 949  | 908  | 856  | 819  | 781  | 717  | 664  | 612  | 554  |      |      |      |      |      |
| 2  |                      | 1076  | 1038 | 997  | 973  | 913  | 875  | 840  | 786  | 717  | 659  |      |      |      |      |      |
| 3  |                      | 1286  | 1225 | 1186 | 1158 | 1129 | 1085 | 1044 | 1004 | 948  | 755  |      |      |      |      |      |
| 4  |                      | 1352  | 1311 | 1274 | 1233 | 1203 | 1162 | 1119 | 1066 | 989  | 774  |      |      |      |      |      |
| 5  |                      | -   | -    | -    | -    | -    | -    | -    | -    | -    | -    |      |      |      |      |      |

Notes: When the required data fall between the published data, interpolation may be performed. Extrapolation is not an acceptable practice.  
† Total capacities are net capacities. Blower heat has been subtracted  
†† At TVA rating indoor condition (75°F db/ 63°F wb), All other indoor air temperatures are at 80°F db  
\* System amps is total unit amps

50CU500267 - 2.0

|  |                      | PHF33600K00A1                                     |      |       |      |      |      |      |       |      |      |      |      |       |      |      |
|--|----------------------|---|------|-------|------|------|------|------|-------|------|------|------|------|-------|------|------|
|  |                      | 1050  |      |       |      |      | 1200 |      |       |      |      | 1350 |      |       |      |      |
| OD Ambient<br>(°F) db  | ID Airflow<br>(SCFM) | Entering Indoor Temperature - Degrees F, Wet Bulb |      |       |      |      |      |      |       |      |      |      |      |       |      |      |
|  |                      | 57  | 62   | 63 1" | 67   | 72   | 57   | 62   | 63 1" | 67   | 72   | 57   | 62   | 63 1" | 67   | 72   |
| 75   | MBh†                 | 32.9  | 34.1 | 34.8  | 37.6 | 40.5 | 36.3 | 36.3 | 36.7  | 38.9 | 41.2 | 37.4 | 37.4 | 37.4  | 39.2 | 41.3 |
|  | S/T                  | 0.97  | 0.89 | 0.84  | 0.68 | 0.50 | 0.97 | 0.97 | 0.94  | 0.75 | 0.53 | 0.97 | 0.97 | 0.97  | 0.78 | 0.55 |
|  | AMPS*                | 10.3  | 10.4 | 10.4  | 10.5 | 10.6 | 10.8 | 10.8 | 10.9  | 11.1 | 11.1 | 11.1 | 11.1 | 11.1  | 11.4 | 11.5 |
|  | HI PR                | 184   | 185  | 186   | 187  | 191  | 187  | 187  | 187   | 189  | 192  | 188  | 188  | 188   | 190  | 193  |
|  | LO PR                | 70  | 73   | 74    | 78   | 83   | 77   | 77   | 77    | 81   | 85   | 79   | 79   | 79    | 82   | 85   |
| 85   | MBh†                 | 31.8  | 32.7 | 33.3  | 36.1 | 39.8 | 35.0 | 35.0 | 35.1  | 37.7 | 40.9 | 36.1 | 36.2 | 36.2  | 38.1 | 41.1 |
|  | S/T                  | 0.97  | 0.90 | 0.86  | 0.69 | 0.51 | 0.97 | 0.97 | 0.96  | 0.77 | 0.54 | 0.97 | 0.97 | 0.97  | 0.80 | 0.56 |
|  | AMPS*                | 11.4  | 11.5 | 11.6  | 11.7 | 11.7 | 12.0 | 12.0 | 12.1  | 12.2 | 12.3 | 12.2 | 12.2 | 12.2  | 12.6 | 12.7 |
|  | HI PR                | 209   | 211  | 211   | 214  | 217  | 214  | 214  | 214   | 216  | 219  | 215  | 215  | 215   | 216  | 220  |
|  | LO PR                | 72  | 74   | 75    | 80   | 85   | 78   | 78   | 79    | 83   | 88   | 81   | 81   | 81    | 84   | 89   |
| 95   | MBh†                 | 30.7  | 31.2 | 31.8  | 34.5 | 38.4 | 33.6 | 33.6 | 33.6  | 35.0 | 39.7 | 34.7 | 34.7 | 34.7  | 36.4 | 40.0 |
|  | S/T                  | 0.97  | 0.93 | 0.88  | 0.70 | 0.51 | 0.97 | 0.97 | 0.97  | 0.78 | 0.55 | 0.97 | 0.97 | 0.97  | 0.82 | 0.57 |
|  | AMPS*                | 12.6  | 12.7 | 12.8  | 13.0 | 13.0 | 13.2 | 13.2 | 13.2  | 13.5 | 13.6 | 13.5 | 13.5 | 13.5  | 13.8 | 14.0 |
|  | HI PR                | 237   | 238  | 239   | 243  | 246  | 242  | 242  | 242   | 245  | 248  | 244  | 244  | 244   | 245  | 249  |
|  | LO PR                | 74  | 75   | 76    | 81   | 87   | 80   | 80   | 80    | 84   | 90   | 82   | 82   | 82    | 85   | 91   |
| 105  | MBh†                 | 29.4  | 29.7 | 30.2  | 32.8 | 36.7 | 32.2 | 32.3 | 32.3  | 34.2 | 38.0 | 33.2 | 33.3 | 33.3  | 34.6 | 38.3 |
|  | S/T                  | 0.97  | 0.95 | 0.90  | 0.72 | 0.52 | 0.97 | 0.97 | 0.97  | 0.81 | 0.56 | 0.97 | 0.97 | 0.97  | 0.85 | 0.59 |
|  | AMPS*                | 13.9  | 14.0 | 14.1  | 14.3 | 14.4 | 14.6 | 14.6 | 14.6  | 14.9 | 15.0 | 14.9 | 14.9 | 14.9  | 15.2 | 15.4 |
|  | HI PR                | 268   | 268  | 269   | 273  | 277  | 273  | 273  | 273   | 276  | 279  | 275  | 275  | 275   | 276  | 280  |
|  | LO PR                | 75  | 76   | 77    | 82   | 88   | 81   | 81   | 81    | 85   | 91   | 84   | 84   | 84    | 86   | 92   |
| 115  | MBh†                 | 28.1  | 28.1 | 28.5  | 31.0 | 34.8 | 30.7 | 30.7 | 30.8  | 32.2 | 36.1 | 31.7 | 31.7 | 31.7  | 32.6 | 36.4 |
|  | S/T                  | 0.97  | 0.97 | 0.93  | 0.74 | 0.53 | 0.97 | 0.97 | 0.97  | 0.83 | 0.58 | 0.97 | 0.97 | 0.97  | 0.87 | 0.60 |
|  | AMPS*                | 15.4  | 15.4 | 15.5  | 15.7 | 15.9 | 16.0 | 16.0 | 16.0  | 16.3 | 16.5 | 16.3 | 16.4 | 16.4  | 16.7 | 16.9 |
|  | HI PR                | 300   | 300  | 301   | 306  | 311  | 306  | 306  | 306   | 309  | 313  | 308  | 308  | 308   | 310  | 314  |
|  | LO PR                | 77  | 77   | 78    | 83   | 90   | 83   | 83   | 83    | 86   | 93   | 85   | 85   | 85    | 87   | 94   |
| 125  | MBh†                 | 26.6  | 26.6 | 26.7  | 29.1 | 32.7 | 29.1 | 29.1 | 29.1  | 30.2 | 33.9 | 30.0 | 30.0 | 30.0  | 30.5 | 34.2 |
|  | S/T                  | 0.97  | 0.97 | 0.96  | 0.76 | 0.54 | 0.97 | 0.97 | 0.97  | 0.86 | 0.59 | 0.97 | 0.97 | 0.97  | 0.91 | 0.62 |
|  | AMPS*                | 16.9  | 16.9 | 17.0  | 17.2 | 17.5 | 17.5 | 17.6 | 17.6  | 17.8 | 18.2 | 17.9 | 17.9 | 17.9  | 18.2 | 18.5 |
|  | HI PR                | 336   | 336  | 336   | 341  | 347  | 342  | 342  | 342   | 344  | 350  | 344  | 344  | 344   | 345  | 350  |
|  | LO PR                | 79  | 79   | 80    | 84   | 91   | 85   | 85   | 85    | 87   | 94   | 87   | 87   | 87    | 88   | 95   |
| Air Delivery in CFM - Dry Coil - No Filter (Add .05 Static Press for Wet Coil) |                      |   |      |       |      |      |      |      |       |      |      |      |      |       |      |      |
| Speed Tap  |                      | External Static Pressure (Inch Water Col)         |      |       |      |      |      |      |       |      |      |      |      |       |      |      |
|  |                      | 0.1   | 0.2  | 0.3   | 0.4  | 0.5  | 0.6  | 0.7  | 0.8   | 0.9  | 1.0  |      |      |       |      |      |
| 1  |                      | 1162  | 1118 | 1062  | 1014 | 958  | 892  | 826  | 780   | 735  | 675  |      |      |       |      |      |
| 2  |                      | 1278  | 1233 | 1191  | 1149 | 1108 | 1060 | 1005 | 943   | 892  | 844  |      |      |       |      |      |
| 3  |                      | 1529  | 1484 | 1440  | 1402 | 1364 | 1326 | 1284 | 1238  | 1179 | 1123 |      |      |       |      |      |
| 4  |                      | 1652  | 1607 | 1574  | 1541 | 1501 | 1462 | 1426 | 1384  | 1338 | 1277 |      |      |       |      |      |
| 5  |                      | -   | -    | -     | -    | -    | -    | -    | -     | -    | -    |      |      |       |      |      |

Notes: When the required data fall between the published data, interpolation may be performed. Extrapolation is not an acceptable practice.  
† Total capacities are net capacities. Blower heat has been subtracted  
‡ At TVA rating indoor condition (75°F db/ 63°F wb), All other indoor air temperatures are at 80°F db  
\* System amps is total unit amps

50CU500268 - 2.0

|  |                      | PHF34200K00A1                                     |      |       |      |      |      |      |       |      |      |      |      |       |      |      |
|--|----------------------|---|------|-------|------|------|------|------|-------|------|------|------|------|-------|------|------|
|  |                      | 1225  |      |       |      |      | 1400 |      |       |      |      | 1575 |      |       |      |      |
| OD Ambient<br>(°F) db  | ID Airflow<br>(SCFM) | Entering Indoor Temperature - Degrees F, Wet Bulb |      |       |      |      |      |      |       |      |      |      |      |       |      |      |
|  |                      | 57  | 62   | 63 1" | 67   | 72   | 57   | 62   | 63 1" | 67   | 72   | 57   | 62   | 63 1" | 67   | 72   |
| 75   | MBh†                 | 38.0  | 38.8 | 39.4  | 42.6 | 47.0 | 39.7 | 39.8 | 40.3  | 43.3 | 47.8 | 41.0 | 41.1 | 41.1  | 43.9 | 48.4 |
|  | S/T                  | 0.96  | 0.91 | 0.86  | 0.69 | 0.51 | 0.96 | 0.96 | 0.91  | 0.73 | 0.52 | 0.96 | 0.96 | 0.96  | 0.76 | 0.54 |
|  | AMPS*                | 12.0  | 12.2 | 12.2  | 12.4 | 12.6 | 12.3 | 12.4 | 12.6  | 12.8 | 13.0 | 12.7 | 12.7 | 12.9  | 13.2 | 13.5 |
|  | HI PR                | 193   | 194  | 194   | 198  | 203  | 195  | 195  | 196   | 199  | 204  | 197  | 197  | 197   | 200  | 205  |
|  | LO PR                | 74  | 76   | 77    | 82   | 89   | 77   | 78   | 79    | 84   | 91   | 80   | 80   | 80    | 85   | 92   |
| 85   | MBh†                 | 36.9  | 37.3 | 38.0  | 41.0 | 45.3 | 38.4 | 38.5 | 38.8  | 41.7 | 46.0 | 39.7 | 39.8 | 39.8  | 42.2 | 46.5 |
|  | S/T                  | 0.96  | 0.93 | 0.88  | 0.71 | 0.51 | 0.96 | 0.96 | 0.93  | 0.74 | 0.53 | 0.96 | 0.96 | 0.96  | 0.78 | 0.55 |
|  | AMPS*                | 13.4  | 13.5 | 13.6  | 13.8 | 14.0 | 13.7 | 13.7 | 13.9  | 14.2 | 14.4 | 14.1 | 14.1 | 14.1  | 14.6 | 14.9 |
|  | HI PR                | 219   | 220  | 221   | 225  | 230  | 222  | 222  | 222   | 226  | 231  | 224  | 224  | 224   | 227  | 232  |
|  | LO PR                | 75  | 76   | 78    | 83   | 90   | 79   | 79   | 79    | 84   | 92   | 81   | 81   | 81    | 86   | 93   |
| 95   | MBh†                 | 35.7  | 35.9 | 36.5  | 39.3 | 43.5 | 37.1 | 37.2 | 37.3  | 40.0 | 44.2 | 38.3 | 38.4 | 38.4  | 40.4 | 44.6 |
|  | S/T                  | 0.96  | 0.95 | 0.90  | 0.72 | 0.52 | 0.96 | 0.96 | 0.95  | 0.76 | 0.54 | 0.96 | 0.96 | 0.96  | 0.80 | 0.56 |
|  | AMPS*                | 14.9  | 15.1 | 15.1  | 15.4 | 15.6 | 15.3 | 15.3 | 15.4  | 15.7 | 16.0 | 15.7 | 15.7 | 15.7  | 16.2 | 16.4 |
|  | HI PR                | 249   | 249  | 250   | 254  | 260  | 251  | 251  | 252   | 255  | 261  | 253  | 253  | 253   | 257  | 262  |
|  | LO PR                | 77  | 77   | 78    | 83   | 91   | 80   | 80   | 80    | 85   | 92   | 83   | 83   | 83    | 87   | 94   |
| 105  | MBh†                 | 34.4  | 34.4 | 34.9  | 37.6 | 41.7 | 35.8 | 35.8 | 35.9  | 38.2 | 42.3 | 36.9 | 37.0 | 37.0  | 38.6 | 42.6 |
|  | S/T                  | 0.96  | 0.96 | 0.92  | 0.73 | 0.53 | 0.96 | 0.96 | 0.96  | 0.77 | 0.55 | 0.96 | 0.96 | 0.96  | 0.82 | 0.57 |
|  | AMPS*                | 16.6  | 16.7 | 16.8  | 17.0 | 17.3 | 17.0 | 17.0 | 17.0  | 17.4 | 17.7 | 17.4 | 17.4 | 17.4  | 17.8 | 18.1 |
|  | HI PR                | 281   | 281  | 282   | 286  | 292  | 284  | 284  | 284   | 287  | 293  | 286  | 286  | 286   | 289  | 294  |
|  | LO PR                | 78  | 78   | 79    | 84   | 92   | 81   | 81   | 81    | 86   | 93   | 84   | 84   | 84    | 87   | 95   |
| 115  | MBh†                 | 33.1  | 33.1 | 33.3  | 35.9 | 39.7 | 34.4 | 34.4 | 34.4  | 36.4 | 40.3 | 35.4 | 35.5 | 35.5  | 36.7 | 40.6 |
|  | S/T                  | 0.96  | 0.96 | 0.94  | 0.75 | 0.53 | 0.96 | 0.96 | 0.96  | 0.79 | 0.56 | 0.96 | 0.96 | 0.96  | 0.84 | 0.58 |
|  | AMPS*                | 18.5  | 18.5 | 18.6  | 18.9 | 19.1 | 18.8 | 18.8 | 18.9  | 19.3 | 19.5 | 19.2 | 19.2 | 19.2  | 19.7 | 20.0 |
|  | HI PR                | 316   | 317  | 317   | 321  | 327  | 319  | 319  | 319   | 322  | 328  | 321  | 321  | 321   | 323  | 329  |
|  | LO PR                | 80  | 80   | 80    | 85   | 92   | 83   | 83   | 83    | 87   | 94   | 85   | 85   | 85    | 88   | 95   |
| 125  | MBh†                 | 31.7  | 31.7 | 31.7  | 34.0 | 37.7 | 32.9 | 32.9 | 32.9  | 34.5 | 38.2 | 33.9 | 33.9 | 33.9  | 34.8 | 38.4 |
|  | S/T                  | 0.96  | 0.96 | 0.96  | 0.77 | 0.54 | 0.96 | 0.96 | 0.96  | 0.82 | 0.57 | 0.96 | 0.96 | 0.96  | 0.86 | 0.59 |
|  | AMPS*                | 20.5  | 20.5 | 20.5  | 20.9 | 21.1 | 20.8 | 20.9 | 20.9  | 21.2 | 21.5 | 21.2 | 21.3 | 21.3  | 21.6 | 22.0 |
|  | HI PR                | 355   | 355  | 355   | 359  | 365  | 357  | 357  | 357   | 360  | 366  | 359  | 359  | 359   | 361  | 367  |
|  | LO PR                | 81  | 81   | 81    | 86   | 93   | 84   | 84   | 84    | 88   | 95   | 87   | 87   | 87    | 89   | 96   |
| Air Delivery in CFM - Dry Coil - No Filter (Add .05 Static Press for Wet Coil) |                      |   |      |       |      |      |      |      |       |      |      |      |      |       |      |      |
| Speed Tap  |                      | External Static Pressure (Inch Water Col)         |      |       |      |      |      |      |       |      |      |      |      |       |      |      |
|  |                      | 0.1   | 0.2  | 0.3   | 0.4  | 0.5  | 0.6  | 0.7  | 0.8   | 0.9  | 1.0  |      |      |       |      |      |
| 1  |                      | 1138  | 1087 | 1041  | 989  | 940  | 885  | 806  | 752   | 694  | 646  |      |      |       |      |      |
| 2  |                      | 1240  | 1189 | 1145  | 1104 | 1063 | 1010 | 952  | 891   | 828  | 773  |      |      |       |      |      |
| 3  |                      | 1505  | 1467 | 1431  | 1398 | 1363 | 1324 | 1283 | 1234  | 1175 | 1120 |      |      |       |      |      |
| 4  |                      | 1643  | 1609 | 1577  | 1541 | 1509 | 1476 | 1439 | 1402  | 1352 | 1264 |      |      |       |      |      |
| 5  |                      | -   | -    | -     | -    | -    | -    | -    | -     | -    | -    |      |      |       |      |      |

Notes: When the required data fall between the published data, interpolation may be performed. Extrapolation is not an acceptable practice.  
† Total capacities are net capacities. Blower heat has been subtracted  
‡ At TVA rating indoor condition (75°F db/ 63°F wb), All other indoor air temperatures are at 80°F db  
\* System amps is total unit amps

50CU500269 - 2.0

|  |                      | PHF34800K00A1                                     |      |      |      |      |      |      |      |      |      |      |      |      |      |      |
|--|----------------------|---|------|------|------|------|------|------|------|------|------|------|------|------|------|------|
|  |                      | 1400  |      |      |      |      | 1600 |      |      |      |      | 1800 |      |      |      |      |
|  |                      | Entering Indoor Temperature - Degrees F, Wet Bulb |      |      |      |      |      |      |      |      |      |      |      |      |      |      |
| OD Ambient<br>(°F) db  | ID Airflow<br>(SCFM) | 57  | 62   | 63 † | 67   | 72   | 57   | 62   | 63 † | 67   | 72   | 57   | 62   | 63 † | 67   | 72   |
|  |                      | 75  | MBh† | 42.4 | 43.6 | 44.3 | 47.7 | 52.3 | 44.4 | 44.8 | 45.3 | 48.7 | 53.4 | 46.0 | 46.0 | 46.1 |
|  | S/T                  | 0.98  | 0.91 | 0.72 | 0.70 | 0.51 | 0.98 | 0.95 | 0.76 | 0.73 | 0.53 | 0.98 | 0.98 | 0.79 | 0.77 | 0.55 |
|  | AMPS*                | 15.6  | 15.6 | 15.6 | 15.7 | 15.9 | 15.9 | 15.9 | 15.9 | 16.1 | 16.2 | 16.3 | 16.3 | 16.3 | 16.4 | 16.6 |
|  | HI PR                | 195   | 196  | 196  | 200  | 205  | 197  | 197  | 198  | 202  | 207  | 199  | 199  | 199  | 203  | 208  |
|  | LO PR                | 72  | 74   | 75   | 82   | 90   | 76   | 76   | 77   | 84   | 92   | 79   | 79   | 79   | 85   | 94   |
| 85   | MBh†                 | 41.2  | 42.0 | 42.6 | 45.9 | 50.5 | 43.0 | 43.2 | 43.6 | 46.9 | 51.5 | 44.5 | 44.6 | 44.4 | 47.7 | 52.3 |
|  | S/T                  | 0.98  | 0.92 | 0.73 | 0.71 | 0.52 | 0.98 | 0.97 | 0.77 | 0.75 | 0.54 | 0.98 | 0.98 | 0.80 | 0.78 | 0.56 |
|  | AMPS*                | 17.1  | 17.1 | 17.1 | 17.2 | 17.4 | 17.4 | 17.4 | 17.4 | 17.5 | 17.7 | 17.8 | 17.8 | 17.8 | 17.9 | 18.1 |
|  | HI PR                | 223   | 224  | 224  | 228  | 234  | 225  | 225  | 226  | 230  | 235  | 227  | 227  | 226  | 231  | 236  |
|  | LO PR                | 74  | 75   | 76   | 83   | 91   | 77   | 78   | 78   | 85   | 93   | 80   | 80   | 80   | 86   | 95   |
| 95   | MBh†                 | 39.8  | 40.4 | 40.9 | 44.1 | 48.5 | 41.6 | 41.6 | 41.8 | 44.5 | 49.4 | 43.0 | 43.1 | 42.5 | 45.7 | 50.2 |
|  | S/T                  | 0.98  | 0.94 | 0.75 | 0.72 | 0.52 | 0.98 | 0.98 | 0.78 | 0.76 | 0.54 | 0.98 | 0.98 | 0.82 | 0.80 | 0.57 |
|  | AMPS*                | 18.7  | 18.7 | 18.7 | 18.9 | 19.0 | 19.1 | 19.1 | 19.2 | 19.3 | 19.3 | 19.5 | 19.5 | 19.4 | 19.6 | 19.7 |
|  | HI PR                | 253   | 254  | 255  | 259  | 264  | 256  | 256  | 256  | 260  | 266  | 258  | 258  | 257  | 261  | 267  |
|  | LO PR                | 75  | 76   | 77   | 84   | 92   | 79   | 79   | 79   | 86   | 94   | 82   | 82   | 81   | 87   | 96   |
| 105  | MBh†                 | 38.4  | 38.7 | 39.1 | 42.2 | 46.4 | 40.1 | 40.1 | 40.0 | 43.0 | 47.3 | 41.4 | 41.5 | 40.6 | 43.7 | 48.0 |
|  | S/T                  | 0.98  | 0.96 | 0.76 | 0.74 | 0.53 | 0.98 | 0.98 | 0.80 | 0.78 | 0.55 | 0.98 | 0.98 | 0.84 | 0.82 | 0.58 |
|  | AMPS*                | 20.5  | 20.5 | 20.5 | 20.6 | 20.8 | 20.9 | 20.9 | 20.8 | 21.0 | 21.1 | 21.3 | 21.3 | 21.2 | 21.3 | 21.5 |
|  | HI PR                | 287   | 288  | 288  | 292  | 298  | 290  | 290  | 289  | 294  | 299  | 292  | 292  | 290  | 295  | 300  |
|  | LO PR                | 77  | 78   | 78   | 85   | 93   | 81   | 81   | 80   | 87   | 95   | 84   | 84   | 82   | 88   | 97   |
| 115  | MBh†                 | 36.9  | 37.0 | 37.3 | 40.2 | 44.3 | 38.5 | 38.5 | 38.1 | 41.0 | 45.1 | 39.8 | 39.8 | 38.7 | 41.6 | 45.7 |
|  | S/T                  | 0.98  | 0.98 | 0.78 | 0.75 | 0.54 | 0.98 | 0.98 | 0.82 | 0.80 | 0.56 | 0.98 | 0.98 | 0.86 | 0.84 | 0.59 |
|  | AMPS*                | 22.4  | 22.4 | 22.4 | 22.6 | 22.7 | 22.8 | 22.8 | 22.8 | 22.9 | 23.1 | 23.2 | 23.2 | 23.1 | 23.3 | 23.4 |
|  | HI PR                | 324   | 324  | 324  | 328  | 334  | 326  | 326  | 325  | 330  | 335  | 328  | 328  | 326  | 331  | 336  |
|  | LO PR                | 79  | 79   | 80   | 86   | 95   | 82   | 83   | 81   | 88   | 96   | 85   | 86   | 83   | 89   | 98   |
| 125  | MBh†                 | -   | -    | -    | -    | -    | -    | -    | -    | -    | -    | -    | -    | -    | -    | -    |
|  | S/T                  | -   | -    | -    | -    | -    | -    | -    | -    | -    | -    | -    | -    | -    | -    | -    |
|  | AMPS*                | -   | -    | -    | -    | -    | -    | -    | -    | -    | -    | -    | -    | -    | -    | -    |
|  | HI PR                | -   | -    | -    | -    | -    | -    | -    | -    | -    | -    | -    | -    | -    | -    | -    |
|  | LO PR                | -   | -    | -    | -    | -    | -    | -    | -    | -    | -    | -    | -    | -    | -    | -    |
| Air Delivery in CFM - Dry Coil - No Filter (Add .05 Static Press for Wet Coil) |                      |   |      |      |      |      |      |      |      |      |      |      |      |      |      |      |
| Speed Tap  |                      | External Static Pressure (Inch Water Col)         |      |      |      |      |      |      |      |      |      |      |      |      |      |      |
|  |                      | 0.1   | 0.2  | 0.3  | 0.4  | 0.5  | 0.6  | 0.7  | 0.8  | 0.9  | 1.0  |      |      |      |      |      |
| 1  |                      | 1154  | 1084 | 1005 | 940  | 880  | 832  | 780  | 713  | 663  | 613  |      |      |      |      |      |
| 2  |                      | 1245  | 1170 | 1110 | 1034 | 972  | 924  | 875  | 836  | 773  | 720  |      |      |      |      |      |
| 3  |                      | 1750  | 1696 | 1643 | 1592 | 1547 | 1497 | 1443 | 1400 | 1354 | 1302 |      |      |      |      |      |
| 4  |                      | 1908  | 1864 | 1819 | 1770 | 1720 | 1678 | 1632 | 1586 | 1538 | 1494 |      |      |      |      |      |
| 5  |                      | -   | -    | -    | -    | -    | -    | -    | -    | -    | -    |      |      |      |      |      |

Notes: When the required data fall between the published data, interpolation may be performed. Extrapolation is not an acceptable practice.  
† Total capacities are net capacities. Blower heat has been subtracted  
†† At TVA rating indoor condition (75°F db/ 63°F wb), All other indoor air temperatures are at 80°F db  
\* System amps is total unit amps

50C U 500270 - 2.0

# PHF324 - 42

**SCHEMATIC  
208/230-1-60**

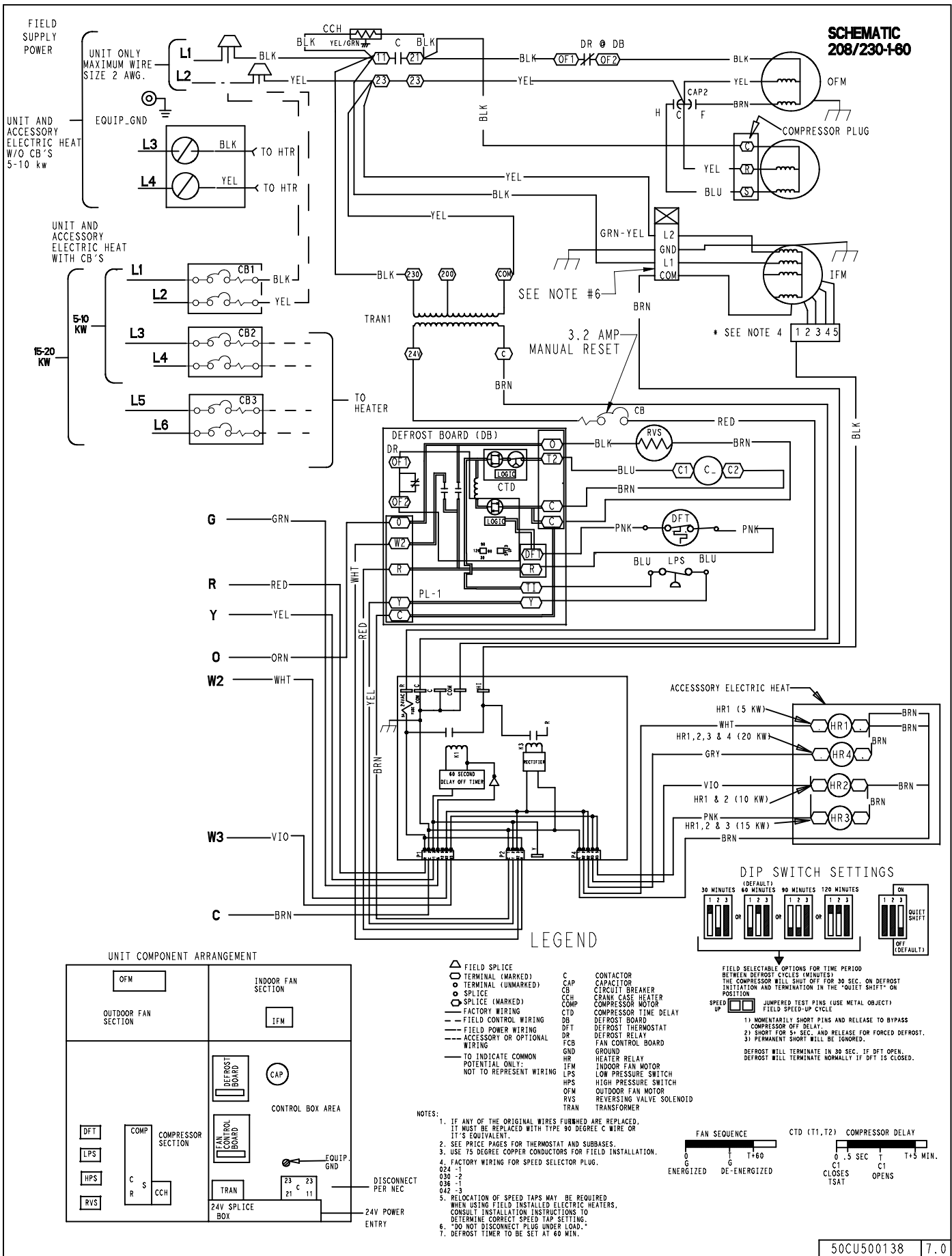

50CU500138 7.0



# PHF348

**SCHEMATIC  
208/230-1-60**

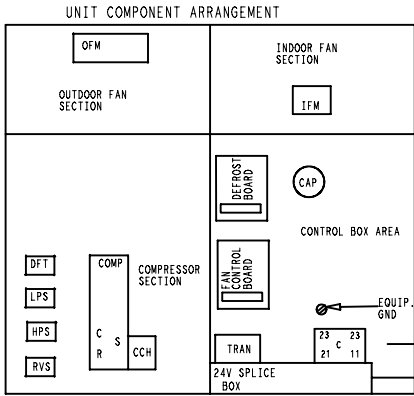
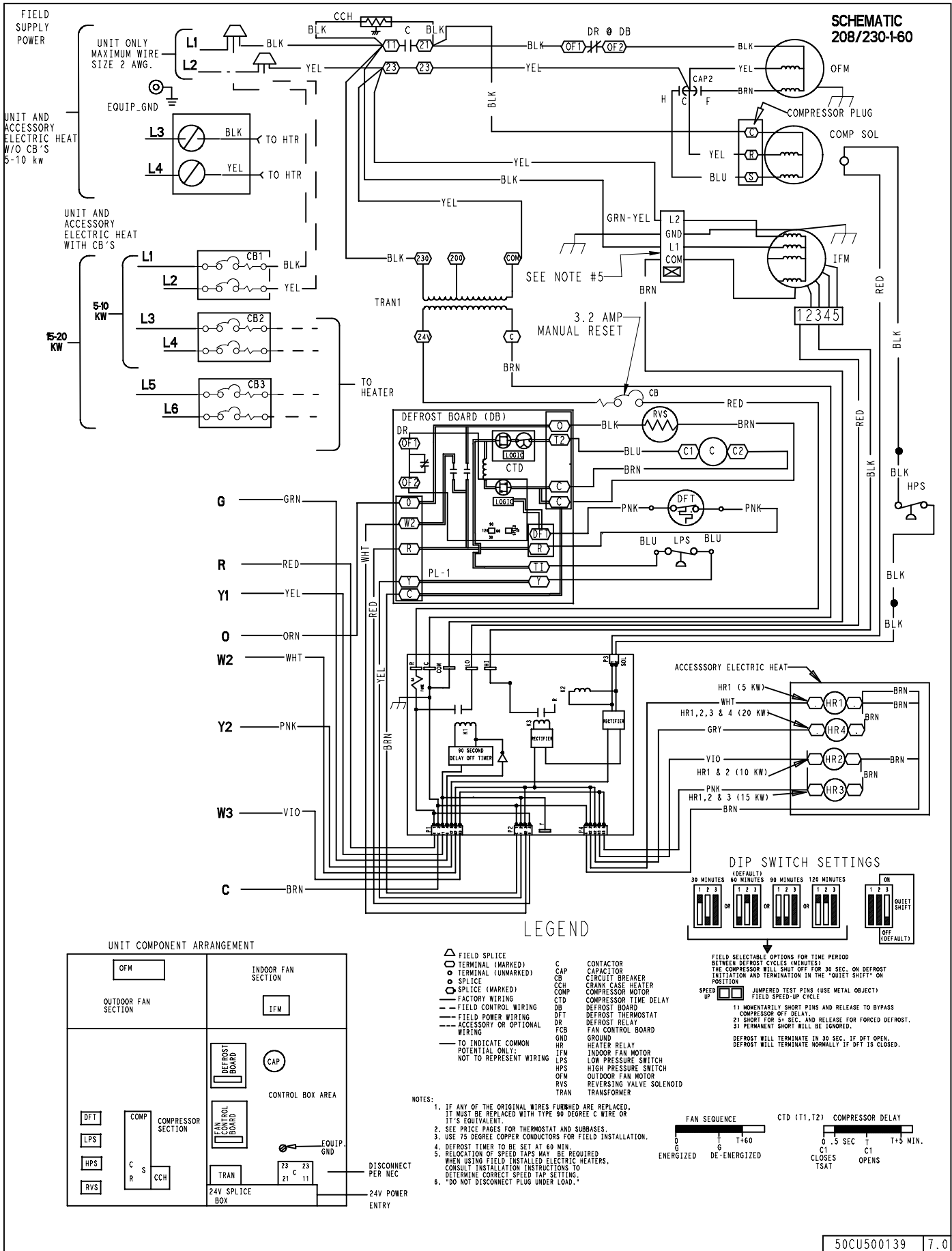

- LEGEND**
- △ FIELD SPLICE
  - TERMINAL (MARKED)
  - TERMINAL (UNMARKED)
  - SPLICE
  - SPLICE (MARKED)
  - FACTORY WIRING
  - FIELD CONTROL WIRING
  - FIELD POWER WIRING
  - - - ACCESSORY OR OPTIONAL WIRING
  - TO INDICATE COMMON POTENTIAL ONLY; NOT TO REPRESENT WIRING
  - C CONTACTOR
  - CAP CAPACITOR
  - CB CIRCUIT BREAKER
  - CCH CRANK CASE HEATER
  - COMP COMPRESSOR MOTOR
  - CTD COMPRESSOR TIME DELAY
  - DB DEFROST BOARD
  - DFT DEFROST THERMOSTAT
  - DR DEFROST RELAY
  - FCB FAN CONTROL BOARD
  - GND GROUND
  - HR HEATER RELAY
  - IFM INDOOR FAN MOTOR
  - LPS LOW PRESSURE SWITCH
  - HPS HIGH PRESSURE SWITCH
  - OFM OUTDOOR FAN MOTOR
  - RVS REVERSING VALVE SOLENOID
  - TRAN TRANSFORMER

- NOTES:**
- IF ANY OF THE ORIGINAL WIRES FURNISHED ARE REPLACED, IT MUST BE REPLACED WITH TYPE 90 DEGREE C WIRE OR IT'S EQUIVALENT.
  - SEE PRICE PAGES FOR THERMOSTAT AND SUBBASES.
  - USE 75 DEGREE COPPER CONDUCTORS FOR FIELD INSTALLATION.
  - DEFROST TIMER TO BE SET AT 60 MIN.
  - RELOCATION OF SPEED TAPS MAY BE REQUIRED WHEN USING FIELD INSTALLED ELECTRIC HEATERS. CONSULT INSTALLATION INSTRUCTIONS TO DETERMINE CORRECT SPEED TAP SETTING.
  - DO NOT DISCONNECT PLUG UNDER LOAD.

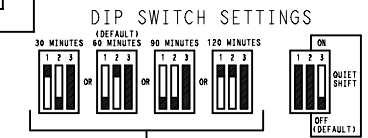

FIELD SELECTABLE OPTIONS FOR TIME PERIOD BETWEEN DEFROST CYCLES (MINUTES). THE COMPRESSOR WILL SHUT OFF FOR 30 SEC. ON DEFROST INITIATION AND TERMINATION IN THE "QUIET SHIFT" ON POSITION.

SPEED UP JUMPED TEST PINS (USE METAL OBJECT) FIELD SPEED-UP CYCLE

- MOMENTARILY SHORT PINS AND RELEASE TO BYPASS COMPRESSOR OFF DELAY.
- SHORT FOR 54 SEC. AND RELEASE FOR FORCED DEFROST.
- PERMANENT SHORT WILL BE IGNORED.

DEFROST WILL TERMINATE IN 30 SEC. IF DFT OPEN. DEFROST WILL TERMINATE NORMALLY IF DFT IS CLOSED.

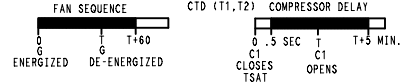

50CU500139 7.0