

Parts List Tech Labels Wiring Diagrams

Models

Single Phase

PHAD24N1K4	PYMC24G4
PHAD30N1K4	PYMC30G4
PHAD36N1K4	PYMC36G4
PHAD42N1K4	PYMC42G4
PHAD47N1K4	PYMC48G4
PHAD60N1K4	PYMC60G4

Single Package Heat Pumps

Save This Manual For Future Reference

Balance Chart 2 Ton 12 SEER Package Heat Pump

Heating Capacity Balance Chart

Balance Chart Performance based on 230V Operation

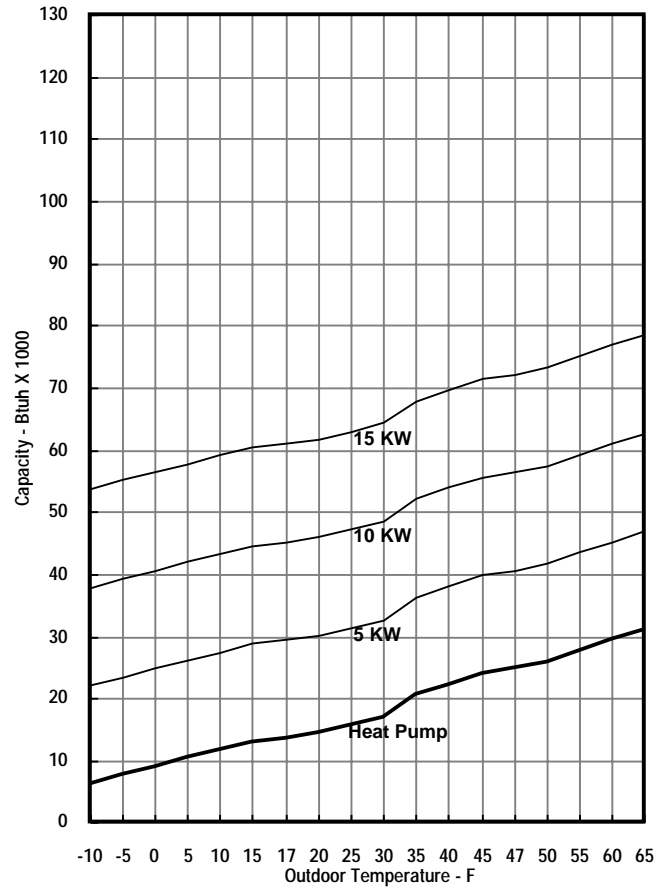

Tech Data

Style No:		2 Ton Pkg. H.P.		Outdoor Ambient Temperature - Degrees F. Dry Bulb																																																																							
Voltage		208-230		75				85				95				105				115																																																							
Phase/Cycles		1 -- 60		Entering Indoor Temperature - Degrees F. Wet Bulb																																																																							
Ampacity		20.2		59				63				67				71				59				63				67				71																																											
Wire Ga/Length	NEC			MBh				S/T				AMPS				HI PR				LO PR				MBh				S/T				AMPS				HI PR				LO PR																																			
Delay Fuse	25			22.5 23.2 25.1 26.9				22.0 22.6 24.5 26.3				21.4 22.1 23.9 25.6				20.3 21.0 22.7 24.3				18.8 19.4 21.0 22.5				22.9 23.4 25.0 26.7				22.3 22.8 24.4 26.1				21.8 22.3 23.8 25.4				20.7 21.2 22.6 24.2				19.2 19.6 20.9 22.4																																			
Max. Fuse/HACR	30			0.85 0.76 0.57 0.37				0.87 0.78 0.59 0.38				0.90 0.80 0.61 0.39				0.93 0.83 0.63 0.40				0.94 0.84 0.63 0.41				0.93 0.87 0.71 0.53				0.95 0.89 0.73 0.54				0.98 0.92 0.75 0.56				1.00 0.96 0.78 0.58				1.00 0.96 0.78 0.59																																			
Compressor	COPELAND			7.2 7.3 7.6 7.8				7.8 8.0 8.2 8.5				8.3 8.5 8.8 9.1				8.8 9.0 9.3 9.7				9.3 9.6 9.9 10.2				158 170 180 187				180 193 204 213				205 220 233 243				230 248 262 273				254 274 289 302																																			
RLA	12.9			64 68 74 79				67 71 77 82				70 74 81 86				73 78 85 91				76 81 88 94				65 69 75 80				67 72 78 83				71 75 82 87				74 79 86 92				77 81 89 95																																			
LRA	62.5			22.9 23.4 25.0 26.7				22.3 22.8 24.4 26.1				21.8 22.3 23.8 25.4				20.7 21.2 22.6 24.2				19.2 19.6 20.9 22.4				0.97 0.94 0.85 0.69				1.00 0.96 0.87 0.71				1.00 0.99 0.90 0.73				1.00 1.00 0.93 0.76				1.00 1.00 0.94 0.76																																			
Cap MFD/V	40 / 370			160 172 181 189				182 195 206 215				207 223 235 245				233 250 264 276				257 277 292 305				7.3 7.5 7.7 8.0				7.9 8.1 8.4 8.7				8.4 8.6 8.9 9.3				9.0 9.2 9.5 9.9				9.5 9.7 10.1 10.4																																			
CC Heater	N/A			65 69 75 80				67 72 78 83				71 75 82 87				74 79 86 92				77 81 89 95				23.3 23.7 24.9 26.5				22.7 23.2 24.3 25.9				22.2 22.6 23.7 25.3				21.1 21.5 22.5 24.0				19.5 19.9 20.8 22.2																																			
Start Kit	NAMA001SC			23.6 23.1 22.7 22.3 2.20 2.18				2.14 2.09 2.11 2.06 2.02 1.99				2.06 2.02 1.99 1.97 1.93 1.88				1.84 1.79 1.75				12.9 11.9 11.1 10.5 10.1 9.9				9.3 8.9 8.5 8.1 7.7 7.5				7.4 7.0 6.6 6.2 5.7 5.1				3.92 3.77 3.58 3.41 3.30 3.22				3.03 2.83 2.60 2.38 2.15 2.00				1.94 1.79 1.62 1.45 1.27 1.06																																			
Cond & Evap	Cond	Evap		Outdoor Ambient Temperature - Degrees F. Dry Bulb																																																																							
Type	Fan	Blower		65				60				55				50				47				45				40				35				30				25				20				17				15				10				5				0				-5				-10			
Size	20	DD10-8A		31.6 29.8 27.8 26.0 24.8 24.0				22.1 20.3 18.8 16.8 14.8 13.6				13.1 11.8 10.4 9.1 7.8 6.4				36.6 34.5 32.2 30.1 28.7 27.8				25.6 23.5 21.7 19.4 17.1 15.7				15.2 13.6 12.1 10.5 9.0 7.4				2.36 2.31 2.27 2.23 2.20 2.18				2.14 2.09 2.11 2.06 2.02 1.99				2.06 2.02 1.99 1.97 1.93 1.88				1.84 1.79 1.75				12.9 11.9 11.1 10.5 10.1 9.9				9.3 8.9 8.5 8.1 7.7 7.5				7.4 7.0 6.6 6.2 5.7 5.1				3.92 3.77 3.58 3.41 3.30 3.22				3.03 2.83 2.60 2.38 2.15 2.00				1.94 1.79 1.62 1.45 1.27 1.06											
Motor-HP	1/3 PSC	1/3 PSC		12.9 11.9 11.1 10.5 10.1 9.9				9.3 8.9 8.5 8.1 7.7 7.5				7.4 7.0 6.6 6.2 5.7 5.1				3.92 3.77 3.58 3.41 3.30 3.22				3.03 2.83 2.60 2.38 2.15 2.00				1.94 1.79 1.62 1.45 1.27 1.06				13.4 12.9 12.2 11.7 11.3 11.0				10.3 9.7 8.9 8.1 7.3 6.8				6.6 6.1 5.5 4.9 4.3 3.6				258 247 238 227 222 218				209 201 192 184 176 172				169 163 157 150 145 140				80 74 69 63 60 58				53 47 43 38 33 31				30 25 22 18 16 13															
Type	PSC	PSC		Heating																																																																							
FLA	1.4	2.6		Air Delivery in CFM - Dry Coil (Add .08 static W/Internal Filters - Subtract 25 CFM for Wet Coil)																																																																							
LRA	3.57	4		230 Volt																208 Volt																																																							
RPM	1155	1100		Motor Speed																Motor Speed																																																							
Cap MFD/V	5 / 370	7.5 / 370		External Static Pressure (Inch Water Column)																External Static Pressure (Inch Water Column)																																																							
PTCR	N/A	N/A		0.10 0.20 0.30 0.40 0.50 0.60 0.70																0.10 0.20 0.30 0.40 0.50 0.60 0.70																																																							
Hi Press	N/A	N/A		1314 1282 1243 1196 1142 1080 1010																1178 1156 1127 1090 1049 988 919																																																							
Low Press	N/A	N/A		1077 1062 1041 1012 971 916 844																927 919 904 883 849 797 735																																																							
Low Amb	N/A	N/A		1020 1007 987 957 917 864 796																870 864 853 832 799 757 692																																																							
Low Charge Sw	20 - 50			825 816 801 780 749 707 653																696 689 677 660 632 591 542																																																							
Defrost	Timed																																																																										
Sensor	31/71																																																																										
Operating Chg	(R-22 Oz)																																																																										
	120																																																																										
Service Driers																																																																											
Liquid/Chg	8 Cu In / 7 oz																																																																										
Suction	30 Sq In																																																																										
Unit Weight	394																																																																										

Part No:
1083498

Balance Chart

2 1/2 Ton 12 SEER Package Heat Pump

Heating Capacity Balance Chart

Balance Chart Performance based on 230V Operation

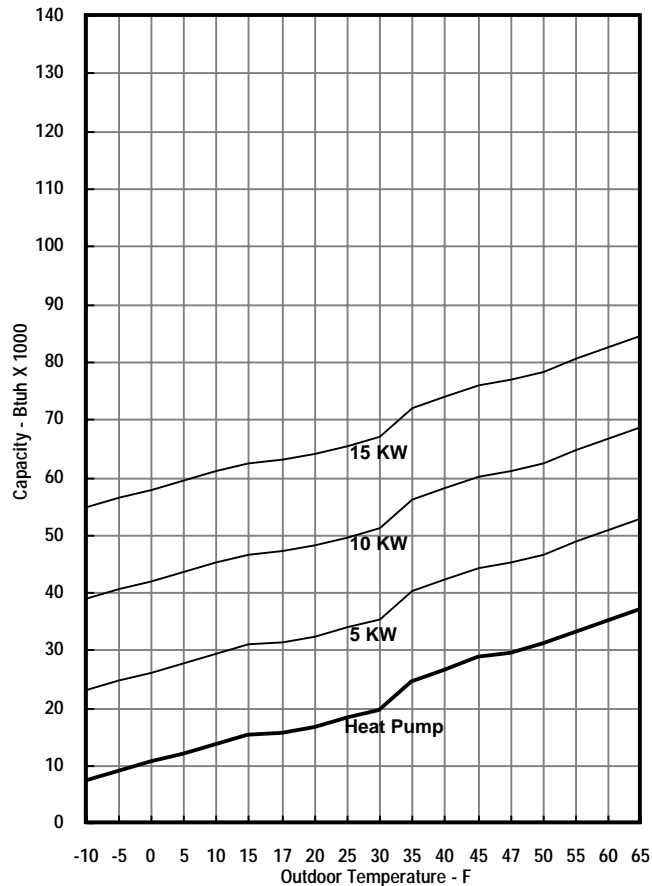

Tech Data

Style No:		2-1/2 Ton Pkg. H.P.		Outdoor Ambient Temperature - Degrees F. Dry Bulb																			
				75				85				95				105				115			
				Entering Indoor Temperature - Degrees F. Wet Bulb																			
		IDB		59	63	67	71	59	63	67	71	59	63	67	71	59	63	67	71	59	63	67	71
Voltage	208-230			MBh				S/T				AMPS				HI PR				LO PR			
Phase/Cycles	1 -- 60			28.2 29.0 31.4 33.7				27.5 28.3 30.6 32.9				26.8 27.6 29.9 32.1				25.5 26.2 28.4 30.5				23.6 24.3 26.3 28.2			
Ampacity	23			0.85 0.76 0.57 0.37				0.87 0.78 0.59 0.38				0.90 0.80 0.61 0.39				0.93 0.83 0.63 0.40				0.94 0.84 0.63 0.41			
Wire Ga/Length	NEC			9.5 9.7 10.0 10.4				10.3 10.5 10.9 11.3				11.0 11.3 11.6 12.1				11.7 12.0 12.4 12.9				12.4 12.7 13.1 13.6			
Delay Fuse	30			169 182 193 201				193 207 219 228				220 236 249 260				247 266 281 293				273 294 310 323			
Max. Fuse/HACR	35			66 70 76 81				68 73 79 84				72 76 83 89				75 80 87 93				78 83 90 96			
Compressor	COPELAND			MBh				S/T				AMPS				HI PR				LO PR			
RLA	15.2			28.7 29.3 31.3 33.4				28.0 28.6 30.5 32.7				27.3 27.9 29.8 31.9				25.9 26.5 28.3 30.3				24.0 24.5 26.2 28.0			
LRA	76			0.93 0.87 0.71 0.53				0.95 0.89 0.73 0.54				0.98 0.92 0.75 0.56				1.00 0.96 0.78 0.58				1.00 0.96 0.78 0.59			
Cap MFD/V	45 / 370			9.5 9.8 10.1 10.5				10.4 10.6 11.0 11.4				11.1 11.4 11.8 12.2				11.8 12.1 12.5 13.0				12.5 12.8 13.3 13.8			
CC Heater	N/A			171 184 195 203				195 210 221 231				222 239 252 263				249 268 284 296				276 297 313 327			
Start Kit	NAMA001SC			66 70 77 82				69 73 80 85				72 77 84 89				76 81 88 94				78 83 91 97			
Cond & Evap	Cond	Evap		MBh				S/T				AMPS				HI PR				LO PR			
Type	Fan	Blower		29.2 29.7 31.1 33.2				28.5 29.0 30.4 32.4				27.8 28.3 29.7 31.6				26.4 26.9 28.2 30.1				24.4 24.9 26.1 27.8			
Size	20	DD10-8A		0.97 0.94 0.85 0.69				1.00 0.96 0.87 0.71				1.00 0.99 0.90 0.73				1.00 1.00 0.93 0.76				1.00 1.00 0.94 0.76			
Motor-HP	1/3 PSC	1/3 PSC		9.6 9.9 10.2 10.6				10.5 10.7 11.1 11.5				11.2 11.5 11.9 12.3				11.9 12.2 12.6 13.1				12.6 13.0 13.4 13.9			
Type	PSC	PSC		173 186 196 205				197 212 223 233				224 241 255 265				252 271 286 299				278 300 316 330			
FLA	1.4	2.6		67 71 78 83				70 74 81 86				73 78 85 90				77 81 89 95				79 84 92 98			
LRA	3.57	4																					
RPM	1155	1100																					
Cap MFD/V	5 / 370	7.5 / 370																					
PTCR	N/A																						
Hi Press	N/A																						
Low Press	N/A																						
Low Amb	N/A																						
Low Charge Sw	20 - 50																						
Defrost	Timed																						
Sensor	31 / 71																						
Operating Chg	(R-22 Oz)																						
	130																						
Service Driers																							
Liquid/Chg	8 Cu In / 7 oz																						
Suction	30 Sq In																						
Unit Weight	401																						
				Air Delivery in CFM - Dry Coil (Add .08 static W/Internal Filters - Subtract 25 CFM for Wet Coil)																			
				230 Volt								208 Volt								*** Do Not Operate on Low Speed			
				External Static Pressure (Inch Water Column)								External Static Pressure (Inch Water Column)											
				Motot Speed								Motot Speed											
				0.10 0.20 0.30 0.40 0.50 0.60 0.70								0.10 0.20 0.30 0.40 0.50 0.60 0.70											
				HI								HI											
				MD HI								MD HI											
				MD LO								MD LO											
				LO								LO											
				***								***											
				***								***								Part No: 1083499			

Balance Chart 3 Ton 12 SEER Package Heat Pump

Heating Capacity Balance Chart

Balance Chart Performance based on 230V Operation

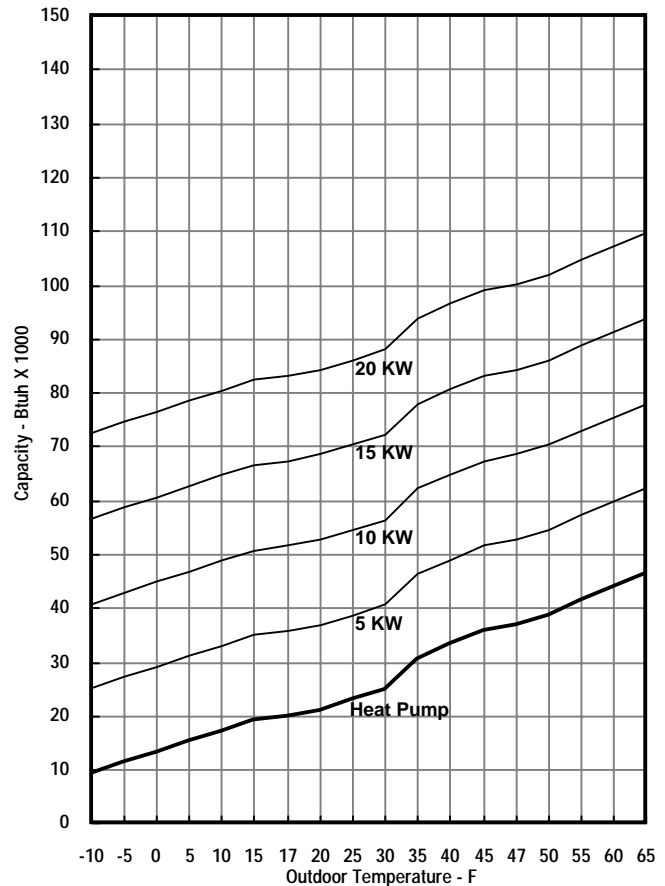

Tech Data

Style No:	3 Ton Pkg. H.P.		Outdoor Ambient Temperature - Degrees F. Dry Bulb																					
			75				85				95				105				115					
			Entering Indoor Temperature - Degrees F. Wet Bulb																					
Voltage	208-230		IDB		59	63	67	71	59	63	67	71	59	63	67	71	59	63	67	71	59	63	67	71
Phase/Cycles	1 -- 60		75	MBh	33.3	34.2	37.1	39.8	32.5	33.4	36.2	38.8	31.7	32.6	35.3	37.9	30.1	31.0	33.5	36.0	27.9	28.7	31.1	33.3
Ampacity	27.4			S/T	0.86	0.77	0.58	0.37	0.88	0.79	0.60	0.38	0.91	0.81	0.61	0.40	0.94	0.84	0.64	0.41	0.95	0.85	0.64	0.41
Wire Ga/Length	NEC			AMPS	11.1	11.4	11.7	12.2	12.1	12.3	12.7	13.2	12.9	13.2	13.6	14.1	13.7	14.0	14.5	15.0	14.5	14.8	15.3	15.9
Delay Fuse	35			HI PR	172	185	195	203	195	210	222	231	222	239	252	263	250	269	284	296	276	297	314	327
Max. Fuse/HACR	45		LO PR	65	69	75	80	67	72	78	83	71	75	82	88	74	79	86	92	77	82	89	95	
Compressor	COPELAND		80	MBh	33.9	34.6	37.0	39.5	33.0	33.8	36.1	38.6	32.2	32.9	35.2	37.6	30.6	31.3	33.4	35.7	28.4	29.0	31.0	33.1
RLA	17.9			S/T	0.94	0.88	0.72	0.54	0.96	0.90	0.74	0.55	1.00	0.93	0.76	0.57	1.00	0.97	0.79	0.59	1.00	0.98	0.80	0.59
LRA	90.5			AMPS	11.2	11.5	11.8	12.3	12.2	12.5	12.9	13.3	13.0	13.3	13.7	14.2	13.8	14.1	14.6	15.1	14.6	15.0	15.5	16.0
Cap MFD/V	50 / 370			HI PR	173	186	197	205	197	212	224	234	224	241	255	266	252	272	287	299	279	300	317	331
CC Heater	N/A		LO PR	65	70	76	81	68	72	79	84	71	76	83	88	75	80	87	93	77	82	90	96	
Start Kit	NAMA001SC		85	MBh	34.4	35.1	36.8	39.2	33.6	34.3	35.9	38.3	32.8	33.4	35.0	37.4	31.2	31.8	33.3	35.5	28.9	29.4	30.8	32.9
Cond & Evap	Cond	Evap		S/T	0.99	0.95	0.86	0.70	1.00	0.98	0.88	0.71	1.00	1.00	0.91	0.74	1.00	1.00	0.94	0.77	1.00	1.00	0.95	0.77
Type	Fan	Blower		AMPS	11.3	11.6	12.0	12.4	12.3	12.6	13.0	13.5	13.1	13.4	13.9	14.4	13.9	14.3	14.7	15.3	14.7	15.1	15.6	16.2
Size	20	DD11-9A		HI PR	175	188	199	207	199	214	226	236	227	244	258	269	255	274	290	302	282	303	320	334
Motor-HP	1/3 PSC	1/2 PSC	LO PR	66	70	77	82	69	73	80	85	72	77	84	89	76	80	88	94	78	83	91	97	
Type	PSC	PSC	Heating		Outdoor Ambient Temperature - Degrees F. Dry Bulb																			
FLA	1.4	3.6	70	MBh	47.1	44.5	41.5	38.7	37.0	35.9	33.0	30.3	27.6	24.7	21.8	20.0	19.3	17.3	15.3	13.4	11.4	9.3		
LRA	3.57	7.8		T/R	36.4	34.3	32.0	29.9	28.5	27.7	25.5	23.4	21.3	19.0	16.8	15.4	14.9	13.3	11.8	10.3	8.8	7.2		
RPM	1155	1125		KW	3.40	3.34	3.28	3.22	3.19	3.16	3.10	3.04	3.09	3.02	2.96	2.93	2.90	2.84	2.77	2.71	2.65	2.59		
Cap MFD/V	5 / 370	15 / 370		AMPS	19.0	17.6	16.4	15.5	14.9	14.6	13.8	13.1	12.5	12.0	11.4	11.1	11.0	10.4	9.7	9.1	8.4	7.6		
PTCR	N/A	N/A	70	COP	4.06	3.90	3.70	3.52	3.40	3.32	3.11	2.91	2.61	2.39	2.15	2.00	1.94	1.78	1.62	1.44	1.26	1.06		
Hi Press	N/A	N/A		EER	13.9	13.3	12.6	12.0	11.6	11.3	10.6	10.0	8.9	8.2	7.3	6.8	6.6	6.1	5.5	4.9	4.3	3.6		
Low Press	N/A	N/A		HI PR	252	242	232	222	217	213	205	196	188	180	173	168	165	159	153	147	141	136		
Low Amb	N/A	N/A		LO PR	76	70	66	60	57	55	50	45	41	36	32	30	29	24	21	18	15	12		
Low Charge Sw	20 - 50		Air Delivery in CFM - Dry Coil (Add .08 static W/Internal Filters - Subtract 25 CFM for Wet Coil)																					
Defrost	Timed		230 Volt				External Static Pressure (Inch Water Column)				208 Volt				External Static Pressure (Inch Water Column)									
Sensor	31 / 71		Motot Speed		0.10	0.20	0.30	0.40	0.50	0.60	0.70	Motot Speed		0.10	0.20	0.30	0.40	0.50	0.60	0.70				
Operating Chg	(R-22 Oz)		HI		1602	1547	1489	1428	1363	1291	1211	HI		1541	1490	1435	1380	1315	1237	1159				
Each Circuit	135		MD HI		1518	1468	1416	1358	1295	1226	1148	MD HI		1424	1380	1333	1287	1230	1155	1078				
Service Driers	16 Cu In / 11 oz		MD LO		1459	1413	1364	1311	1252	1185	1109	MD LO		1347	1308	1264	1220	1165	1094	1020				
Liquid/Chg	30 Sq In		LO		1339	1299	1255	1204	1147	1084	1015	LO		1192	1163	1130	1095	1050	987	916				
Suction			Part No: 1083500																					
Unit Weight	410																							

2 THRU 4 TON MODELS

CONNECTION WIRING DIAGRAM

DANGER: ELECTRICAL SHOCK HAZARD DISCONNECT POWER BEFORE SERVICING

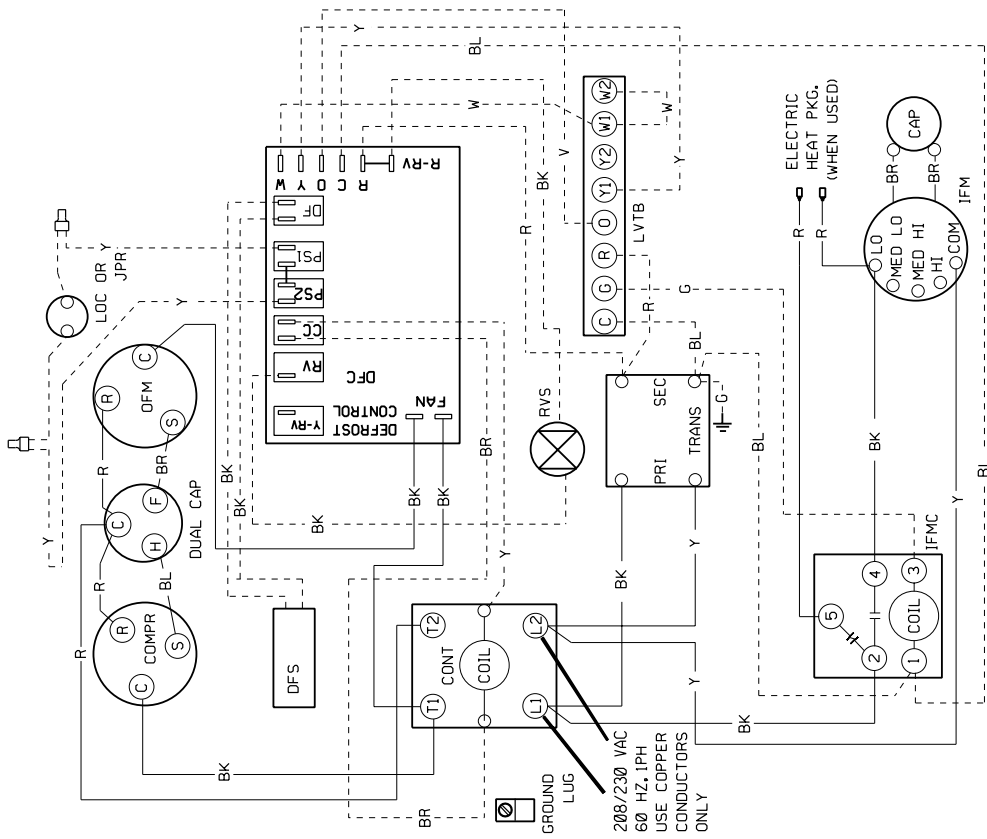

IF ANY OF THE ORIGINAL WIRE AS SUPPLIED WITH THE APPLIANCE MUST BE REPLACED, IT MUST BE REPLACED WITH TYPE AWG-105°C OR ITS EQUIVALENT.

• SEE INSTALLATION INSTRUCTIONS FOR PROPER HEATING AND COOLING CONNECTIONS FOR YOUR UNIT

LINE VOLTAGE	VOLTAGE FACTORY	COLOR CODE	G	W	Y
—	—	BLACK	BK	GREEN	GR
—	—	BLUE	BL	ORANGE	OR
—	—	BROWN	BR	RED	RD
—	—	GRAY	GY	VIOLET	VI
—	—			WHITE	WH
—	—			YELLOW	YL

LADDER WIRING DIAGRAM

DANGER: ELECTRICAL SHOCK HAZARD DISCONNECT POWER BEFORE SERVICING

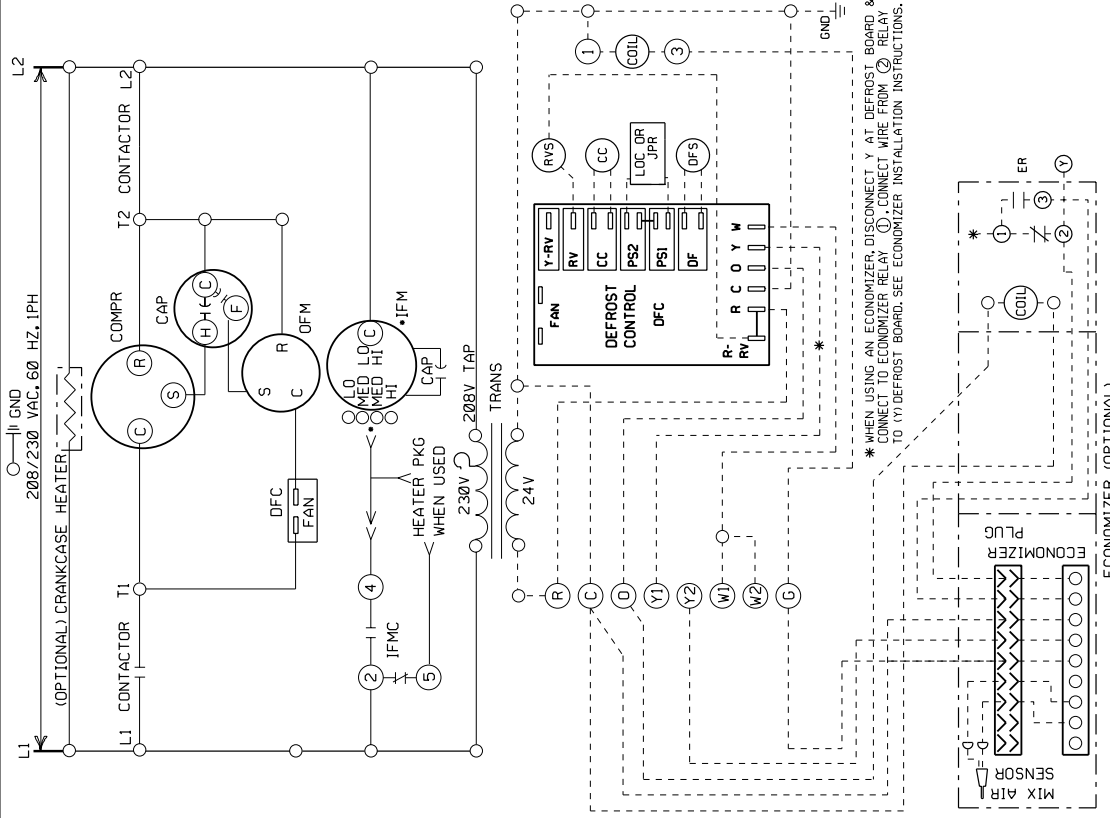

TRANSFORMER
COMPR
CAP
FT
CONT
JPR

GND
DFS
DFC
ER
ECONOMIZER

LVTB
IFMC
RVS
OFM
LOC

5 TON MODEL

LADDER WIRING DIAGRAM

DANGER: ELECTRICAL SHOCK HAZARD DISCONNECT POWER BEFORE SERVICING

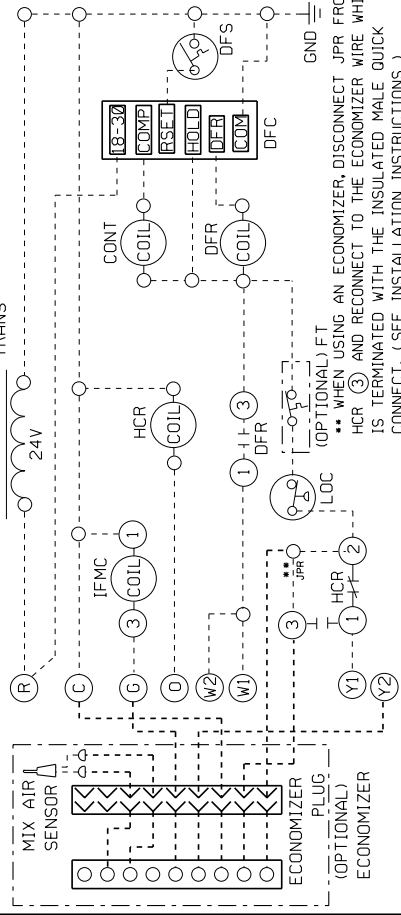
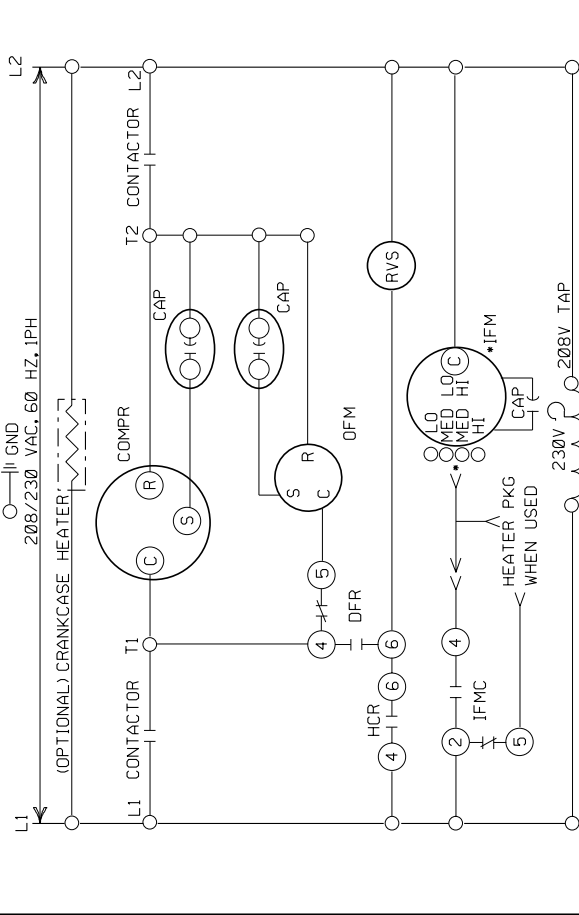

LEGEND

TRANS.....TRANSFORMER
 COMPR.....COMPRESSOR
 CAP.....CAPACITOR
 FT.....FREEZE THERMOSTAT
 CONT.....CONTACTOR
 JPR.....JUMPER WIRE

GND.....GROUND
 HCR.....HEAT/COOL RELAY
 DFR.....DEFROST RELAY
 DFS.....DEFROST SENSOR
 DFC.....DEFROST CONTROL

LVTB.....LOW VOLT TERM BOARD
 IFMC.....INDOOR FAN MOTOR CONTROL
 IFM.....INDOOR FAN MOTOR
 RV.....REVERSING VALVE SOLENOID
 OFM.....OUTDOOR FAN MOTOR
 LOC.....LOSS OF CHARGE PRESSURE SWITCH

CONNECTION WIRING DIAGRAM

DANGER: ELECTRICAL SHOCK HAZARD DISCONNECT POWER BEFORE SERVICING

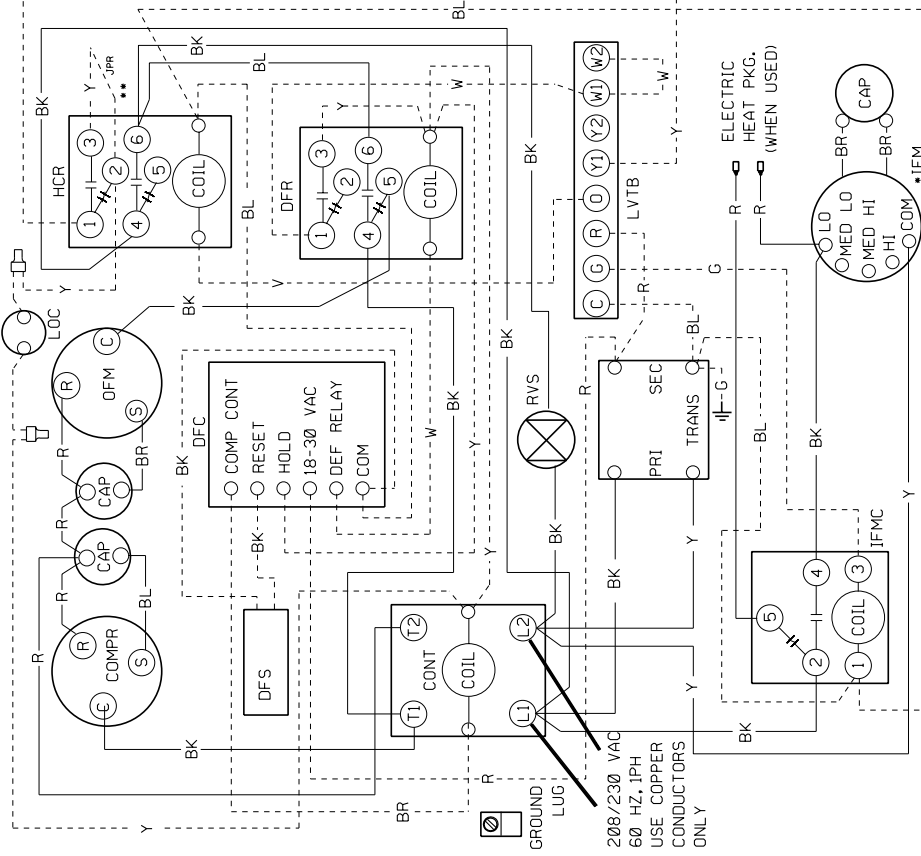

IF ANY OF THE ORIGINAL WIRE AS SUPPLIED WITH THE APPLIANCE MUST BE REPLACED, IT MUST BE REPLACED WITH TYPE AWN-105°C OR ITS EQUIVALENT.
 • SEE INSTALLATION INSTRUCTIONS FOR PROPER HEATING AND COOLING CONNECTIONS FOR YOUR UNIT

LINE VOLTAGE	VOLTAGE	FAC	FACTORY	COLOR	CODE	BLACK	BK	GREEN	G	WHITE	W
---	---	---	---	---	---	---	---	---	---	---	---
- - -	- - -	- - -	- - -	- - -	- - -	- - -	- - -	- - -	- - -	- - -	- - -
- - -	- - -	- - -	- - -	- - -	- - -	- - -	- - -	- - -	- - -	- - -	- - -
- - -	- - -	- - -	- - -	- - -	- - -	- - -	- - -	- - -	- - -	- - -	- - -

BLOWER PARTS - ALL MODELS

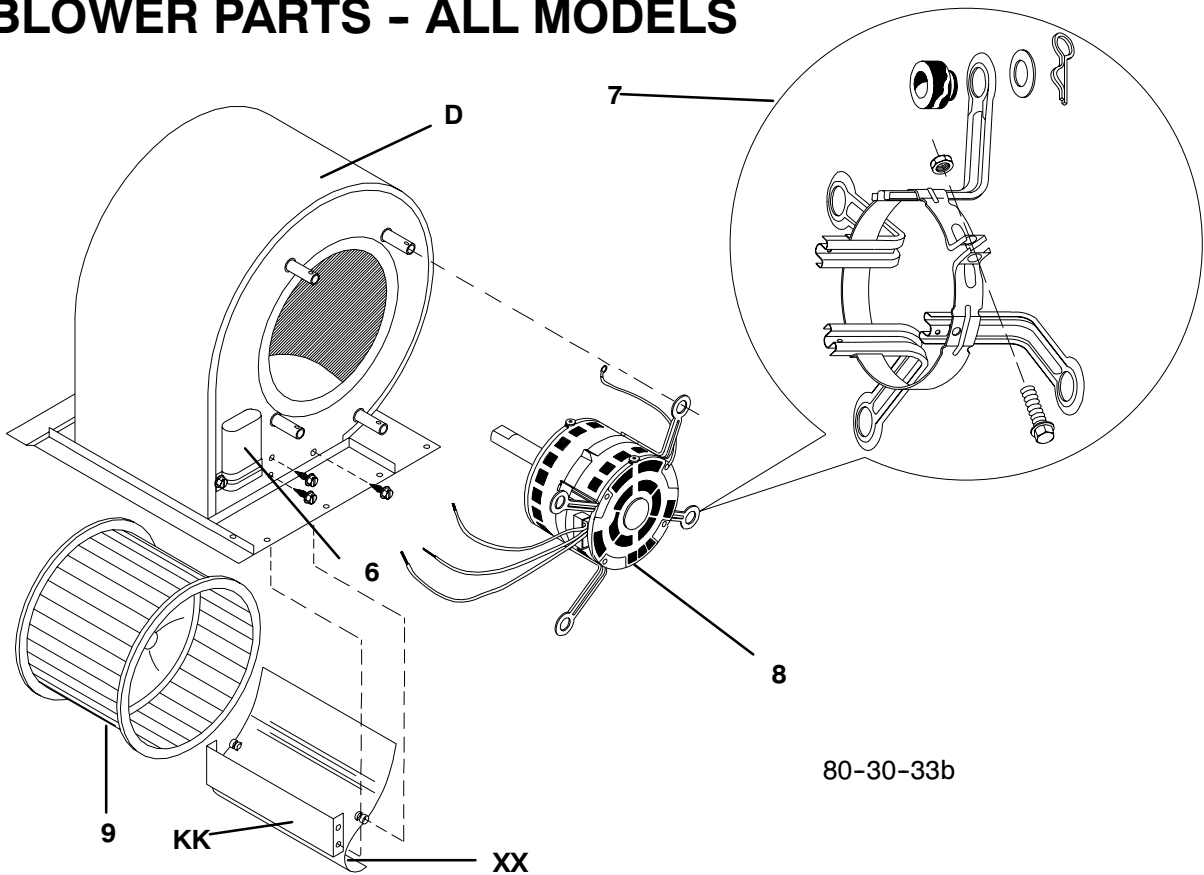

Replacement Parts

Replacement part supplied will be current active part.
For parts not listed, consult place of purchase.

			Model Number/ Quantity Required					
			PHAD					
			24N1K4	30N1K4	36N1K4	42N1K4	47N1K4	60N1K4
			PYMC					
			24G4	30G4	36G4	42G4	48G4	60G4
6	Capacitor, 7.5MFD., 370V. 15.0 MFD., 370V. 20.0 MFD., 440V.	1094239	1	1	-	1	-	-
		1094959	-	-	1	-	-	-
		1094968	-	-	-	-	1	1
7	Kit, Motor Mount	1004905	1	1	-	1	-	-
		1002804	-	-	1	-	1	1
8	Motor, Evaporator Blower	1066420	1	1	-	-	-	-
		1066421	-	-	1	-	-	-
		1054583	-	-	-	1	-	-
		1065129	-	-	-	-	1	1
9	Wheel, Blower	600587	1	1	-	1	-	-
		1065361	-	-	1	-	-	-
		1054593	-	-	-	-	1	1
D	Housing, Blower	1065300	1	1	-	1	-	-
		1066454	-	-	1	-	-	-
		1066363	-	-	-	-	1	1
KK	Baffle, Air (3, 4 and 5 Ton models only. Positioning of baffle is different on 4 and 5 ton models.)	1066621	-	-	1	-	-	-
		1066364	-	-	-	-	1	1
XX	Panel, Cut-Off	95143	1	1	-	1	-	-
		1066448	-	-	1	-	-	-
		1065073	-	-	-	-	1	1

CONTROL PLATE - ALL MODELS

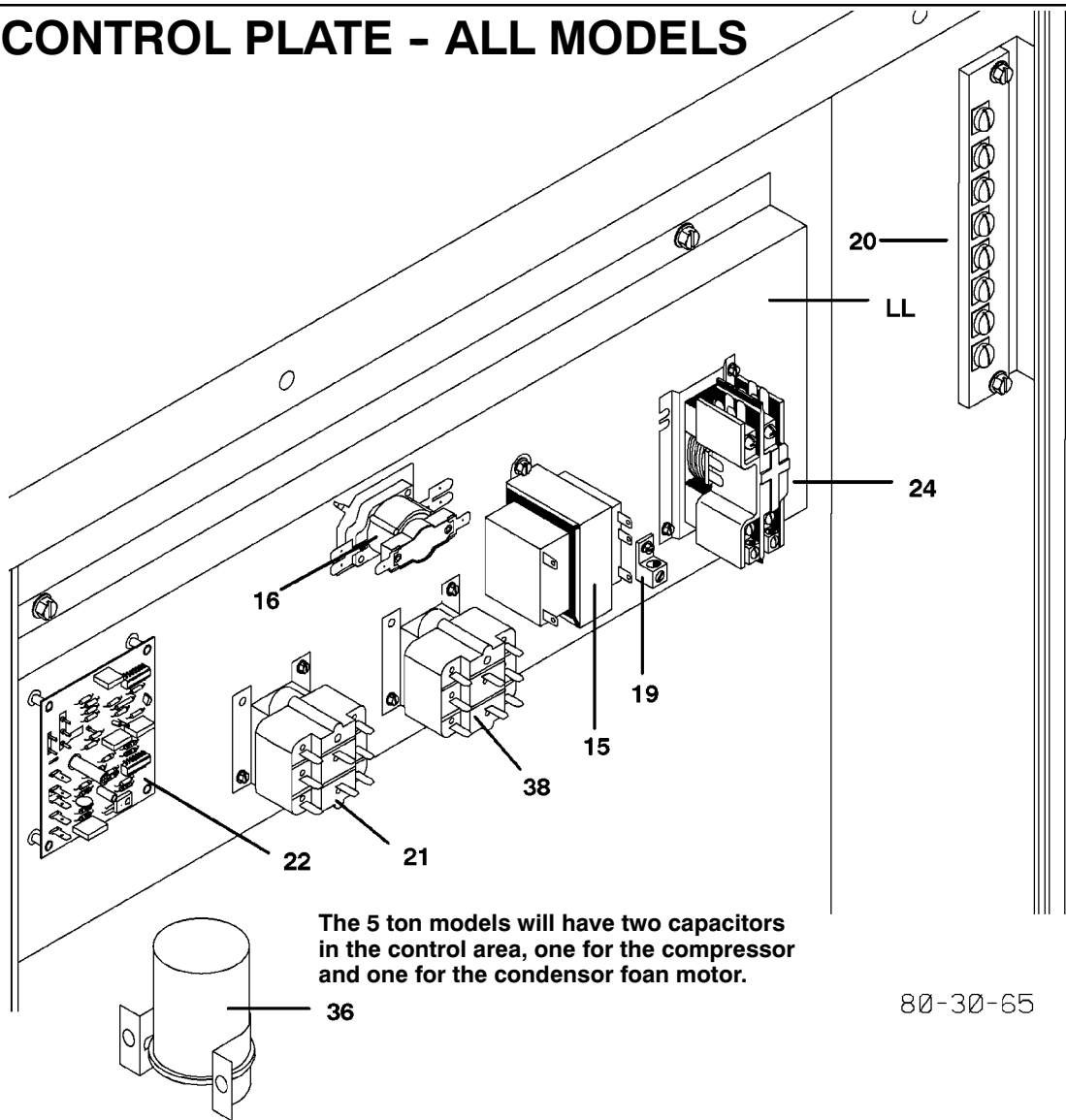

Replacement Parts

Replacement part supplied will be current active part.
For parts not listed, consult place of purchase.

Key No.	Description	Replacement Part Number	Model Number/ Quantity Required					
			PHAD					
			24N1K4	30N1K4	36N1K4	42N1K4	47N1K4	60N1K4
			PYMC					
			24G4	30G4	36G4	42G4	48G4	60G4
15	Transformer	1082611	1	1	1	1	1	1
16	Sequencer, SPDT	1054372	1	1	1	1	1	1
19	Lug, Ground	91590	1	1	1	1	1	1
20	Board, Terminal	1066159	1	1	1	1	1	1
22	Control, Defrost	1069364	1	1	1	1	1	1
24	Contactor, 25 AMP., 1Ph.	1050699	1	1	1	-	-	-
	35 AMP., 1Ph.	1050839	-	-	-	1	-	-
	40 AMP., 1Ph.	1053980	-	-	-	-	1	1
36	Capacitor, 5 / 40MFD., 370V.	1094980	1	-	-	-	-	-
	5 / 45MFD., 370V.	1094982	-	1	-	-	-	-
	5 / 50MFD., 370V.	1094993	-	-	1	-	-	-
	7.5 / 35MFD., 440V.	1094985	-	-	-	1	-	-
	7.5 / 60MFD., 370V.	1149997	-	-	-	-	1	-
	80MFD., 440V. (compressor only)	1149998	-	-	-	-	-	1
	10MFD., 440V. (condenser fan only)	1094965	-	-	-	-	-	1
LL	Plate, Control	1066168	1	1	1	1	1	1

FUNCTIONAL PARTS PHAD/PYMC24-36

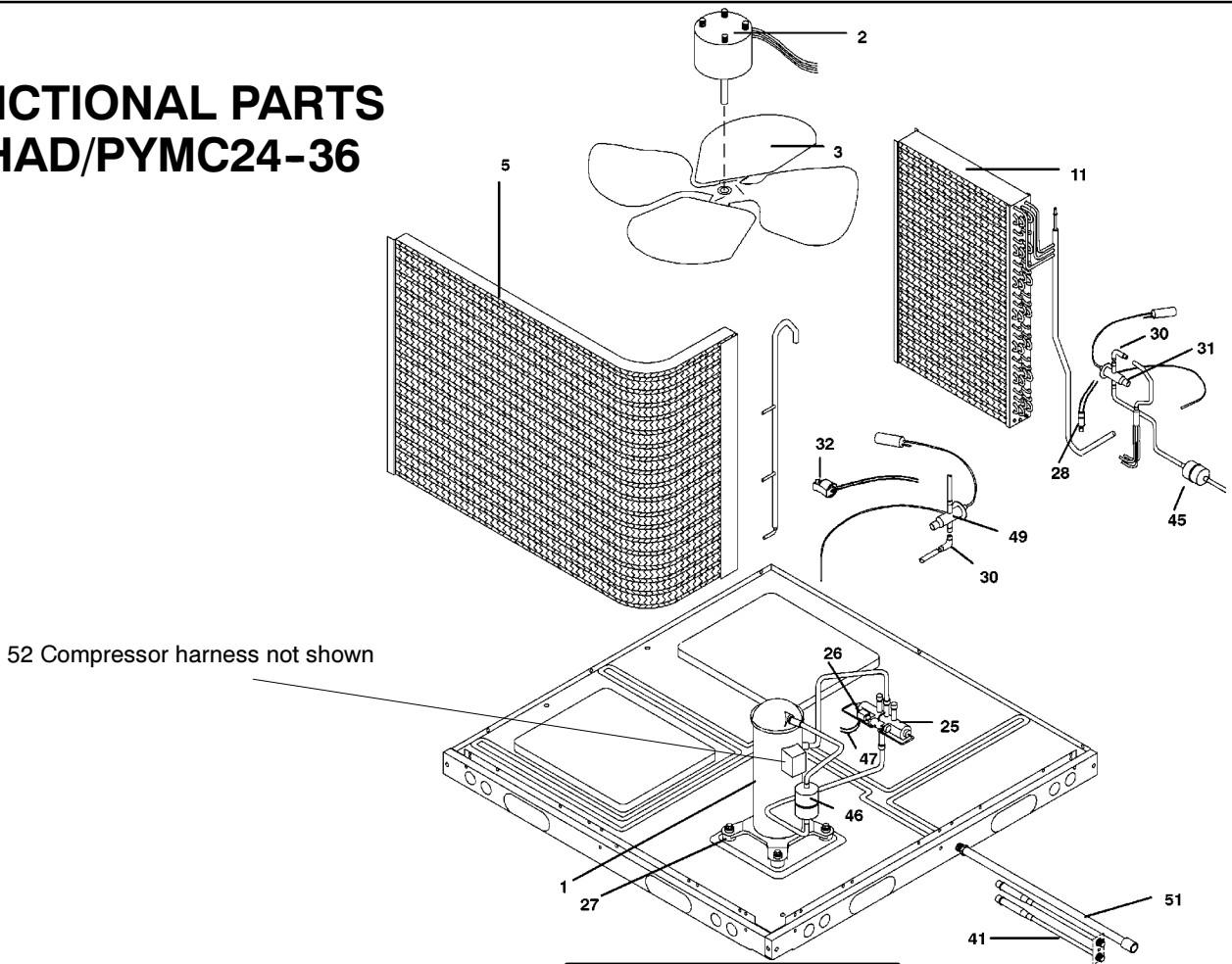

52 Compressor harness not shown

Key No.	Description	Replacement Part Number	PHAD		
			24N1K4	30N1K4	36N1K4
			PYMC		
			24G4	30G4	36G4
1	Compressor ZR22K3PFV ZR28K3PFV ZR34K3PFV	1082755 1082756 1081881	1 - -	- 1 -	- - 1
2	Motor, Condenser Fan	1082491	1	1*	1*
3	Blade, Fan	1080794 1080790	1 -	- -	- 1
5	Coil, Condenser	1066050 1066560	1 -	- 1	- 1
21	Coil, Evaporator	1066069 1066070	1 -	- 1	- 1
25	Valve, Reversing (includes solenoid coil and coil cord)	1095321 1095320	1 -	- 1	- 1
26	Coil, Solenoid 24V	34329055	1	1	1
27	Grommet, Compressor Mounting	1052060	4	4	4
28	Switch, Loss of Charge Pressure	1071317	1	1	1
30	Tube, Strainer	1066347	2	2	2
31	Valve, TXV (Evaporator)	1066042 1066043 1066044	1 - -	- 1 -	- - 1
32	Sensor, Defrost	1066430	1	1	1
41	Assembly, Valve Port	1083959	1	1	1
45	Dryer, Bi-Flow Filter	1083858	1	1	1
46	Muffler	1059730	1	1	1
47	Cord, Coil	1066711	1	1	1
49	Valve, TXV (Condenser)	1065871 1066006 1066007	1 - -	- 1 -	- - 1
51	Tube, Drain	1069172	1	1	1
52	Plug, Compressor Harness	1083811	1	1	1

* part number 1082492

FUNCTIONAL PARTS 3¹/₂ THRU 5 TON

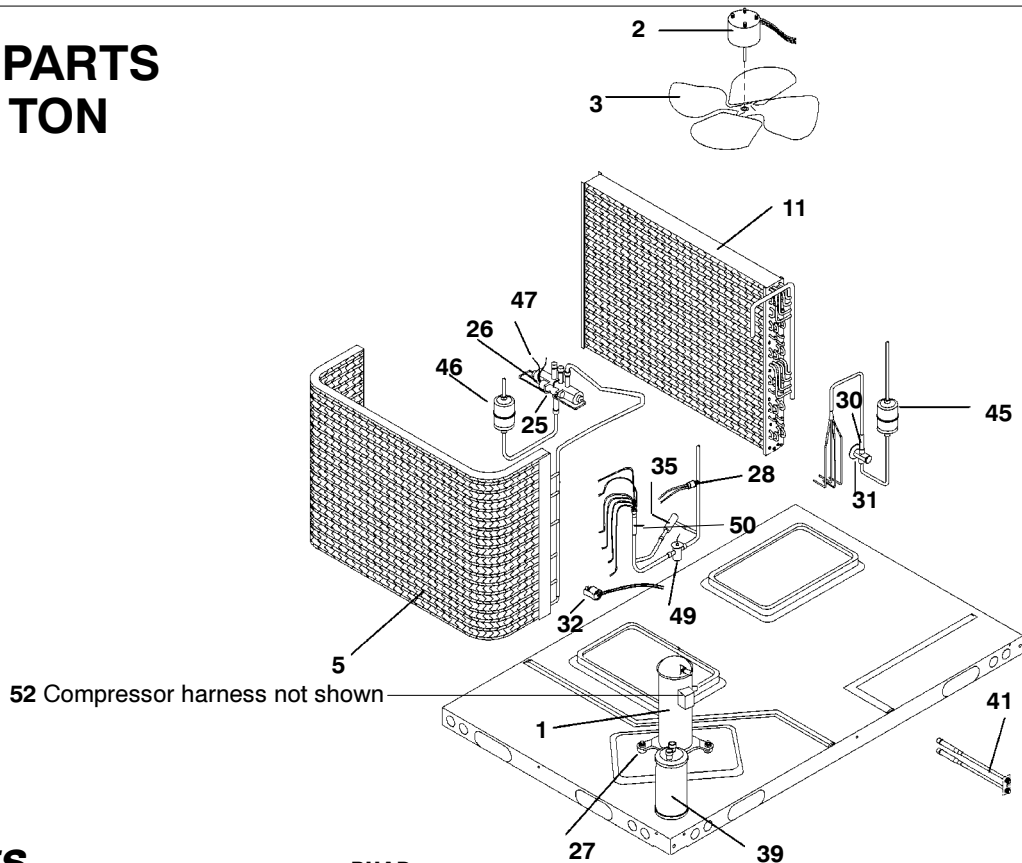

Replacement Parts

Key No.	Description	Part Number	PHAD		
			42N1K4	47N1K4	60N1K4
			PYMC		
			42G4	48G4	60G4
1	Compressor ZR40K3PFV ZR46K3PFV ZR57K3PFV	1083000	1	-	-
		1083018	-	1	-
		1083019	-	-	1
2	Motor, Condenser Fan	1066470	1	1	-
		1065751	-	-	1
3	Blade, Fan	1080795	1	1	-
		1080792	-	-	1
5	Coil, Condenser	1066598	1	-	-
		1066847	-	1	-
		1067435	-	-	1
		1067472	1	-	-
11	Coil, Evaporator	1067471	-	1	-
		1067473	-	-	1
		1095319	1	-	-
		34329030	-	1	1
25	Valve, Reversing (includes solenoid coil and coil cord)	34329055	1	1	1
		1052060	4	4	4
26	Coil, Solenoid 24V	1066803	1	1	1
27	Grommet, Compressor Mounting	1053431	1	-	-
28	Switch, Loss of Charge Pressure	1053432	-	1	1
30	Tube, Strainer	1083939	1	1	1
31	Valve, TXV (Evaporator)	1066008	1	-	-
		1066490	-	1	-
		1066819	-	-	1
32	Sensor, Defrost	1066934	1	1	1
35	Valve, Check	1066803	1	1	1
39	Accumulator, Suction Line	1053431	1	-	-
		1053432	-	1	1
41	Assembly, Valve Port	1083939	1	1	1
45	Dryer, Bi-Flow Filter	1083858	1	1	1
46	Muffler	1059730	1	1	1
47	Cord, Coil	1066711	1	1	1
49	Valve, TXV (Condenser)	1066484	1	1	-
		1067420	-	-	1
50	Tube, Strainer	1066804	1	1	1
52	Plug, Compressor Harness	1083935	1	1	1

NON-FUNCTIONAL PARTS 2 THRU 3 TON MODELS

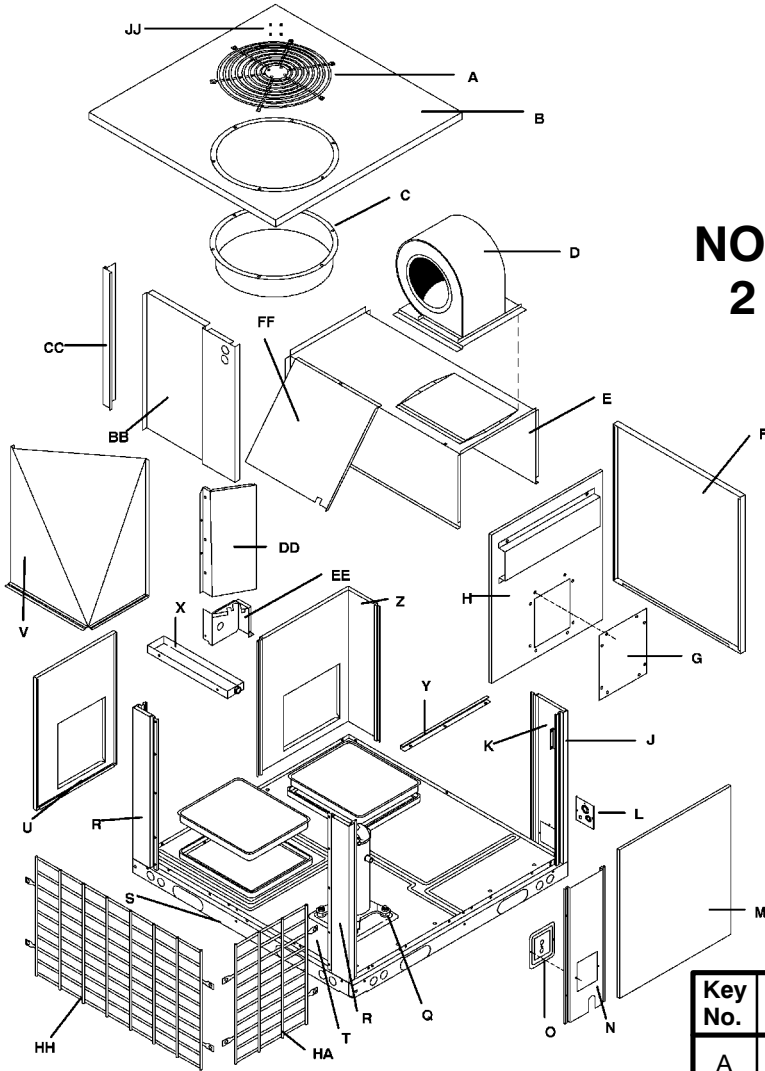

Replacement Parts

Key No.	Description	Part Number	All 2 to 3 Ton
A	Grille, Top Discharge	1064541	1
B	Panel, Top	1068191	1
C	Orifice, Condenser Fan	1065724	1
D	Housing, Blower	SEE BLOWER ASSEMBLY	
E	Deck, Blower	1065949	1
F	Panel, Access	1068180	1
G	Plate, Block Off	1066107	1
H	Panel, Division	1065942	1
J	Post, Electrical Corner	1068192	1
K	Bracket, Low Volt Terminal Mtg	1066106	1
L	Plate, Conduit	1068179	1
M	Panel, Electric Access	1068185	1
N	Panel, Pressure Port	1068182	1
O	Plate, Pressure Port	1068189	1
Q	Bolt, Compressor Mounting	1057967	4
R	Post, Corner	1068167	2
S	Rail, Base	1065001	4
T	Panel, Base	1065031	1
U	Panel, Return Air	1068166	1
V	Partition, Return Air	1065033	1
X	Pan, Drain	1066040	1
Y	Bracket, Evaporator	1065035	1
Z	Panel, Supply Air	1068165	1
AA	Cover, Duct	1068159	2
BB	Partition, Heat / Cool	1066331	1
CC	Bracket, Supply Air	1054524	1
DD	Evaporator Cover, Top	1066332	1
EE	Evaporator Cover, Bottom	1066333	1
FF	Baffle, Evaporator Blower	1066409	1
HH	Grille, Inlet End	1149485	1
JJ	Nut, Cap	1052962	4
HA	Grille, Inlet Side	1082186	1

NON-FUNCTIONAL PARTS 3 1/2 THRU 5 TON MODELS

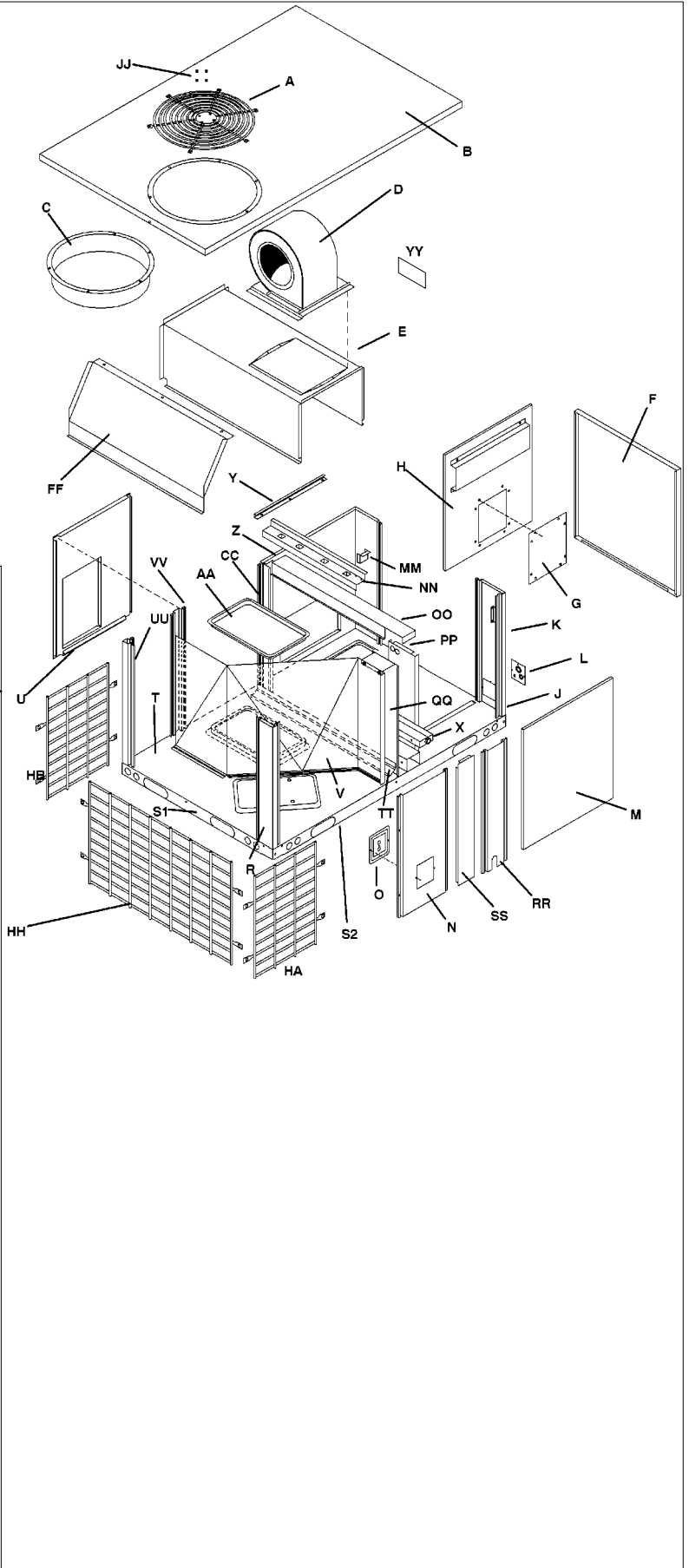

Replacement Parts

Key No.	Description	Part Number	All 3-1/2 to 5 Ton
A	Grille, Top Discharge	1064542	1
B	Panel, Top	1068157	1
C	Orifice, Condenser Fan	1065725	1
D	Housing, Blower See Blower Assembly		
E	Deck, Blower	1065948	1
F	Panel, Access	1068181	1
G	Plate, Block Off	1066107	1
H	Panel, Division	1065943	1
J	Post, Electrical Corner	1068193	1
K	Bracket, Low Voltage Mtng	1066106	1
L	Plate, Conduit	1068179	1
M	Panel, Electrical Access	1068186	1
N	Panel, Pressure Port	1068164	1
O	Plate, Pressure Port	1068189	1
R	Post, Corner	1068172	1
S2	Rail, Base	1054464	2
S1	Rail, Base	1065001	2
T	Panel, Base	1054463	1
U	Panel, Return Air	1068160	1
V	Partition, Return Air	1054471	1
X	Pan, Drain	1068366	1
Y	Bracket, Evaporator	1082436	1
Z	Panel, Supply Air	1068161	1
AA	Cover, Duct	1068158	2
CC	Bracket, Supply Air	1054525	1
FF	Baffle, Air	1054522	1
HH	Grille, Inlet	1082281	1
JJ	Nut, Cap	1067902	4
MM	Bracket, Filter Top	1065618	1
NN	Support, Filter Top	1054502	1
OO	Panel, Coil Support	1082434	1
PP	Panel, Heating Area	1054508	1
QQ	Baffle, Coil	1082435	1
RR	Panel, Drain Outlet	1068162	1
SS	Panel, Filter Access	1068175	1
TT	Support, Filter Bottom	1054501	1
UU	Post, Return Air	1068168	1
VV	Post, Center	1068163	1
YY	Bracket, Blower Support	1065030	1 - Not used on 3-1/2 ton
HA	Grille Inlet (Right)	1082279	
HB	Grille Inlet (Left)	1082280	