

Parts List, Charging Charts, Tech Labels, Wiring Diagrams

PGX3 1 Phase Series

PACKAGE GAS ELECTRIC UNITS



TABLE OF CONTENTS

PARTS LIST	2-9
PARTS DRAWING	10-11
CHARGING CHARTS.....	12
TECH LABELS	
PGX3 24 - 30	13
PGX3 36 - 42	14
PGX3 42 - 60	15
WIRING DIAGRAMS ---	16-17



PGX3 1 PHASE PARTS LIST

KEY NO.	DESCRIPTION	FAST PART NO.										
			PGX324040K00A1	PGX324040K01A1	PGX324060K00A1	PGX324060K01A1	PGX324080K00A1	PGX324080K01A1	PGX330040K00A1	PGX330040K01A1	PGX330060K00A1	PGX330060K01A1
1	COMP ZPS20K4E-PFV-130	ZPS20K4EPFV130	1	1	1	1	1	1	*	*	*	*
1	COMP ZPS26K4E-PFV-130	ZPS26K4EPFV130	*	*	*	*	*	*	1	1	1	1
2	MTR CND 1/230 1/8 825/1	1173699	1	1	1	1	1	1	1	1	1	1
3	FAN C 20" 3B 1/2" 34 INT	1173706	1	1	1	1	1	1	1	1	1	1
4	COIL, EVAP MANIFOLDS INCL.	1174353	1	1	1	1	1	1	*	*	*	*
4	COIL, EVAP MANIFOLDS INCL.	1174354	*	*	*	*	*	*	1	1	1	1
7	DISTRIBUTOR	1174360	1	1	1	1	1	1	1	1	1	1
8	BAFFLE NOX (low nox models only)	1173201	*	2	*	3	*	4	*	2	*	3
9	MOUNT KIT BLOWER MOTOR	1174295	1	1	1	1	1	1	1	1	1	1
10	WHEEL DD10x8x1/2 CW CV	1173813	1	1	1	1	1	1	1	1	1	1
11	MTR BLR 1/230 1/2 HP	1174278	1	1	1	1	1	1	*	*	*	*
11	MTR BLR 1/230 1/2 HP	1174279	*	*	*	*	*	*	1	1	1	1
12	CAP RN RD 370V 5+35	1172110	1	1	1	1	1	1	*	*	*	*
12	CAP RN RD 370V 5+40	1172147	*	*	*	*	*	*	1	1	1	1
13	CONTACTOR 1P 25A 24V	1173689	1	1	1	1	1	1	1	1	1	1
14	BREAKER 3.2A 1 POLE 250V	1171114	1	1	1	1	1	1	1	1	1	1
15	TRANS 200/230/460>24 75VA	1171496	1	1	1	1	1	1	1	1	1	1
16	CIRCUIT BOARD X-13	1174144	1	1	1	1	1	1	1	1	1	1
17	COIL, COND MANIFOLDS INCL.	1174363	1	1	1	1	1	1	*	*	*	*
17	COIL, COND MANIFOLDS INCL.	1174364	*	*	*	*	*	*	1	1	1	1
18	PLUG COMP WIRE (SM)	1173826	1	1	1	1	1	1	1	1	1	1
19	PLUG COMP SOLENOID COIL 85"LDS	1173695	1	1	1	1	1	1	1	1	1	1
20	PORT ASY VLV/SWT	1083619	1	1	1	1	1	1	1	1	1	1
23	HTR CC WP 40W240V	1173705	1	1	1	1	1	1	1	1	1	1
25	SWITCH PRESS HI O650 C420	1174407	1	1	1	1	1	1	1	1	1	1
26	VALVE TXV 2.0 R410 SHT 86	1174408	1	1	1	1	1	1	*	*	*	*
26	VALVE TXV 2.0 R410 SHT 95	1174409	*	*	*	*	*	*	1	1	1	1
29	IGNITOR ASY REMOTE SPARK	1173831	1	1	1	1	1	1	1	1	1	1
30	TUBE SENSOR 3/16" ID	1013088	1	1	1	1	1	1	1	1	1	1
31	BURNER ASY 2-SECT	1009178	1	1	*	*	*	*	1	1	*	*
31	BURNER ASY 3 SECT	1008724	*	*	1	1	*	*	*	*	1	1
31	BURNER ASY 4 SECT	1008725	*	*	*	*	1	1	*	*	*	*
32	SWITCH LMT 250-M	1013101	1	1	1	1	1	1	1	1	1	1
33	IGNITOR SPARK W/ FLAME SENSOR	1173829	1	1	*	*	*	*	1	1	*	*
33	IGNITOR SPARK	1173828	*	*	1	1	1	1	*	*	1	1
34	SENSOR FLAME	1173830	*	*	1	1	1	1	*	*	1	1
35	VALVE N HSI SNAP HW VR8205S	1173845	1	1	1	1	1	1	1	1	1	1
36	ORIFICE MAIN 44	1011352	2	2	3	3	4	4	2	2	3	3
37	MANIFOLD 2 SECT	1004138	1	1	*	*	*	*	1	1	*	*
37	MANIFOLD 3 SECT	1004139	*	*	1	1	*	*	*	*	1	1
37	MANIFOLD 4 SECT	1004140	*	*	*	*	1	1	*	*	*	*
38	SWITCH LMT 160-30 SB	1065207	1	1	*	*	*	*	*	*	*	*
38	SWITCH LMT 150-30 SB	1065638	*	*	1	1	*	*	*	*	1	1
38	SWITCH LMT 135-30 SB	1065295	*	*	*	*	1	1	*	*	*	*
38	SWITCH LMT 170-20 SB	1095242	*	*	*	*	*	*	1	1	*	*
39	BOX COLLECTOR ALCT	1098331	1	1	1	1	1	1	1	1	1	1
40	GASKET COLL BOX	1065209	1	1	1	1	1	1	1	1	1	1
41	HT EX TUBE 2S SS	1174425	1	1	*	*	*	*	1	1	*	*

KEY NO.	DESCRIPTION	FAST PART NO.	PGX324040K00A1	PGX324040K01A1	PGX324060K00A1	PGX324060K01A1	PGX324080K00A1	PGX324080K01A1	PGX330040K00A1	PGX330040K01A1	PGX330060K00A1	PGX330060K01A1
			*	*	1	1	*	*	*	*	1	1
41	HT EX TUBE 3S SS	1174426	*	*	1	1	*	*	*	*	1	1
41	HT EX TUBE 4S SS	1174427	*	*	*	*	1	1	*	*	*	*
42	PLATE, INJECTOR-2	1084328	1	1	*	*	*	*	1	1	*	*
42	PLATE, INJECTOR-3	1084329	*	*	1	1	*	*	*	*	1	1
42	PLATE, INJECTOR-4	1084330	*	*	*	*	1	1	*	*	*	*
44	GASKET, COMB BLW	607014	1	1	1	1	1	1	1	1	1	1
45	BLOWER VENT PKG	1054268	1	1	1	1	1	1	1	1	1	1
46	BOARD CONTROL YAC	1173838	1	1	1	1	1	1	1	1	1	1
48	SWITCH PRESS LO O20 C45	1174412	1	1	1	1	1	1	1	1	1	1
54	SWITCH PRESS COMP SOL	1174413	1	1	1	1	1	1	1	1	1	1
55	DRIER LIQ 08 CU IN 3/8 SWEAT	1173679	1	1	1	1	1	1	1	1	1	1
56	SWITCH VENT PRESS	1172198	1	1	1	1	1	1	1	1	1	1
57	TUBE DRAIN	1069172	1	1	1	1	1	1	1	1	1	1
60	RAIL, BASE W/FORK SLOTS	1065001	2	2	2	2	2	2	2	2	2	2
61	RAIL, BASE WO/FORK SLOTS	1113559	2	2	2	2	2	2	2	2	2	2
A	PANEL, TOP "B CHASSIS"	1174392	1	1	1	1	1	1	1	1	1	1
B	GRILLE OUTLET	1173832	1	1	1	1	1	1	1	1	1	1
C	GRILLE COND INLET	1064544	1	1	1	1	1	1	1	1	1	1
D	GRILLE COND INLET	1064543	1	1	1	1	1	1	1	1	1	1
F	NUT CAP	1172740	4	4	4	4	4	4	4	4	4	4
G	PANEL PORT P250	1068182	1	1	1	1	1	1	1	1	1	1
H	PLATE PORT P250	1068189	1	1	1	1	1	1	1	1	1	1
I	BRACKET EVAP	1099106	1	1	1	1	1	1	1	1	1	1
J	HOUSING BLOWER	1174166	1	1	1	1	1	1	1	1	1	1
K	BOX BLW	1174395	1	1	1	1	1	1	1	1	1	1
M	HOOD FLUE ALCT	1054269	1	1	1	1	1	1	1	1	1	1
MM	SUPPORT, FLUE	1054620	1	1	1	1	1	1	1	1	1	1
MMM	GASKET, EXTENSION	1065260	1	1	1	1	1	1	1	1	1	1
N	SHIELD BURNER ALCT	1054449	1	1	*	*	*	*	1	1	*	*
N	SHIELD BURNER ALCT	1054435	*	*	1	1	*	*	*	*	1	1
N	SHIELD BURNER ALCT	1054422	*	*	*	*	1	1	*	*	*	*
P	PANEL, SUPPLY AIR	1110951	1	1	1	1	1	1	1	1	1	1
Q	PANEL, RETURN AIR	1110952	1	1	1	1	1	1	1	1	1	1
R	COVER, DUCTS	1110961	2	2	2	2	2	2	2	2	2	2
RR	COVER, CONT BOX	1174448	1	1	1	1	1	1	1	1	1	1
S	PANEL, ACCESS	1068183	1	1	1	1	1	1	1	1	1	1
T	SUPPORT, MANF	1084327	2	2	2	2	2	2	2	2	2	2
U	PANEL BLR ACC	1110953	1	1	1	1	1	1	1	1	1	1
V	POST RETURN AIR	1068167	2	2	2	2	2	2	2	2	2	2
W	POST, CNR (HEATING)	1174441	1	1	1	1	1	1	1	1	1	1
ZZ	PAN, DRAIN	1110954	1	1	1	1	1	1	1	1	1	1
V	BRACKET, COMPONENT MTG	1084157	1	1	1	1	1	1	*	1	*	1
PARTS NOT SHOWN												
)	NAT >LP CONVERSION	1173857	1	1	1	1	1	1	1	1	1	1
)	NAT >LP CONVERSION	1173859	1	1	1	1	1	1	1	1	1	1
)	NAT >LP CONVERSION	1173861	1	1	1	1	1	1	1	1	1	1
)	LP>NAT GAS CONVERSION	1173863	1	1	1	1	1	1	1	1	1	1
)	HARNESS, WIRE (DUAL CAP YAC)	1174424	1	1	1	1	1	1	1	1	1	1
)	HARNESS, WIRE (DUAL CAP ADP)	1174320	1	1	1	1	1	1	1	1	1	1

PGX3 1 PHASE PARTS LIST

KEY NO.	DESCRIPTION	FAST PART NO.	PGX330080K00A1	PGX330080K01A1	PGX336060K00A1	PGX336060K01A1	PGX336080K00A1	PGX336080K01A1	PGX336100K00A1	PGX336100K01A1
1	COMP ZPS26K4E-PFV-130	ZPS26K4EPFV130	1	1	*	*	*	*	*	*
1	COMP ZPS30K4E-PFV-130	ZPS30K4EPFV130	*	*	1	1	1	1	1	1
2	MTR CND 1/230 1/8 825/1	1173699	1	1	*	*	*	*	*	*
2	MTR CND 1/230 1/4 1100/1	1173700	*	*	1	1	1	1	1	1
3	FAN C 20" 3B 1/2" 34 INT	1173706	1	1	1	1	1	1	1	1
4	COIL, EVAP MANIFOLDS INCL.	1174354	1	1	*	*	*	*	*	*
4	COIL, EVAP MANIFOLDS INCL.	1174355	*	*	1	1	1	1	1	1
7	DISTRIBUTOR	1174360	1	1	*	*	*	*	*	*
7	DISTRIBUTOR	1174361	*	*	1	1	1	1	1	1
8	BAFFLE NOX (low nox models only)	1173201	*	4	*	3	*	4	*	5
9	MOUNT KIT BLOWER MOTOR	1174295	1	1	1	1	1	1	1	1
10	WHEEL DD10x8x1/2 CW CV	1173813	1	1	*	*	*	*	*	*
10	WHEEL DD11x9x1/2 CW CV	1171742	*	*	1	1	1	1	1	1
11	MTR BLR 1/230 1/2 HP	1174279	1	1	*	*	*	*	*	*
11	MTR BLR 1/230 3/4 HP	1174280	*	*	1	1	1	1	1	1
12	CAP RN RD 370V 5+40	1172147	1	1	1	1	1	1	1	1
13	CONTACTOR 1P 25A 24V	1173689	1	1	1	1	1	1	1	1
14	BREAKER 3.2A 1 POLE 250V	1171114	1	1	1	1	1	1	1	1
15	TRANS 200/230/460>24 75VA	1171496	1	1	1	1	1	1	1	1
16	CIRCUIT BOARD X-13	1174144	1	1	1	1	1	1	1	1
17	COIL, COND MANIFOLDS INCL.	1174364	1	1	*	*	*	*	*	*
17	COIL, COND MANIFOLDS INCL.	1174365	*	*	1	1	1	1	1	1
18	PLUG COMP WIRE (SM)	1173826	1	1	1	1	1	1	1	1
19	PLUG COMP SOLENOID COIL 85"LDS	1173695	1	1	1	1	1	1	1	1
20	PORT ASY VLV/SWT	1083619	1	1	1	1	1	1	1	1
23	HTR CC WP 40W240V	1173705	1	1	1	1	1	1	1	1
25	SWITCH PRESS HI O650 C420	1174407	1	1	1	1	1	1	1	1
26	VALVE TXV 2.0 R410 SHT 95	1174409	1	1	1	1	1	1	1	1
29	IGNITOR ASY REMOTE SPARK	1173831	1	1	1	1	1	1	1	1
30	TUBE SENSOR 3/16" ID	1013088	1	1	1	1	1	1	1	1
31	BURNER ASY 3 SECT	1008724	*	*	1	1	*	*	*	*
31	BURNER ASY 4 SECT	1008725	1	1	*	*	1	1	*	*
31	BURNER ASY 5 SECT	1008726	*	*	*	*	*	*	1	1
32	SWITCH LMT 250-M	1013101	1	1	*	*	*	*	*	*
32	SWITCH LMT 300-M	1013102	*	*	1	1	1	1	1	1
33	IGNITOR SPARK	1173828	1	1	1	1	1	1	1	1
34	SENSOR FLAME	1173830	1	1	1	1	1	1	1	1
35	VALVE N HSI SNAP HW VR8205S	1173845	1	1	1	1	1	1	1	1
36	ORIFICE MAIN 44	1011352	4	4	3	3	4	4	5	5
37	MANIFOLD 3 SECT	1004139	*	*	1	1	*	*	*	*
37	MANIFOLD 4 SECT	1004140	1	1	*	*	1	1	*	*
37	MANIFOLD 5 SECT	1004141	*	*	*	*	*	*	1	1
38	SWITCH LMT 140-30 SB	1065294	1	1	1	1	1	1	1	1
39	BOX COLLECTOR ALCT	1098331	1	1	1	1	1	1	1	1
40	GASKET COLL BOX	1065209	1	1	1	1	1	1	1	1
41	HT EX TUBE 3S SS	1174426	*	*	1	1	*	*	*	*
41	HT EX TUBE 4S SS	1174427	1	1	*	*	1	1	*	*
41	HT EX TUBE 5S SS	1174428	*	*	*	*	*	*	1	1

KEY NO.	DESCRIPTION	FAST PART NO.	PGX330080K00A1	PGX330080K01A1	PGX336060K00A1	PGX336060K01A1	PGX336080K00A1	PGX336080K01A1	PGX336100K00A1	PGX336100K01A1
42	PLATE, INJECTOR-3	1084329	*	*	1	1	*	*	*	*
42	PLATE, INJECTOR-4	1084330	1	1	*	*	1	1	*	*
42	PLATE, INJECTOR-5	1084331	*	*	*	*	*	*	1	1
44	GASKET, COMB BLW	607014	1	1	1	1	1	1	1	1
45	BLOWER VENT PKG	1054268	1	1	1	1	1	1	1	1
46	BOARD CONTROL YAC	1173838	1	1	1	1	1	1	1	1
48	SWITCH PRESS LO O20 C45	1174412	1	1	1	1	1	1	1	1
54	SWITCH PRESS COMP SOL	1174413	1	1	1	1	1	1	1	1
55	DRIER LIQ 08 CU IN 3/8 SWEAT	1173679	1	1	1	1	1	1	1	1
56	SWITCH VENT PRESS	1172198	1	1	1	1	1	1	1	1
57	TUBE DRAIN	1069172	1	1	1	1	1	1	1	1
60	RAIL, BASE W/FORK SLOTS	1065001	2	2	2	2	2	2	2	2
61	RAIL, BASE WO/FORK SLOTS	1113559	2	2	2	2	2	2	2	2
A	PANEL, TOP "B CHASSIS"	1174392	1	1	1	1	1	1	1	1
B	GRILLE OUTLET	1173832	1	1	1	1	1	1	1	1
C	GRILLE COND INLET	1064544	1	1	1	1	1	1	1	1
D	GRILLE COND INLET	1064543	1	1	1	1	1	1	1	1
F	NUT CAP	1172740	4	4	4	4	4	4	4	4
G	PANEL PORT P250	1068182	1	1	1	1	1	1	1	1
H	PLATE PORT P250	1068189	1	1	1	1	1	1	1	1
I	BRACKET EVAP	1099106	1	1	1	1	1	1	1	1
J	HOUSING BLOWER	1174166	1	1	*	*	*	*	*	*
J	HOUSING BLOWER	1174167	*	*	1	1	1	1	1	1
K	BOX BLW	1174395	1	1	1	1	1	1	1	1
M	HOOD FLUE ALCT	1054269	1	1	1	1	1	1	1	1
MM	SUPPORT, FLUE	1054620	1	1	1	1	1	1	1	1
MMM	GASKET, EXTENSION	1065260	1	1	1	1	1	1	1	1
N	SHIELD BURNER ALCT	1054435	*	*	1	1	*	*	*	*
N	SHIELD BURNER ALCT	1054422	1	1	*	*	1	1	*	*
N	SHIELD BURNER ALCT	1054267	*	*	*	*	*	*	1	1
P	PANEL, SUPPLY AIR	1110951	1	1	1	1	1	1	1	1
Q	PANEL, RETURN AIR	1110952	1	1	1	1	1	1	1	1
R	COVER, DUCTS	1110961	2	2	2	2	2	2	2	2
RR	COVER, CONT BOX	1174448	1	1	1	1	1	1	1	1
S	PANEL, ACCESS	1068183	1	1	1	1	1	1	1	1
T	SUPPORT, MANF	1084327	2	2	2	2	2	2	2	2
U	PANEL BLR ACC	1110953	1	1	1	1	1	1	1	1
V	POST RETURN AIR	1068167	2	2	2	2	2	2	2	2
W	POST, CNR (HEATING)	1174441	1	1	1	1	1	1	1	1
ZZ	PAN, DRAIN	1110954	1	1	1	1	1	1	1	1
V	BRACKET, COMPONENT MTG	1084157	1	*	1	*	1	*	1	*
PARTS NOT SHOWN										
)	(NAT >LP CONVERSION	1173857	1	1	1	1	1	1	1	1
)	(NAT >LP CONVERSION	1173859	1	1	1	1	1	1	1	1
)	(NAT >LP CONVERSION	1173861	1	1	1	1	1	1	1	1
)	(LP>NAT GAS CONVERSION	1173863	1	1	1	1	1	1	1	1
)	(HARNESS, WIRE (DUAL CAP YAC)	1174424	1	1	1	1	1	1	1	1
)	(HARNESS, WIRE (DUAL CAP ADP)	1174320	1	1	1	1	1	1	1	1

PGX3 1 PHASE PARTS LIST

KEY NO.	DESCRIPTION	FAST PART NO.	PGX342080K00A1	PGX342080K01A1	PGX342100K00A1	PGX342100K01A1	PGX348080K00A1	PGX348080K01A1	PGX348120K00A1	PGX348120K01A1
1	COMP ZPS35K4E-PFV-130	ZPS35K4EPFV130	1	1	1	1	*	*	*	*
1	COMP ZPS40K4E-PFV-130	ZPS40K4EPFV130	*	*	*	*	1	1	1	1
2	MTR CND 1/230 1/4 1100/1	1173700	1	1	1	1	1	1	1	1
3	FAN C 22" 3B 1/2" 24 INT	1171220	1	1	1	1	1	1	1	1
4	COIL, EVAP MANIFOLDS INCL.	1174356	1	1	1	1	*	*	*	*
4	COIL, EVAP MANIFOLDS INCL.	1174357	*	*	*	*	1	1	1	1
7	DISTRIBUTOR	1174359	1	1	1	1	1	1	1	1
8	BAFFLE NOX (low nox models only)	1173201	*	4	*	5	*	4	*	6
9	MOUNT KIT BLOWER MOTOR	1174295	1	1	1	1	1	1	1	1
10	WHEEL DD11x9x1/2 CW CV	1171742	1	1	1	1	*	*	*	*
10	WHEEL DD11x10x1/2 CW CV	1173815	*	*	*	*	1	1	1	1
11	MTR BLR 1/230 3/4 HP	1174281	1	1	1	1	*	*	*	*
11	MTR BLR 1/230 1 HP	1174282	*	*	*	*	1	1	1	1
12	CAP RN RD 370V 5+45	1172124	1	1	1	1	1	1	1	1
13	CONTACTOR 1P 40A 24V	1173690	1	1	1	1	1	1	1	1
14	BREAKER 3.2A 1 POLE 250V	1171114	1	1	1	1	1	1	1	1
15	TRANS 200/230/460>24 75VA	1171496	1	1	1	1	1	1	1	1
16	CIRCUIT BOARD X-13	1174144	1	1	1	1	1	1	1	1
17	COIL, COND MANIFOLDS INCL.	1174367	1	1	1	1	1	1	1	1
18	PLUG COMP WIRE (SM)	1173826	1	1	1	1	1	1	1	1
19	PLUG COMP SOLENOID COIL 85"LDS	1173695	1	1	1	1	1	1	1	1
20	PORT ASY VLV/SWT	1083619	1	1	1	1	1	1	1	1
23	HTR CC WP 40W240V	1173705	1	1	1	1	1	1	1	1
25	SWITCH PRESS HI O650 C420	1174407	1	1	1	1	1	1	1	1
26	VALVE TXV 4.0 R410 SHT 88	1174410	1	1	1	1	1	1	1	1
29	IGNITOR ASY REMOTE SPARK	1173831	1	1	1	1	1	1	1	1
30	TUBE SENSOR 3/16" ID	1013088	1	1	1	1	1	1	1	1
31	BURNER ASY 4 SECT	1008725	1	1	*	*	1	1	*	*
31	BURNER ASY 5 SECT	1008726	*	*	1	1	*	*	*	*
31	BURNER ASY 6 SECT	1009179	*	*	*	*	*	*	1	1
32	SWITCH LMT 300-M	1013102	1	1	1	1	1	1	1	1
33	IGNITOR SPARK	1173828	1	1	1	1	1	1	1	1
34	SENSOR FLAME	1173830	1	1	1	1	1	1	1	1
35	VALVE N HSI SNAP HW VR8205S	1173845	1	1	1	1	1	1	1	1
36	ORIFICE MAIN 44	1011352	4	4	5	5	4	4	6	6
37	MANIFOLD 4 SECT	1004140	1	1	*	*	1	1	*	*
37	MANIFOLD 5 SECT	1004141	*	*	1	1	*	*	*	*
37	MANIFOLD 6 SECT	1054272	*	*	*	*	*	*	1	1
38	SWITCH LMT 135-30 SB	1065295	1	1	1	1	1	1	1	1
39	BOX COLLECTOR ALCT	1098340	1	1	1	1	1	1	1	1
40	GASKET COLL BOX	1065210	1	1	1	1	1	1	1	1
41	HT EX TUBE 4S SS	1174429	1	1	*	*	1	1	*	*
41	HT EX TUBE 5S SS	1174430	*	*	1	1	*	*	*	*
41	HT EX TUBE 6S SS	1174431	*	*	*	*	*	*	1	1
42	PLATE, INJECTOR-4	1084330	1	1	*	*	1	1	*	*
42	PLATE, INJECTOR-5	1084331	*	*	1	1	*	*	*	*
42	PLATE, INJECTOR-6	1084332	1	1	*	*	*	*	1	1
42	PLATE, INJECTOR-7	1084333	*	*	1	1	*	*	*	*
44	GASKET, COMB BLW	607014	1	1	1	1	1	1	1	1
45	BLOWER VENT PKG	1054268	1	1	1	1	1	1	1	1

KEY NO.	DESCRIPTION	FAST PART NO.	PGX342080K00A1	PGX342080K01A1	PGX342100K00A1	PGX342100K01A1	PGX348080K00A1	PGX348080K01A1	PGX348120K00A1	PGX348120K01A1
46	BOARD CONTROL YAC	1173838	1	1	1	1	1	1	1	1
48	SWITCH PRESS LO O20 C45	1174412	1	1	1	1	1	1	1	1
54	SWITCH PRESS COMP SOL	1174413	1	1	1	1	1	1	1	1
55	DRIER LIQ 08 CU IN 3/8 SWEAT	1173679	1	1	1	1	1	1	1	1
56	SWITCH VENT PRESS	1172198	1	1	1	1	1	1	1	1
58	RAIL, BASE W/FORK SLOTS	1054464	1	1	1	1	1	1	1	1
59	RAIL, BASE W/FORK SLOTS	1084078	1	1	1	1	1	1	1	1
60	RAIL, BASE W/FORK SLOTS	1065001	1	1	1	1	1	1	1	1
61	RAIL, BASE WO/FORK SLOTS	1113559	1	1	1	1	1	1	1	1
A	PANEL, TOP "C CHASSIS"	1174393	1	1	1	1	1	1	1	1
B	GRILLE OUTLET	1174394	1	1	1	1	1	1	1	1
C	GRILLE COND INLET	1064545	1	1	1	1	1	1	1	1
D	GRILLE COND INLET	1064547	1	1	1	1	1	1	1	1
F	NUT CAP	1172740	4	4	4	4	4	4	4	4
G	PANEL PORT P250	1068164	1	1	1	1	1	1	1	1
H	PLATE PORT P250	1068189	1	1	1	1	1	1	1	1
I	BRACKET EVAP	1098999	1	1	1	1	1	1	1	1
J	HOUSING BLOWER	1174167	1	1	1	1	*	*	*	*
J	HOUSING BLOWER	1174168	*	*	*	*	1	1	1	1
K	BOX BLW	1174396	1	1	1	1	1	1	1	1
M	HOOD FLUE ALCT	1054621	1	1	1	1	1	1	1	1
MM	SUPPORT, FLUE	1054620	1	1	1	1	1	1	1	1
MMM	GASKET, EXTENSION	1065260	1	1	1	1	1	1	1	1
N	SHIELD BURNER ALCT	1054422	1	1	*	*	1	1	*	*
N	SHIELD BURNER ALCT	1054267	*	*	1	1	*	*	*	*
N	SHIELD BURNER ALCT	1054382	*	*	*	*	*	*	1	1
O	POST, CNTR	1068163	1	1	1	1	1	1	1	1
P	PANEL, SUPPLY AIR	1111268	1	1	1	1	1	1	1	1
Q	PANEL, RETURN AIR	1111269	1	1	1	1	1	1	1	1
R	COVER, DUCTS	1111275	2	2	2	2	2	2	2	2
RR	COVER, CONT BOX	1174449	1	1	1	1	1	1	1	1
S	PANEL, ACCESS	1068184	1	1	1	1	1	1	1	1
T	SUPPORT, MANF	1084327	2	2	2	2	2	2	2	2
U	PANEL BLR ACC	1111270	1	1	1	1	1	1	1	1
V	POST RETURN AIR	1068168	1	1	1	1	1	1	1	1
W	POST, CNR (HEATING)	1174442	1	1	1	1	1	1	1	1
X	POST, CNR (COND)	1068172	1	1	1	1	1	1	1	1
Y	PANEL, FILTER	1111271	1	1	1	1	1	1	1	1
Z	PANEL, EVAP COIL BAFF	1111281	1	1	1	1	1	1	1	1
ZZ	PAN, DRAIN	1172244	1	1	1	1	1	1	1	1
V	BRACKET, COMPONENT MTG	1084157	1	*	1	*	1	*	1	*
PARTS NOT SHOWN										
)	NAT >LP CONVERSION	1173857	1	1	1	1	1	1	1	1
)	NAT >LP CONVERSION	1173859	1	1	1	1	1	1	1	1
)	NAT >LP CONVERSION	1173861	1	1	1	1	1	1	1	1
)	LP>NAT GAS CONVERSION	1173863	1	1	1	1	1	1	1	1
)	HARNESS, WIRE (DUAL CAP YAC)	1174424	1	1	1	1	1	1	1	1
)	HARNESS, WIRE (DUAL CAP ADP)	1174320	1	1	1	1	1	1	1	1
)	FILTER FG 20X30X2 S	1054503	2	2	2	2	2	2	2	2

PGX3 1 PHASE PARTS LIST

KEY NO.	DESCRIPTION	FAST PART NO.								
			PGX348140K00A1	PGX348140K01A1	PGX360080K00A1	PGX360080K01A1	PGX360120K00A1	PGX360120K01A1	PGX360140K00A1	PGX360140K01A1
1	COMP ZPS40K4E-PFV-130	ZPS40K4EPFV130	1	1	*	*	*	*	*	*
1	COMP ZPS51K4E-PFV-130	ZPS51K4EPFV130	*	*	1	1	1	1	1	1
2	MTR CND 1/230 1/4 1100/1	1173700	1	1	*	*	*	*	*	*
2	MTR CND 1/230 1/4	1171335	*	*	1	1	1	1	1	1
3	FAN C 22" 3B 1/2" 24 INT	1171220	1	1	*	*	*	*	*	*
3	FAN C 22" 3B 1/2" 28 INT	1171219	*	*	1	1	1	1	1	1
4	COIL, EVAP MANIFOLDS INCL.	1174357	1	1	*	*	*	*	*	*
4	COIL, EVAP MANIFOLDS INCL.	1174358	*	*	1	1	1	1	1	1
7	DISTRIBUTOR	1174359	1	1	*	*	*	*	*	*
7	DISTRIBUTOR	1174243	*	*	1	1	1	1	1	1
8	BAFFLE NOX (low nox models only)	1173201	*	7	*	4	*	6	*	7
9	MOUNT KIT BLOWER MOTOR	1174295	1	1	1	1	1	1	1	1
10	WHEEL DD11x10x1/2 CW CV	1173815	1	1	1	1	1	1	1	1
11	MTR BLR 1/230 1 HP	1174282	1	1	*	*	*	*	*	*
11	MTR BLR 1/230 1 HP	1174362	*	*	1	1	1	1	1	1
12	CAP RN RD 370V 5+45	1172124	1	1	*	*	*	*	*	*
12	CAP RN RD 370V 10+80	1173703	*	*	1	1	1	1	1	1
13	CONTACTOR 1P 40A 24V	1173690	1	1	1	1	1	1	1	1
14	BREAKER 3.2A 1 POLE 250V	1171114	1	1	1	1	1	1	1	1
15	TRANS 200/230/460>24 75VA	1171496	1	1	1	1	1	1	1	1
16	CIRCUIT BOARD X-13	1174144	1	1	1	1	1	1	1	1
17	COIL, COND MANIFOLDS INCL.	1174367	1	1	*	*	*	*	*	*
17	COIL, COND MANIFOLDS INCL.	1174368	*	*	1	1	1	1	1	1
18	PLUG COMP WIRE (SM)	1173826	1	1	1	1	1	1	1	1
19	PLUG COMP SOLENOID COIL 85"LDS	1173695	1	1	1	1	1	1	1	1
20	PORT ASY VLV/SWT	1083619	1	1	1	1	1	1	1	1
23	HTR CC WP 40W240V	1173705	1	1	1	1	1	1	1	1
25	SWITCH PRESS HI O650 C420	1174407	1	1	1	1	1	1	1	1
26	VALVE TXV 4.0 R410 SHT 88	1174410	1	1	*	*	*	*	*	*
26	VALVE TXV 5.0 R410 SHT 90	1174411	*	*	1	1	1	1	1	1
29	IGNITOR ASY REMOTE SPARK	1173831	1	1	1	1	1	1	1	1
30	TUBE SENSOR 3/16" ID	1013088	1	1	1	1	1	1	1	1
31	BURNER ASY 4 SECT	1008725	*	*	1	1	*	*	*	*
31	BURNER ASY 6 SECT	1009179	*	*	*	*	1	1	*	*
31	BURNER ASY 7 SECT	1009180	1	1	*	*	*	*	1	1
32	SWITCH LMT 300-M	1013102	1	1	1	1	1	1	1	1
33	IGNITOR SPARK	1173828	1	1	1	1	1	1	1	1
34	SENSOR FLAME	1173830	1	1	1	1	1	1	1	1
35	VALVE N HSI SNAP HW VR8205S	1173845	1	1	1	1	1	1	1	1
36	ORIFICE MAIN 44	1011352	7	7	4	4	6	6	7	7
37	MANIFOLD 4 SECT	1004140	*	*	1	1	*	*	*	*
37	MANIFOLD 6 SECT	1054272	*	*	*	*	1	1	*	*
37	MANIFOLD 7 SECT	1054414	1	1	*	*	*	*	1	1
38	SWITCH LMT 135-30 SB	1065295	1	1	1	1	1	1	1	1
39	BOX COLLECTOR ALCT	1098340	1	1	1	1	1	1	1	1
40	GASKET COLL BOX	1065210	1	1	1	1	1	1	1	1
41	HT EX TUBE 4S SS	1174429	*	*	1	1	*	*	*	*
41	HT EX TUBE 6S SS	1174431	*	*	*	*	1	1	*	*
41	HT EX TUBE 7S SS	1174432	1	1	*	*	*	*	1	1
42	PLATE, INJECTOR-4	1084330	*	*	1	1	*	*	*	*

KEY NO.	DESCRIPTION	FAST PART NO.								
			PGX348140K00A1	PGX348140K01A1	PGX360080K00A1	PGX360080K01A1	PGX360120K00A1	PGX360120K01A1	PGX360140K00A1	PGX360140K01A1
42	PLATE, INJECTOR-6	1084332	*	*	*	*	1	1	*	*
44	GASKET, COMB BLW	607014	1	1	1	1	1	1	1	1
45	BLOWER VENT PKG	1054268	1	1	1	1	1	1	1	1
46	BOARD CONTROL YAC	1173838	1	1	1	1	1	1	1	1
48	SWITCH PRESS LO O20 C45	1174412	1	1	1	1	1	1	1	1
54	SWITCH PRESS COMP SOL	1174413	1	1	1	1	1	1	1	1
55	DRIER LIQ 08 CU IN 3/8 SWEAT	1173679	1	1	1	1	1	1	1	1
56	SWITCH VENT PRESS	1172198	1	1	1	1	1	1	1	1
58	RAIL, BASE W/FORK SLOTS	1054464	1	1	1	1	1	1	1	1
59	RAIL, BASE W/FORK SLOTS	1084078	1	1	1	1	1	1	1	1
60	RAIL, BASE W/FORK SLOTS	1065001	1	1	1	1	1	1	1	1
61	RAIL, BASE WO/FORK SLOTS	1113559	1	1	1	1	1	1	1	1
A	PANEL, TOP "C CHASSIS"	1174393	1	1	1	1	1	1	1	1
B	GRILLE OUTLET	1174394	1	1	1	1	1	1	1	1
C	GRILLE COND INLET	1064545	1	1	1	1	1	1	1	1
D	GRILLE COND INLET	1064547	1	1	1	1	1	1	1	1
E	GRILLE COND INLET	1064546	*	*	1	1	1	1	1	1
F	NUT CAP	1172740	4	4	4	4	4	4	4	4
G	PANEL PORT P250	1068164	1	1	1	1	1	1	1	1
H	PLATE PORT P250	1068189	1	1	1	1	1	1	1	1
I	BRACKET EVAP	1098999	1	1	1	1	1	1	1	1
J	HOUSING BLOWER	1174168	1	1	1	1	1	1	1	1
K	BOX BLW	1174396	1	1	1	1	1	1	1	1
M	HOOD FLUE ALCT	1054621	1	1	1	1	1	1	1	1
MM	SUPPORT, FLUE	1054620	1	1	1	1	1	1	1	1
MMM	GASKET, EXTENSION	1065260	1	1	1	1	1	1	1	1
N	SHIELD BURNER ALCT L	1054422	*	*	1	1	*	*	*	*
N	SHIELD BURNER ALCT L	1054382	*	*	*	*	1	1	*	*
N	SHIELD BURNER ALCT L	1054415	1	1	*	*	*	*	1	1
O	POST, CNTR	1068163	1	1	1	1	1	1	1	1
P	PANEL, SUPPLY AIR	1111268	1	1	1	1	1	1	1	1
Q	PANEL, RETURN AIR	1111269	1	1	1	1	1	1	1	1
R	COVER, DUCTS	1111275	2	2	2	2	2	2	2	2
RR	COVER, CONT BOX	1174449	1	1	1	1	1	1	1	1
S	PANEL, ACCESS	1068184	1	1	1	1	1	1	1	1
T	SUPPORT, MANF	1084327	2	2	2	2	2	2	2	2
U	PANEL BLR ACC	1111270	1	1	1	1	1	1	1	1
V	POST RETURN AIR	1068168	1	1	1	1	1	1	1	1
W	POST, CNR (HEATING)	1174442	1	1	1	1	1	1	1	1
X	POST, CNR (COND)	1068172	1	1	1	1	1	1	1	1
Y	PANEL, FILTER	1111271	1	1	1	1	1	1	1	1
Z	PANEL, EVAP COIL BAFF	1111281	1	1	1	1	1	1	1	1
ZZ	PAN, DRAIN	1172244	1	1	1	1	1	1	1	1
PARTS NOT SHOWN										
)	NAT >LP CONVERSION	1173857	1	1	1	1	1	1	1	1
)	NAT >LP CONVERSION	1173859	1	1	1	1	1	1	1	1
)	NAT >LP CONVERSION	1173861	1	1	1	1	1	1	1	1
)	LP>NAT GAS CONVERSION	1173863	1	1	1	1	1	1	1	1
)	HARNESS, WIRE (DUAL CAP YAC)	1174424	1	1	1	1	1	1	1	1
)	HARNESS, WIRE (DUAL CAP ADP)	1174320	1	1	1	1	1	1	1	1
)	FILTER FG 20X30X2 S	1054503	2	2	2	2	2	2	2	2

PGX3

NOTE: This illustration is for reference only. Your unit may differ in appearance or may not include all components shown.

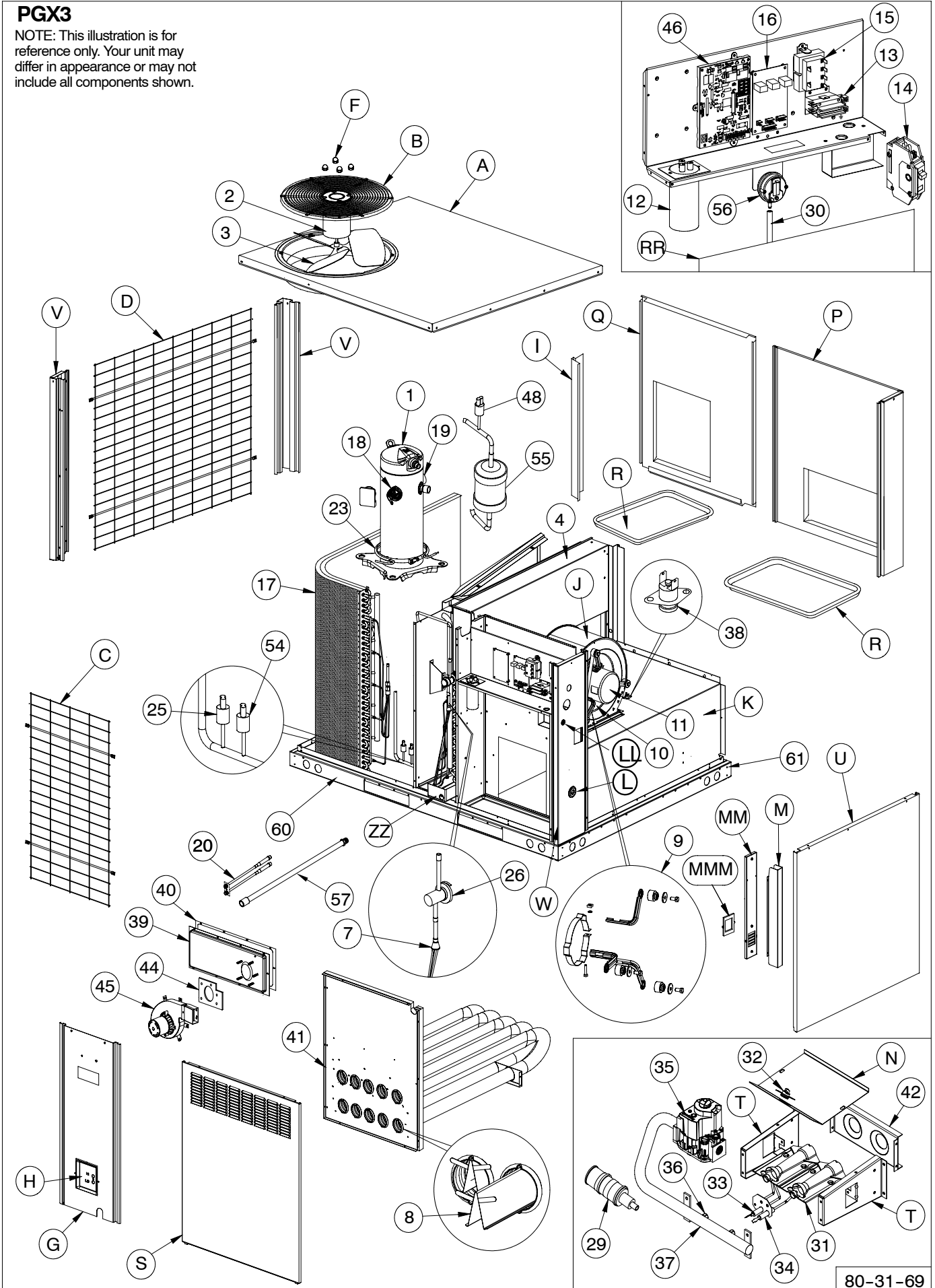

80-31-69

PGX3

NOTE: This illustration is for reference only. Your unit may differ in appearance or may not include all components shown.

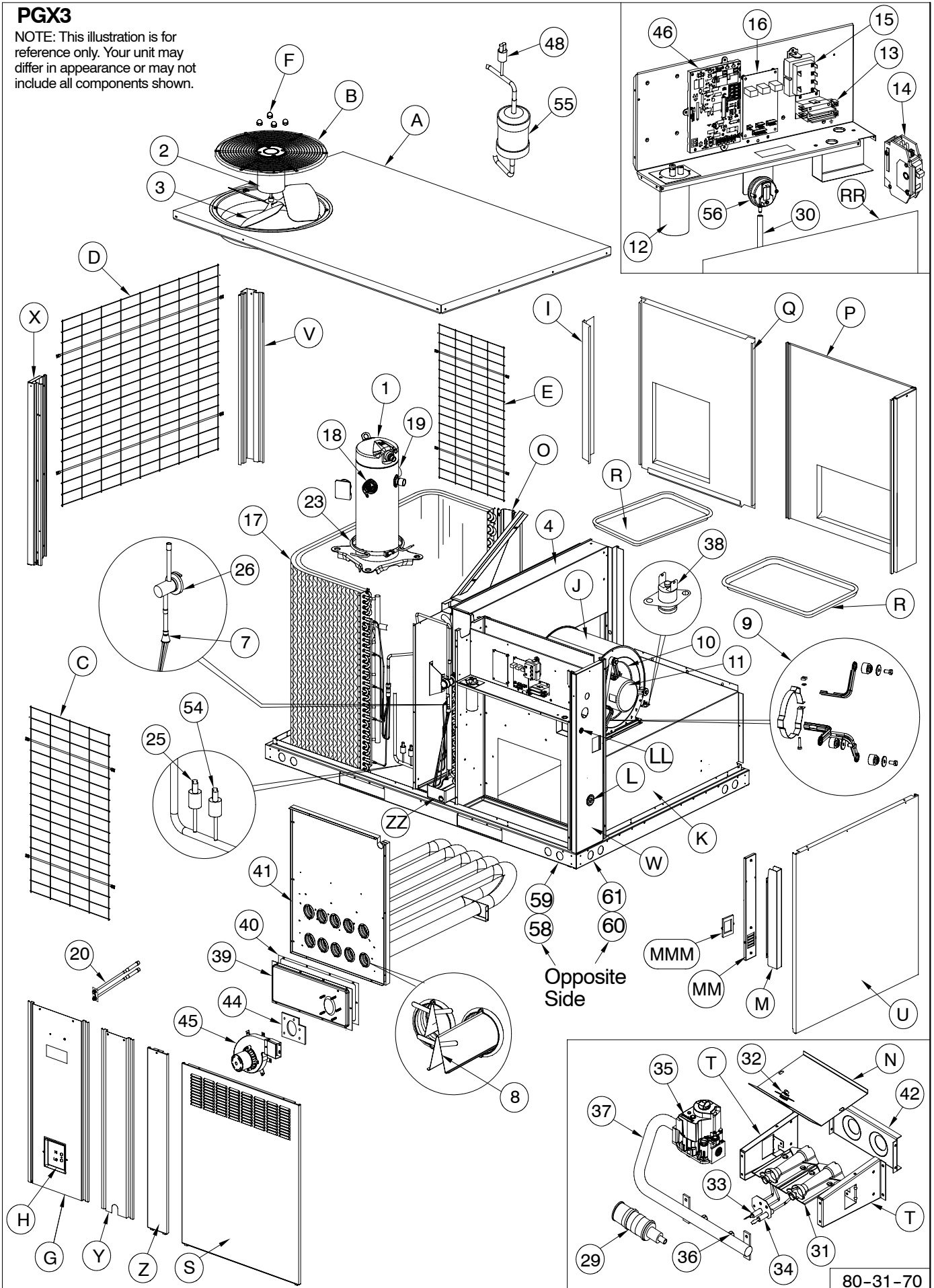

80-31-70

Charging Procedure

- 1- Measure Discharge line pressure by attaching a gauge to the service port.
- 2- Measure the Liquid line temperature by attaching a temperature sensing device to it.
- 3- Insulate the temperature sensing device so that the Outdoor Ambient doesn't affect the reading.
- 4- Refer to the required Subcooling in the table to find the required Subcooling based on the model size and the Outdoor Ambient temperature.
- 5- Interpolate if the Outdoor temperature lies in between the table values. Extrapolate if the temperature lies beyond the table range.
- 6- Find the Pressure Value corresponding to the measured Pressure on the Compressor Discharge line.
- 7- Read across from the Pressure reading to obtain the Liquid line temperature for a required Subcooling.
- 8- Add Charge if the measured temperature is higher than the liquid line temperature value in the table.
- 9- Add Charge using the service connection on the Suction line of the Compressor.

Model Size	Required Subcooling of ^(°C) Outdoor Ambient Temperature				
	75 (24)	82 (28)	85 (29)	95 (35)	105 (41)
024	17.8 (9.9)	17.5 (9.7)	17.4 (9.6)	16.9 (9.4)	16.4 (9.1)
030	16.6 (9.2)	16.4 (9.1)	16.3 (9.1)	16 (8.9)	15.7 (8.7)
036	24.2 (13.5)	24.5 (13.6)	24.6 (13.7)	25 (13.9)	25.4 (14.1)
042	23.8 (13.2)	23.5 (13.1)	23.4 (13)	23 (12.8)	22.6 (12.6)
048	26.1 (14.5)	25 (13.9)	24.5 (13.6)	23 (12.8)	21.5 (11.9)
060	20.8 (11.5)	20.5 (11.4)	20.4 (11.3)	20 (11.1)	19.6 (10.9)

Required Liquid Line Temperature for a Specific Subcooling (R-410A)

Pressure (psig)	Required Subcooling ^(°F)				
	5	10	15	20	25
189	61	56	51	46	41
196	63	58	53	48	43
203	66	61	56	51	46
210	68	63	58	53	48
217	70	65	60	55	50
224	72	67	62	57	52
231	74	69	64	59	54
238	76	71	66	61	56
245	77	72	67	62	57
252	79	74	69	64	59
260	81	76	71	66	61
268	83	78	73	68	63
276	85	80	75	70	65
284	87	82	77	72	67
292	89	84	79	74	69
300	91	86	81	76	71
309	93	88	83	78	73
318	95	90	85	80	75
327	97	92	87	82	77
336	99	94	89	84	79
345	101	96	91	86	81
354	103	98	93	88	83
364	105	100	95	90	85
374	107	102	97	92	87
384	108	103	98	93	88
394	110	105	100	95	90
404	112	107	102	97	92
414	114	109	104	99	94
424	116	111	106	101	96
434	118	113	108	103	98
444	119	114	109	104	99
454	121	116	111	106	101
464	123	118	113	108	103
474	124	119	114	109	104
484	126	121	116	111	106
494	127	122	117	112	107
504	129	124	119	114	109
514	131	126	121	116	111
524	132	127	122	117	112
534	134	129	124	119	114

Pressure (kPa)	Required Subcooling ^(°C)				
	3	6	8	11	14
1303	13	13	11	8	5
1351	13	15	12	9	6
1399	13	16	13	10	8
1448	13	17	14	11	9
1496	13	18	15	13	10
1544	13	19	16	14	11
1593	13	20	18	15	12
1641	13	21	19	16	13
1689	13	22	20	17	14
1737	13	23	21	18	15
1792	13	25	22	19	16
1848	13	26	23	20	17
1903	13	27	24	21	19
1958	13	28	25	22	20
2013	13	29	26	23	21
2068	13	30	27	24	22
2130	13	31	28	26	23
2192	13	32	29	27	24
2254	13	33	31	28	25
2316	13	34	32	29	26
2378	13	35	33	30	27
2440	13	36	34	31	28
2509	13	38	35	32	29
2578	13	39	36	33	30
2647	13	40	37	34	31
2716	13	41	38	35	32
2785	13	42	39	36	33
2854	13	43	40	37	34
2923	13	44	41	38	35
2992	13	45	42	39	36
3061	13	46	43	40	37
3130	13	47	44	41	38
3199	13	48	45	42	39
3268	13	48	46	43	40
3337	13	49	47	44	41
3406	13	50	47	45	42
3475	13	51	48	46	43
3544	13	52	49	46	44
3612	13	53	50	47	45
3681	13	54	51	48	45

PGX3 - 24

ID Airflow (SCFM)		700					800					900				
		Entering Indoor Temperature - Degrees F, Wet Bulb														
		57	62	63 ††	67	72	57	62	63 ††	67	72	57	62	63 ††	67	72
75	MBh†	21.7	22.5	22.9	24.7	27.1	22.8	23.2	23.5	25.3	27.7	23.7	23.8	24.0	25.8	28.2
	S/T‡	0.99	0.90	0.72	0.69	0.51	0.99	0.95	0.75	0.73	0.53	0.99	0.99	0.79	0.76	0.54
	AMPS*	7.0	7.5	7.5	7.6	7.7	7.3	7.3	7.3	7.4	7.5	7.5	7.5	7.5	7.6	7.7
	HI PR	314	315	316	322	331	316	316	317	323	332	321	321	319	326	334
	LO PR	128	129	131	141	154	131	131	132	142	156	138	139	136	146	160
85	MBh†	21.0	21.5	21.9	23.6	25.9	22.0	22.2	22.5	24.2	26.5	22.8	22.9	22.9	24.6	26.9
	S/T‡	0.99	0.92	0.73	0.71	0.52	0.99	0.97	0.77	0.74	0.53	0.99	0.99	0.80	0.78	0.55
	AMPS*	7.8	8.3	8.3	8.4	8.5	8.1	8.1	8.1	8.2	8.3	8.3	8.3	8.3	8.4	8.6
	HI PR	357	357	358	364	373	359	359	359	365	374	364	364	361	368	377
	LO PR	131	131	132	143	156	134	134	134	144	158	141	141	138	148	161
95	MBh†	20.2	20.5	20.9	22.5	24.6	21.1	21.1	21.4	23.0	25.2	21.9	21.9	21.8	23.4	25.6
	S/T‡	0.99	0.95	0.75	0.72	0.52	0.99	0.99	0.79	0.76	0.54	0.99	0.99	0.82	0.80	0.56
	AMPS*	8.7	9.2	9.2	9.3	9.4	9.0	9.0	9.0	9.1	9.2	9.2	9.3	9.2	9.3	9.4
	HI PR	404	404	404	411	420	406	406	405	412	421	411	411	408	414	423
	LO PR	133	134	134	144	158	136	137	135	146	159	144	144	139	150	163
105	MBh†	19.3	19.5	19.7	21.3	23.3	20.2	20.2	20.2	21.7	23.8	20.9	21.0	20.6	22.1	24.2
	S/T‡	0.99	0.97	0.77	0.74	0.53	0.99	0.99	0.81	0.78	0.55	0.99	0.99	0.85	0.82	0.58
	AMPS*	9.7	10.2	10.2	10.3	10.4	10.0	10.0	10.0	10.1	10.2	10.2	10.2	10.2	10.3	10.4
	HI PR	456	456	455	462	471	458	458	456	463	472	463	463	459	465	474
	LO PR	136	137	136	146	160	139	140	137	148	161	147	147	141	151	165
115	MBh†	18.4	18.4	18.5	20.0	21.9	19.2	19.2	18.9	20.4	22.3	19.8	19.9	19.3	20.7	22.6
	S/T‡	0.99	0.99	0.79	0.76	0.54	0.99	0.99	0.83	0.81	0.57	0.99	0.99	0.87	0.85	0.59
	AMPS*	10.8	11.3	11.3	11.4	11.5	11.1	11.1	11.1	11.2	11.3	11.3	11.3	11.3	11.4	11.5
	HI PR	512	512	511	517	526	514	514	512	518	526	519	519	514	521	529
	LO PR	139	140	137	148	162	142	143	139	149	163	150	150	142	153	166
Air Delivery in CFM - Dry Coil - No Filter (Add .05 Static Press for Wet Coil)																
Speed Tap		External Static Pressure (Inch Water Col)														
		0.1	0.2	0.3	0.4	0.5	0.6	0.7	0.8	0.9	1.0					
1	661	478	334	262	219	196	-	-	-	-						
2	711	655	623	564	529	481	431	392	334	305						
3	869	842	809	768	736	684	650	599	569	523						
4	951	914	883	858	811	775	733	697	658	618						
5	1251	1218	1194	1170	1139	1100	1063	988	871	745						

50CY501045 - 3.0

PGX3 - 30

OD Ambient (°F)		ID Airflow (SCFM)		875					1000					1125				
				Entering Indoor Temperature - Degrees F, Wet Bulb														
				57	62	63 ††	67	72	57	62	63 ††	67	72	57	62	63 ††	67	72
75	MBh†	26.6	27.6	28.0	30.1	32.9	27.9	28.3	28.7	30.9	33.7	29.0	29.0	29.3	31.4	34.2		
	S/T‡	1.03	0.94	0.75	0.72	0.53	1.03	0.98	0.78	0.75	0.54	1.03	1.03	0.81	0.79	0.56		
	AMPS*	9.1	9.6	9.6	9.7	9.9	9.4	9.4	9.4	9.5	9.7	9.6	9.6	9.7	9.8	9.9		
	HI PR	318	319	320	326	335	320	320	321	327	336	325	325	323	330	338		
	LO PR	128	129	131	141	154	131	131	132	142	156	138	139	136	146	160		
85	MBh†	25.7	26.4	26.8	28.8	31.5	26.9	27.1	27.4	29.5	32.1	27.9	27.9	27.9	30.0	32.7		
	S/T‡	1.03	0.96	0.76	0.73	0.53	1.03	1.01	0.79	0.77	0.55	1.03	1.03	0.83	0.81	0.57		
	AMPS*	10.1	10.6	10.6	10.7	10.9	10.4	10.4	10.4	10.5	10.7	10.6	10.6	10.6	10.8	10.9		
	HI PR	361	361	362	368	377	363	363	363	369	378	368	368	365	372	381		
	LO PR	131	131	132	143	156	134	134	134	144	158	141	141	138	148	161		
95	MBh†	24.7	25.1	25.5	27.4	29.9	25.8	25.8	26.1	28.0	30.5	26.7	26.8	26.5	28.5	31.0		
	S/T‡	1.03	0.98	0.77	0.75	0.54	1.03	1.03	0.81	0.79	0.56	1.03	1.03	0.85	0.83	0.58		
	AMPS*	11.2	11.6	11.7	11.8	11.9	11.5	11.5	11.5	11.6	11.7	11.7	11.7	11.7	11.8	12.0		
	HI PR	408	408	408	415	424	410	410	409	416	425	415	415	412	418	427		
	LO PR	133	134	134	144	158	136	137	135	146	159	144	144	139	150	163		
105	MBh†	23.6	23.8	24.1	25.9	28.3	24.6	24.7	24.6	26.4	28.8	25.5	25.5	25.0	26.9	29.2		
	S/T‡	1.03	1.01	0.79	0.77	0.55	1.03	1.03	0.83	0.81	0.57	1.03	1.03	0.88	0.85	0.60		
	AMPS*	12.4	12.8	12.8	13.0	13.1	12.7	12.7	12.7	12.8	12.9	12.9	12.9	12.9	13.0	13.2		
	HI PR	460	460	459	466	475	462	462	460	467	476	467	467	463	469	478		
	LO PR	136	137	136	146	160	139	140	137	148	161	147	147	141	151	165		
115	MBh†	22.4	22.4	22.6	24.3	26.5	23.3	23.4	23.1	24.8	26.9	24.1	24.1	23.4	25.1	27.3		
	S/T‡	1.03	1.03	0.82	0.79	0.56	1.03	1.03	0.86	0.84	0.59	1.03	1.03	0.91	0.88	0.61		
	AMPS*	13.7	14.1	14.1	14.2	14.4	14.0	14.0	13.9	14.1	14.2	14.2	14.2	14.2	14.3	14.4		
	HI PR	516	516	515	521	530	518	518	516	522	530	523	523	518	525	533		
	LO PR	139	140	137	148	162	142	143	139	149	163	150	150	142	153	166		
Air Delivery in CFM - Dry Coil - No Filter (Add .05 Static Press for Wet Coil)																		
Speed Tap		External Static Pressure (Inch Water Col)																
		0.1	0.2	0.3	0.4	0.5	0.6	0.7	0.8	0.9	1.0							
1	754	708	671	618	584	524	494	443	382	342								
2	789	747	714	668	630	582	542	495	460	403								
3	958	923	894	857	828	786	750	712	661	630								
4	1106	1080	1048	1017	992	954	924	881	838	755								
5	1255	1227	1201	1164	1138	1112	1077	1027	934	809								

50CY501075 - 3.0

† Net Capacity (BTU/HR / 1000)

‡ Sensible Heat Ratio (Sensible Capacity / Net Capacity)

†† At 75°F entering dry bulb - Tennessee Valley Authority [TVA] rating conditions; all others at 80°F entering dry bulb.

PGX3 - 36

OD Ambient (°F)	ID Airflow (SCFM)	1050					1200					1350				
		Entering Indoor Temperature - Degrees F, Wet Bulb														
		57	62	63 "	67	72	57	62	63 "	67	72	57	62	63 "	67	72
75	MBh†	33.2	34.4	35.0	37.9	41.7	34.8	35.5	36.0	38.9	42.7	36.2	36.4	36.7	39.7	43.6
	S/T‡	1.00	0.91	0.72	0.69	0.50	1.00	0.95	0.75	0.72	0.52	1.00	0.99	0.78	0.76	0.54
	Total Unit Amps (230-1-60/230-3-60)	11.9 / 7.9	12.4 / 8.2	12.5 / 8.2	12.6 / 8.3	12.7 / 8.4	12.2 / 8	12.3 / 8.1	12.3 / 8.1	12.4 / 8.2	12.5 / 8.3	12.5 / 8.2	12.5 / 8.2	12.5 / 8.2	12.6 / 8.3	12.8 / 8.4
	HI PR	321	322	323	329	338	323	323	324	330	339	328	328	326	333	341
	LO PR	129	130	132	142	155	132	132	133	143	157	139	140	137	147	161
85	MBh†	31.9	32.8	33.3	36.1	39.7	33.4	33.8	34.2	37.0	40.7	34.7	34.8	34.9	37.7	41.4
	S/T‡	1.00	0.93	0.73	0.71	0.51	1.00	0.97	0.77	0.74	0.53	1.00	1.00	0.80	0.78	0.55
	Total Unit Amps (230-1-60/230-3-60)	13.3 / 8.8	13.8 / 9.1	13.8 / 9.1	13.9 / 9.2	14.1 / 9.3	13.6 / 8.9	13.6 / 9	13.6 / 9	13.7 / 9.1	13.9 / 9.2	13.9 / 9.1	13.9 / 9.1	13.9 / 9.1	14 / 9.2	14.2 / 9.3
	HI PR	364	364	365	371	380	366	366	366	372	381	371	371	368	375	384
	LO PR	132	132	133	144	157	135	135	135	145	159	142	142	139	149	162
95	MBh†	30.5	31.1	31.5	34.2	37.7	32.0	32.0	32.3	35.0	38.6	33.2	33.2	33.0	35.7	39.2
	S/T‡	1.00	0.95	0.75	0.72	0.52	1.00	1.00	0.79	0.76	0.54	1.00	1.00	0.82	0.80	0.56
	Total Unit Amps (230-1-60/230-3-60)	14.8 / 9.7	15.2 / 10	15.3 / 10	15.4 / 10.1	15.6 / 10.2	15.1 / 9.9	15.1 / 9.9	15.1 / 9.9	15.2 / 10	15.4 / 10.1	15.3 / 10.1	15.3 / 10.1	15.3 / 10.1	15.5 / 10.2	15.6 / 10.3
	HI PR	411	411	411	418	427	413	413	412	419	428	418	418	415	421	430
	LO PR	134	135	135	145	159	137	138	136	147	160	145	145	140	151	164
105	MBh†	29.1	29.3	29.7	32.2	35.6	30.4	30.5	30.4	33.0	36.3	31.6	31.6	31.0	33.6	36.9
	S/T‡	1.00	0.98	0.77	0.74	0.53	1.00	1.00	0.81	0.78	0.55	1.00	1.00	0.85	0.82	0.57
	Total Unit Amps (230-1-60/230-3-60)	16.4 / 10.8	16.8 / 11.1	16.8 / 11.1	17 / 11.2	17.2 / 11.3	16.7 / 11	16.7 / 11	16.7 / 11	16.8 / 11.1	17 / 11.2	16.9 / 11.2	16.9 / 11.2	16.9 / 11.1	17.1 / 11.2	17.2 / 11.3
	HI PR	463	463	462	469	478	465	465	463	470	479	470	470	466	472	481
	LO PR	137	138	137	147	161	140	141	138	149	162	148	148	142	152	166
115	MBh†	27.6	27.6	27.8	30.2	33.3	28.8	28.9	28.4	30.8	34.0	29.9	29.9	28.9	31.4	34.6
	S/T‡	1.00	1.00	0.79	0.77	0.54	1.00	1.00	0.84	0.81	0.56	1.00	1.00	0.88	0.85	0.59
	Total Unit Amps (230-1-60/230-3-60)	18.1 / 11.9	18.5 / 12.2	18.5 / 12.2	18.7 / 12.3	18.9 / 12.4	18.4 / 12.1	18.4 / 12.1	18.4 / 12.1	18.5 / 12.2	18.7 / 12.3	18.7 / 12.3	18.7 / 12.3	18.6 / 12.3	18.8 / 12.4	19 / 12.5
	HI PR	519	519	518	524	533	521	521	519	525	533	526	526	521	528	536
	LO PR	140	141	138	149	163	143	144	140	150	164	151	151	143	154	167

Air Delivery in CFM - Dry Coil - No Filter (Add .05 Static Press for Wet Coil)

Speed Tap	External Static Pressure (Inch Water Col)									
	0.1	0.2	0.3	0.4	0.5	0.6	0.7	0.8	0.9	1.0
1	876	841	794	756	694	651	598	543	499	464
2	1026	994	949	913	871	841	793	735	683	638
3	1276	1242	1209	1179	1150	1117	1086	1045	998	946
4	1630	1588	1526	1477	1415	1354	1287	1216	1145	1070
5	-	-	-	-	-	-	-	-	-	-

50CY501087 • 4.0

PGX3 - 42

OD Ambient (°F)	ID Airflow (SCFM)	1225					1400					1575				
		Entering Indoor Temperature - Degrees F, Wet Bulb														
		57	62	63 "	67	72	57	62	63 "	67	72	57	62	63 "	67	72
75	MBh†	38.4	39.6	40.2	43.3	47.2	40.2	40.7	41.2	44.3	48.2	41.7	41.8	42.0	45.1	49.0
	S/T‡	0.98	0.90	0.72	0.69	0.50	0.98	0.95	0.75	0.72	0.52	0.98	0.98	0.78	0.76	0.54
	Total Unit Amps (230-1-60/230-3-60)	14.2 / 9.4	14.3 / 9.4	14.3 / 9.4	14.5 / 9.5	14.7 / 9.7	14.3 / 9.4	14.3 / 9.5	14.4 / 9.5	14.5 / 9.6	14.7 / 9.7	14.4 / 9.5	14.4 / 9.5	14.4 / 9.5	14.6 / 9.6	14.8 / 9.8
	HI PR	316	317	318	324	333	318	318	319	325	334	323	323	321	328	336
	LO PR	127	128	130	140	153	130	130	131	141	155	137	138	135	145	159
85	MBh†	37.0	37.8	38.4	41.3	45.0	38.7	38.8	39.3	42.2	45.9	40.1	40.2	40.0	42.9	46.6
	S/T‡	0.98	0.92	0.73	0.70	0.51	0.98	0.97	0.77	0.74	0.53	0.98	0.98	0.80	0.78	0.55
	Total Unit Amps (230-1-60/230-3-60)	15.6 / 10.3	15.6 / 10.3	15.7 / 10.3	15.8 / 10.5	16.1 / 10.6	15.7 / 10.4	15.7 / 10.4	15.7 / 10.4	15.9 / 10.5	16.1 / 10.6	15.8 / 10.4	15.8 / 10.4	15.8 / 10.4	15.9 / 10.5	16.2 / 10.7
	HI PR	359	359	360	366	375	361	361	361	367	376	366	366	363	370	379
	LO PR	130	130	131	142	155	133	133	133	143	157	140	140	137	147	160
95	MBh†	35.4	35.9	36.4	39.2	42.7	37.0	37.1	37.3	40.0	43.5	38.4	38.4	37.9	40.7	44.1
	S/T‡	0.98	0.95	0.75	0.72	0.52	0.98	0.98	0.78	0.76	0.54	0.98	0.98	0.82	0.80	0.56
	Total Unit Amps (230-1-60/230-3-60)	17.1 / 11.3	17.1 / 11.3	17.2 / 11.3	17.3 / 11.4	17.6 / 11.6	17.2 / 11.4	17.2 / 11.4	17.2 / 11.4	17.4 / 11.5	17.6 / 11.6	17.3 / 11.4	17.3 / 11.4	17.3 / 11.4	17.4 / 11.5	17.7 / 11.7
	HI PR	406	406	406	413	422	408	408	407	414	423	414	413	410	416	425
	LO PR	132	133	133	143	157	135	136	134	145	158	143	143	138	149	162
105	MBh†	33.8	34.0	34.4	37.0	40.2	35.3	35.3	35.1	37.7	41.0	36.5	36.5	35.7	38.3	41.5
	S/T‡	0.98	0.97	0.76	0.74	0.53	0.98	0.98	0.81	0.78	0.55	0.98	0.98	0.85	0.83	0.58
	Total Unit Amps (230-1-60/230-3-60)	18.8 / 12.4	18.8 / 12.4	18.8 / 12.4	19 / 12.5	19.2 / 12.7	18.9 / 12.5	18.9 / 12.5	18.9 / 12.4	19 / 12.6	19.3 / 12.7	18.9 / 12.5	18.9 / 12.5	19 / 12.5	19.1 / 12.6	19.3 / 12.7
	HI PR	458	458	457	464	473	460	460	458	465	474	465	465	461	467	476
	LO PR	135	136	135	145	159	138	139	136	147	160	146	146	140	150	164
115	MBh†	32.0	32.1	32.2	34.6	37.6	33.4	33.4	32.8	35.2	38.2	34.4	34.5	33.3	35.7	38.7
	S/T‡	0.98	0.98	0.79	0.76	0.54	0.98	0.98	0.83	0.81	0.57	0.98	0.98	0.88	0.86	0.59
	Total Unit Amps (230-1-60/230-3-60)	20.6 / 13.6	20.6 / 13.6	20.6 / 13.6	20.8 / 13.7	21 / 13.9	20.7 / 13.6	20.7 / 13.7	20.6 / 13.6	20.8 / 13.7	21 / 13.9	20.8 / 13.7	20.8 / 13.7	20.7 / 13.7	20.9 / 13.8	21.1 / 13.9
	HI PR	514	514	513	519	528	516	516	514	520	528	521	521	516	523	531
	LO PR	138	139	136	147	161	141	142	138	148	162	149	149	141	152	165

Air Delivery in CFM - Dry Coil - No Filter (Add .05 Static Press for Wet Coil)

Speed Tap	External Static Pressure (Inch Water Col)									
	0.1	0.2	0.3	0.4	0.5	0.6	0.7	0.8	0.9	1.0
1	973	900	853	797	749	702	642	581	529	476
2	1028	969	924	881	838	789	731	680	617	562
3	1302	1260	1219	1179	1138	1103	1060	1015	963	923
4	1481	1448	1412	1374	1336	1298	1263	1226	1186	1143
5	1569	1537	1500	1463	1423	1389	1353	1317	1276	1208

50CY501098 • 4.0

† Net Capacity (BTU/HR / 1000)
 ‡ Sensible Heat Ratio (Sensible Capacity / Net Capacity)
 †† At 75°F entering dry bulb - Tennessee Valley Authority [TVA] rating conditions; all others at 80°F entering dry bulb.

PGX3 - 48

OD Ambient (°F)	ID Airflow (SCFM)	1400					1600					1800				
		Entering Indoor Temperature - Degrees F, Wet Bulb														
		57	62	63 †	67	72	57	62	63 †	67	72	57	62	63 †	67	72
75	MBh†	42.8	44.1	44.9	48.4	53.1	44.9	45.4	46.0	49.6	54.3	46.7	46.7	46.9	50.5	55.3
	S/T‡	0.98	0.91	0.72	0.69	0.50	0.98	0.95	0.75	0.73	0.52	0.98	0.98	0.79	0.76	0.54
	Total Unit Amps (230-1-60/230-3-60)	15.9 / 10.5	16.4 / 10.8	16.5 / 10.8	16.6 / 11	16.9 / 11.1	16.2 / 10.7	16.3 / 10.7	16.3 / 10.7	16.5 / 10.9	16.7 / 11	16.5 / 10.9	16.5 / 10.9	16.6 / 10.9	16.8 / 11	17 / 11.2
	HI PR	323	324	325	331	340	325	325	326	332	341	330	330	328	335	343
	LO PR	125	126	128	138	151	128	128	129	139	153	135	136	133	143	157
85	MBh†	41.3	42.1	42.8	46.3	50.7	43.2	43.4	43.9	47.3	51.9	44.9	44.9	44.7	48.2	52.7
	S/T‡	0.98	0.93	0.73	0.70	0.51	0.98	0.97	0.77	0.74	0.53	0.98	0.98	0.80	0.78	0.55
	Total Unit Amps (230-1-60/230-3-60)	17.4 / 11.5	17.9 / 11.8	17.9 / 11.8	18.1 / 11.9	18.4 / 12.1	17.7 / 11.7	17.7 / 11.7	17.8 / 11.7	18 / 11.8	18.2 / 12	18 / 11.9	18 / 11.9	18 / 11.9	18.2 / 12	18.5 / 12.2
	HI PR	366	366	367	373	382	368	368	368	374	383	373	373	370	377	386
	LO PR	128	128	129	140	153	131	131	131	141	155	138	138	135	145	158
95	MBh†	39.6	40.1	40.7	44.0	48.3	41.5	41.5	41.7	45.0	49.3	43.0	43.1	42.5	45.8	50.1
	S/T‡	0.98	0.95	0.75	0.72	0.51	0.98	0.98	0.79	0.76	0.54	0.98	0.98	0.82	0.80	0.56
	Total Unit Amps (230-1-60/230-3-60)	19 / 12.5	19.5 / 12.8	19.5 / 12.9	19.7 / 13	20 / 13.2	19.3 / 12.7	19.3 / 12.8	19.4 / 12.8	19.6 / 12.9	19.8 / 13.1	19.6 / 13	19.7 / 13	19.6 / 12.9	19.8 / 13.1	20.1 / 13.2
	HI PR	413	413	413	420	429	415	415	414	421	430	420	420	417	423	432
	LO PR	130	131	131	141	155	133	134	132	143	156	141	141	136	147	160
105	MBh†	37.9	38.0	38.5	41.7	45.7	39.6	39.7	39.4	42.6	46.6	41.1	41.1	40.1	43.3	47.4
	S/T‡	0.98	0.98	0.77	0.74	0.52	0.98	0.98	0.81	0.78	0.55	0.98	0.98	0.85	0.82	0.57
	Total Unit Amps (230-1-60/230-3-60)	20.8 / 13.7	21.2 / 14	21.3 / 14	21.5 / 14.2	21.8 / 14.3	21.1 / 13.9	21.1 / 13.9	21.1 / 13.9	21.3 / 14.1	21.6 / 14.2	21.4 / 14.1	21.4 / 14.1	21.4 / 14.1	21.6 / 14.2	21.9 / 14.4
	HI PR	465	465	464	471	480	467	467	465	472	481	472	472	468	474	483
	LO PR	133	134	133	143	157	136	137	134	145	158	144	144	138	146	162
115	MBh†	36.0	36.1	36.2	39.1	43.0	37.6	37.7	37.0	39.9	43.8	38.9	39.0	37.6	40.6	44.4
	S/T‡	0.98	0.98	0.79	0.76	0.53	0.98	0.98	0.83	0.81	0.56	0.98	0.98	0.88	0.85	0.59
	Total Unit Amps (230-1-60/230-3-60)	22.8 / 15	23.2 / 15.3	23.2 / 15.3	23.4 / 15.4	23.7 / 15.6	23.1 / 15.2	23.1 / 15.2	23 / 15.3	23.3 / 15.5	23.5 / 15.5	23.4 / 15.4	23.4 / 15.4	23.3 / 15.4	23.5 / 15.5	23.8 / 15.7
	HI PR	521	521	520	526	535	523	523	521	527	535	528	528	523	530	538
	LO PR	136	137	134	145	159	139	140	136	146	160	147	147	139	150	163

Air Delivery in CFM - Dry Coil - No Filler (Add .05 Static Press for Wet Coil)

Speed Tap	External Static Pressure (Inch Water Col)									
	0.1	0.2	0.3	0.4	0.5	0.6	0.7	0.8	0.9	1.0
1	1173	1127	1085	1027	983	927	881	821	764	710
2	1304	1256	1216	1167	1126	1077	1026	979	921	875
3	1680	1650	1614	1578	1544	1507	1470	1427	1373	1289
4	1831	1797	1763	1732	1696	1661	1621	1559	1446	1339
5	2103	2051	2001	1942	1878	1809	1723	1632	1526	1388

50CY501104 • 4.0

PGX3 - 60

OD Ambient (°F)	ID Airflow (SCFM)	1750					2000					2250				
		Entering Indoor Temperature - Degrees F, Wet Bulb														
		57	62	63 †	67	72	57	62	63 †	67	72	57	62	63 †	67	72
75	MBh†	55.9	57.2	58.1	62.1	67.2	58.3	58.7	59.4	63.4	68.4	60.4	60.5	60.4	64.4	69.4
	S/T‡	0.96	0.90	0.71	0.68	0.49	0.96	0.95	0.74	0.72	0.51	0.96	0.96	0.78	0.76	0.53
	Total Unit Amps (230-1-60/230-3-60)	20.2 / 13.5	20.8 / 13.8	20.8 / 13.9	21.2 / 14.1	21.6 / 14.4	20.8 / 13.7	20.7 / 13.8	20.7 / 13.8	21.1 / 14	21.5 / 14.3	21 / 14	21 / 14	21 / 14	21.4 / 14.2	21.8 / 14.5
	HI PR	325	326	327	333	342	327	327	328	334	343	332	332	330	337	345
	LO PR	125	126	128	138	151	128	128	129	139	153	135	136	133	143	157
85	MBh†	53.7	54.5	55.4	59.1	63.9	56.0	56.0	56.5	60.3	65.0	57.9	57.9	57.5	61.2	65.9
	S/T‡	0.96	0.92	0.72	0.70	0.50	0.96	0.96	0.76	0.74	0.52	0.96	0.96	0.80	0.78	0.55
	Total Unit Amps (230-1-60/230-3-60)	22 / 14.7	22.5 / 15	22.6 / 15.1	23 / 15.3	23.4 / 15.6	22.5 / 15	22.5 / 15	22.5 / 15	22.8 / 15.2	23.3 / 15.5	22.9 / 15.2	22.9 / 15.2	22.8 / 15.2	23.2 / 15.4	23.6 / 15.7
	HI PR	368	368	369	375	384	370	370	370	376	385	375	375	372	379	388
	LO PR	128	128	129	140	153	131	131	131	141	155	138	138	135	145	158
95	MBh†	51.3	51.7	52.4	56.0	60.5	53.5	53.5	53.5	57.0	61.5	55.2	55.3	54.3	57.8	62.3
	S/T‡	0.96	0.95	0.74	0.72	0.51	0.96	0.96	0.78	0.76	0.53	0.96	0.96	0.82	0.80	0.56
	Total Unit Amps (230-1-60/230-3-60)	24 / 16	24.5 / 16.3	24.6 / 16.4	24.9 / 16.6	25.4 / 16.9	24.4 / 16.3	24.4 / 16.3	24.4 / 16.3	24.8 / 16.5	25.2 / 16.8	24.8 / 16.5	24.8 / 16.5	24.7 / 16.5	25.1 / 16.7	25.5 / 17
	HI PR	415	415	415	422	431	417	417	416	423	432	422	422	419	425	434
	LO PR	130	131	131	141	155	133	134	132	143	156	141	141	136	147	160
105	MBh†	48.8	48.9	49.3	52.6	56.8	50.7	50.8	50.3	53.5	57.7	52.3	52.4	51.0	54.3	58.4
	S/T‡	0.96	0.96	0.76	0.74	0.52	0.96	0.96	0.80	0.79	0.55	0.96	0.96	0.85	0.83	0.57
	Total Unit Amps (230-1-60/230-3-60)	26.2 / 17.4	26.6 / 17.7	26.6 / 17.7	27 / 18	27.4 / 18.3	26.6 / 17.7	26.6 / 17.7	26.5 / 17.7	26.9 / 17.9	27.3 / 18.2	27 / 17.9	27 / 18	26.8 / 17.9	27.2 / 18.1	27.6 / 18.4
	HI PR	467	467	466	473	482	469	469	467	474	483	474	474	470	476	485
	LO PR	133	134	133	143	157	136	137	134	145	158	144	144	138	146	162
115	MBh†	46.0	46.1	45.9	48.9	52.8	47.7	47.8	46.7	49.7	53.5	49.1	49.2	47.4	50.4	54.1
	S/T‡	0.96	0.96	0.78	0.77	0.53	0.96	0.96	0.83	0.82	0.56	0.96	0.96	0.88	0.87	0.59
	Total Unit Amps (230-1-60/230-3-60)	28.5 / 18.9	28.9 / 19.2	28.9 / 19.2	29.2 / 19.4	29.6 / 19.7	28.9 / 19.2	28.9 / 19.2	28.7 / 19.1	29.1 / 19.4	29.5 / 19.6	29.2 / 19.5	29.2 / 19.5	29 / 19.3	29.3 / 19.5	29.8 / 19.8
	HI PR	523	523	522	528	537	525	525	523	529	537	530	530	525	532	540
	LO PR	136	137	134	145	159	139	140	136	146	160	147	147	139	150	163

Air Delivery in CFM - Dry Coil - No Filler (Add .05 Static Press for Wet Coil)

Speed Tap	External Static Pressure (Inch Water Col)									
	0.1	0.2	0.3	0.4	0.5	0.6	0.7	0.8	0.9	1.0
1	1300	1263	1214	1169	1117	1073	1026	975	926	862
2	1368	1321	1283	1231	1197	1144	1105	1038	969	913
3	1839	1807	1772	1735	1702	1667	1629	1590	1535	1460
4	2091	2056	2023	1987	1935	1878	1811	1729	1640	1536
5	2188	2140	2096	2039	1974	1905	1827	1745	1642	1537

† Net Capacity (BTU/HR / 1000)

‡ Sensible Heat Ratio (Sensible Capacity / Net Capacity)

†† At 75°F entering dry bulb - Tennessee Valley Authority [TVA] rating conditions; all others at 80°F entering dry bulb.

50CY501108 • 4.0

PGX3 24 - 60

CONNECTION WIRING DIAGRAM

DANGER: ELECTRICAL SHOCK HAZARD DISCONNECT POWER BEFORE SERVICING

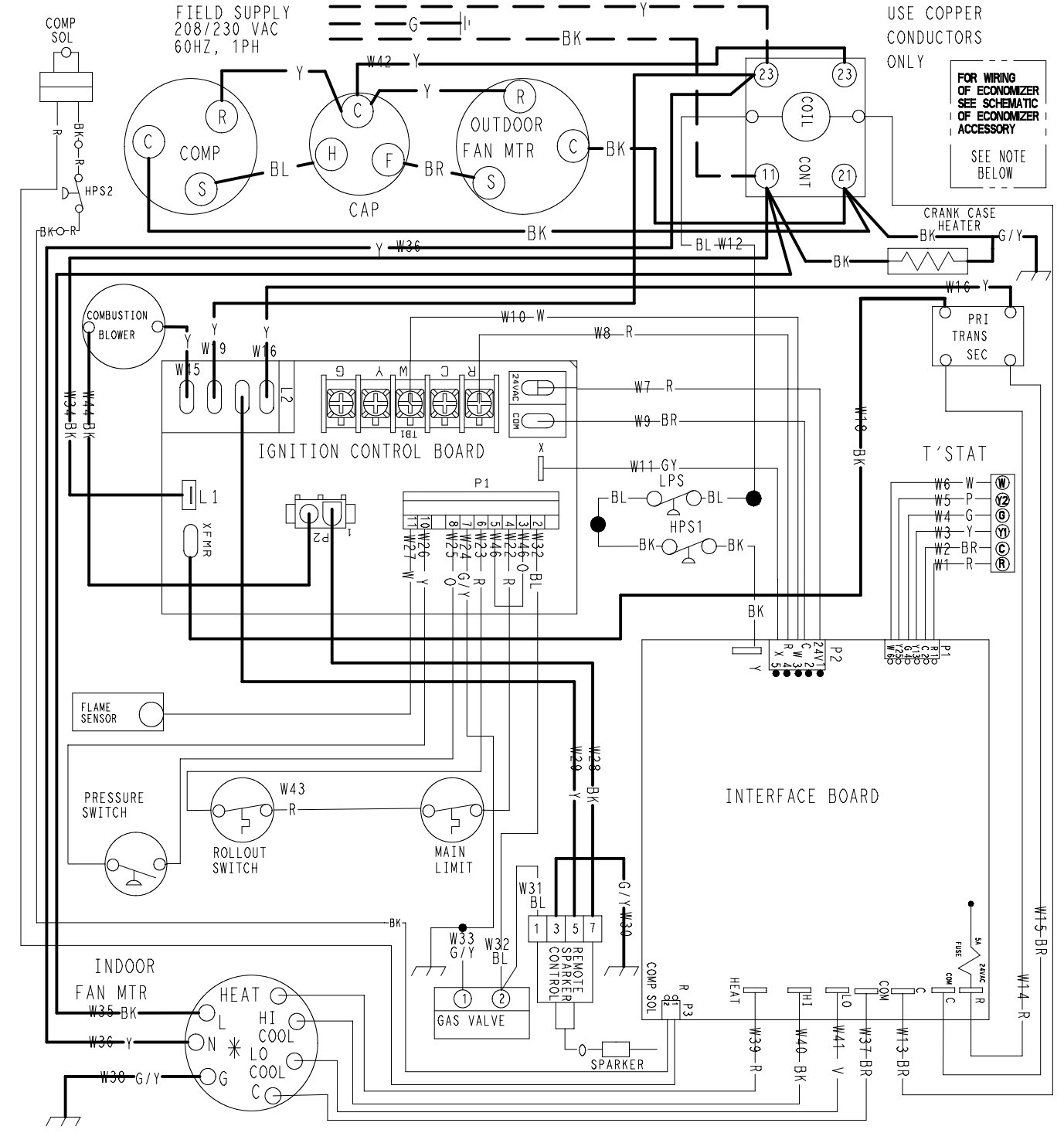

IF ANY OF THE ORIGINAL WIRE AS SUPPLIED WITH THE APPLIANCE MUST BE REPLACED, IT MUST BE REPLACED WITH TYPE AWM-105°C OR ITS EQUIVALENT.

* SEE INSTALLATION INSTRUCTIONS FOR PROPER HEATING AND COOLING CONNECTIONS FOR YOUR UNIT. INDOOR FAN MOTOR PLUGS- "Do Not Disconnect Under Load"

— — — — —	LINE VOLTAGE FACTORY	— — — — —	LOW VOLTAGE FIELD	— — — — —	LOW VOLTAGE FACTORY	— — — — —	LINE VOLTAGE FIELD
— — — — —	INTERNAL CIRCUIT BOARD WIRING	COLOR CODE :		BLACK BK	GREEN G	WHITE W	
		BLUE BL	ORANGE O	BROWN BR	RED R	YELLOW Y	
		GRAY GY	VIOLET V			PINK P	

FOR WIRING OF ECONOMIZER ACCESSORY SEE ACCESSORY WIRING LABEL.

LADDER WIRING DIAGRAM

DANGER: ELECTRICAL SHOCK HAZARD DISCONNECT POWER BEFORE SERVICING

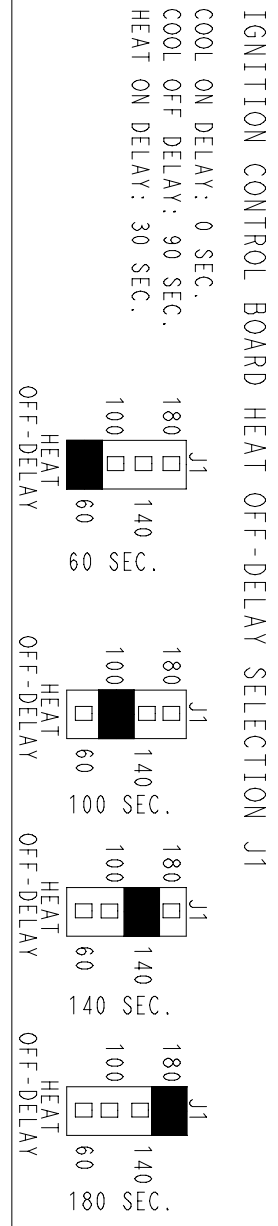
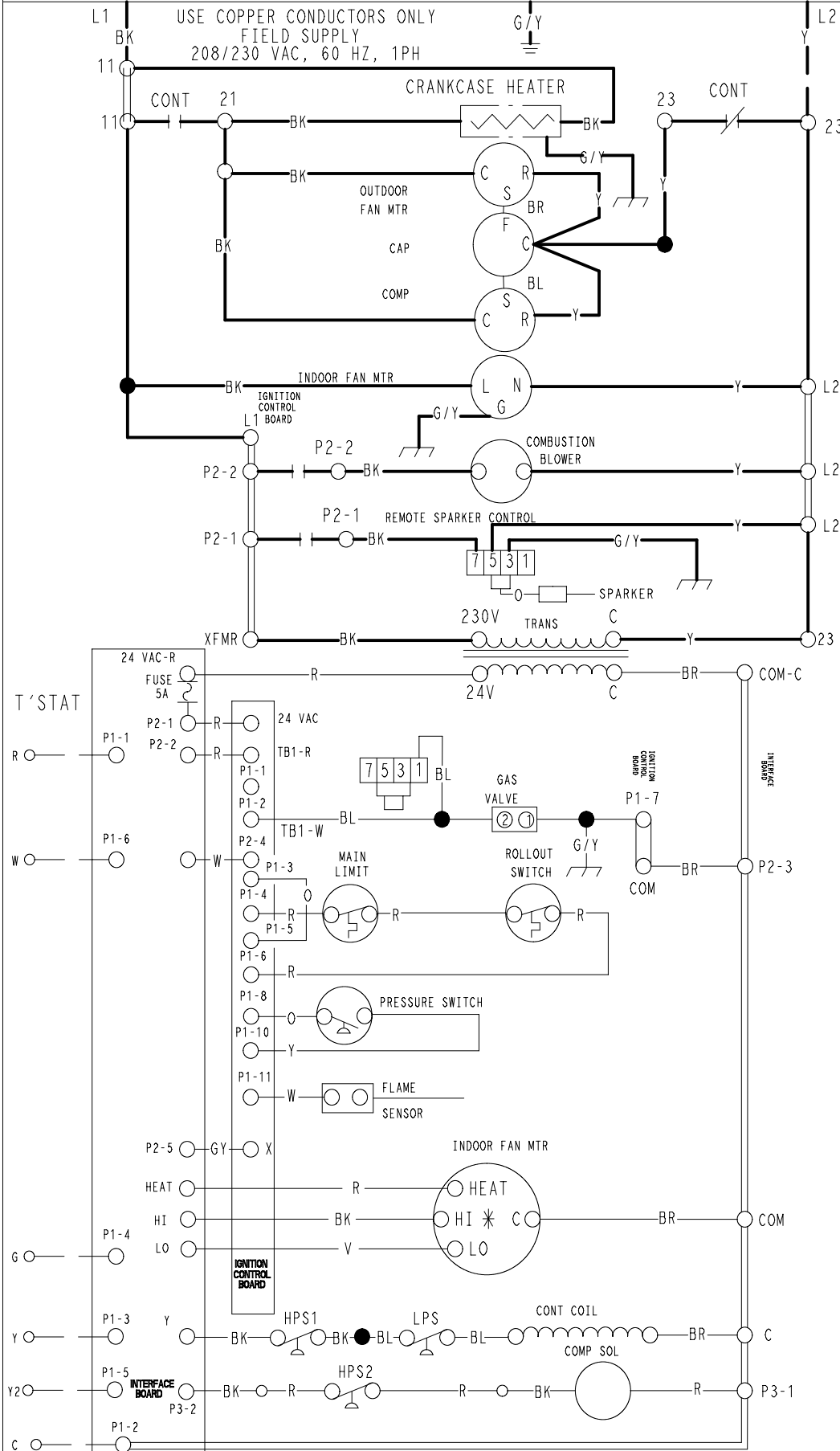

50CY501160 5.0