

Parts List, Tech Labels & Wiring Diagrams for PAB240 & RAMA20 Series

Model Numbers: PAB240N2HC, PAB240N2LC, PAB240N2SC & RAMA20H001C, RAMA20F001C, RAMA20N001C

No.	Description	Part No.	PAB240N2HC RAMA20H001C	PAB240N2LC RAMA20F001C	PAB240N2SC RAMA20N001C
1	Compressor, ZR125KCTF5	1096773	2		
1	ZR125KCTFD	1096550	*	2	
1	ZR125KCTFE	1096774	*	*	2
24	Block, Terminal	170720	1	1	1
35	Filter, Air (20" X 30" X 2")	1054503	4	4	4
36	Valve, Expansion	1083125	2	2	2
37	Coil, Evaporator	1083068	1	1	1
38	Manifold, Evaporator	1083072	1	1	1
39	Manifold, Evaporator	1083071	1	1	1
40	Distributor Asy Evaporator	1098045	1	1	1
41	Distributor Asy Evaporator	1098045	1	1	1
42	Switch, Freeze Stat	1071790	2	2	2
43	Switch, Low Pressure	1083422	2	2	2
44	Port Valve Asy	1083526	2	2	2
45	Switch, High Pressure	1083423	2	2	2
46	Grommet, Compressor Mtg.	79608	8	8	8
47	Bolt, Compressor Mtg.	1057967	8	8	8
48	Manifold, Condenser	1083130	1	1	1
49	Manifold, Condenser (Liquid)	1083060	1	1	1
50	Coil, Condenser	1083537	1	1	1
51	Drier	1083142	2	2	2
52	Coil, Condenser	1083538	1	1	1
53	Manifold, Condenser	1083056	1	1	1
54	Manifold, Condenser (Liquid)	1083131	1	1	1
55	Coil, Condenser, Disch	1082324	1	1	1
56	Manifold, Disch	1083400	1	1	1
57	Manifold, Disch	1083401	1	1	1
58	Fan, Condenser	1083133	2	2	2
59	Motor, Condenser Fan	1083106	2	2	
59		1083926	*	*	2
60	Timer, Compressor Anti-Short Cycle	1085325	2	2	2
64	Transformer, 230V Pri., 24V Sec., 75VA	1072393	1		
64	460V Pri., 24V Sec., 75VA	1084001	*	1	
64	575V Pri., 24V Sec., 65VA	1054638	*	*	1
65	Contact, 40 Amp, 3 Pole	1071334	2	2	2
66	Contact, 30 Amp, 3 Pole, DPS	1082354	1		
66	30 Amp, 3 Pole, DPS	1082358	*	1	1
67	Contact, 20 Amp, 3 Pole	1083121	1	1	1
69	Board, Terminal (Low Voltage)	1066159	1	1	1
70	Pan, Drain	1083413	1	1	1
71	Hose, Drain	1071345	1	1	1
72	Motor, Evaporator Blower	1098474	1	1	
72		1098475	*	*	1
73	Pulley, Blower Motor	1098616	1	1	1
74	Belt, Drive	1098617	1	1	1
75	Pulley, Blower	1098609	1	1	1

Parts List, Tech Labels & Wiring Diagrams for PAB240 & RAMA20 Series

No.	Description	Part No.	PAB240N2HC RAMA20H001C	PAB240N2LC RAMA20F001C	PAB240N2SC RAMA20N001C
77	Blower, Belt Drive	1081250	1	1	1
78	Block, Fuse	1083531	1		
78		1071623	*	1	
78		1071622	*	*	1
79	Fuse, FRS150	1083439	3		
79	FRS70	91774	*	3	
79	FRS60	1083929	*	*	3
80	Wheel, Blower	1162406	1	1	1
81	Shaft, Blower	1162407	1	1	1
82	Bearing, Blower	1162408	2	2	2
A	Grille, Condenser Fan	1072841	2	2	2
AA	Panel, Base (Heat)	*****	1	1	1
AB	Panel, Base (Evap)	*****	1	1	1
AC	Panel, Base (Condenser)	*****	1	1	1
B	Nut, Cap	1083113	8	8	8
B1	Mount, Blower Motor	1099101	1	1	1
B3	Housing, Blower	1162409	1	1	1
B4	Panel, Blower Cutoff	1162410	1	1	1
BB	Rail, Base (Front)	*****	1	1	1
C	Orifice, Condenser Fan	1070458	2	2	2
C1	Bracket, Filter Rack	1083434	1	1	1
C2	Bracket, Filter Rack	1083129	1	1	1
C3	Bracket, Filter Rack	1083435	1	1	1
CC	Post, Evaporator Front	1072822	1	1	1
D	Mount, Condenser Fan	1099100	2	2	2
DD	Panel, Evap Division	1071457	1	1	1
E	Panel, Top Rear	1082267	1	1	1
E1	Panel, Top Front	1082268	1	1	1
EE	Post, Front Control Box	1072824	1	1	1
F	Panel, Top Evap	1072831	1	1	1
FF	Box, Control	1070331	1	1	1
G	Panel, Top Heat	1072779	1	1	1
GG	Post, Evap Division	1082282	1	1	1
H	Plate, Connect	1072729	1	1	1
HH	Channel, Wire	*****	1	1	1
J	Panel, Cond/Evap Division	*****	1	1	1
JJ	Post, Condenser Center	1081171	1	1	1
K	Post, Rear Corner Heat	1072775	1	1	1
KK	Plate, Pressure Port	1068190	1	1	1
L	Panel, Heat Access	1072830	1	1	1
LL	Panel, Condenser Access	1082269	1	1	1
M	Deck, Blower	1083175	1	1	1
MM	Post, Condenser Corner	1081169	1	1	1
N	Post, Front Corner Heat	1072828	1	1	1
NN	Post, Condenser Center	1083151	1	1	1
OO	Post, Condenser Corner	1081170	1	1	1
PP	Post, Condenser Corner	1081242	1	1	1

Parts List, Tech Labels & Wiring Diagrams for PAB240 & RAMA20 Series

No.	Description	Part No.	PAB240N2HC RAMA20H001C	PAB240N2LC RAMA20F001C	PAB240N2SC RAMA20N001C
QQ	Bracket, Coil Brace	1081334	2	2	2
R	Panel, Blower Access	1072803	1	1	1
RR	Cover, Duct (Return)	1072812	1	1	1
S	Panel, Access	1072814	1	1	1
SS	Post, Condenser Corner	1081173	1	1	1
TT	Post, Evaporator Division	1082283	1	1	1
U	Panel, Fuse Division	1071467	1	1	1
U1	Plate, Fuse Panel	1071487	1	1	1
U2	Bracket, Fuse Block	1071602	1	1	1
U3	Cover, Fuse Block	1071603	1	1	1
UU	Rail, Base (Rear)	*****	1	1	1
V	Panel, Evaporator Access	1072789	1	1	1
VV	Panel, Return Air	1072795	1	1	1
W	Panel, Control Box Access	1072783	1	1	1
WW	Panel, Filler	1083174	1	1	1
X	Rail, Base (End)	*****	2	2	2
XX	Panel, Supply Air	1072799	1	1	1
YY	Cover, Duct (Supply)	1072810	1	1	1
ZZ	Post, Evap Rear	1072771	1	1	1
)(Manual, Parts List	51304140300	1	1	1
)(Manual, Installation	51301140100	1	1	1

Parts List, Tech Labels & Wiring Diagrams for PAB240 & RAMA20 Series

Illustrations for reference only.
Your model may differ from
the units shown.

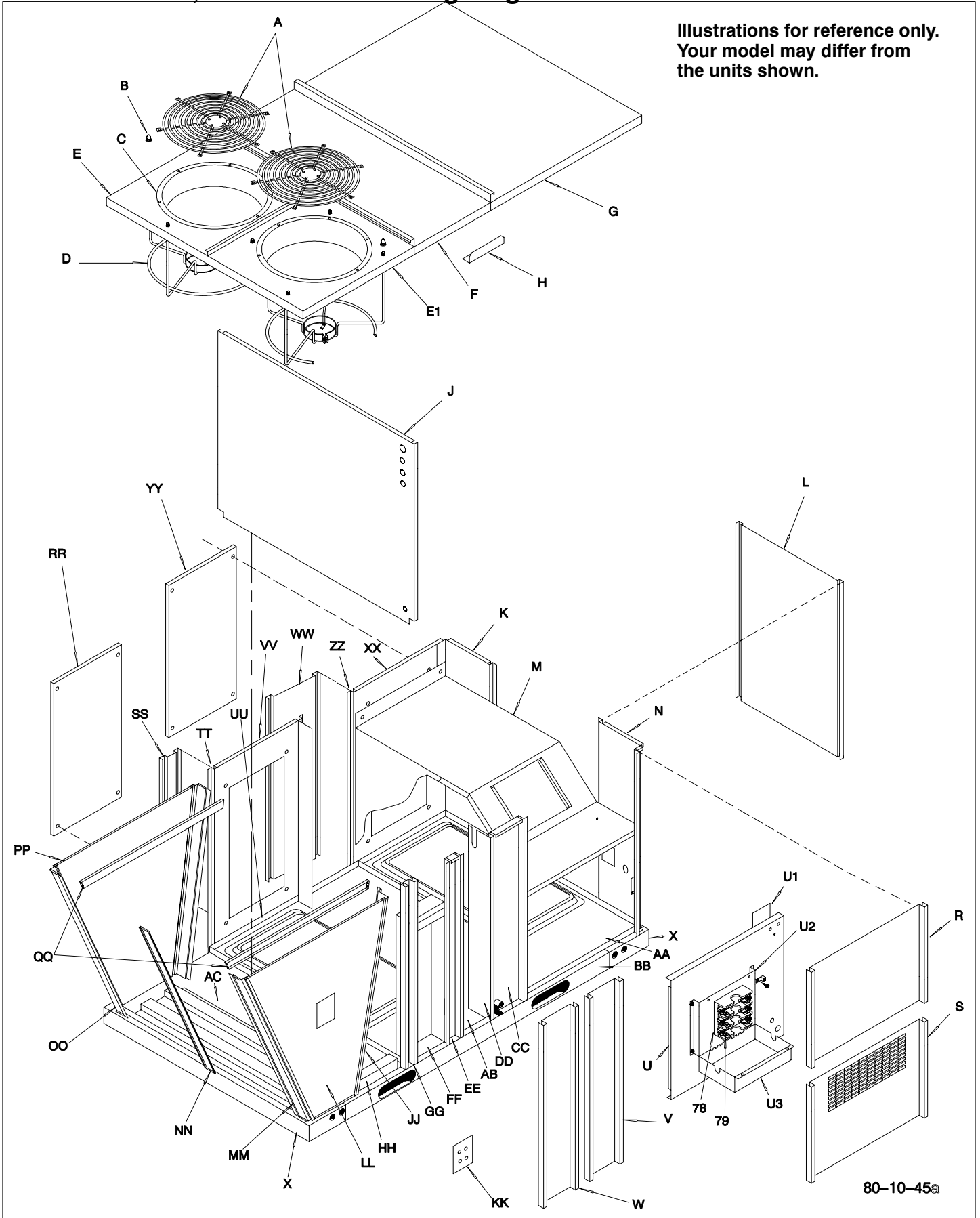

Parts List, Tech Labels & Wiring Diagrams for PAB240 & RAMA20 Series

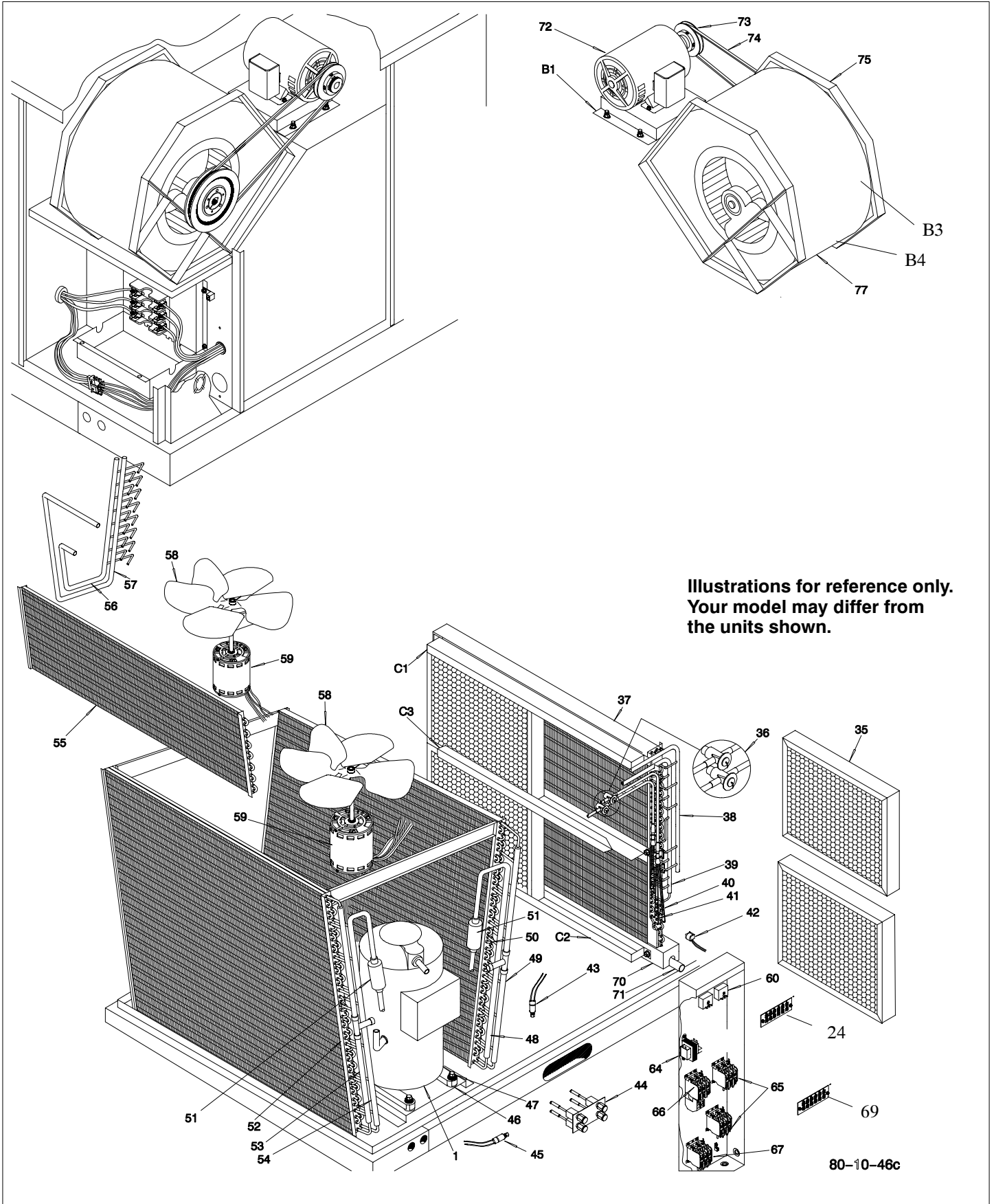

Parts List, Tech Labels & Wiring Diagrams for PAB240 & RAMA20 Series

Unit Size		20 Ton Package Air																				
Voltage/Ph/Hz	208/230/3/60																					
Ampacity	127.1																					
Max. Fuse	160																					
Time Delay Fuse	140																					
Compressors (2)	#1 #2																					
RLA	37.8 37.8																					
LRA	239.0 239.0																					
Condensator Fans	#1 #2																					
Blades/Size/Pitch	5/24/40 5/24/40																					
Motor-Hp	1.5 1.5																					
FLA	31.4 31.4																					
LRA	23.0 23.0																					
RPM	1140 1140																					
CFM	8000 8000																					
Evaporator Fan (1)																						
Voltage/Phase/Hz	230/3/60																					
Max. Cont. BHP	11.5																					
FLA / LRA	31.4 / 218																					
Fan RPM Range	1314 - 1556																					
CFM	8000																					
Controls																						
Hi Pressure	420 / 300																					
Lo Pressure	5 / 20																					
Transformer VA	75																					
Comp. Anti-Cycle	5 min.																					
Evap. Freeze Stat. (F)	30 / 50																					
R-22, oz..	Rating Plate																					
Unit Weight	1730 lbs.																					
		Outdoor Ambient Temperature - Degrees F. Dry Bulb																				
		75				85				95				105				115				
		Entering Indoor Temperature - Degrees F. Wet Bulb																				
		59				63				67				71				75				
IDB	70	MBh	223.0	231.2	253.3	-	217.7	225.7	247.2	-	212.4	220.1	241.2	-	201.8	209.1	229.1	-	186.9	193.7	212.3	-
		S/T	0.70	0.59	0.41	-	0.72	0.60	0.42	-	0.75	0.62	0.43	-	0.77	0.65	0.45	-	0.78	0.65	0.45	-
		AMPS	75.4	76.8	78.7	-	80.4	81.9	84.1	-	84.7	86.4	88.7	-	89.0	90.8	93.3	-	93.3	95.2	97.8	-
		HI PR	194	209	221	-	221	238	251	-	252	271	286	-	283	305	322	-	313	337	356	-
75	70	LOPR	60	64	70	-	63	67	73	-	66	70	76	-	69	73	80	-	71	76	83	-
		MBh	226.8	233.5	252.8	271.3	221.4	228.0	246.7	264.8	216.0	222.4	240.7	258.4	205.2	211.3	228.7	245.4	190.1	195.7	211.8	227.4
		S/T	0.80	0.72	0.54	0.35	0.82	0.73	0.56	0.36	0.85	0.76	0.57	0.37	0.88	0.79	0.60	0.38	0.89	0.79	0.60	0.39
		AMPS	75.9	77.3	79.3	81.6	81.0	82.5	84.7	87.2	85.4	87.0	89.3	92.0	89.7	91.5	94.0	96.9	94.0	95.9	98.5	101.6
80	75	HI PR	196	211	223	233	223	240	254	265	254	274	289	302	286	308	325	339	316	340	359	375
		LOPR	61	65	71	75	63	67	74	78	66	71	77	82	70	74	81	86	72	77	84	89
		MBh	230.8	235.9	252.0	269.4	225.3	230.3	246.0	263.0	219.8	224.6	240.0	256.6	208.8	213.4	228.0	243.7	193.5	197.7	211.2	225.8
		S/T	0.88	0.82	0.67	0.50	0.90	0.85	0.69	0.51	0.93	0.87	0.71	0.53	0.97	0.91	0.74	0.55	0.97	0.91	0.74	0.56
85	80	AMPS	76.5	77.9	79.9	82.2	81.6	83.1	85.3	87.9	86.0	87.7	90.0	92.7	90.4	92.2	94.7	97.6	94.7	96.6	99.3	102.4
		HI PR	198	213	225	235	226	243	256	267	257	277	292	305	289	311	329	343	319	344	363	379
		LOPR	62	65	71	76	64	68	74	79	67	71	78	83	70	75	82	87	73	77	85	90
		MBh	234.9	239.4	250.7	267.5	229.3	233.7	244.8	261.1	223.7	228.0	238.8	254.8	212.5	216.6	226.9	242.0	196.8	200.6	210.1	224.2
85	80	S/T	0.92	0.89	0.80	0.65	0.94	0.91	0.82	0.67	0.98	0.94	0.85	0.69	1.00	0.98	0.88	0.72	1.00	0.98	0.89	0.72
		AMPS	77.0	78.4	80.5	82.8	82.2	83.7	85.9	88.5	86.6	88.3	90.7	93.4	91.1	92.9	95.4	98.4	95.5	97.4	100.1	103.2
		HI PR	200	216	228	237	228	245	259	270	260	279	295	308	292	314	332	346	323	347	367	382
		LOPR	62	66	72	77	65	69	75	80	68	72	79	84	71	76	83	88	74	78	85	91
		EXTERNAL STATIC PRESSURE IN INCHES WATER COLUMN (PASCALS)																				
		.25 (62)		.50 (124)		.75 (186)		1.0 (249)		1.25 (311)		1.50 (373)		1.75 (435)		2.0 (497)						
		RPM	W	RPM	W	RPM	W	RPM	W	RPM	W	RPM	W	RPM	W	RPM	W					
CFM	6750															1390	7100	1410	7300			
	7000					1220	5800	1265	6250	1350	6650	1380	7200	1410	7400	1430	7600					
	7250	1190	5760	1220	5920	1260	6300	1290	6550	1390	7500	1410	7700	1425	7750	1480	8600					
	7500	1220	6150	1255	6500	1300	6950	1390	8010	1420	8250	1440	8400	1460	8650							
	7750	1250	6750	1280	6850	1360	8000	1420	8450	1450	8700	1460	9750	1475	8800							
	8000	1280	7300	1380	8800	1420	8800	1433	8870	1455	8950	1470	9000	1480	9050							
	8250	1400	8890	1420	9150	1432	9200	1455	9250	1470	9270	1480	9300									
		High Static Data / Standard NOTE: DO NOT EXCEED LISTED AMPS ON BLOWER MOTOR, 31.8 AMPS / 208-230V																				
		PULLEY TURNS OPEN						Factory Setting Turns Open														
FAN	RPM	STD PULLEY		1556	1518	1481	1439	1398	1357	1314	10 HP STD Pulley		5									
		LOW STATIC PULLEY		1332	1289	1246	1204	1162	1119	1076	10 HP Low Static Pulley		Field Installed/Adjusted									
		1099002 7-19-99																				

Parts List, Tech Labels & Wiring Diagrams for PAB240 & RAMA20 Series

Unit Size		20 Ton Package Air																									
Voltage/Ph/Hz	460/3/60	IDB		Outdoor Ambient Temperature - Degrees F. Dry Bulb																							
Ampacity	59.7			75				85				95				105				115							
Max. Fuse	70			Entering Indoor Temperature - Degrees F. Wet Bulb																							
Time Delay Fuse	70			59	63	67	71	59	63	67	71	59	63	67	71	59	63	67	71	59	63	67	71				
Compressors (2)	#1 #2	70	MBh	223.0	231.2	253.3	-	217.7	225.7	247.2	-	212.4	220.1	241.2	-	201.8	209.1	229.1	-	186.9	193.7	212.3	-				
RLA	17.2 17.2		S/T	0.70	0.59	0.41	-	0.72	0.60	0.42	-	0.75	0.62	0.43	-	0.77	0.65	0.45	-	0.78	0.65	0.45	-				
LRA	125.0 125.0		AMPS	35.4	36.0	36.9	-	37.7	38.4	39.3	-	39.6	40.4	41.4	-	41.6	42.4	43.5	-	43.6	44.4	45.6	-				
Condenser Fans	#1 #2	75	HI PR	194	209	221	-	221	238	251	-	252	271	286	-	283	305	322	-	313	337	356	-				
Blades/Size/Pitch	5/24/40 5/24/40		LOPR	60	64	70	-	63	67	73	-	66	70	76	-	69	73	80	-	71	76	83	-				
Motor-Hp	1.5 1.5		MBh	226.8	233.5	252.8	271.3	221.4	228.0	246.7	264.8	216.0	222.4	240.7	258.4	205.2	211.3	228.7	245.4	190.1	195.7	211.8	227.4				
FLA	2.6 2.6	S/T	0.80	0.72	0.54	0.35	0.82	0.73	0.56	0.36	0.85	0.76	0.57	0.37	0.88	0.79	0.60	0.38	0.89	0.79	0.60	0.39					
LRA	11.5 11.5	AMPS	35.6	36.3	37.2	38.2	37.9	38.6	39.6	40.8	39.9	40.7	41.7	43.0	41.9	42.7	43.9	45.2	43.9	44.7	46.0	47.4					
RPM	1140 1140	HI PR	196	211	223	233	223	240	254	265	254	274	289	302	286	308	325	339	316	340	359	375					
CFM	8000 8000	LOPR	61	65	71	75	63	67	74	78	66	71	77	82	70	74	81	86	72	77	84	89					
Evaporator Fan (1)		80	MBh	230.8	235.9	252.0	269.4	225.3	230.3	246.0	263.0	219.8	224.6	240.0	256.6	208.8	213.4	228.0	243.7	193.5	197.7	211.2	225.8				
Voltage/Phase/Hz	460/3/60		S/T	0.88	0.82	0.67	0.50	0.90	0.85	0.69	0.51	0.93	0.87	0.71	0.53	0.97	0.91	0.74	0.55	0.97	0.91	0.74	0.56				
Max. Cont. BHP	11.5		AMPS	35.9	36.5	37.4	38.5	38.2	38.9	39.9	41.1	40.2	41.0	42.1	43.3	42.2	43.0	44.2	45.5	44.2	45.1	46.3	47.7				
FLA / LRA	15.7 / 109.0	HI PR	198	213	225	235	226	243	256	267	257	277	292	305	289	311	329	343	319	344	363	379					
Fan RPM Range	1314 - 1556	LOPR	62	65	71	76	64	68	74	79	67	71	78	83	70	75	82	87	73	77	85	90					
CFM	8000	85	MBh	234.9	239.4	250.7	267.5	229.3	233.7	244.8	261.1	223.7	228.0	238.8	254.8	212.5	216.6	226.9	242.0	196.8	200.6	210.1	224.2				
Controls			S/T	0.92	0.89	0.80	0.65	0.94	0.91	0.82	0.67	0.98	0.94	0.85	0.69	1.00	0.98	0.88	0.72	1.00	0.98	0.89	0.72				
Hi Pressure	420 / 300		AMPS	36.1	36.8	37.7	38.8	38.5	39.2	40.2	41.4	40.5	41.3	42.4	43.6	42.5	43.4	44.5	45.9	44.5	45.4	46.7	48.1				
Lo Pressure	5 / 20	HI PR	200	216	228	237	228	245	259	270	260	279	295	308	292	314	332	346	323	347	367	382					
Transformer VA	75	LOPR	62	66	72	77	65	69	75	80	68	72	79	84	71	76	83	88	74	78	85	91					
Comp. Anti-Cycle	5 min.																										
Evap. Freeze Stat. (F)	30 / 50																										
R-22, oz.	Rating Plate																										
Unit Weight	1730 lbs.																										

CFM	EXTERNAL STATIC PRESSURE IN INCHES WATER COLUMN (PASCALS)															
	.25 (62)		.50 (124)		.75 (186)		1.0 (249)		1.25 (311)		1.50 (373)		1.75 (435)		2.0 (497)	
	RPM	W	RPM	W	RPM	W	RPM	W	RPM	W	RPM	W	RPM	W	RPM	W
6750																
7000					1220	5800	1265	6250	1350	6650	1380	7200	1410	7400	1430	7600
7250	1190	5760	1220	5920	1260	6300	1290	6550	1390	7500	1410	7700	1425	7750	1480	8600
7500	1220	6150	1255	6500	1300	6950	1390	8010	1420	8250	1440	8400	1460	8650		
7750	1250	6750	1280	6850	1360	8000	1420	8450	1450	8700	1460	9750	1475	8800		
8000	1280	7300	1380	8800	1420	8800	1433	8870	1455	8950	1470	9000	1480	9050		
8250	1400	8890	1420	9150	1432	9200	1455	9250	1470	9270	1480	9300				

High Static Data / Standard NOTE: DO NOT EXCEED LISTED AMPS ON BLOWER MOTOR, 14.7 AMPS / 460V

FAN RPM	PULLEY TURNS OPEN							Factory Setting Turns Open		1099003 7-19-99
	0	1	2	3	4	5	6	10 HP STD Pulley	5	
STD PULLEY	1556	1518	1481	1439	1398	1357	1314	10 HP Low Static Pulley	Field Installed/Adjusted	

Parts List, Tech Labels & Wiring Diagrams for PAB240 & RAMA20 Series

Unit Size		20 Ton Package Air											
Voltage/Ph/Hz	575/3/60												
Ampacity	43.3												
Max. Fuse	50												
Time Delay Fuse	50												
Compressors (2)	#1 #2												
RLA	12.4 12.4												
LRA	80.0 80.0												
Condensator Fans	#1 #2												
Blades/Size/Pitch	5/24/40 5/24/40												
Motor-Hp	1.5 1.5												
FLA	1.6 1.6												
LRA	8.0 8.0												
RPM	1140 1140												
CFM	8000 8000												
Evaporator Fan (1)													
Voltage/Phase/Hz	575/3/60												
Max. Cont. BHP	11.5												
FLA / LRA	12.3 / 62.0												
Fan RPM Range	1314 - 1556												
CFM	8000												
Controls													
Hi Pressure	420 / 300												
Lo Pressure	5 / 20												
Transformer VA	75												
Comp. Anti-Cycle	5 min.												
Evap. Freeze Stat. (F)	30 / 50												
R-22, oz.	Rating Plate												
Unit Weight	1730 lbs.												

IDB	75	Outdoor Ambient Temperature - Degrees F. Dry Bulb																			
		75				85				95				105				115			
		Entering Indoor Temperature - Degrees F. Wet Bulb																			
	59	63	67	71	59	63	67	71	59	63	67	71	59	63	67	71	59	63	67	71	
70	MBh	223.0	231.2	253.3	-	217.7	225.7	247.2	-	212.4	220.1	241.2	-	201.8	209.1	229.1	-	186.9	193.7	212.3	-
	ST	0.70	0.59	0.41	-	0.72	0.60	0.42	-	0.75	0.62	0.43	-	0.77	0.65	0.45	-	0.78	0.65	0.45	-
	AMPS	26.0	26.4	27.1	-	27.6	28.1	28.8	-	29.0	29.6	30.3	-	30.5	31.0	31.8	-	31.9	32.5	33.3	-
	HI PR	194	209	221	-	221	238	251	-	252	271	286	-	283	305	322	-	313	337	356	-
75	LOPR	60	64	70	-	63	67	73	-	66	70	76	-	69	73	80	-	71	76	83	-
	MBh	226.8	233.5	252.8	271.3	221.4	228.0	246.7	264.8	216.0	222.4	240.7	258.4	205.2	211.3	228.7	245.4	190.1	195.7	211.8	227.4
	ST	0.80	0.72	0.54	0.35	0.82	0.73	0.56	0.36	0.85	0.76	0.57	0.37	0.88	0.79	0.60	0.38	0.89	0.79	0.60	0.39
	AMPS	26.2	26.6	27.3	28.0	27.8	28.3	29.0	29.9	29.3	29.8	30.6	31.5	30.7	31.3	32.1	33.0	32.1	32.7	33.6	34.6
80	HI PR	196	211	223	233	223	240	254	265	254	274	289	302	286	308	325	339	316	340	359	375
	LOPR	61	65	71	75	63	67	74	78	66	71	77	82	70	74	81	86	72	77	84	89
	MBh	230.8	235.9	252.0	269.4	225.3	230.3	246.0	263.0	219.8	224.6	240.0	256.6	208.8	213.4	228.0	243.7	193.5	197.7	211.2	225.8
	ST	0.88	0.82	0.67	0.50	0.90	0.85	0.69	0.51	0.93	0.87	0.71	0.53	0.97	0.91	0.74	0.55	0.97	0.91	0.74	0.56
85	AMPS	26.3	26.8	27.5	28.2	28.0	28.5	29.2	30.1	29.5	30.0	30.8	31.7	30.9	31.5	32.3	33.3	32.3	33.0	33.8	34.9
	HI PR	198	213	225	235	226	243	256	267	257	277	292	305	289	311	329	343	319	344	363	379
	LOPR	62	65	71	76	64	68	74	79	67	71	78	83	70	75	82	87	73	77	85	90
	MBh	234.9	239.4	250.7	267.5	229.3	233.7	244.8	261.1	223.7	228.0	238.8	254.8	212.5	216.6	226.9	242.0	196.8	200.6	210.1	224.2
85	ST	0.92	0.89	0.80	0.65	0.94	0.91	0.82	0.67	0.98	0.94	0.85	0.69	1.00	0.98	0.88	0.72	1.00	0.98	0.89	0.72
	AMPS	26.5	27.0	27.6	28.4	28.2	28.7	29.4	30.3	29.7	30.2	31.0	31.9	31.1	31.7	32.6	33.5	32.6	33.2	34.1	35.1
	HI PR	200	216	228	237	228	245	259	270	260	279	295	308	292	314	332	346	323	347	367	382
	LOPR	62	66	72	77	65	69	75	80	68	72	79	84	71	76	83	88	74	78	85	91

CFM	EXTERNAL STATIC PRESSURE IN INCHES WATER COLUMN (PASCALS)																
	.25 (62)		.50 (124)		.75 (186)		1.0 (249)		1.25 (311)		1.50 (373)		1.75 (435)		2.0 (497)		
	RPM	W	RPM	W	RPM	W	RPM	W	RPM	W	RPM	W	RPM	W	RPM	W	
6750																	
7000					1220	5800	1265	6250	1350	6650	1380	7200	1410	7400	1430	7600	
7250	1190	5760	1220	5920	1260	6300	1290	6550	1390	7500	1410	7700	1425	7750	1480	8600	
7500	1220	6150	1255	6500	1300	6950	1390	8010	1420	8250	1440	8400	1460	8650			
7750	1250	6750	1280	6850	1360	8000	1420	8450	1450	8700	1460	9750	1475	8800			
8000	1280	7300	1380	8800	1420	8800	1433	8870	1455	8950	1470	9000	1480	9050			
8250	1400	8890	1420	9150	1432	9200	1455	9250	1470	9270	1480	9300					

High Static Data / Standard NOTE: DO NOT EXCEED LISTED AMPS ON BLOWER MOTOR, 13.4 AMPS / 575V

PULLEY TURNS OPEN		0	1	2	3	4	5	6	Factory Setting Turns Open	
FAN	STD PULLEY	1556	1518	1481	1439	1398	1357	1314	10 HP STD Pulley	5
RPM	LOW STATIC PULLEY	1332	1289	1246	1204	1162	1119	1076	10 HP Low Static Pulley	Field Installed/Adjusted

1099005
7-19-99

Parts List, Tech Labels & Wiring Diagrams for PAB240 & RAMA20 Series

CONNECTION WIRING DIAGRAM

DANGER: ELECTRICAL SHOCK HAZARD
DISCONNECT POWER BEFORE SERVICING

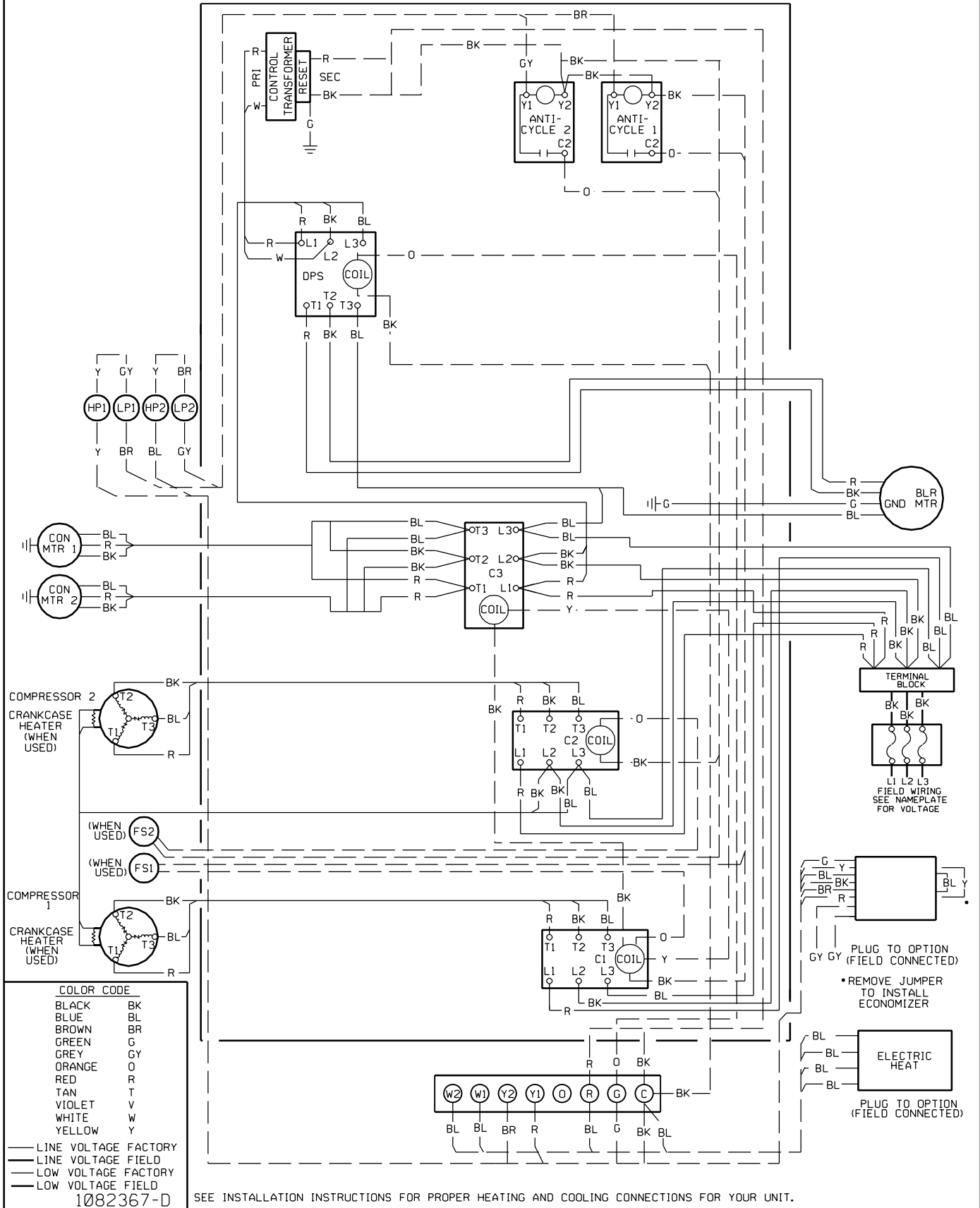

Parts List, Tech Labels & Wiring Diagrams for PAB240 & RAMA20 Series

LADDER WIRING DIAGRAM

DANGER: ELECTRICAL SHOCK HAZARD
DISCONNECT POWER BEFORE SERVICING

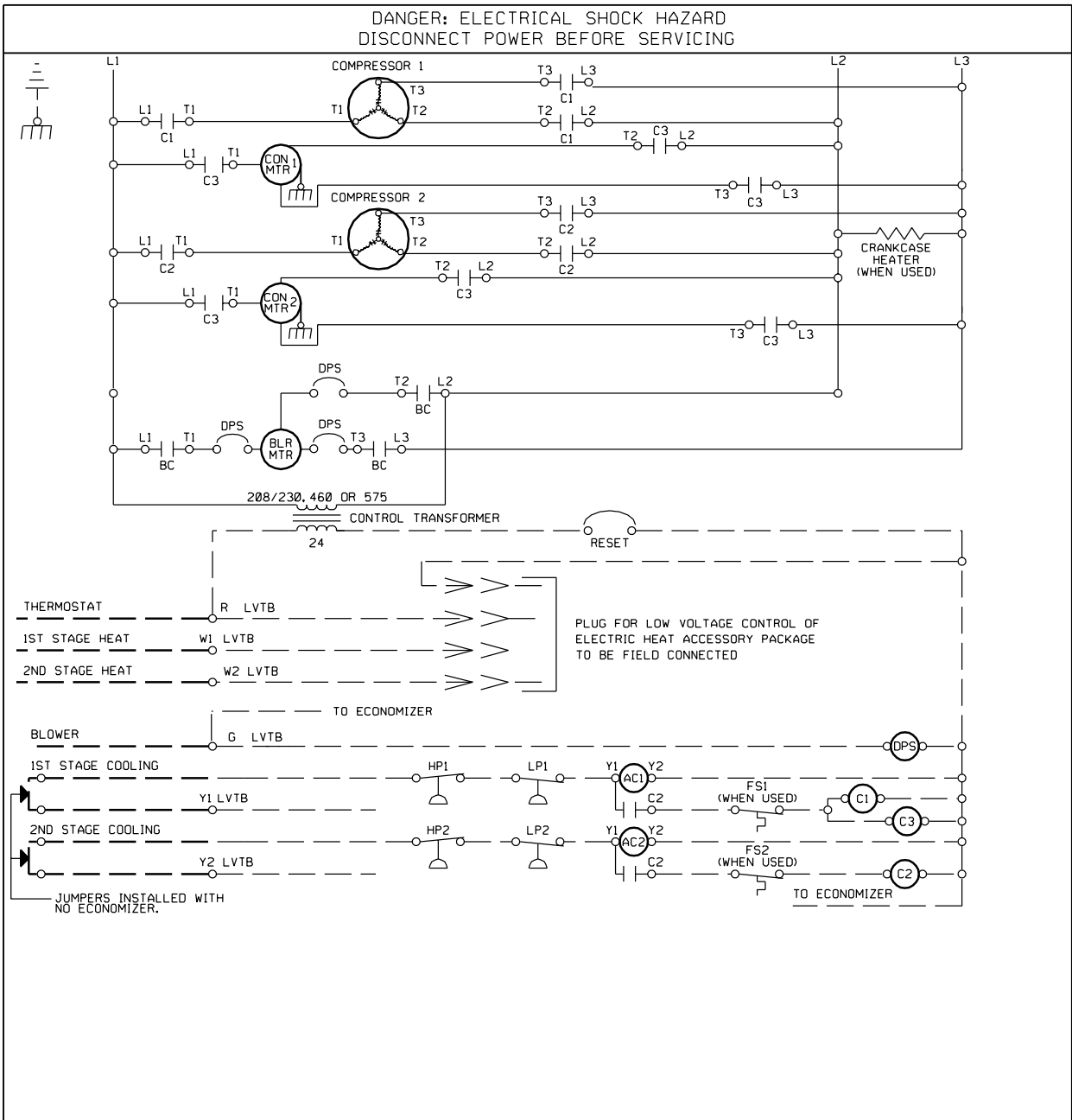

COMPONENT CODE
 AC-ANTICYCLO DELAY
 B-INDOOR BLOWER FAN RELAY
 C-COMPRESSOR CONTACTOR
 CON MTR-CONDENSER MOTOR
 FS-FREEZE STAT
 HP-HIGH PRESSURE SWITCH
 LP-LOW PRESSURE SWITCH
 LVTB-LOW VOLTAGE TERMINAL BOARD
 MA-MIXED AIR
 DPS-DEFINITE PURPOSE STARTER
 BC-BLOWER CONTACTOR

NOTES:
 1. ALL MOTORS HAVE EXTERNAL OVERLOAD PROTECTION. COMPRESSORS HAVE INTERNAL THERMAL PROTECTION.
 2. REPLACEMENT WIRE MUST BE THE SAME SIZE AND TYPE OF INSULATION AS ORIGINAL.
 3. REFER TO UNIT RATING PLATE FOR MINIMUM CIRCUIT AMPACITY AND MAXIMUM OVERCURRENT PROTECTION SIZE.
 4. DIFFERENTIAL ENTHALPY ONLY. 620 RESISTOR MUST BE REMOVED.

1082368-D