

Parts List, Tech Labels & Wiring Diagrams for PAAE & PAME Series

**Model Numbers: PAAE36N1K2, PAAE42N1K2, PAAE48N1K2, PAAE60N1K2
PAME36G001, PAME42G001, PAME48G001, PAME60G001**

	DESCRIPTION	Part No	36	42	48	60
1	Compressor, ZR34K3PFV	1081881	1			
1	Compressor, ZR40K3PFV	1083000	*	1		
1	Compressor, ZR46K3PFV	1083018	*	*	1	
1	Compressor, ZR54K3PFV	1098504	*	*	*	1
2	Motor, Condenser Fan	1066350	1	1	1	1
3	Fan, Condenser	1080795	1	1	1	1
5	Coil, Condenser	1066920	1	1	1	
5	Coil, Condenser	1084371	*	*	*	1
6	Capacitor, 7.5 MFD / 370V	1094239	1	1		
6	Capacitor, 20 MFD / 440V	1094968	*	*	1	1
7	Mount Kit, Blower Mtr.	1004905	1	1		
7	Mount Kit, Blower Mtr.	1002804	*	*	1	1
8	Motor, Blower	1054583	1	1		
8	Motor, Blower	1065129	*	*	1	1
9	Wheel, Blower 10-8 DD	600587	1	1		
9	Wheel, Blower 11-11 DD	1054593	*	*	1	1
11	Coil, Evaporator	1067439	1			
11	Coil, Evaporator	1067438	*	1	1	1
14	Feeder Tube Asy	1067441	1			
14	Feeder Tube Asy	1067440	*	1	1	1
15	Transformer, 230V PRI, 24V SEC. 40VA	1082611	1	1	1	1
19	Lug, Ground	91590	1	1	1	1
20	Board, Terminal	1066159	1	1	1	1
24	Contact, 35 AMP.	1050839	1	1	1	
24	Contact, 40 AMP.	1053980	*	*	*	1
27	Grommet Compressor MTG	1052060	4	4	4	4
30	Tube, Liq. /TXV/ Drier	1114002	1	1	1	*
30	Tube, Liq. /TXV/ Drier	1114051	*	*	*	1
31	Valve, Expansion	1066926	1	1	1	
31	Valve, Expansion	1066901	*	*	*	1
36	Capacitor, 50 + 7.5 MFD / 370V	1067388	1			
36	Capacitor, 55 + 7.5 MFD / 370V	1084310	*	1		
36	Capacitor, 60 + 7.5 MFD / 370V	1149997	*	*	1	
36	Capacitor, 80 + 7.5 MFD / 370V	1149999	*	*	*	1
41	Port Valve Asy	1083939	1	1	1	1
42	Sequencer, Blower	1054372	1	1	1	1
43	Manifold, Cond. (Discharge)	1054556	1	1	1	
43	Manifold, Cond. (Discharge)	1084381	*	*	*	1
44	Manifold, Condenser (Liquid)	1065475	1	1	1	
44	Manifold Condenser (Liquid)	1084382	*	*	*	1
48	Manifold, Evaporator	1066589	1			
48	Manifold, Evaporator	1066077	*	1	1	1
52	Plug, Compressor Harness	1083935	1	1	1	1
A	Grille, Outlet	1064542	1	1	1	1
AA	Cover, Duct	1068158	2	2	2	2
B	Panel, Top	1068157	1	1	1	1

	DESCRIPTION	Part No.	36	42	48	60
C	Orifice, Condenser Fan	1065725	1	1	1	1
CC	Bracket, Supply Air	1054525	1	1	1	1
D	Housing, Blower	1065300	1	1		
D	Housing, Blower	1066363	*	*	1	1
E	Deck, Blower	1065948	1	1	1	1
F	Panel, Access	1068181	1	1	1	1
FF	Baffle, Air	1054522	1	1	1	1
G	Plate, Block Off	1066107	1	1	1	1
H	Panel, Division	1065943	1	1	1	1
HA	Grille, Inlet (Right Side)	1082279	1	1	1	1
HB	Grille, Inlet (Left Side)	1082280	1	1	1	1
HH	Grille, Inlet (End)	1082281	1	1	1	1
J	Post, Electrical Corner	1068193	1	1	1	1
JJ	Nut, Cap	1067902	4	4	4	4
K	Bracket, Terminal Board Mtg.	1066106	1	1	1	1
KK	Baffle, Air	1066364	*	*	1	1
L	Plate, Conduit	1068179	1	1	1	1
LL	Plate, Control	1066168	1	1	1	1
M	Panel, Electrical Access	1068186	1	1	1	1
MM	Bracket	1065618	1	1	1	1
N	Panel, Pressure Port	1068164	1	1	1	1
NN	Support, Filter Top	1054502	1	1	1	1
O	Plate, Pressure Top	1068189	1	1	1	1
OO	Panel, Coil Support	1082434	1	1	1	1
PP	Panel, Heating Area	1054508	1	1	1	1
QQ	Baffle, Coil	1082435	1	1	1	1
R	Post, Condenser Corner	1068172	1	1	1	1
RR	Panel, Drain Outlet	1068162	1	1	1	1
S1	Rail, Base	1065001	2	2	2	2
S2	Rail, Base	1054464	1	1	1	1
S3	Rail, Base	1084078	1	1	1	1
SS	Panel, Filter Access	1068175	1	1	1	1
T	Panel, Base	1054463	1	1	1	1
U	Panel, Return Air	1068160	1	1	1	1
UU	Post, Return Air	1068168	1	1	1	1
V	Panel, Divider Air	1054471	1	1	1	1
VV	Post, Center	1068163	1	1	1	1
WW	Clamp, Capacitor	1095020	1	1		
WW	Clamp, Capacitor	1095022	*	*	1	1
X	Pan, Drain	1068366	1	1	1	1
XX	Panel, Cut Off	95143	1	1		
XX	Panel, Cut Off	1065073	*	*	1	1
Y	Bracket, Evaporator	1098999	1	1	1	1
YY	Bracket, Blower Support	1065030	*	*	*	1
Z	Panel, Supply Air	1068161	1	1	1	1
)(Manual, Parts List	519041102	1	1	1	1
)(Manual, Installation	519011001	1	1	1	1

Parts List, Tech Labels & Wiring Diagrams for PAAE & PAME Series

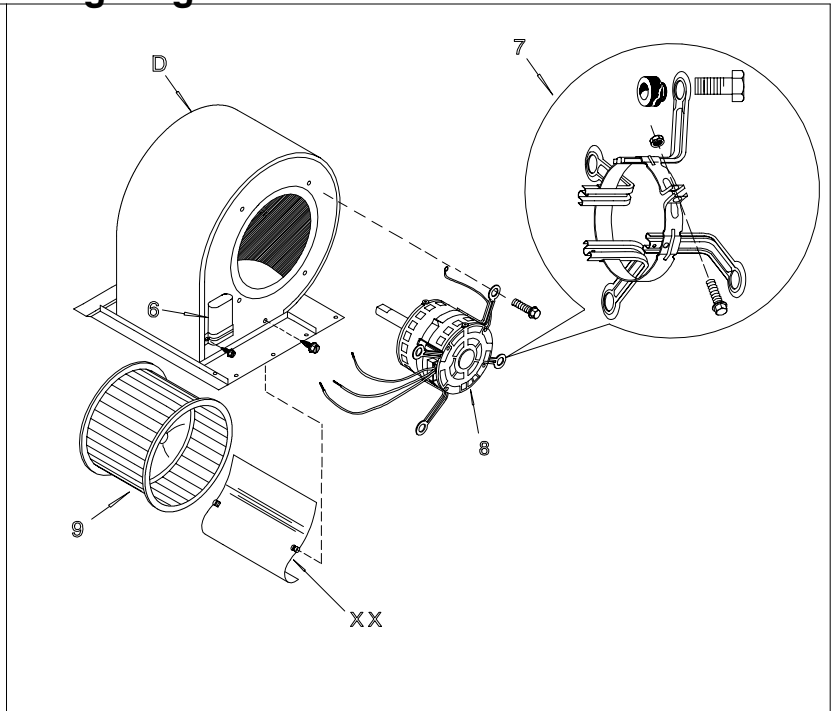
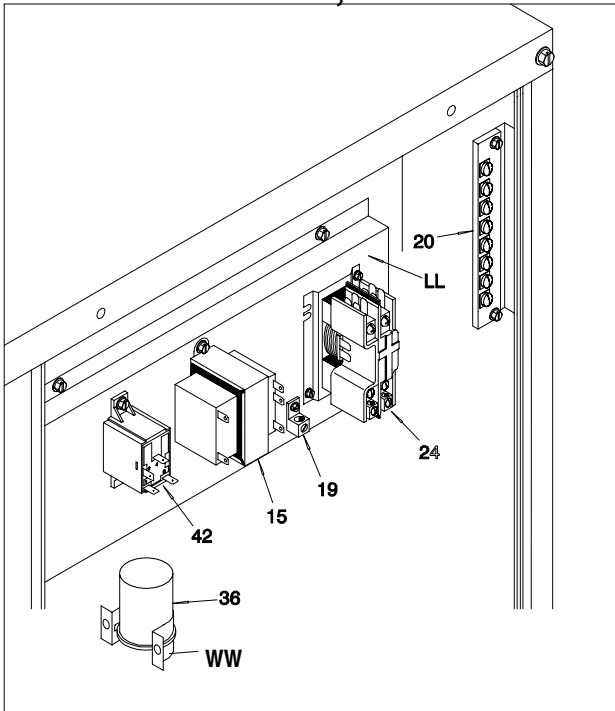

This illustration is for reference only, your unit may differ from the one shown.

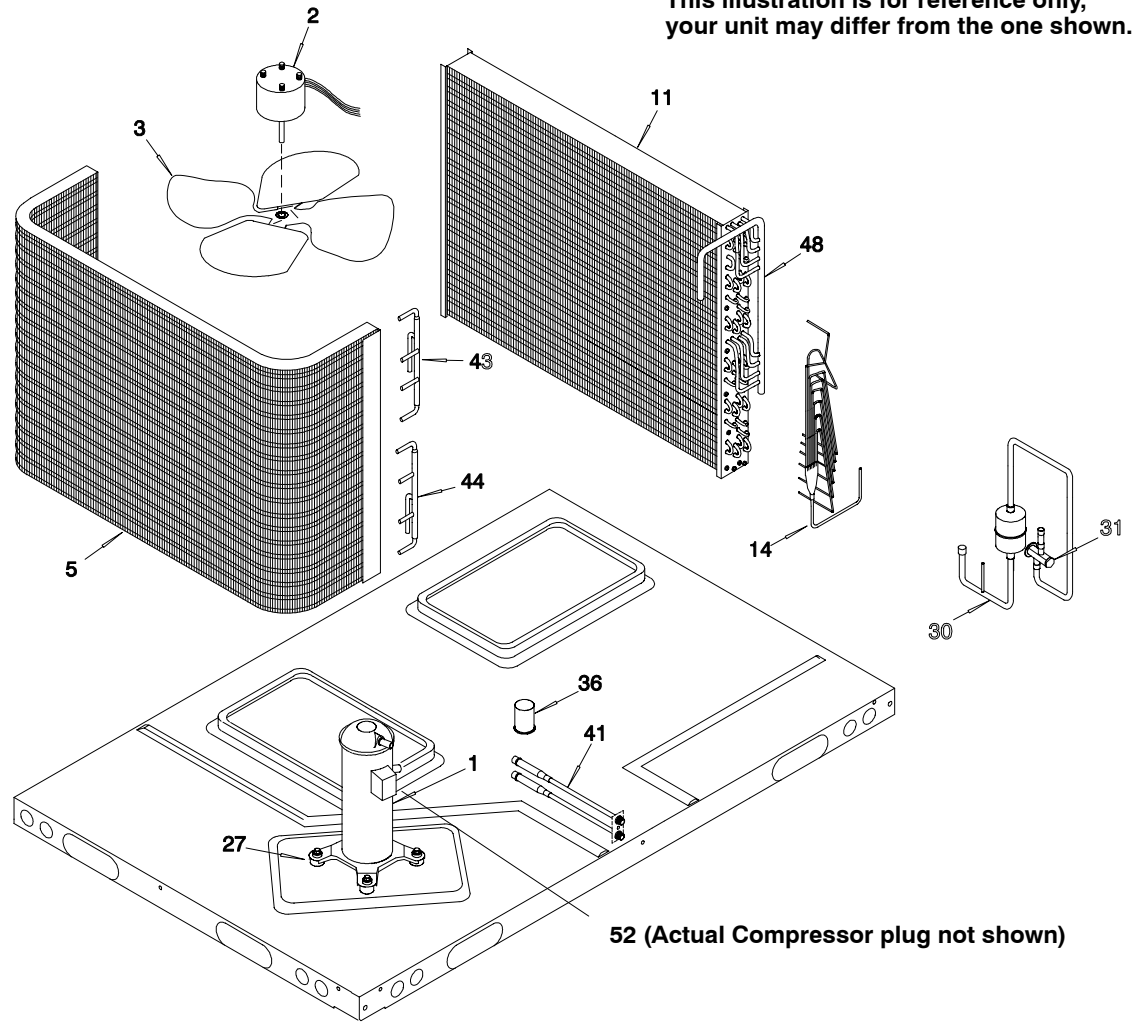

80-31-24

Parts List, Tech Labels & Wiring Diagrams for PAAE & PAME Series

This illustration is for reference only,
your unit may differ from the one shown.

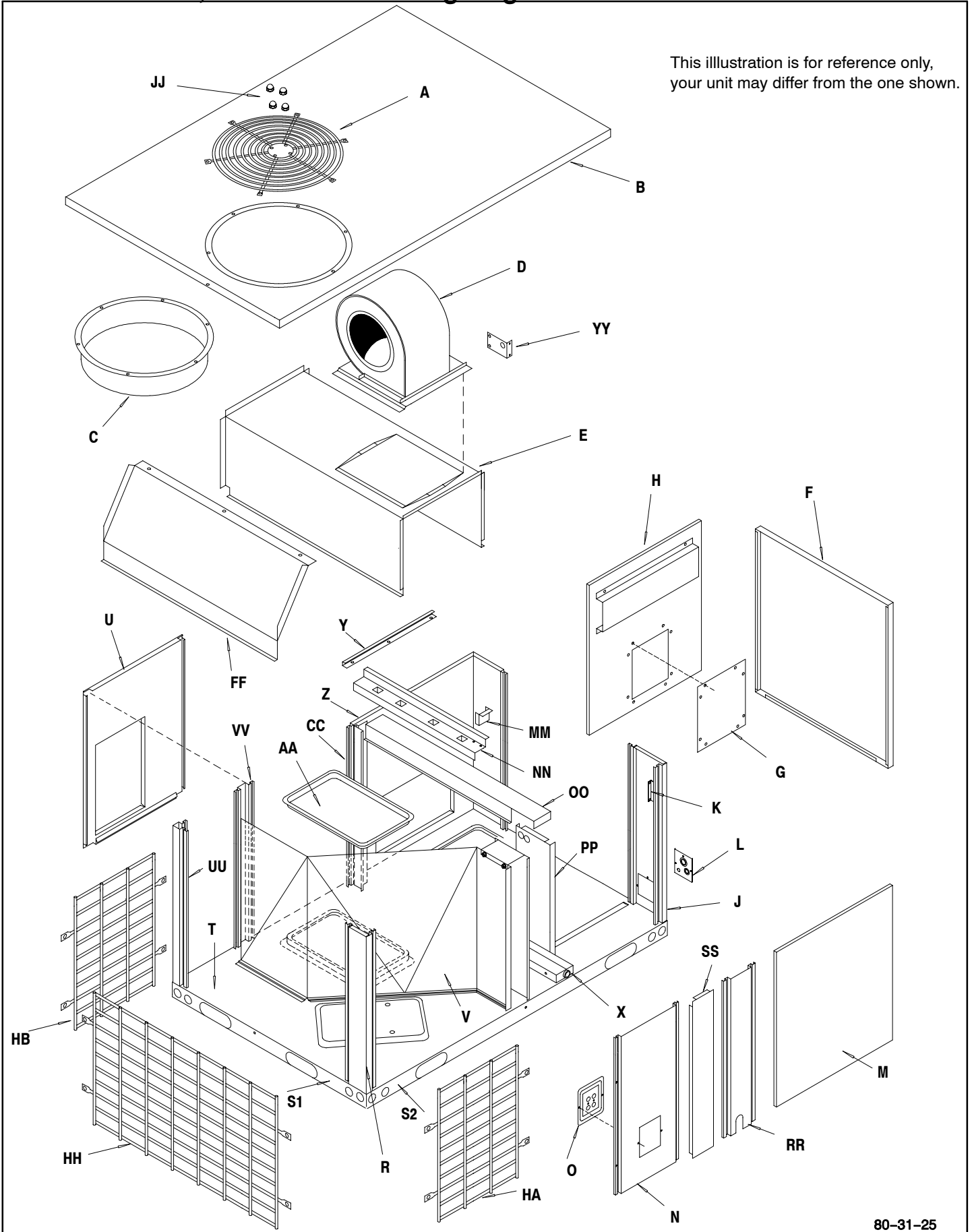

80-31-25

Parts List, Tech Labels & Wiring Diagrams for PAAE & PAME Series

TECH LABELS - 3 & 3-1/2 TON

Style No:		3 Ton Pkg Air		Outdoor Ambient Temperature - Degrees F. Dry Bulb																						
				75				85				95				105				115						
Voltage		208 / 230		IDB		Entering Indoor Temperature - Degrees F. Wet Bulb																				
						59	63	67	71	59	63	67	71	59	63	67	71	59	63	67	71	59	63	67	71	
Phase	1																									
Ampacity	25.8																									
Wire Ga/Ft	NEC																									
Delay Fuse	30																									
Max. Fuse	40																									
Compressor	COPELAND																									
RLA	16																									
LRA	88																									
Cap MFD/V	35 / 440																									
CC Heater																										
Start Kit	NAMA001SC																									
Cond & Evap	Cond	Evap																								
Type	Fan	Blower																								
Size	20	DD11-8A																								
Motor-HP	1/3	1 / 2																								
Type	PSC	PSC																								
FLA	1.8	4																								
LRA	6.42	7.09																								
RPM	1135	1125																								
Cap MFD/V	5 / 370	15/370																								
PTCR																										
Hi Press																										
Low Press																										
Operating Chg (No Lines)*	(R-22 Oz)		230 Volt																208 Volt							
	180		External Static Press (Inch Water Column)																External Static Press (Inch Water Column)							
			Speed Tap		0.1	0.2	0.3	0.4	0.5	0.6	0.7	Speed Tap		0.1	0.2	0.3	0.4	0.5	0.6	0.7						
Service Driers			HI	1611	1569	1522	1470	1414	1353	1288	HI	1459	1428	1394	1359	1315	1260	1205								
Liquid/Chg	16 Cu In / 11 oz		MD HI	1341	1320	1294	1262	1225	1181	1128	MD HI	1132	1121	1106	1088	1062	1025	984								
Suction	30 Sq In		MD LO	-	-	-	-	-	-	-	MD LO	-	-	-	-	-	-	-								
Unit Weight	435		LO	1167	1157	1139	1114	1083	1047	1007	LO	945	938	928	914	895	868	835								

1084363

Style No:		3 1/2 Ton Pkg Air		Outdoor Ambient Temperature - Degrees F. Dry Bulb																						
				75				85				95				105				115						
Voltage		208 / 230		IDB		Entering Indoor Temperature - Degrees F. Wet Bulb																				
						59	63	67	71	59	63	67	71	59	63	67	71	59	63	67	71	59	63	67	71	
Phase	1																									
Ampacity	28.2																									
Wire Ga/Ft	NEC																									
Delay Fuse	35																									
Max. Fuse	45																									
Compressor	COPELAND																									
RLA	17.95																									
LRA	104																									
Cap MFD/V	35 / 440																									
CC Heater																										
Start Kit	NAMA001SC																									
Cond & Evap	Cond	Evap																								
Type	Fan	Blower																								
Size	20	DD11-8A																								
Motor-HP	1/3	1 / 2																								
Type	PSC	PSC																								
FLA	1.8	4																								
LRA	6.42	7.09																								
RPM	1135	1145																								
Cap MFD/V	5 / 370	15 / 370																								
PTCR																										
Hi Press																										
Low Press																										
Operating Chg (No Lines)*	(R-22 Oz)		230 Volt																208 Volt							
	215		External Static Press (Inch Water Column)																External Static Press (Inch Water Column)							
			Speed Tap		0.1	0.2	0.3	0.4	0.5	0.6	0.7	Speed Tap		0.1	0.2	0.3	0.4	0.5	0.6	0.7						
Service Driers			HI	1611	1569	1522	1470	1414	1353	1288	HI	1459	1428	1394	1359	1315	1260	1205								
Liquid/Chg	16 Cu In / 11 oz		MD HI	1341	1320	1294	1262	1225	1181	1128	MD HI	1132	1121	1106	1088	1062	1025	984								
Suction	30 Sq In		MD LO	-	-	-	-	-	-	-	MD LO	-	-	-	-	-	-	-								
Unit Weight	450		LO	1167	1157	1139	1114	1083	1047	1007	LO	945	938	928	914	895	868	835								

1084364

Parts List, Tech Labels & Wiring Diagrams for PAAE & PAME Series

TECH LABELS - 4 & 5 TON

Style No: 4 Ton Pkg Air		Outdoor Ambient Temperature - Degrees F. Dry Bulb																					
		75				85				95				105				115					
Voltage 208 / 230 Phase 1 Ampacity 36.5 Wire Ga/Ft NEC Delay Fuse 45 Max. Fuse 60		IDB	Entering Indoor Temperature - Degrees F. Wet Bulb																				
			59	63	67	71	59	63	67	71	59	63	67	71	59	63	67	71	59	63	67	71	
Compressor	COPELAND	70	MBh	45.5	47.2	51.7	-	44.4	46.1	50.5	-	43.4	44.9	49.2	-	41.2	42.7	46.8	-	38.2	39.6	43.3	-
RLA	23.72		S/T	0.74	0.62	0.43	-	0.76	0.64	0.44	-	0.79	0.66	0.46	-	0.82	0.68	0.47	-	0.82	0.69	0.48	-
LRA	129		AMPS	18.5	18.9	19.4	-	19.8	20.3	20.8	-	21.0	21.4	22.0	-	22.1	22.6	23.3	-	23.3	23.8	24.5	-
Cap MFD/V	40 / 440		HI PR	176	189	200	-	200	215	227	-	228	245	259	-	256	276	291	-	283	305	322	-
CC Heater		75	LO PR	66	71	77	-	69	73	80	-	73	77	84	-	76	81	88	-	79	84	91	-
Start Kit	NAMA001SC		MBh	46.3	47.7	51.6	55.4	45.2	46.5	50.4	54.1	44.1	45.4	49.1	52.7	41.9	43.1	46.7	50.1	38.8	40.0	43.2	46.4
Cond & Evap	Cond Evap		S/T	0.85	0.76	0.57	0.37	0.87	0.78	0.59	0.38	0.90	0.80	0.61	0.39	0.93	0.83	0.63	0.40	0.94	0.84	0.63	0.41
Type	Fan Blower		AMPS	18.7	19.0	19.6	20.2	20.0	20.4	21.0	21.7	21.2	21.6	22.2	22.9	22.3	22.8	23.5	24.2	23.5	24.0	24.7	25.5
Size	22 DD9-9A	HI PR	178	191	202	210	202	217	229	239	230	248	261	273	259	278	294	307	286	308	325	339	
Motor-HP	3 / 4 1 / 2	LO PR	67	71	78	83	70	74	81	86	73	78	85	91	77	82	89	95	79	85	92	98	
Type	PSC PSC	MBh	47.1	48.2	51.5	55.0	46.0	47.0	50.2	53.7	44.9	45.9	49.0	52.4	42.6	43.6	46.6	49.8	39.5	40.4	43.1	46.1	
FLA	1.8 5	S/T	0.93	0.87	0.71	0.53	0.95	0.89	0.73	0.54	0.98	0.92	0.75	0.56	1.00	0.96	0.78	0.58	1.00	0.96	0.78	0.59	
LRA	6.42 8.75	AMPS	18.8	19.2	19.7	20.3	20.2	20.6	21.2	21.8	21.3	21.8	22.4	23.1	22.5	23.0	23.6	24.4	23.7	24.2	24.9	25.7	
RPM	1155 1140	HI PR	179	193	204	213	204	220	232	242	232	250	264	275	261	281	297	310	289	311	328	342	
Cap MFD/V	7.5/440 20/370	LO PR	68	72	79	84	70	75	82	87	74	79	86	92	78	83	90	96	80	85	93	99	
PTCR		MBh	48.0	48.9	51.2	54.6	46.8	47.7	50.0	53.3	45.7	46.6	48.8	52.0	43.4	44.2	46.3	49.4	40.2	41.0	42.9	45.8	
Hi Press		S/T	0.97	0.94	0.85	0.69	1.00	0.96	0.87	0.71	1.00	0.99	0.90	0.73	1.00	1.00	0.93	0.76	1.00	1.00	0.94	0.76	
Low Press		AMPS	18.9	19.3	19.9	20.5	20.3	20.7	21.3	22.0	21.5	21.9	22.6	23.3	22.7	23.2	23.8	24.6	23.8	24.4	25.1	25.9	
Operating Chg (No Lines)*	(R-22 Oz) 215	HI PR	181	195	206	215	206	222	234	244	235	253	267	278	264	284	300	313	292	314	331	346	
Service Driers		LO PR	69	73	80	85	71	76	83	88	75	80	87	93	78	83	91	97	81	86	94	100	
Liquid/Chg	30 Cu In / 17 oz	Air Delivery in CFM - Dry Coil - No Filter (Add .05 static for Wet Coil)																					
Suction	30 Sq In	230 Volt	External Static Press (Inch Water Column)							208 Volt	External Static Press (Inch Water Column)							1084365					
Unit Weight	600	Speed Tap	0.1	0.2	0.3	0.4	0.5	0.6	0.7	Speed Tap	0.1	0.2	0.3	0.4	0.5	0.6	0.7						
		HI	2184	2124	2062	1997	1928	1854	1773		2015	1971	1918	1859	1794	1725	1652						
		MD HI	2039	1990	1936	1877	1814	1746	1672		1811	1780	1741	1694	1641	1583	1519						
		MD LO	1638	1614	1584	1549	1507	1457	1398		1378	1366	1349	1326	1296	1257	1207						
		LO	1285	1277	1263	1242	1212	1174	1127		1061	1052	1040	1023	1000	970	933						

Style No: 5 Ton Pkg Air		Outdoor Ambient Temperature - Degrees F. Dry Bulb																					
		75				85				95				105				115					
Voltage 208 / 230 Phase 1 Ampacity 38.1 Wire Ga/Ft NEC Delay Fuse 45 Max. Fuse 60		IDB	Entering Indoor Temperature - Degrees F. Wet Bulb																				
			59	63	67	71	59	63	67	71	59	63	67	71	59	63	67	71	59	63	67	71	
Compressor	COPELAND	70	MBh	53.9	55.9	61.2	-	52.6	54.5	59.7	-	51.3	53.2	58.3	-	48.8	50.5	55.4	-	45.2	46.8	51.3	-
RLA	25		S/T	0.75	0.63	0.44	-	0.77	0.65	0.45	-	0.80	0.67	0.46	-	0.83	0.69	0.48	-	0.84	0.70	0.48	-
LRA	169		AMPS	21.5	21.9	22.5	-	23.0	23.5	24.1	-	24.3	24.8	25.5	-	25.6	26.1	26.9	-	26.9	27.5	28.3	-
Cap MFD/V	55 / 440		HI PR	176	189	200	-	200	215	227	-	228	245	259	-	256	276	291	-	283	305	322	-
CC Heater		75	LO PR	65	69	75	-	67	72	78	-	71	75	82	-	74	79	86	-	77	82	89	-
Start Kit	NAMA001SC		MBh	54.8	56.4	61.1	65.6	53.5	55.1	59.6	64.0	52.2	53.7	58.2	62.4	49.6	51.1	55.3	59.3	45.9	47.3	51.2	54.9
Cond & Evap	Cond Evap		S/T	0.86	0.77	0.58	0.37	0.88	0.79	0.60	0.38	0.91	0.81	0.61	0.40	0.94	0.84	0.64	0.41	0.95	0.85	0.64	0.41
Type	Fan Blower		AMPS	21.6	22.1	22.7	23.4	23.2	23.6	24.3	25.1	24.5	25.0	25.7	26.5	25.8	26.4	27.1	28.0	27.1	27.7	28.5	29.4
Size	22 DD11-11A	HI PR	178	191	202	210	202	217	229	239	230	248	261	273	259	278	294	307	286	308	325	339	
Motor-HP	3 / 4 1	LO PR	66	70	77	82	69	73	80	85	72	77	84	89	76	81	88	94	78	83	91	97	
Type	PSC PSC	MBh	56.8	57.9	60.6	64.6	55.4	56.5	59.2	63.1	54.1	55.1	57.7	61.6	51.4	52.3	54.8	58.5	47.6	48.5	50.8	54.2	
FLA	1.8 5	S/T	0.99	0.95	0.86	0.70	1.00	0.98	0.88	0.71	1.00	1.00	0.91	0.74	1.00	1.00	0.94	0.77	1.00	1.00	0.95	0.77	
LRA	6.42 8.75	AMPS	22.0	22.4	23.0	23.7	23.5	24.0	24.7	25.4	24.9	25.4	26.1	26.9	26.2	26.8	27.5	28.4	27.6	28.1	29.0	29.9	
RPM	1155 1125	HI PR	181	195	206	215	206	222	234	244	235	253	267	278	264	284	300	313	292	314	331	346	
Cap MFD/V	10/440 20/370	LO PR	67	71	78	83	70	74	81	86	73	78	85	90	77	81	89	95	79	84	92	98	
PTCR		Air Delivery in CFM - Dry Coil - No Filter (Add .05 static for Wet Coil)																					
Hi Press		230 Volt	External Static Press (Inch Water Column)							208 Volt	External Static Press (Inch Water Column)							1084366					
Low Press		Speed Tap	0.1	0.2	0.3	0.4	0.5	0.6	0.7	Speed Tap	0.1	0.2	0.3	0.4	0.5	0.6	0.7						
Operating Chg (No Lines)*	(R-22 Oz) 223	HI	2184	2124	2062	1997	1928	1854	1773		2015	1971	1918	1859	1794	1725	1652						
Service Driers		MD HI	2039	1990	1936	1877	1814	1746	1672		1811	1780	1741	1694	1641	1583	1519						
Liquid/Chg	30 Cu In / 17 oz	MD LO	1638	1614	1584	1549	1507	1457	1398		1378	1366	1349	1326	1296	1257	1207						
Suction	30 Sq In	LO	1285	1277	1263	1242	1212	1174	1127		1061	1052	1040	1023	1000	970	933						
Unit Weight	620																						

CONNECTION WIRING DIAGRAM

LADDER WIRING DIAGRAM

DANGER: ELECTRICAL SHOCK HAZARD DISCONNECT POWER BEFORE SERVICING

DANGER: ELECTRICAL SHOCK HAZARD DISCONNECT POWER BEFORE SERVICING

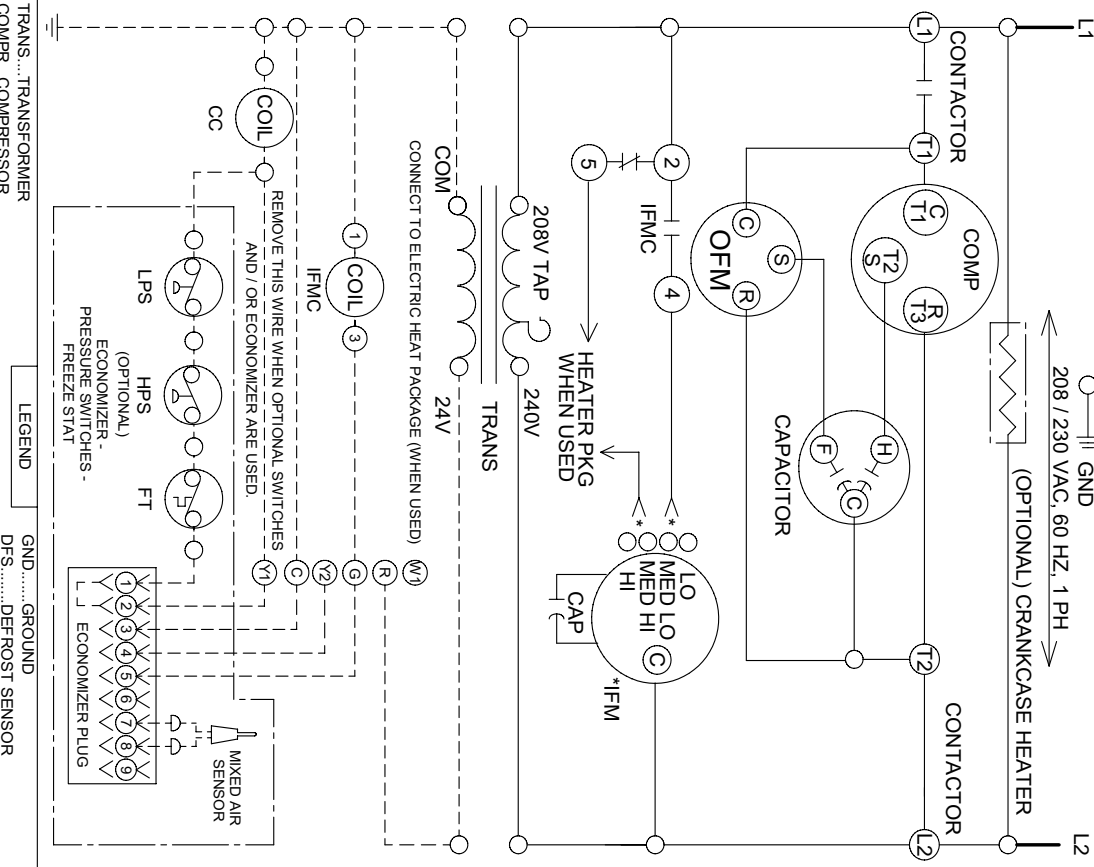
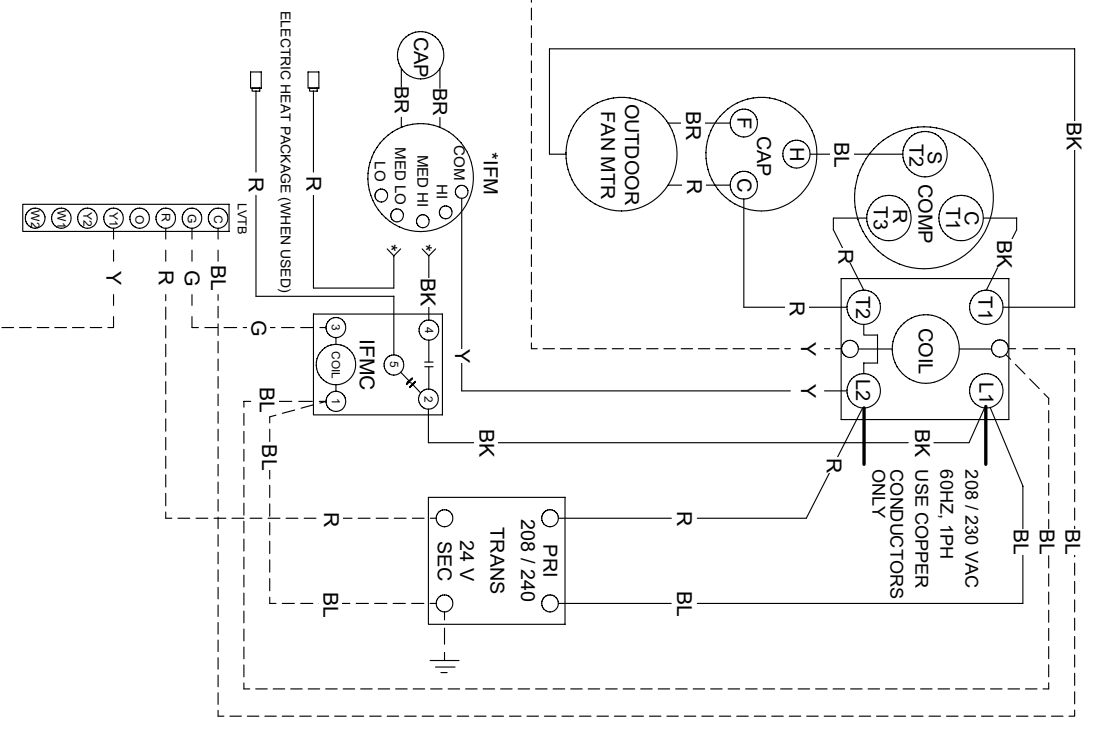

IF ANY OF THE ORIGINAL WIRE AS SUPPLIED WITH THE APPLIANCE MUST BE REPLACED, IT MUST BE REPLACED WITH TYPE AMM-105°C OR ITS EQUIVALENT.
 -SEE INSTALLATION INSTRUCTIONS FOR PROPER HEATING AND COOLING CONNECTIONS FOR YOUR UNIT.
 -LINE VOLTAGE FACTORY COLOR CODE:
 -LINE VOLTAGE FIELD
 -LOW VOLTAGE FACTORY
 -LOW VOLTAGE FIELD

TRANSFORMER
 COMPRESSOR
 CAPACITOR
 FREEZE THERMOSTAT
 CONT. JUMPER WIRE
 JPR. JUMPER WIRE
 FCC. FAN CONTACTOR COIL
 CC. COMPRESSOR CONTACTOR COIL
 LPS. LOW PRESSURE SWITCH
 RVS. REVERSING VALVE SOLENOID

COLOR CODE	BLACK	BLUE	BROWN	GRAY	GREEN	ORANGE	RED	VIOLET	G	R	V	WHITE	YELLOW	W	Y
LINE VOLTAGE FACTORY	BK	BL	BR	GY	GRN	ORNG	RED	VT							
LINE VOLTAGE FIELD	BK	BL	BR	GY	GRN	ORNG	RED	VT							
LOW VOLTAGE FACTORY	BK	BL	BR	GY	GRN	ORNG	RED	VT	G	R	V	W	Y		
LOW VOLTAGE FIELD	BK	BL	BR	GY	GRN	ORNG	RED	VT	G	R	V	W	Y		

Parts List, Tech Labels & Wiring Diagrams for PAAE & PAME Series

CONNECTION WIRING DIAGRAM

LADDER WIRING DIAGRAM

DANGER: ELECTRICAL SHOCK HAZARD DISCONNECT POWER BEFORE SERVICING

DANGER: ELECTRICAL SHOCK HAZARD DISCONNECT POWER BEFORE SERVICING

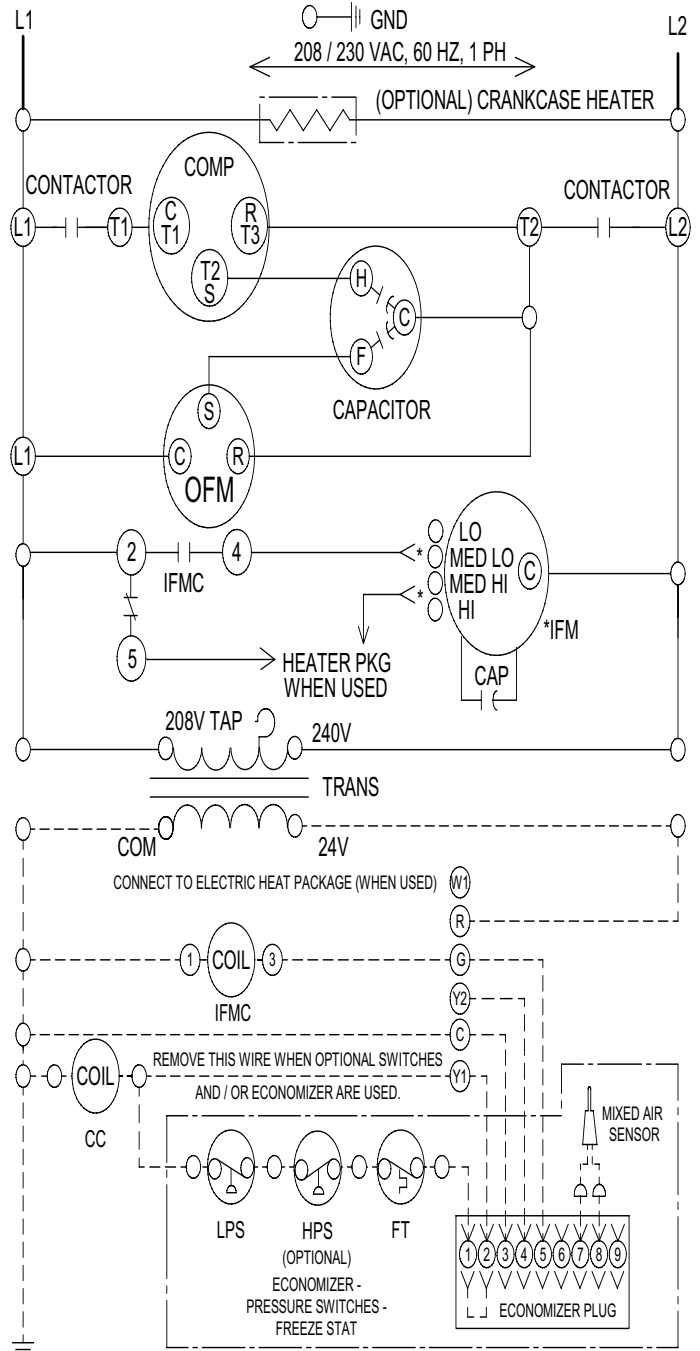
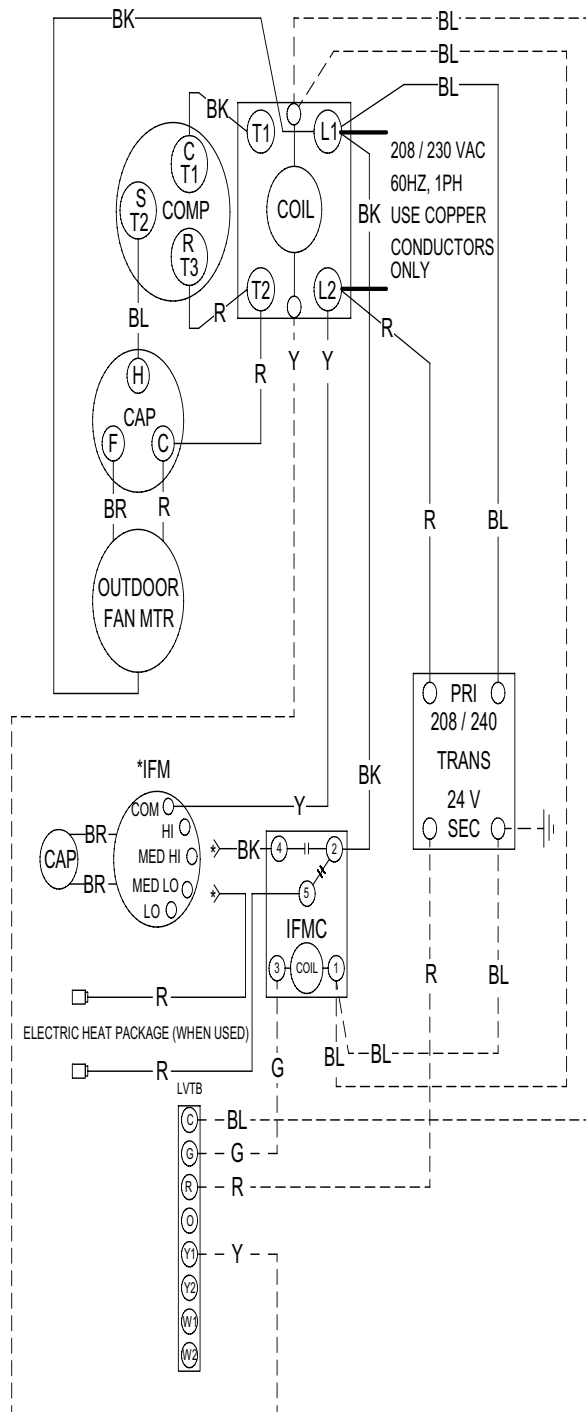

IF ANY OF THE ORIGINAL WIRE AS SUPPLIED WITH THE APPLIANCE MUST BE REPLACED, IT MUST BE REPLACED WITH TYPE AWM-105°C OR ITS EQUIVALENT.

* SEE INSTALLATION INSTRUCTIONS FOR PROPER HEATING AND COOLING CONNECTIONS FOR YOUR UNIT

LINE VOLTAGE FACTORY	COLOR CODE:	BLACK BK	GREEN G	WHITE W
— LINE VOLTAGE FIELD	—	BLUE BL	ORANGE O	YELLOW Y
- - - - LOW VOLTAGE FACTORY	- - - -	BROWN BR	RED R	
- - - - LOW VOLTAGE FIELD	- - - -	GRAY GY	VIOLET V	

LEGEND	
TRANS.....	TRANSFORMER
COMPR.....	COMPRESSOR
CAP.....	CAPACITOR
FT.....	FREEZE THERMOSTAT
CONT.....	CONTACTOR
JPR.....	JUMPER WIRE
FCC.....	FAN CONTACTOR COIL
CC.....	COMPRESSOR CONTACTOR COIL
LPS.....	LOW PRESSURE SWITCH
RVS.....	REVERSING VALVE SOLENOID
GND.....	GROUND
DFS.....	DEFROST SENSOR
DFC.....	DEFROST CONTROL
ER.....	ECONOMIZER RELAY
HPS.....	HIGH PRESSURE SWITCH
TDR.....	TIME DELAY RELAY
LVTB.....	LOW VOLT TERM BOARD
IFMC.....	INDOOR FAN MOTOR CONTROL
IFM.....	INDOOR FAN MOTOR
OFM.....	OUTDOOR FAN MOTOR

1114128