

PA55/PAPA Series, 380V-3 Phase-50Hz

Parts List, Wiring Diagrams, Tech Labels

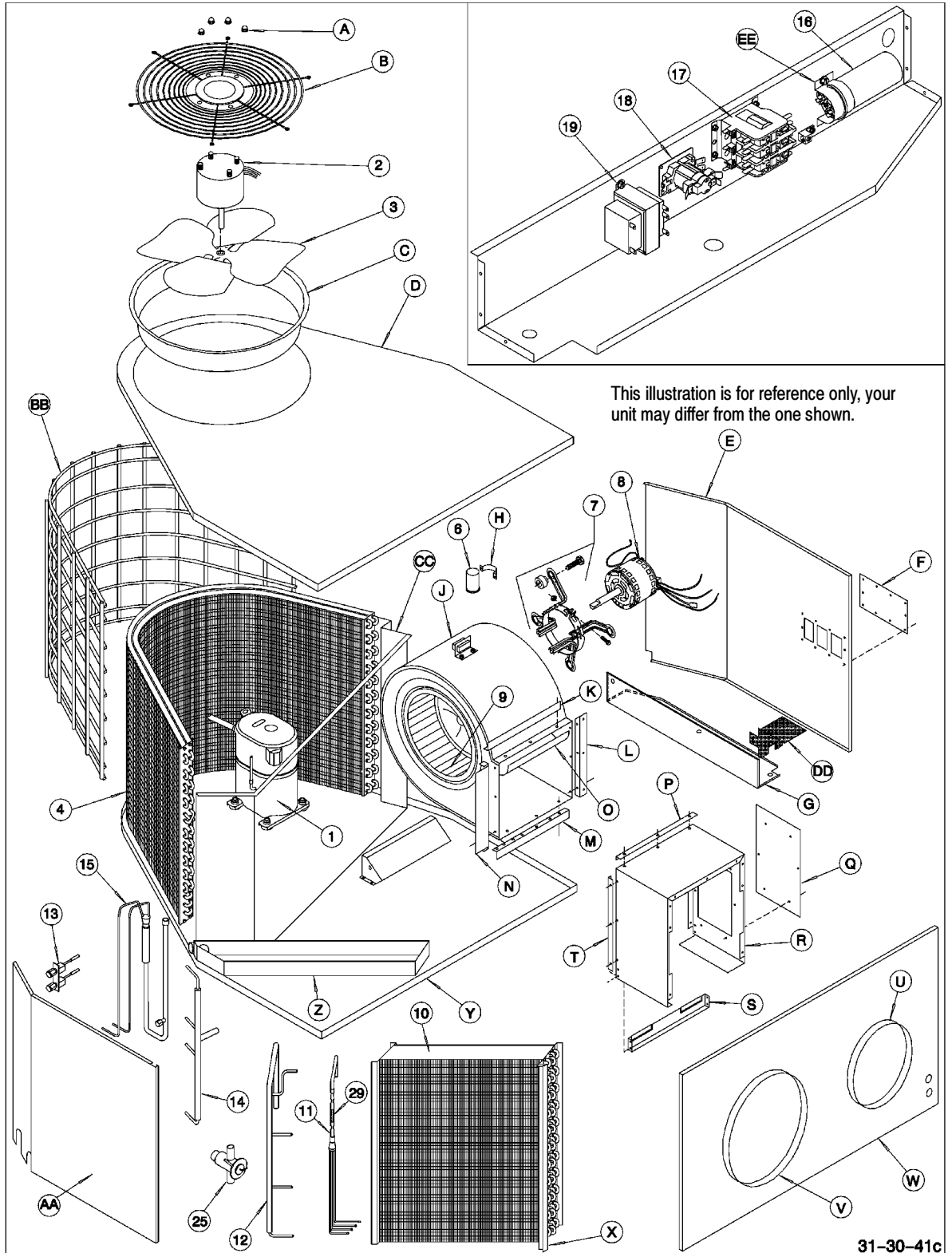

31-30-41c

PA5536AZA1, PA5548AZA1, PA5560AZA1, PAPA36ZA1, PAPA48ZA1, PAPA60ZA

	DESCRIPTION	PART No.	36	48	60		DESCRIPTION	PART No.	36	48	60
1	Compressor, CR35K6TFD	1083941	1			A	Nut, Cap	1067902	4	4	4
1	ZR45KCTFD	1082648	-	1		AA	Panel, Side (Evap)	1081102	1	1	1
1	ZR57K3TFD	1066518	-	-	1	B	Grille, Top	1064541	1	1	
2	Motor, Condenser	1083860	1	1	1	B	Grille, Inlet	1072868	-	-	1
3	Fan Blade, Condenser	1080790	1	1	1	BB	Grille, Inlet	1081378	1	1	1
4	Condenser Coil Assembly	1081121	1			C	Orifice, Condenser Fan	1065724	1	1	1
4		1081122	-	1		CC	Panel, Center	1097343	1	1	1
4		1082375	-	-	1	D	Panel, Top	1068344	1	1	1
6	Capacitor, 12.5 / 370V	1094958	1			DD	Partition, Low Voltage	1082051	1	1	1
6	20 / 370V	1094961	-	1	1	E	Panel, Side (Blower)	1081103	1	1	1
7	Mount, Blower Motor Kit	609227	1	1		EE	Clamp, Capacitor	1095020	1	1	1
		522020024	-	-	1	F	Cover, Side (Blower)	1081375	1	1	1
8	Motor, Blower	1083861	1			G	Box, Control	1081220	1	1	1
8		1083862	-	1	1	H	Clamp, Capacitor	1095022	1	1	1
9	Wheel, Blower	706038	1			J	Housing, Blower	1081213	1	1	
9		1082068	-	1		J		1082149	-	-	1
9		1082069	-	-	1	K	Bracket, Blower Mounting	1081116	1	1	
10	Evaporator Coil	1081131	1			L	Bracket, Blower Mounting	1081119	1	1	
10		1082108	-	1		M	Bracket, Blower Mounting	1081117	1	1	
10		1082335	-	-	1	N	Bracket, Blower Mounting	1081118	1	1	
11	Feeder Tube Asy (Evap)	1081248	1			O	Panel, Blower Cutoff	721020013	1	1	
11		1082105	-	1		O		1082176	-	-	1
11		1082292	-	-	1	P	Bracket, Heater Box	1081114	1	1	1
12	Manifold (Evap)	1081156	1			Q	Plate, Heater Cover	1083655	1	1	1
12		1081157	-	1		R	Box, Heater	1081111	1	1	1
12		1082710	-	-	1	S	Bracket, Heater Box	1081112	1	1	1
13	Port Asy, Test	1083859	1	1	1	T	Bracket, Heater Box	1081113	1	1	
14	Manifold, Discharge (Cond)	1081145	1			T		1082179	-	-	1
14		1081146	-	1		U	Ring, Air Duct 12"	1066734	1	1	1
14		1082376	-	-	1	V	Ring, Air Duct 14"	1066735	1	1	1
15	Manifold, Liquid (Cond)	1081153	1			W	Panel, Rear	1081101	1	1	1
15		1082198	-	1		X	Bracket, Evap Coil	1081110	1	1	1
15		1082398	-	-	1	Y	Panel, Base	1081100	1	1	1
16	Capacitor, 10 / 370V	1094956	1	1	1	Z	Pan, Drain	1081120	1	1	1
17	Contact, 20 AMP 3 POLE	1083121	1	1			Manual, Parts List	42604100500	1	1	1
17	30 AMP 3 POLE	607339	-	-	1		Manual, Installation	42601100300	1	1	1
18	Relay	92840	1	1	1						
19	Transformer	1083797	1	1	1						
29	Restrictor, Flow Control	1082106	-	1							
31	Valve, Expansion	1082294	-	-	1						

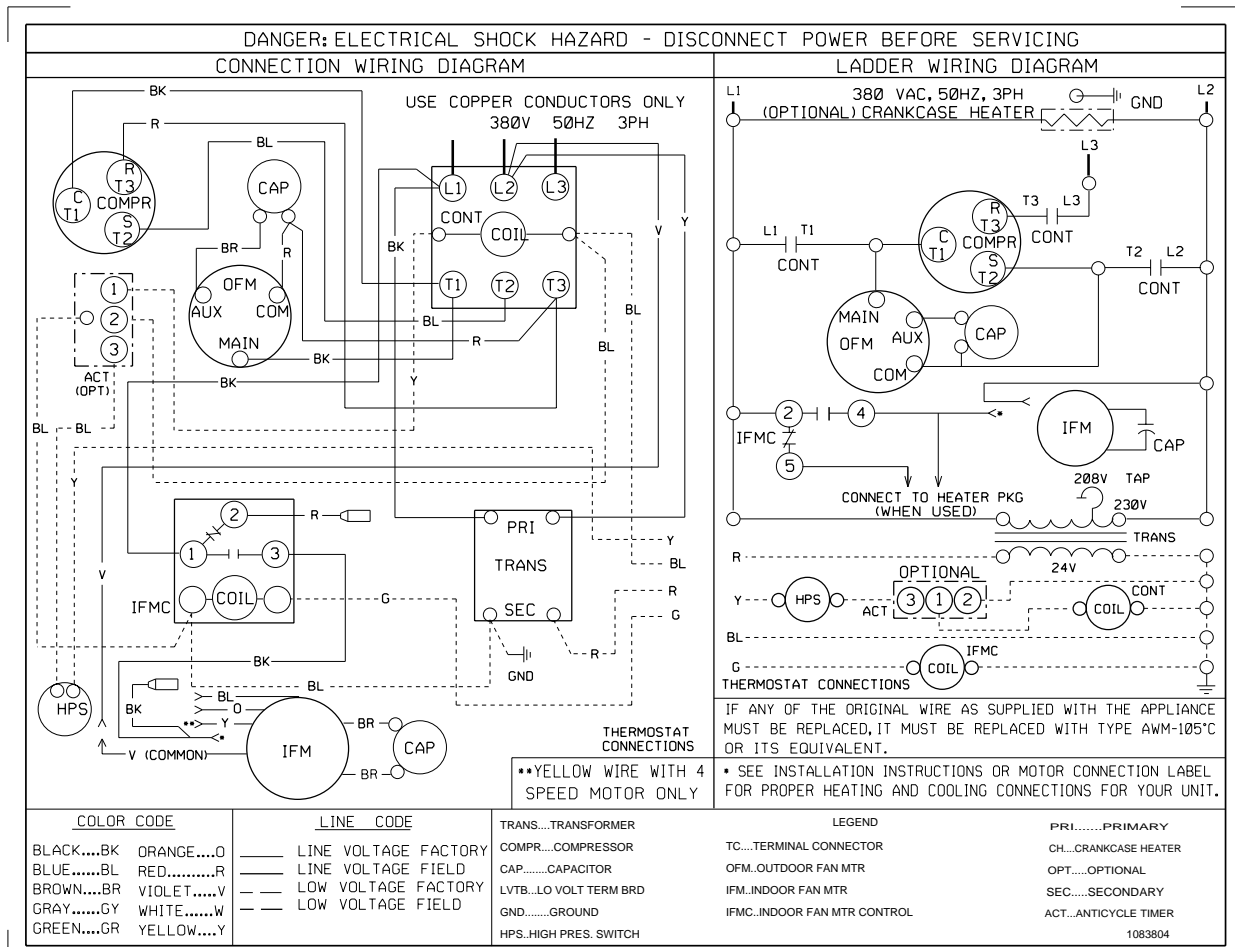

Style No:	PA5536AZA		Outdoor Ambient Temperature - Degrees F. Dry Bulb																																							
	Voltage	380 / 50	75								85								95								105								115							
			59	63	67	71	59	63	67	71	59	63	67	71	59	63	67	71	59	63	67	71																				
Phase	3		Entering Indoor Temperature - Degrees F. Wet Bulb																																							
Phase	11																																									
Wire Ga/Ft	15	NEC																																								
Delay Fuse	15																																									
Max. Fuse	15																																									
Compressor	COPELAND																																									
RLA	6.1																																									
LRA	40																																									
Cap MFD/V																																										
CC Heater																																										
Start Kit																																										
Cond & Evap	Cond	Evap																																								
Type	Fan	Blower																																								
Size	20	DD10-8																																								
Motor-HP	1/3	1 / 3																																								
Type	PSC	PSC																																								
FLA	1.32	2.1																																								
LRA																																										
RPM	1120	1075																																								
Cap MFD/V	5 / 370	5 / 370																																								
PTCR	N/A																																									
Hi Press	N/A																																									
Low Press	N/A																																									
Operating Chg (No Lines)*	(R-22 Oz) 84																																									
Service Driers	16 Cu In / 11 oz		Air Delivery in CFM - Dry Coil - No Filter (Add .05 static for Wet Coil)																																							
			External Static Press (Inch Water Column)																																							
Liquid/Chg	30 Sq In		Speed Tap																																							
			HI																																							
Suction			MD HI																																							
			MD LO																																							
Unit Weight	280		LO																																							
																																1083866										
																																6/8/97										

Style No:		PA5548AZA		Outdoor Ambient Temperature - Degrees F. Dry Bulb																					
Voltage		380 / 50		75				85				95				105				115					
Phase		3		Entering Indoor Temperature - Degrees F. Wet Bulb																					
Ampacity		12.2		IDB																					
Wire Ga/Ft		NEC		59	63	67	71	59	63	67	71	59	63	67	71	59	63	67	71	59	63	67	71		
Delay Fuse	20			MBh	37.2	38.5	42.2	-	36.3	37.6	41.2	-	35.4	36.7	40.2	-	33.6	34.9	38.2	-	31.2	32.3	35.4	-	
Max. Fuse	20			S/T	0.84	0.70	0.49	-	0.87	0.72	0.50	-	0.89	0.75	0.52	-	0.93	0.77	0.54	-	0.93	0.78	0.54	-	
Compressor	COPELAND			AMPS	7.4	7.5	7.7	-	7.9	8.1	8.3	-	8.3	8.5	8.7	-	8.8	9.0	9.2	-	9.2	9.4	9.7	-	
				HI PR	197	212	224	-	224	241	255	-	255	275	290	-	287	309	326	-	317	341	361	-	
				LO PR	67	72	78	-	70	74	81	-	73	78	85	-	77	82	89	-	80	85	92	-	
RLA	8.2			75	MBh	37.8	38.9	42.1	45.2	36.9	38.0	41.1	44.1	36.0	37.1	40.1	43.1	34.2	35.2	38.1	40.9	31.7	32.6	35.3	37.9
LRA	48				S/T	0.96	0.86	0.65	0.42	0.98	0.88	0.67	0.43	1.00	0.91	0.69	0.44	1.00	0.94	0.71	0.46	1.00	0.95	0.72	0.46
Cap MFD/V					AMPS	7.5	7.6	7.8	8.0	8.0	8.1	8.3	8.6	8.4	8.6	8.8	9.1	8.9	9.0	9.3	9.6	9.3	9.5	9.7	10.1
CC Heater				HI PR	199	214	226	236	226	244	257	268	258	278	293	306	290	312	330	344	321	345	364	380	
Start Kit				LO PR	68	72	79	84	71	75	82	87	74	79	86	92	78	83	90	96	80	86	93	99	
Cond & Evap	Cond	Evap	Air Delivery in CFM - Dry Coil - No Filter (Add .05 static for Wet Coil)																						
Type	Fan	Blower																							
Size	20	DD10-8																							
Motor-HP	1/3	3 / 4																							
Type	PSC	PSC																							
FLA	1.32	2.7																							
LRA																									
RPM	1140	1075																							
Cap MFD/V	7.5/370	20/370																							
PTCR	N/A			80	MBh	39.1	39.9	41.8	44.6	38.2	39.0	40.8	43.5	37.3	38.0	39.8	42.5	35.4	36.1	37.8	40.3	32.8	33.4	35.0	37.4
					S/T	1.00	1.00	0.96	0.78	1.00	1.00	0.98	0.80	1.00	1.00	1.00	0.82	1.00	1.00	1.00	0.86	1.00	1.00	1.00	0.86
					AMPS	7.5	7.7	7.9	8.1	8.0	8.2	8.4	8.7	8.5	8.6	8.9	9.2	8.9	9.1	9.4	9.6	9.4	9.5	9.8	10.1
Hi Press	N/A			HI PR	201	216	229	238	229	246	260	271	260	280	296	309	293	315	333	347	324	348	368	384	
Low Press	N/A			LO PR	69	73	80	85	71	76	83	88	75	80	87	93	79	84	91	97	81	86	94	100	
Operating Chg (No Lines)*	(R-22 Oz)			81	External Static Press (Inch Water Column)																				
					Speed Tap	0.15	0.25	0.35	0.45	0.55	0.65	0.75													
					HI	-	1904	1822	1736	1635	1530	1411													
Service Driers			MD HI	-	1827	1759	1670	1572	1478	1377															
Liquid/Chg	30 Cu In / 17 oz		MD LO	-	1707	1651	1577	1497	1417	1322															
Suction	30 Sq In		LO	-	-	-	-	-	-	-															
Unit Weight	280																			1083867					
																				6/8/97					

Style No:		PA5560AZA		Outdoor Ambient Temperature - Degrees F. Dry Bulb																					
Voltage		380 / 50		75				85				95				105				115					
Phase		3		Entering Indoor Temperature - Degrees F. Wet Bulb																					
Ampacity		17.1		IDB																					
Wire Ga/Ft		NEC		59	63	67	71	59	63	67	71	59	63	67	71	59	63	67	71	59	63	67	71		
Delay Fuse	20			MBh	46.5	48.2	52.8	-	45.4	47.0	51.5	-	44.3	45.9	50.3	-	42.0	43.6	47.7	-	38.9	40.4	44.2	-	
Max. Fuse	25			S/T	0.80	0.67	0.47	-	0.82	0.69	0.48	-	0.85	0.71	0.49	-	0.88	0.74	0.51	-	0.89	0.74	0.52	-	
Compressor	COPELAND			AMPS	8.6	8.7	9.0	-	9.2	9.4	9.6	-	9.7	9.9	10.2	-	10.2	10.4	10.7	-	10.7	11.0	11.3	-	
				HI PR	200	216	228	-	228	245	259	-	260	279	295	-	292	314	332	-	323	347	367	-	
				LO PR	61	64	70	-	63	67	73	-	66	70	77	-	69	74	81	-	72	76	83	-	
RLA	10.5			75	MBh	47.3	48.6	52.7	56.5	46.1	47.5	51.4	55.2	45.0	46.3	50.2	53.8	42.8	44.0	47.6	51.1	39.6	40.8	44.1	47.4
LRA	64				S/T	0.91	0.82	0.62	0.40	0.94	0.84	0.63	0.41	0.97	0.87	0.65	0.42	1.00	0.90	0.68	0.44	1.00	0.91	0.69	0.44
Cap MFD/V					AMPS	8.6	8.8	9.1	9.3	9.3	9.4	9.7	10.0	9.8	10.0	10.3	10.6	10.3	10.5	10.8	11.2	10.8	11.1	11.4	11.8
CC Heater				HI PR	202	218	230	240	230	248	262	273	262	282	298	311	295	317	335	350	326	351	370	386	
Start Kit				LO PR	61	65	71	76	64	68	74	79	67	71	78	83	70	75	81	87	72	77	84	90	
Cond & Evap	Cond	Evap	Air Delivery in CFM - Dry Coil - No Filter (Add .05 static for Wet Coil)																						
Type	Fan	Blower																							
Size	20	DD11-8																							
Motor-HP	1/3	3 / 4																							
Type	PSC	PSC																							
FLA	1.32	2.7																							
LRA																									
RPM	1140	1075																							
Cap MFD/V	7.5/370	20/370																							
PTCR	N/A			80	MBh	48.9	49.9	52.2	55.7	47.8	48.7	51.0	54.4	46.6	47.5	49.8	53.1	44.3	45.1	47.3	50.4	41.0	41.8	43.8	46.7
					S/T	1.00	1.00	0.92	0.74	1.00	1.00	0.94	0.76	1.00	1.00	0.97	0.79	1.00	1.00	1.00	0.82	1.00	1.00	1.00	0.82
					AMPS	8.8	8.9	9.2	9.5	9.4	9.6	9.9	10.2	9.9	10.1	10.4	10.8	10.5	10.7	11.0	11.4	11.0	11.2	11.6	12.0
Hi Press	N/A			HI PR	207	222	235	245	235	253	267	278	268	288	304	317	301	324	342	357	333	358	378	394	
Low Press	N/A			LO PR	62	66	73	77	65	69	75	80	68	73	79	84	71	76	83	88	74	79	86	91	
Operating Chg (No Lines)*	(R-22 Oz)			106	External Static Press (Inch Water Column)																				
					Speed Tap	0.15	0.25	0.35	0.45	0.55	0.65	0.75													
					HI	-	2214	2139	2050	1948	1866	1808													
Service Driers			MD HI	-	1919	1878	1837	1789	1737	1692															
Liquid/Chg	30 Cu In / 17 oz		MD LO	-	-	-	-	-	-	-															
Suction	30 Sq In		LO	-	-	-	-	-	-	-															
Unit Weight	295																			1083868					
																				6/8/97					