

# Technical Information

## Models

### Single Phase

NPAHC24BK01	NA6P024B3Y1
NPAHC30BK01	NA6P030B3Y1
NPAHC36AK01	NA6P036A3Y1
NPAHC42AK01	NA6P042A3Y1
NPAHC48AK01	NA6P048A3Y1
NPAHC60AK01	NA6P060A3Y1

# Residential Package Air Conditioning Units

Save This Manual For Future Reference

## ELECTRIC POWER REQUIREMENTS

All units 208/230 nominal Volts, 60Hz  
Minimum operating volts 187, Maximum voltage 253; Use copper wire ONLY.

MODEL NUMBER	TOTAL AMPS COOL	MINIMUM CIRCUIT AMPACITY	POWER WIRING*		MINIMUM GROUND WIRE SIZE	MAXIMUM FUSE	TIME DELAY FUSE SIZE/ HACR BREAKER (AMPS)	DISCONNECT SWITCH SIZE (AMPS)
			MAX. LENGTH FEET	MIN. SIZE AWG				
<b>1Ø Units</b>								
NPAHC24BK/NA6P024B3Y	16.0	17.5	40	12	14	30	25	30
NPAHC30BK/NA6P030B3Y	18.1	19.9	45	12	14	30	25	30
NPAHC36AK/NA6P036A3Y	25.6	28.0	55	10	12	45	35	60
NPAHC42AK/NA6P042A3Y	27.6	30.4	78	8	10	50	40	60
NPAHC48AK/NA6P048A3Y	32.3	35.5	78	8	10	50	45	60
NPAHC60AK/NA6P060A3Y	38.0	41.9	76	6	10	60	50	60

\* Based on National Electric Code, NFPA70, 60°C rated wire.

## PERFORMANCE DATA / REFRIGERANT CHARGE

All units 208/230 nominal Volts, 60Hz  
Minimum operating volts 187, Maximum voltage 253; Use copper wire ONLY.

MODEL NUMBER	REFRIG. CHARGE R-22/OZ.	AIR FLOW (CFM)	230 VOLT B.T.U.H.	COOLING	
				BLOWER SPEED (AS SHIPPED)	EXTERNAL STATIC
<b>1Ø Units</b>					
NPAHC24BK/NA6P024B3Y	72	800	24,000	LO	.60
NPAHC30BK/NA6P030B3Y	69	1000	29,600	HI	.30
NPAHC36AK/NA6P036A3Y	114	1200	35,600	LO	.30
NPAHC42AK/NA6P042A3Y	116	1400	42,000	MED	.40
NPAHC48AK/NA6P048A3Y	109	1600	48,000	HI	.40
NPAHC60AK/NA6P060A3Y	110	2000	58,000	HI	.30

\* Based on National Electric Code, NFPA70, 60°C rated wire.

## BLOWER PERFORMANCE DATA

Model Number	NPAHC24BK NA6P024B3Y			NPAHC30BK NA6P030B3Y			NPAHC36AK NA6P036A3Y			NPAHC42AK NA6P042A3Y			NPAHC48AK NA6P048A3Y			NPAHC60AK NA6P060A3Y			
	Lo	Md	Hi	Lo	Md	Hi	Lo	Md	Hi	Lo	Md	Hi	Lo	Md	Hi	Lo	Md	Hi	
Air Delivery In CFM Varying In Static Pressure (In. W.C.)	.10	885	100	1160	900	1020	1180	1240	1415	1640	1205	1395	1620	1370	—	1830	1650	—	2130
	.20	860	965	1120	880	990	1150	1225	1390	1585	1185	1365	1560	1335	—	1765	1585	—	1980
	.30	830	930	1095	860	960	1130	1200	1355	1520	1165	1330	1500	1290	—	1730	1505	—	1915
	.40	800	900	1060	840	940	1100	1170	1310	1465	1140	1285	1435	1230	—	1590	1410	—	1830
	.50	760	850	1000	810	900	1050	1140	1260	1405	1110	1230	1371	1165	—	1490	1305	—	1740

Air delivery against shown external static pressures taken with 230V. to unit, dry coil and equipped with maximum size approved heater. For wet coil subtract approximately 25 C.F.M.

# TECH DATA

Model or Style No. PAHC24AK		Performance Data: 80° F D.B. Indoor										Rated 800 CFM ESP Wet.32 *Chg. R-22 74 Oz.				
Specifications		Low Wet Bulb (63°F)					High Wet Bulb (71°F)									
<b>Electrical:</b> Voltage Branch Circuit Ampacity Wire Size/Max. Ft. Time Delay/HACR Brk. Max. Fuse	208/230-1-60 17.5 No. 12 / 40' 25 30	Coil - INTERNAL														
		Ambient Outdoor °F	Approx. MBTUH	Sens. Total Ratio	High Press.	Low Press.	Unit Amps	Ambient Outdoor °F	Approx. MBTUH	Sens. Total Ratio	High Press.	Low Press.	Unit Amps			
		75	23.8	0.86	194	69	9.3	75	27.4	0.53	215	80	9.9			
		95	22.7	0.91	252	75	10.6	95	26.1	0.56	277	87	11.3			
115	19.9	0.95	313	81	11.8	115	22.8	0.58	345	95	12.6					
<b>Fan Motor:</b> H.P./Type FLA/LRA Speeds / RPM Cap. MFD/Volts	COND. EVAP. 1/4 PSC 1/3 PSC 1.4/3.2 1.7/4.3 1/1050 2/1100 4/370 10/370	Coil -					Rated CFM Δ P Wet. *Chg. R-22 Oz.									
		75					75									
		95					95									
115					115											
<b>Compressor:</b> FLA / LRA Run Cap. MFD. / Volts	COPELAND 12.9 / 62.5 35 / 370	Coil -					Rated CFM Δ P Wet. *Chg. R-22 Oz.									
		75					75									
		95					95									
115					115											
<b>Service Driers:</b> Liquid/Charge Suction	_____ _____	Coil -					Rated CFM Δ P Wet. *Chg. R-22 Oz.									
		75					75									
		95					95									
115					115											
<b>Line Size: (100 Ft. Max.)</b> Liquid Suction	_____ _____ _____	Coil -					Rated CFM Δ P Wet. *Chg. R-22 Oz.									
		75					75									
		95					95									
115					115											
* Ref. Charge (R-22 Oz.) 74 * Lines not included: .25 oz./ft.-1/4 liq. line .45 oz./ft.-5/16 liq. line .60 oz./ft.-3/8 liq. line		Coil -					Rated CFM Δ P Wet. *Chg. R-22 Oz.									
<b>Clearances</b> See Installation Instructions		75					75									
		95					95									
		115					115									

Note: Optimum operating charge will produce 15° - 25° F suction line superheat at compressor with 82° F outdoor ambient and 80° F dry bulb (67° F wet bulb) indoor temperature at rated airflow.

512936-A  
2-1-93  
AH-2

Model or Style No. PAHC30AK		Performance Data: 80° F D.B. Indoor										Rated 1000 CFM ESP Wet. 65 *Chg. R-22 71 Oz.				
Specifications		Low Wet Bulb (63°F)					High Wet Bulb (69°F)									
<b>Electrical:</b> Voltage Branch Circuit Ampacity Wire Size/Max. Ft. Time Delay/HACR Brk. Max. Fuse Boost Transformer	208/230-1-60 19.9 No. 12 / 45' 25 30	Coil - INTERNAL														
		Ambient Outdoor °F	Approx. MBTUH	Sens. Total Ratio	High Press.	Low Press.	Unit Amps	Ambient Outdoor °F	Approx. MBTUH	Sens. Total Ratio	High Press.	Low Press.	Unit Amps			
		75	29.1	0.86	200	67	12.1	75	33.2	0.52	221	78	12.8			
		95	27.7	0.91	259	73	13.8	95	31.6	0.55	286	85	14.7			
115	24.4	0.95	323	79	15.4	115	27.8	0.58	355	92	16.4					
<b>Fan Motor:</b> H.P./Type FLA/LRA Speeds / RPM Cap. MFD/Volts	COND. EVAP. 1/4 PSC 1/3 PSC 1.4/3.2 1.7/4.3 1/1050 2/1100 4/370 10/370	Coil -					Rated CFM Δ P Wet. *Chg. R-22 Oz.									
		75					75									
		95					95									
115					115											
<b>Compressor:</b> FLA / LRA Run Cap. MFD. / Volts Acc. Start Kit	COPELAND 15.0 / 76 35 / 370 NAMA001SC01	Coil -					Rated CFM Δ P Wet. *Chg. R-22 Oz.									
		75					75									
		95					95									
115					115											
<b>Service Driers:</b> Liquid/Charge Suction	_____ _____	Coil -					Rated CFM Δ P Wet. *Chg. R-22 Oz.									
		75					75									
		95					95									
115					115											
<b>Line Size: (100 Ft. Max.)</b> Liquid Suction	_____ _____ _____	Coil -					Rated CFM Δ P Wet. *Chg. R-22 Oz.									
		75					75									
		95					95									
115					115											
* Ref. Charge (R-22 Oz.) 71 * Lines not included: .25 oz./ft.-1/4 liq. line .45 oz./ft.-5/16 liq. line .60 oz./ft.-3/8 liq. line		Coil -					Rated CFM Δ P Wet. *Chg. R-22 Oz.									
<b>Clearances</b> See Installation Instructions		75					75									
		95					95									
		115					115									

Note: Optimum operating charge will produce 15° - 25° F suction line superheat at compressor with 82° F outdoor ambient and 80° F dry bulb (67° F wet bulb) indoor temperature at rated airflow.

512937-A  
2-1-93  
AH-2

# TECH DATA

Model or Style No. PAHC36AK		Performance Data: 80° F D.B. Indoor										Rated 1200 CFM ESP Wet.23 *Chg. R-22 117 Oz.				
Specifications		Low Wet Bulb (63°F)					High Wet Bulb (71°F)									
<b>Electrical:</b> Voltage 208/230-1-60 Branch Circuit Ampacity 27.3 Wire Size/Max. Ft. No. 10 / 55' Time Delay/HACR Brk. 35 Max. Fuse 40		Coil - INTERNAL														
		Ambient Outdoor °F	Appox. MBTUH	Sens. Total Ratio	High Press.	Low Press.	Unit Amps	Ambient Outdoor °F	Appox. MBTUH	Sens. Total Ratio	High Press.	Low Press.	Unit Amps			
		75	35.0	0.88	187	65	13.6	75	40.0	0.54	206	75	14.4			
		95	33.3	0.93	242	71	15.4	95	38.1	0.57	267	82	16.3			
115	29.3	0.98	301	76	17.0	115	33.5	0.59	332	89	18.0					
<b>Fan Motor:</b> COND. 1/4 PSC H.P./Type 1.4/3.2 FLA/LRA 1/1050 Speeds / RPM 2/1000 Cap. MFD/Volts 5/440 10/370	COND. 1/2 PSC EVAP. 3.2/ 7.1	Coil -										Rated	CFM	Δ P Wet.	*Chg. R-22	Oz.
		75						75								
		95						95								
115						115										
<b>Compressor:</b> FLA / LRA 20.0 / 90.5 Run Cap. MFD. / Volts 35 / 440	COPELAND	Coil -										Rated	CFM	Δ P Wet.	*Chg. R-22	Oz.
		75						75								
		95						95								
115						115										
<b>Service Driers:</b> Liquid/Charge _____ Suction _____	_____	Coil -										Rated	CFM	Δ P Wet.	*Chg. R-22	Oz.
		75						75								
		95						95								
115						115										
<b>Line Size: (100 Ft. Max.)</b> Liquid _____ Suction _____	_____	Coil -										Rated	CFM	Δ P Wet.	*Chg. R-22	Oz.
		75						75								
		95						95								
115						115										
<b>* Ref. Charge (R-22 Oz.)</b> 117 *Lines not included: .25 oz./ft.-1/4 liq. line .45 oz./ft.-5/16 liq. line .80 oz./ft.-3/8 liq. line	_____	Coil -										Rated	CFM	Δ P Wet.	*Chg. R-22	Oz.
		75						75								
		95						95								
115						115										
<b>Clearances</b> See Installation Instructions	_____	Coil -										Rated	CFM	Δ P Wet.	*Chg. R-22	Oz.
		75						75								
		95						95								
115						115										
<b>Note: Optimum operating charge will produce 15° - 25° F suction line superheat at compressor with 82° F outdoor ambient and 80° F dry bulb (67° F wet bulb) indoor temperature at rated airflow.</b>												512938-A				
												2-1-93				
												AH-2				

Model or Style No. PAHC42AK		Performance Data: 80° F D.B. Indoor										Rated 1400 CFM ESP Wet.20 *Chg. R-22 112 Oz.				
Specifications		Low Wet Bulb (63°F)					High Wet Bulb (71°F)									
<b>Electrical:</b> Voltage 208/230-1-60 Branch Circuit Ampacity 30.4 Wire Size/Max. Ft. No. 8 / 78' Time Delay/HACR Brk. 40 Max. Fuse 50		Coil - INTERNAL														
		Ambient Outdoor °F	Appox. MBTUH	Sens. Total Ratio	High Press.	Low Press.	Unit Amps	Ambient Outdoor °F	Appox. MBTUH	Sens. Total Ratio	High Press.	Low Press.	Unit Amps			
		75	41.3	0.86	197	69	17.1	75	47.1	0.52	217	80	18.1			
		95	39.3	0.91	255	75	19.4	95	44.9	0.55	281	87	20.7			
115	34.6	0.95	317	81	21.6	115	39.5	0.58	349	95	23.0					
<b>Fan Motor:</b> COND. 1/4 PSC H.P./Type 1.4/3.2 FLA/LRA 1/1050 Speeds / RPM 2/1100 Cap. MFD/Volts 5/440 10/370	COND. 1/2 PSC EVAP. 3.2/7.1	Coil -										Rated	CFM	Δ P Wet.	*Chg. R-22	Oz.
		75						75								
		95						95								
115						115										
<b>Compressor:</b> FLA / LRA 22.0 / 107.0 Run Cap. MFD. / Volts 40/440	COPELAND	Coil -										Rated	CFM	Δ P Wet.	*Chg. R-22	Oz.
		75						75								
		95						95								
115						115										
<b>Service Driers:</b> Liquid/Charge _____ Suction _____	_____	Coil -										Rated	CFM	Δ P Wet.	*Chg. R-22	Oz.
		75						75								
		95						95								
115						115										
<b>Line Size: (100 Ft. Max.)</b> Liquid _____ Suction _____	_____	Coil -										Rated	CFM	Δ P Wet.	*Chg. R-22	Oz.
		75						75								
		95						95								
115						115										
<b>* Ref. Charge (R-22 Oz.)</b> 112 *Lines not included: .25 oz./ft.-1/4 liq. line .45 oz./ft.-5/16 liq. line .80 oz./ft.-3/8 liq. line	_____	Coil -										Rated	CFM	Δ P Wet.	*Chg. R-22	Oz.
		75						75								
		95						95								
115						115										
<b>Clearances</b> See Installation Instructions	_____	Coil -										Rated	CFM	Δ P Wet.	*Chg. R-22	Oz.
		75						75								
		95						95								
115						115										
<b>Note: Optimum operating charge will produce 15° - 25° F suction line superheat at compressor with 82° F outdoor ambient and 80° F dry bulb (67° F wet bulb) indoor temperature at rated airflow.</b>												512938-A				
												2-1-93				
												AH-2				

# CONNECTION AND LADDER WIRING DIAGRAM: ALL MODELS

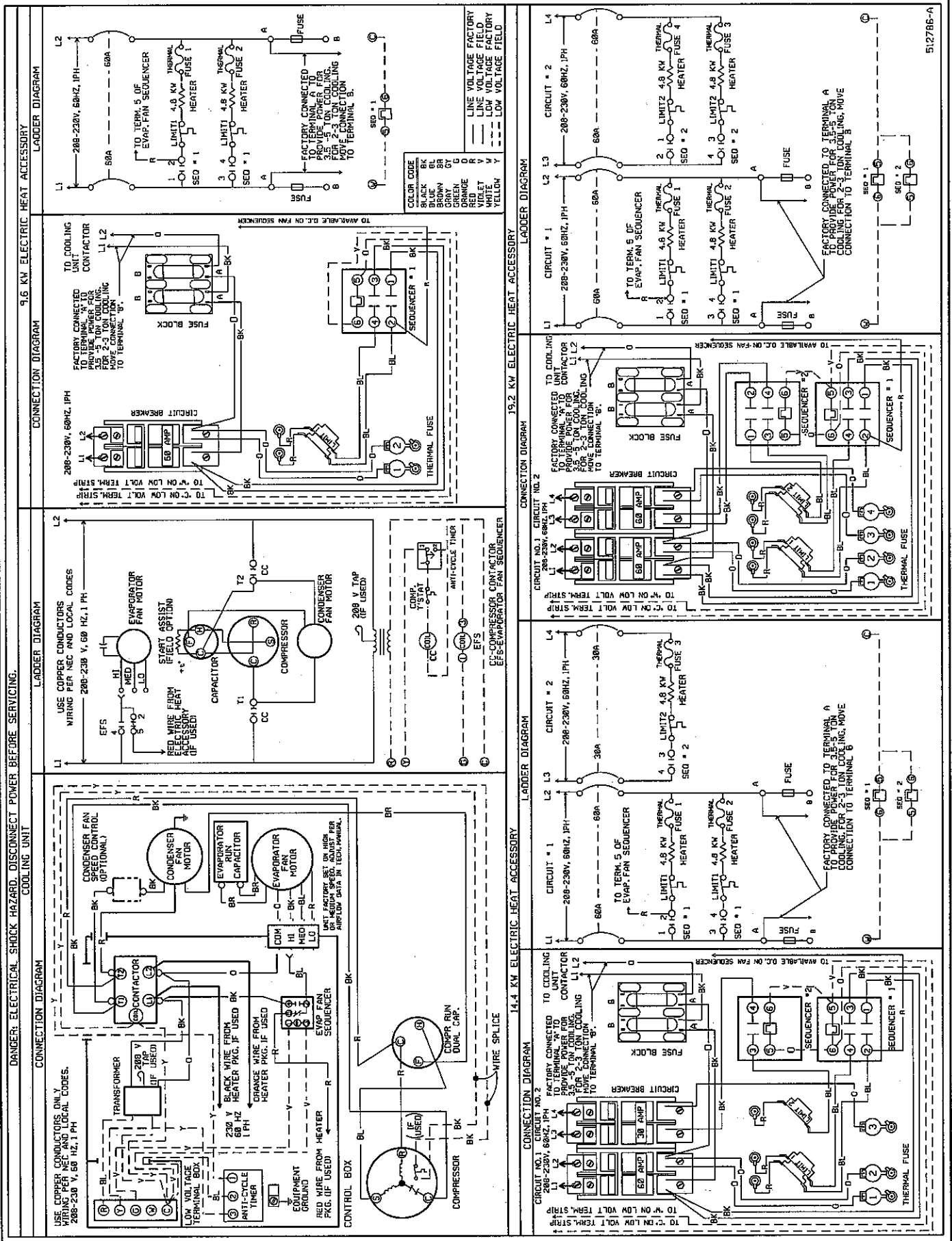

5127BE-A

# TECH DATA

Model or Style No. PAHC48AK		Performance Data: 80° F D.B. Indoor						Rated 1600CFM ESP Wet.32 *Chg. R-22 109 Oz.					
Specifications		Low Wet Bulb (63°F)						High Wet Bulb (71°F)					
<b>Electrical:</b> Voltage 208/230-1-60 Branch Circuit Ampacity 35.5 Wire Size/Max. Ft. 8/78 Time Delay/HACR Brk. 45 Max. Fuse 50		Coil - INTERNAL											
		Ambient Outdoor °F	Appox. MBTUH	Sens. Total Ratio	High Press.	Low Press.	Unit Amps	Ambient Outdoor °F	Appox. MBTUH	Sens. Total Ratio	High Press.	Low Press.	Unit Amps
		75	46.2	.60	195	68	19.0	75	—	—	—	—	—
		95	44.0	.63	252	75	21.8	95	—	—	—	—	—
		Coil -						Rated CFM Δ P Wet. * Chg. R-22 Oz.					
<b>Fan Motor:</b> H.P./Type 1/4 PSC 3/4PSC FLA/LRA 1.9/3.8 4.0/9.5 Speeds / RPM 1100 1100 Cap. MFD/Volts 5/370 10/440		75						75					
		95						95					
		115						115					
<b>Compressor:</b> COPELAND FLA / LRA 26.4 / 129 Run Cap. MFD. / Volts 40/440		Coil -						Rated CFM Δ P Wet. * Chg. R-22 Oz.					
		75						75					
		95						95					
<b>Service Driers:</b> Liquid/Charge Suction ———		Coil -						Rated CFM Δ P Wet. * Chg. R-22 Oz.					
		75						75					
		95						95					
<b>Line Size: (100 Ft. Max.)</b> Liquid Suction ———		Coil -						Rated CFM Δ P Wet. * Chg. R-22 Oz.					
		75						75					
		95						95					
<b>* Ref. Charge (R-22 Oz.)</b> 109 *Lines not included: .25 oz./ft.-1/4 liq. line .45 oz./ft.-5/16 liq. line .60 oz./ft.-3/8 liq. line		Coil -						Rated CFM Δ P Wet. * Chg. R-22 Oz.					
		75						75					
		95						95					
<b>Clearances</b> See Installation Instructions		Coil -						Rated CFM Δ P Wet. * Chg. R-22 Oz.					
		75						75					
		95						95					
								513450 2-1-93 AH-1					

Model or Style No. PAHC60AK		Performance Data: 80° F D.B. Indoor						Rated 2000 CFM ESP Wet.32 *Chg. R-22 110 Oz.					
Specifications		Low Wet Bulb (63°F)						High Wet Bulb (71°F)					
<b>Electrical:</b> Voltage 208/230-1-60 Branch Circuit Ampacity 41.9 Wire Size/Max. Ft. 6/76 Time Delay/HACR Brk. 50 Max. Fuse 60		Coil - INTERNAL											
		Ambient Outdoor °F	Appox. MBTUH	Sens. Total Ratio	High Press.	Low Press.	Unit Amps	Ambient Outdoor °F	Appox. MBTUH	Sens. Total Ratio	High Press.	Low Press.	Unit Amps
		75	55.9	.63	203	65	23.4	75	—	—	—	—	—
		95	53.2	.67	264	71	26.5	95	—	—	—	—	—
		Coil -						Rated CFM Δ P Wet. * Chg. R-22 Oz.					
<b>Fan Motor:</b> H.P./Type 1/4 PSC 3/4 PSC FLA/LRA 1.9/3.8 4.0/9.5 Speeds / RPM 1100 1100 Cap. MFD/Volts 5/370 10/440		75						75					
		95						95					
		115						115					
<b>Compressor:</b> COPELAND FLA / LRA 32.1/169.0 Run Cap. MFD. / Volts 55/440		Coil -						Rated CFM Δ P Wet. * Chg. R-22 Oz.					
		75						75					
		95						95					
<b>Service Driers:</b> Liquid/Charge Suction ———		Coil -						Rated CFM Δ P Wet. * Chg. R-22 Oz.					
		75						75					
		95						95					
<b>Line Size: (100 Ft. Max.)</b> Liquid Suction ———		Coil -						Rated CFM Δ P Wet. * Chg. R-22 Oz.					
		75						75					
		95						95					
<b>* Ref. Charge (R-22 Oz.)</b> 110 *Lines not included: .25 oz./ft.-1/4 liq. line .45 oz./ft.-5/16 liq. line .60 oz./ft.-3/8 liq. line		Coil -						Rated CFM Δ P Wet. * Chg. R-22 Oz.					
		75						75					
		95						95					
<b>Clearances</b> See Installation Instructions		Coil -						Rated CFM Δ P Wet. * Chg. R-22 Oz.					
		75						75					
		95						95					
								513451 2-1-93 AH-1					

# Functional Replacement Parts – All Models

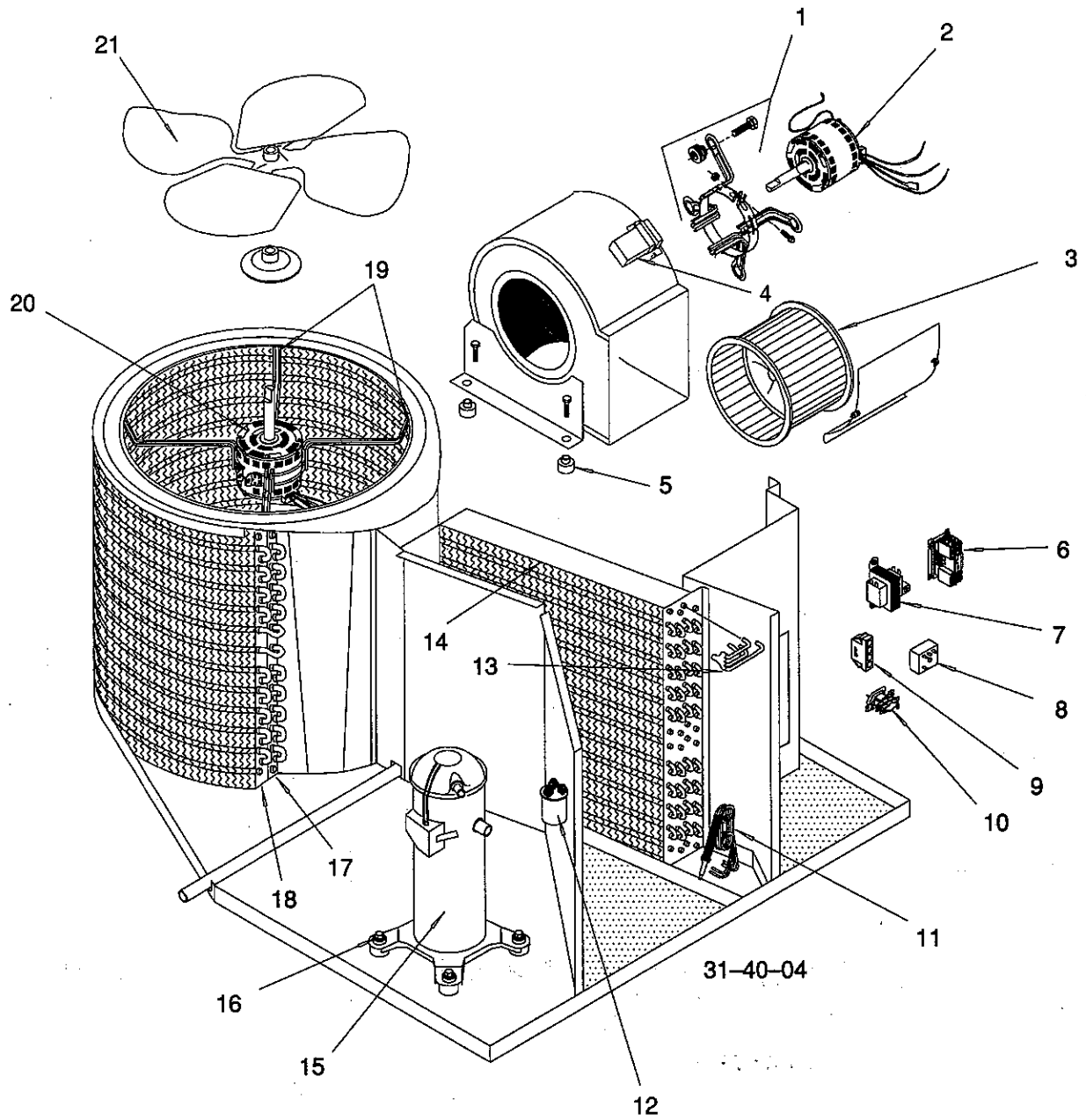

# Replacement Parts

Replacement part supplied will be current active part.  
For parts not listed, consult place of purchase.

			Model Number/Quantity Required					
			NPAHC					
			24BK01	30BK01	36AK01	42AK01	48AK01	60AK01
Key No.	Description	Replacement Part Number	NA6PO					
			24B3Y1	30B3Y1	36A3Y1	42A3Y1	48A3Y1	60A3Y1
1	Kit, Motor Mount	1050254	1	-	-	-	-	-
		609227	-	1	1	1	1	1
2	Motor, Blower	1064043	1	1	-	-	-	-
		513011	-	-	1	1	-	-
		1053917	-	-	-	-	1	1
3	Wheel, Blower	703493	1	1	-	-	-	-
		1056309	-	-	1	1	-	-
		2120143	-	-	-	-	1	1
4	Capacitor, 5 MFD., 370V.	1053139	1	1	-	-	-	-
	5 / 10MFD., 370V.	1057742	-	-	1	1	-	-
	10MFD, 440V.	1053918	-	-	-	-	1	1
5	Grommet, Blower Mount	64475	4	4	4	4	4	4
6	Contactor,	1050839	-	-	-	1	1	1
7	Transformer	1059988	1	1	1	1	1	1
8	Timer, Anti-Cycle	1060410	1	1	1	1	1	1
9	Block, Blower Terminal	96471	1	1	1	1	1	1
10	Sequencer	1054372	1	1	1	1	1	1
11	Tube, Capillary	1054350	1	-	-	-	-	-
		703423	-	1	-	-	-	-
		703441	-	-	1	-	-	-
		1052600	-	-	-	1	-	-
		513332	-	-	-	-	1	-
		513325	-	-	-	-	-	1
12	Capacitor, 5 / 30MFD, 370V.	1052664	1	-	-	-	-	-
	5 / 35MFD., 370V.	1050886	-	1	-	-	-	-
	5 / 35MFD., 440V.	1053068	-	-	1	1	-	-
	5 / 40MFD., 440V.	1053069	-	-	-	-	1	-
	5 / 55MFD., 440V.	1053335	-	-	-	-	-	1
13	Tube, Header	1054897	1	-	-	-	-	-
		708951	-	1	-	-	-	-
		709062	-	-	1	-	-	-
		708860	-	-	-	1	-	-
		513369	-	-	-	-	1	1
14	Coil, Evaporator	512748	1	-	-	-	-	-
		713086	-	1	-	-	-	-
		713088	-	-	1	-	-	-
		512749	-	-	-	1	-	-
		513364	-	-	-	-	1	1
15	Compressor	1059581	1	-	-	-	-	-
		1053333	-	1	-	-	-	-
		1053334	-	-	1	-	-	-
		1052767	-	-	-	1	-	-
		1062126	-	-	-	-	1	-
		1062139	-	-	-	-	-	1
16	Grommet, Compressor Mounting	1053188	4	4	4	4	4	4
17	Coil, Condenser ( Inside )	<del>512748</del>	<del>1</del>	<del>1</del>	<del>1</del>	-	-	-
	512798	<del>512740</del>	<del>1</del>	-	-	1	-	-
	512898	513384	-	-	-	-	1	1
18	Coil, Condenser ( Outside )	512896	1	-	-	-	-	-
		512897	-	1	-	-	-	-
		512909	-	-	1	1	-	-
		513387	-	-	-	-	1	1
19	Kit, Condenser Fan Motor Mount	100124	1	1	1	1	1	1
20	Motor, Condenser Fan:	1057707	1	1	1	1	-	-
		1053831	-	-	-	-	1	1
21	Blade, Fan	1060835	1	1	-	-	-	-
		705523	-	-	1	1	-	-
		1055017	-	-	-	-	1	1
{	Manual, User's Information	1053084	1	1	1	1	1	1
{	Manual, Installation	1060106	1	1	1	1	1	1
{	Manual, Technical Information	513690	1	1	1	1	1	1



# Functional Replacement Parts – All Models

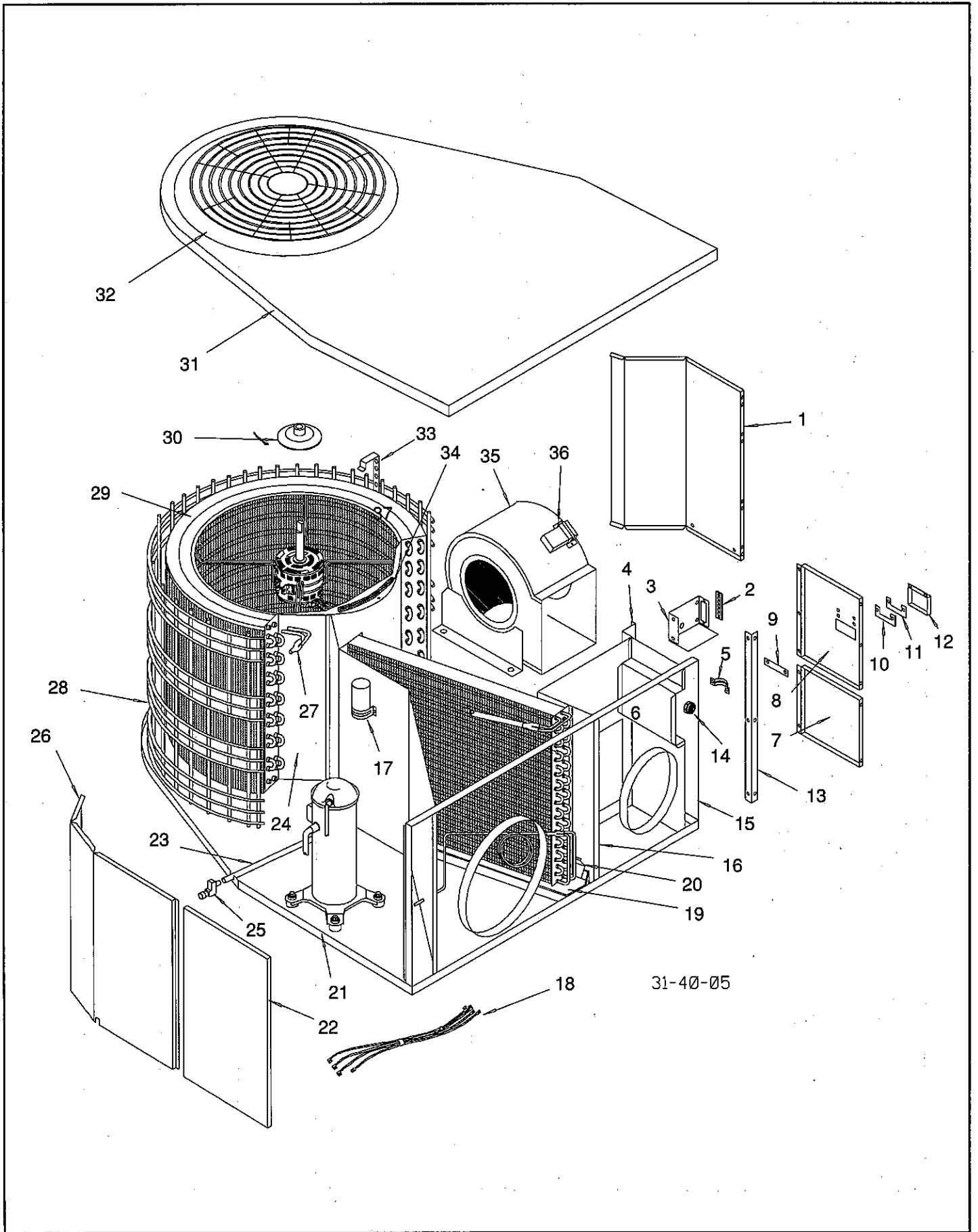

# Replacement Parts

Replacement part supplied will be current active part.  
For parts not listed, consult place of purchase.

Key No.	Description	Replacement Part Number	Model Number/Quantity Required					
			NPAHC					
			24BK01	30BK01	36AK01	42AK01	48AK01	60AK01
1	Panel, Right Side	1057584	1	1	1	1	1	1
2	Board, Terminal	1054901	1	1	1	1	1	1
3	Box, Junction	*	1	1	1	1	1	1
4	Bulkhead, Blower	704697	1	1	1	-	-	-
		1056702	-	-	-	1	1	1
5	Clamp, Capacitor	1051476	1	1	1	1	1	1
6	Box, Control	*	1	1	1	1	1	1
7	Panel, Lower Access	1057579	1	1	1	1	1	1
8	Door, Heater	1057582	1	1	1	1	1	1
9	Plate, Support	709130	1	1	1	1	1	1
10	Flange, Rain	1057577	1	1	1	1	1	1
11	Plate, Adapter	1057578	1	1	1	1	1	1
12	Door, Disconnect	1057588	1	1	1	1	1	1
13	Bracket, Left Side Heater	1057914	1	1	1	1	-	-
		704687	-	-	-	-	1	1
14	Fitting, 1 / 2" Conduit	705708	1	1	1	1	1	1
15	Panel, Rear	1057581	1	1	1	1	1	-
		1057902	-	-	-	-	-	1
16	Panel, Equipment	709194	1	1	1	1	1	1
17	Clamp, Capacitor	1051476	1	1	-	-	-	-
		706439	-	-	1	1	1	1
18	Harness, Wire (Compressor to Contactor)	1052618	1	1	1	1	1	1
19	Assembly, Drain Pan	705511	1	1	1	1	-	-
		705513	-	-	-	-	1	1
20	Diverter, Water	705087	1	1	1	1	-	-
		705201	-	-	-	-	1	1
21	Base	512878	1	1	1	1	1	1
22	Panel, Compressor Access	1062155	1	1	1	1	1	1
23	Tube, Drain	706072	1	1	1	1	1	1
24	Panel, Divider	1057919	1	1	1	1	1	1
25	Trap, Drain	705506	1	1	1	1	1	1
26	Panel, Left Side	1057595	1	1	1	1	1	1
27	Distributor	1052613	-	-	-	1	1	1
28	Grille, Inlet	512900	1	1	1	1	1	1
29	Orifice	1057593	1	1	1	1	1	1
30	Slinger	703128	1	1	1	1	1	1
31	Panel, Top	1057585	1	1	1	1	1	1
32	Grille, Outlet	512848	1	1	1	1	1	1
33	Bracket, Outside Mounting	700075	2	2	2	-	-	-
		707212	-	-	-	2	2	2
34	Tape, Foam	703856	1	1	1	1	1	1
35	Housing, Blower	703433	1	-	-	-	-	-
		1055022	-	1	1	-	-	-
		1055067	-	-	-	1	1	1
36	Clamp, Capacitor	706439	1	1	1	1	1	1

**NOTES:**

\* NOT STOCKED - NON-SERVICEABLE PART

FOR PARTS ILLUSTRATION  
SEE PAGE 9

# Replacement Parts

Replacement part supplied will be current active part.  
For parts not listed, consult place of purchase.

Key No.	Description	Replacement Part Number	Model Number/Quantity Required					
			NA6P0					
			24B3Y1	30B3Y1	36A3Y1	42A3Y1	48A3Y1	60A3Y1
1	Panel, Right Side	512843	1	1	1	1	1	1
2	Board, Terminal	1054901	1	1	1	1	1	1
3	Box, Junction	*	1	1	1	1	1	1
4	Bulkhead, Blower	704697	1	1	1	-	-	-
		1056702	-	-	-	1	1	1
5	Clamp, Capacitor	1051476	1	1	1	1	1	1
6	Box, Control	*	1	1	1	1	1	1
7	Panel, Lower Access	512833	1	1	1	1	1	1
8	Door, Heater	512923	1	1	1	1	1	1
9	Plate, Support	709130	1	1	1	1	1	1
10	Flange, Rain	512830	1	1	1	1	1	1
11	Plate, Adapter	512834	1	1	1	1	1	1
12	Door, Disconnect	512839	1	1	1	1	1	1
13	Bracket, Left Side Heater	1057914	1	1	1	1	-	-
		704687	-	-	-	-	1	1
14	Fitting, 1 / 2" Conduit	705708	1	1	1	1	1	1
15	Panel, Rear	512845	1	1	1	1	1	-
		512846	-	-	-	-	-	1
16	Panel, Equipment	709194	1	1	1	1	1	1
17	Clamp, Capacitor	1051476	1	1	-	-	-	-
		706439	-	1	1	1	1	1
18	Harness, Wire (Compressor to Contactor)	1052618	1	1	1	1	1	1
19	Assembly, Drain Pan	705511	1	1	1	1	-	-
		705513	-	-	-	-	1	1
20	Diverter, Water	705087	1	1	1	1	-	-
		705201	-	-	-	-	1	1
21	Base	512842	1	1	1	1	1	1
22	Panel, Compressor Access	1062157	1	1	1	1	1	1
23	Tube, Drain	706072	1	1	1	1	1	1
24	Panel, Divider	1057919	1	1	1	1	1	1
25	Trap, Drain	705506	1	1	1	1	1	1
26	Panel, Left Side	512844	1	1	1	1	1	1
27	Distributor	1052613	-	-	-	1	1	1
28	Grille, Inlet	512900	1	1	1	1	1	1
29	Orifice	512832	1	1	1	1	1	1
30	Slinger	703128	1	1	1	1	1	1
31	Panel, Top	512847	1	1	1	1	1	1
32	Grille, Outlet	512848	1	1	1	1	1	1
33	Bracket, Outside Mounting	700075	2	2	2	-	-	-
		707212	-	-	-	2	2	2
34	Tape, Foam	703856	1	1	1	1	1	1
35	Housing, Blower	703433	1	-	-	-	-	-
		1055022	-	1	1	-	-	-
		1055067	-	-	-	1	1	1
36	Clamp, Capacitor	706439	1	1	1	1	1	1

**NOTES:**

\* NOT STOCKED - NON-SERVICEABLE PART

FOR PARTS ILLUSTRATION  
SEE PAGE 9

