

International Comfort Products
SPARE PARTS FOR MK - MODEL

No.	Description	Customer Code	MK - MODEL / PCS.						
			MK-012	MK-018	MK-024	MK-030	MK-036	MK-048	MK-060
19.1	BLOWER WHEEL MK012, 018 AND 024 (134 mm x 222 mm)	MK19.1	2	2	2	-	-	-	-
19.2	BLOWER WHEEL MK 030 AND 036 (157 mm x 222 mm)	MK19.2	-	-	-	2	2	-	-
19.3	BLOWER WHEEL MK 048 AND 060 (157 mm x 200 mm)	MK19.3	-	-	-	-	-	4	4
20	FAN MOTOR								
20.1	FAN MOTOR 1/15 HP FOR MK012	MK20.1	1	-	-	-	-	-	-
20.2	FAN MOTOR 1/20 HP FOR MK018	MK20.2	-	1	-	-	-	-	-
20.3	FAN MOTOR 1/10 HP FOR MK024 AND 048	MK20.3	-	-	1	-	-	2	-
20.4	FAN MOTOR 1/8 HP FOR MK030 AND 060	MK20.4	-	-	-	1	-	-	2
20.5	FAN MOTOR 1/6 HP FOR MK036	MK20.5	-	-	-	-	1	-	-
21	STEPPING MOTOR								
21.1	STEPPING MOTOR MP-35 FOR MK012, 018, 024, 030, 036, 048 AND 060	MK21	1	1	1	1	1	1	1
22	STEPPING MOTOR PLASTIC COVER								
22.1	STEPPING MOTOR PLASTIC COVER FOR MK012, 018, 024, 030, 036, 048 AND 060	MK22	1	1	1	1	1	1	1
23	BOARD CONTROL COMPLETE SET WITH TRANSFORMER 24 V.								
23.1	CONTROL + TRANSFORMER 24 V. FOR MK012, 018, 024, 030, 036, 048 AND 060	MK23	1	1	1	1	1	1	1
24	HANDSET OR REMOTE FOR BOARD CONTROL								
24.1	HANDSET OR REMOTE FOR MK012, 018, 024, 030, 036, 048 AND 060	MK24	1	1	1	1	1	1	1
25	EVAPORATOR COIL								
25.1	EVAPORATOR COIL 10" x 35.5" x 2R16F5/16" PLAIN TUBE FOR MK012	MK25.1	1	-	-	-	-	-	-
25.2	EVAPORATOR COIL 10" x 35.5" x 2R18F3/8" PLAIN TUBE FOR MK018	MK25.2	-	1	-	-	-	-	-
25.3	EVAPORATOR COIL 10" x 35.5" x 3R16F3/8" INNER FOR MK024	MK25.3	-	-	1	-	-	-	-
25.4	EVAPORATOR COIL 10" x 35.5" x 3R16F3/8" PLAIN TUBE FOR MK030	MK25.4	-	-	-	1	-	-	-
25.5	EVAPORATOR COIL 10" x 35.5" x 4R14F3/8" PLAIN TUBE FOR MK036	MK25.5	-	-	-	-	1	-	-
25.6	EVAPORATOR COIL 10" x 56" x 3R16F3/8" PLAIN TUBE FOR MK048	MK25.6	-	-	-	-	-	1	-
25.7	EVAPORATOR COIL 10" x 56" x 4R14F3/8" PLAIN TUBE FOR MK060	MK25.7	-	-	-	-	-	-	1
26	FOAM SUPPORT EVAPORATOR COIL								
26.1	FOAM SUPPORT EVAPORATOR COIL MK012, 018 AND 024	MK26.1	1	1	1	-	-	-	-
26.2	FOAM SUPPORT EVAPORATOR COIL MK030 AND 036	MK26.2	-	-	-	1	1	-	-
26.3	FOAM SUPPORT EVAPORATOR COIL MK048 AND 060	MK26.3	-	-	-	-	-	1	1
27	FOAM PACKAGING								
27.1	FOAM PACKAGING MK012, 018 AND 024	MK27.1	1	1	1	-	-	-	-
27.2	FOAM PACKAGING MK036 AND 036	MK27.2	-	-	-	1	1	-	-
27.3	FOAM PACKAGING MK048 AND 060	MK27.3	-	-	-	-	-	1	1
28	REFRIGERANT FLOW CONTROL (ORIFIC TYPE)								
28.1	ORIFICE NO. 0.051 FOR MK012	MK28.1	1	-	-	-	-	-	-
28.2	ORIFICE NO. 0.053 FOR MK018	MK28.2	-	1	-	-	-	-	-
28.3	ORIFICE NO. 0.061 FOR MK024	MK28.3	-	-	1	-	-	-	-
28.4	ORIFICE NO. 0.065 FOR MK030 AND 036	MK28.4	-	-	-	1	1	-	-
28.5	ORIFICE NO. 0.081 FOR MK048	MK28.5	-	-	-	-	-	1	-
28.6	ORIFICE NO. 0.092 FOR MK060	MK28.6	-	-	-	-	-	-	1
29	WIRE FOR CONTROL								
29.1	WIRE FOR CONTROL MK012, 018, 024, 030, 036, 048 AND 060	MK29	1	1	1	1	1	1	1
30	CARTON BOX								
30.1	CARTON BOX MK012, 018 AND 024	MK30.1	1	1	1	-	-	-	-
30.2	CARTON BOX MK030 AND 036	MK30.2	-	-	-	1	1	-	-
30.3	CARTON BOX MK048 AND 060	MK30.3	-	-	-	-	-	1	1

SPARE PARTS MK012AWA - MODEL

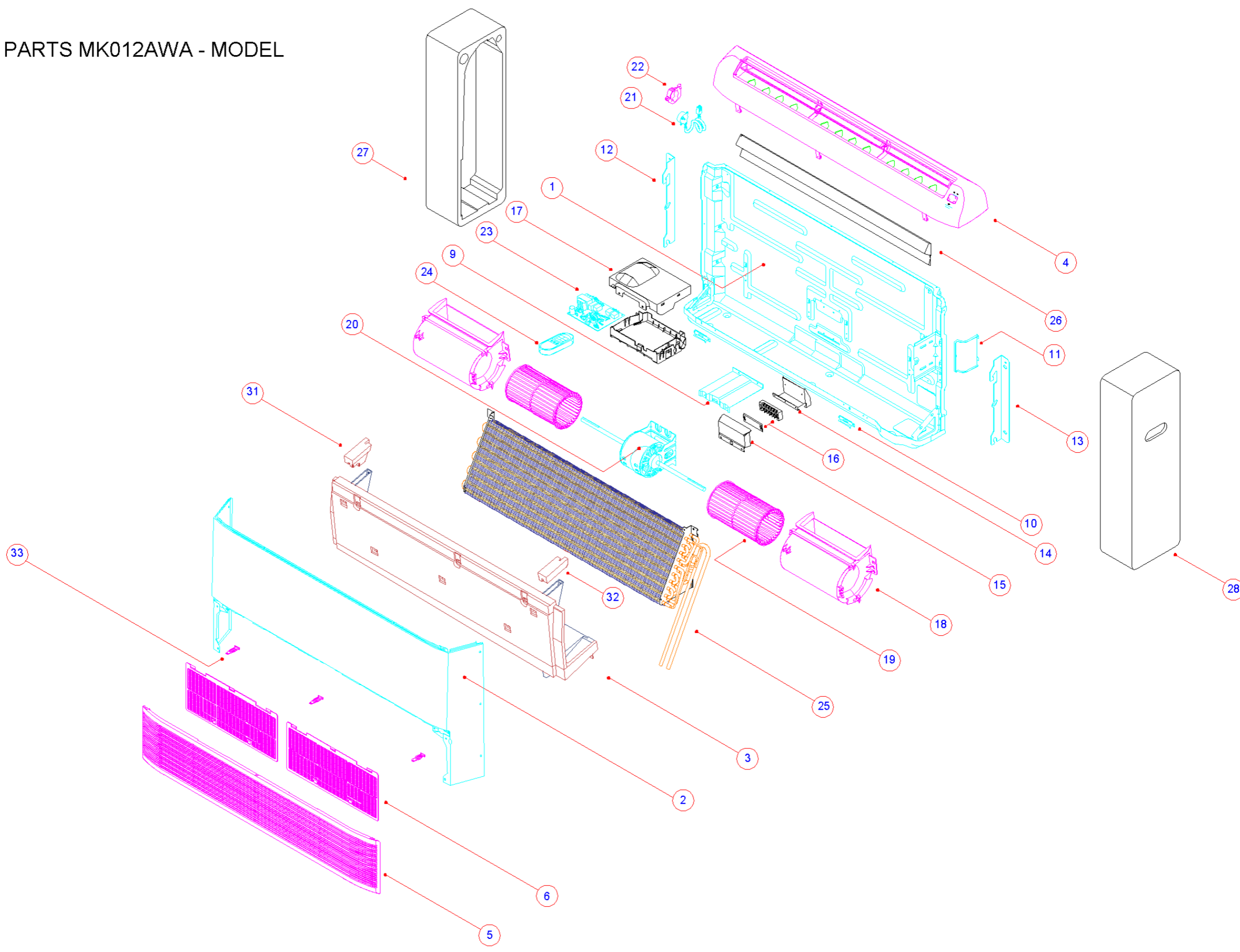

SPARE PARTS MK018AWA - MODEL

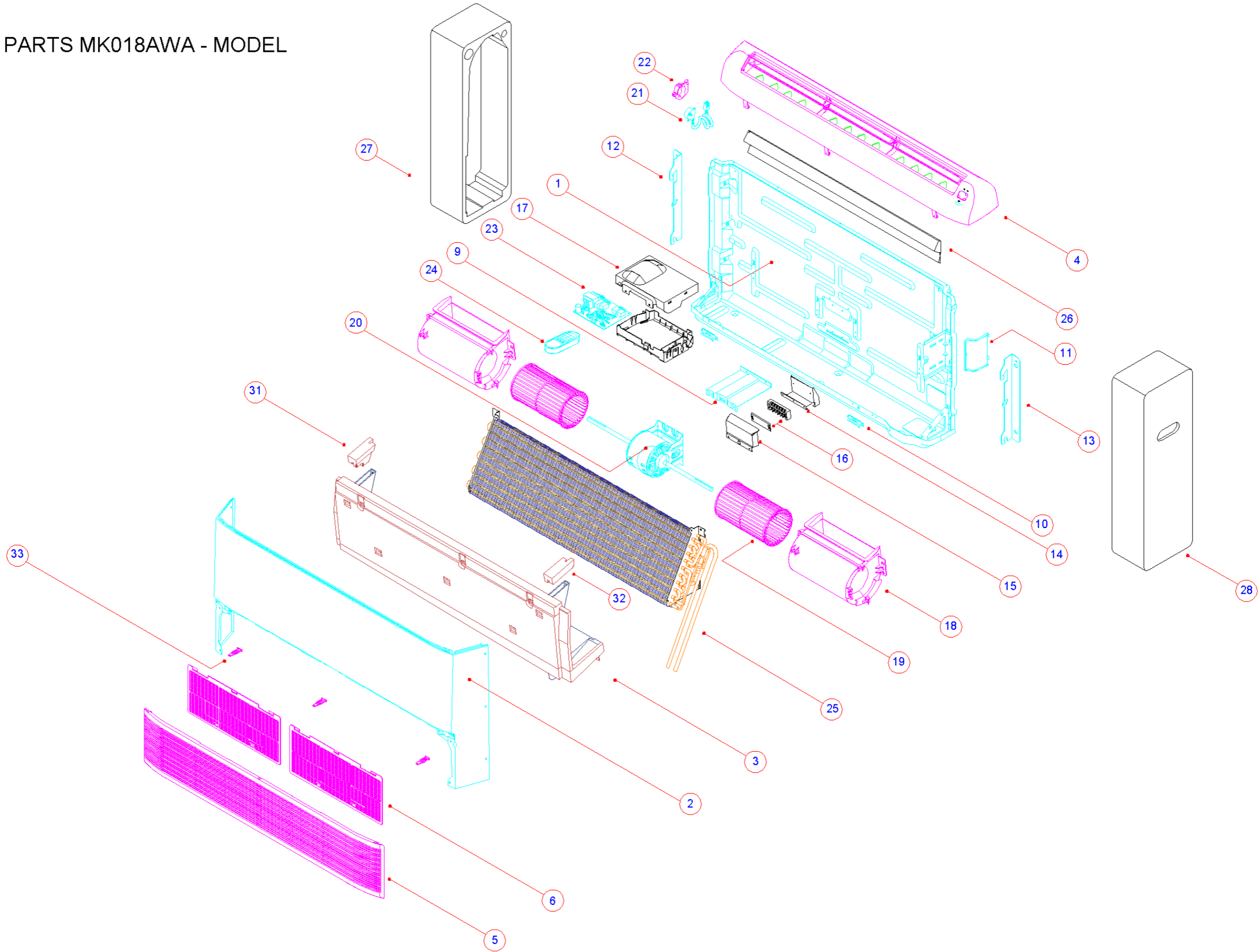

SPARE PARTS MK060AWA-MODEL

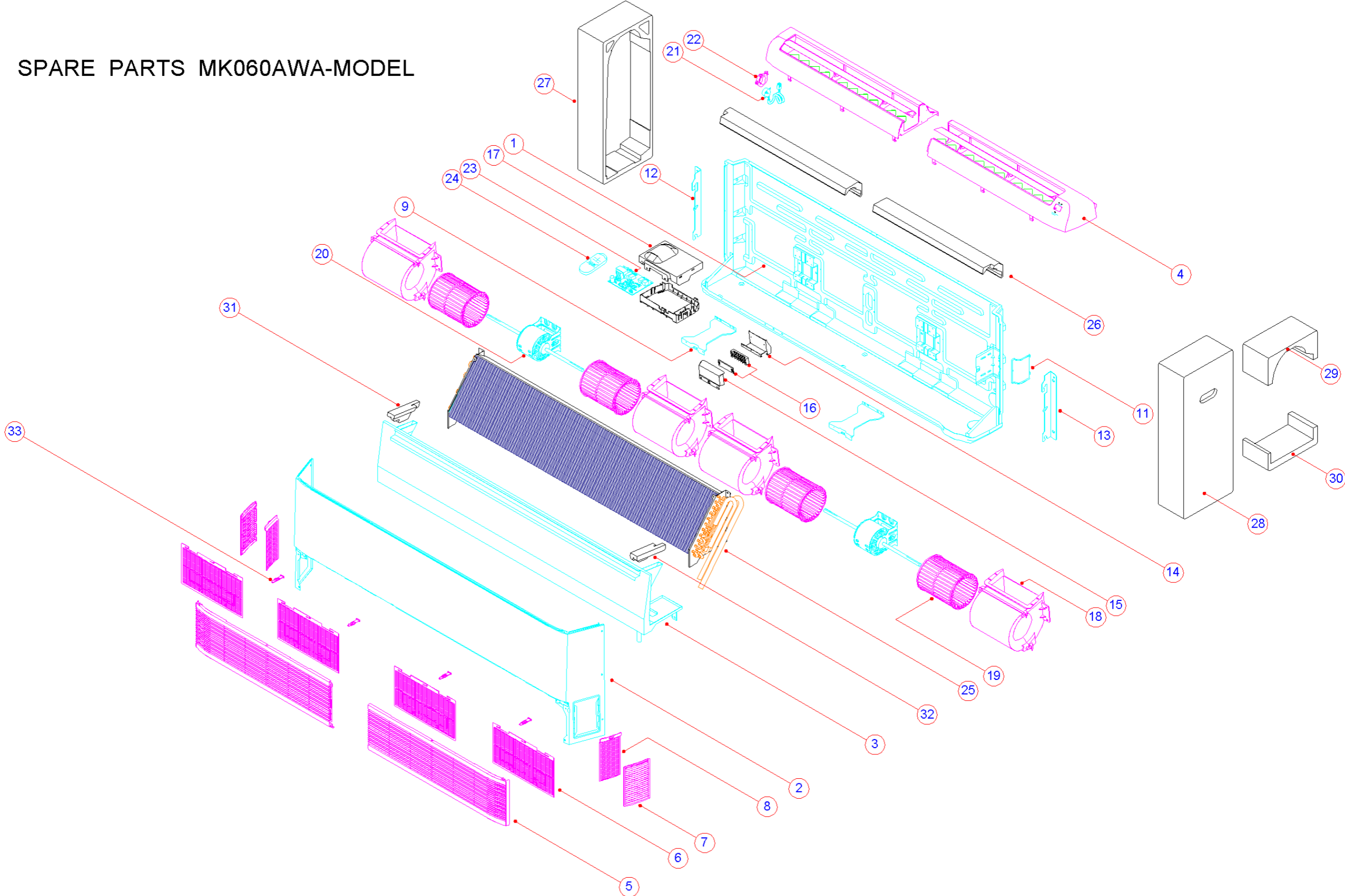

SPARE PARTS MK048AWA-MODEL

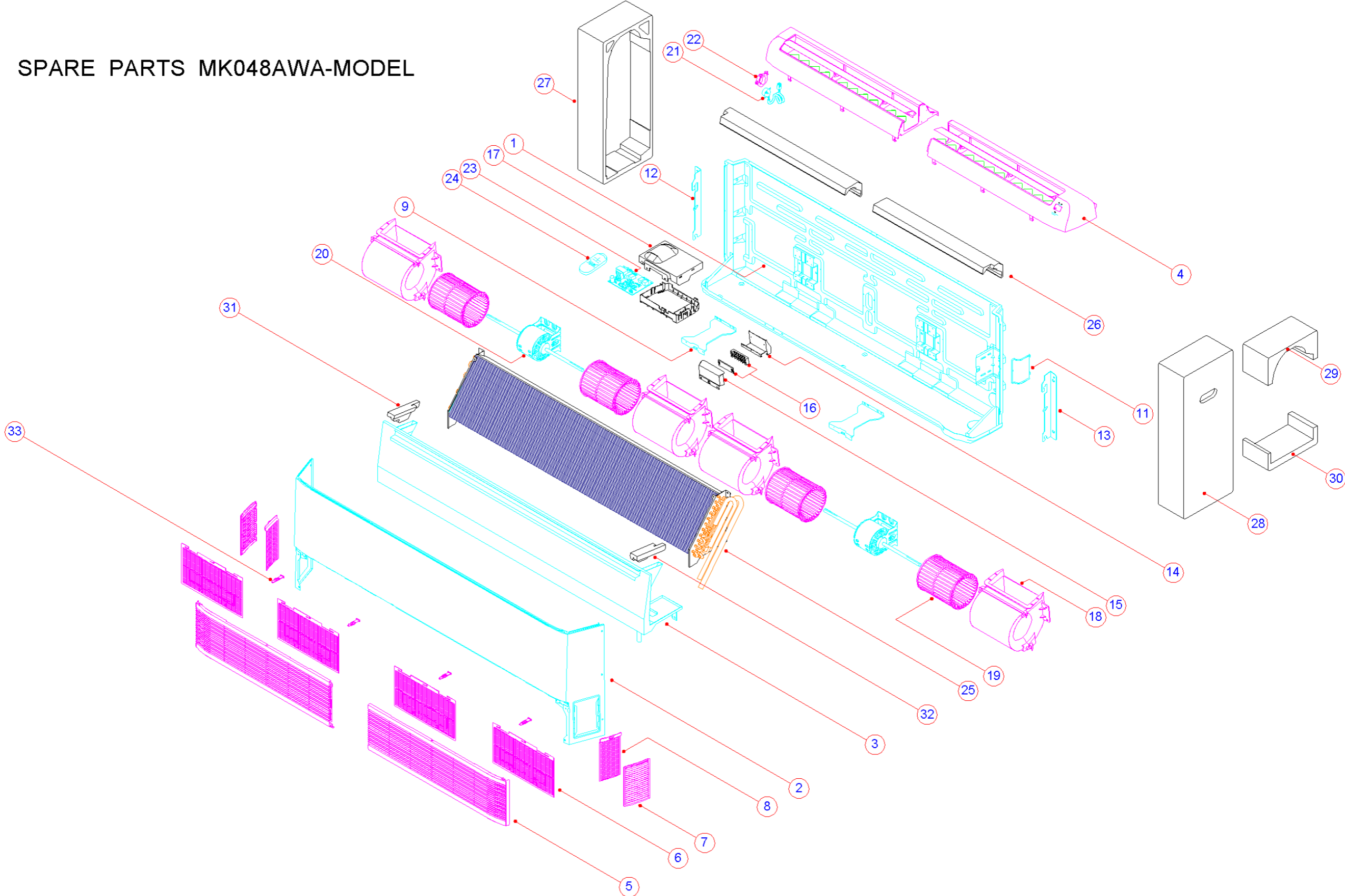

SPARE PARTS MK036AWA-MODEL

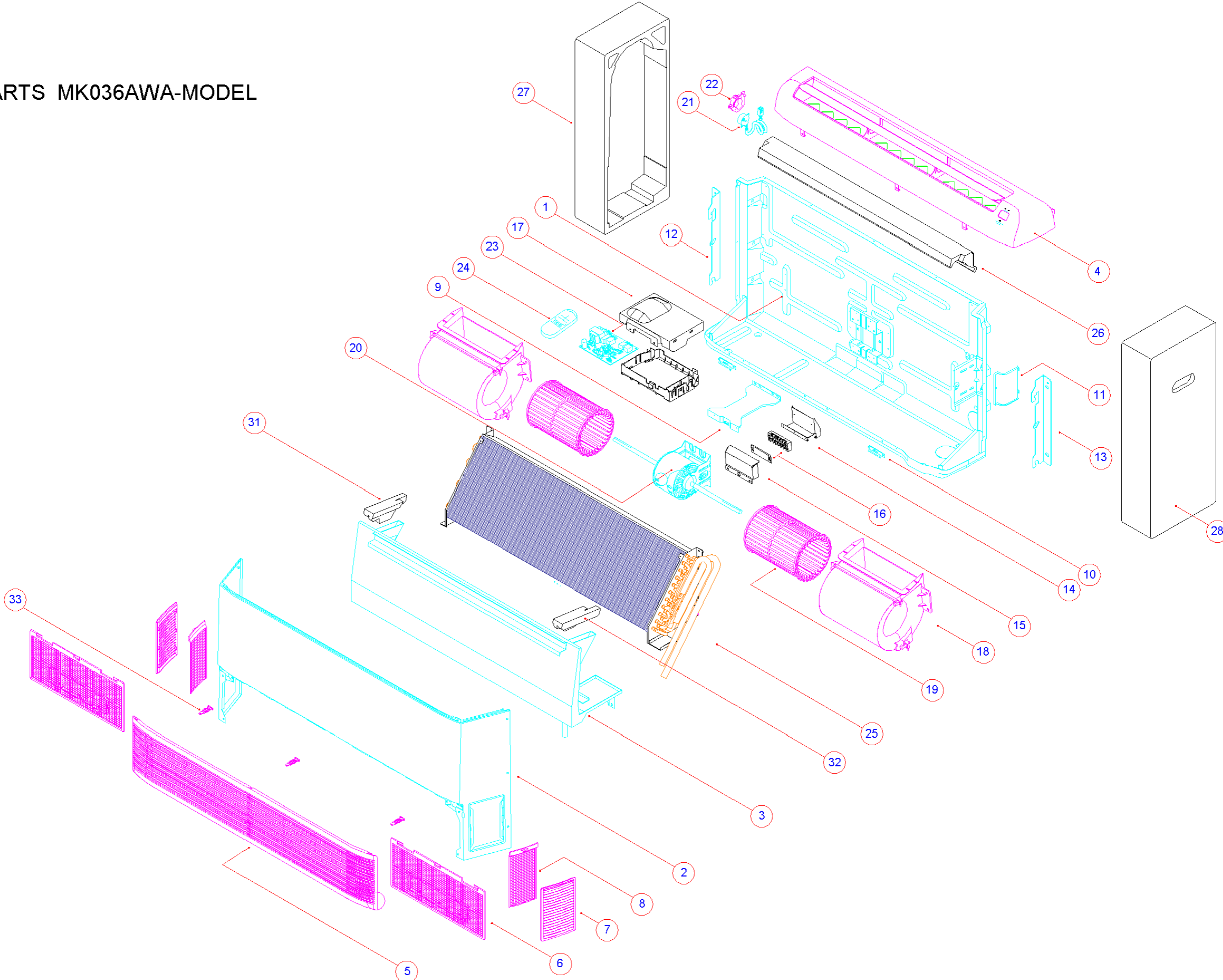

SPARE PARTS MK030AWA-MODEL

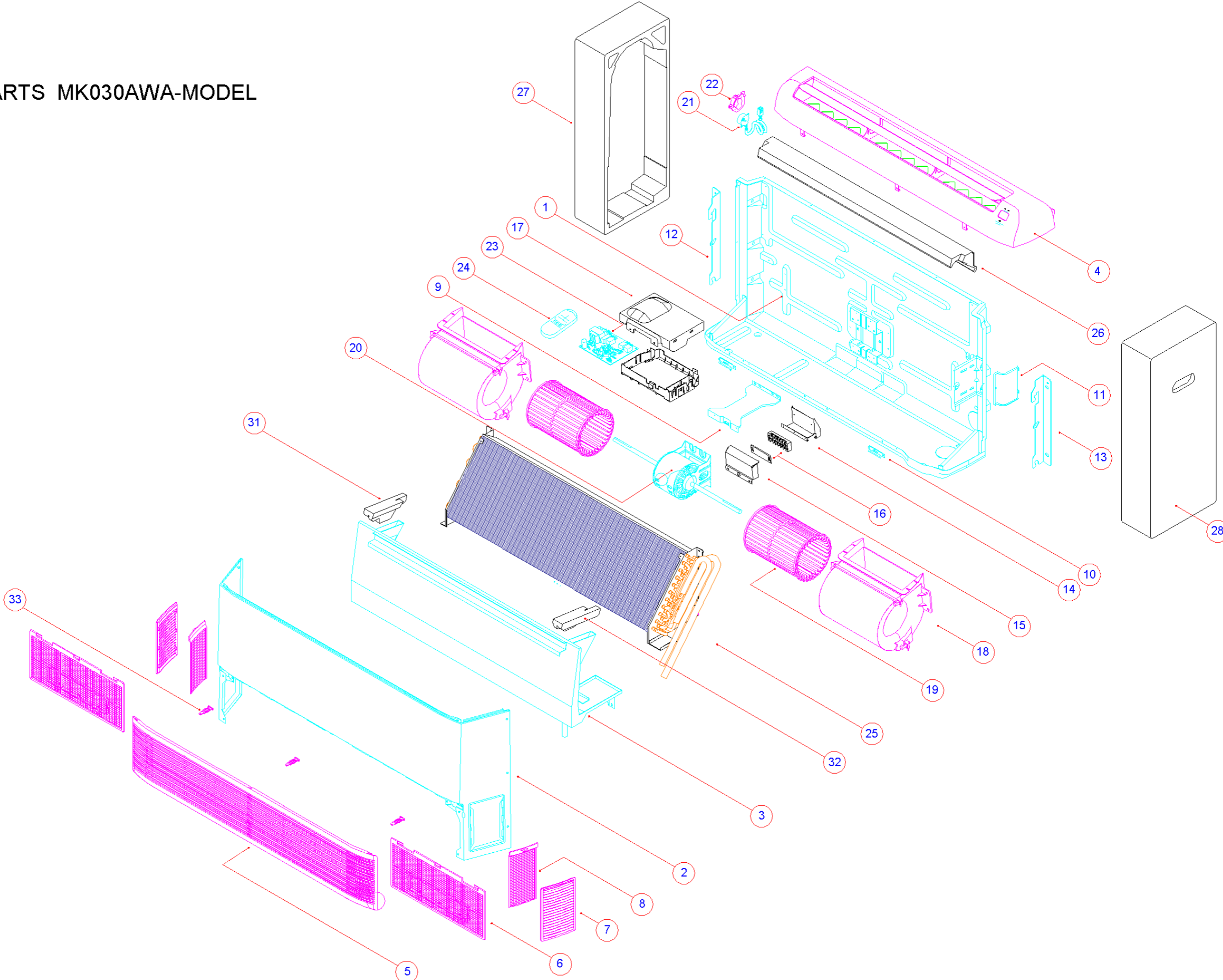

SPARE PARTS MK024AWA - MODEL

