

Technical Support Manual

Save This Manual For Future Reference

Models

H8UH5050B12A1
H8UH5075B12A1
H8UH5100F14A1
H8UH5125J20A1
H8UH5140J20A1

MUF050W3B
MUF075W3B
MUF100W3B
MUF125W3B
MUF140W3B

HL12H3TR
HL18H3TR
HL25H3TR
HL31H4TR
HL34H5TR

International Comfort Products Corporation (USA)
Lewisburg, TN 37091 USA
Fast Parts Division
615-248-8300



FAN ASSISTED COMBUSTION GAS FURNACES

1. Model Specifications

Manufacturers Number (Mfr No -See Rating Plate) ALL Models (H8UH5/MUF/HL)										
Specifications										
	H8UH5050B12 MUF050W3B HL12H3TR		H8UH5075B12 MUF075W3B HL18H3TR		H8UH5100F14 MUF100W3B HL25H3TR		H8UH5125J20 MUF125W3B HL31H4TR		H8UH5140J20 MUF140W3B HL34H5TR	
General										
Input (Btuh)	50,000		75,000		100,000		125,000		140,000	
Output (Btuh)+	39,000		58,000		78,000		98,000		109,000	
Temp. Rise (°F)	30-60		35-65		35-65		35-65		45-75	
Electrical (Volts/Hz/FLA)	220/50/9.8		220/50/8.9		220/50/9.0		220/50/12.0		220/50/12.0	
Gas Type	Nat	LP	Nat	LP	Nat	LP	Nat	LP	Nat	LP
Transformer Size (VA)	40	40	40	40	40	40	40	40	40	40
T'stat Heat Anticipator	.30	.30	.30	.30	.30	.30	.30	.30	.30	.30
Gas & Ignition										
Std. Main Orifices (No/Size)	2/#42	2/#54	3/#42	3/#54	4/#42	4/#54	5/#42	5/#54	6/#42	6/#54
Gas Valve Honeywell SV	9541	9541	9541	9541	9541	9541	9541	9541	9541	9541
Regulation Type	SNAP	SNAP	SNAP	SNAP	SNAP	SNAP	SNAP	SNAP	SNAP	SNAP
Manifold Press. (Inch's WC)	3.5	10.0	3.5	10.0	3.5	10.0	3.5	10.0	3.5	10.0
Pilot Orifice Size	.018	.011	.018	.011	.018	.011	.018	.011	.018	.011
Ignition Type/Series	HW HSP		HW HSP		HW HSP		HW HSP		HW HSP	
Lock-Out Time	NA		NA		NA		NA		NA	
Combustion										
Flue Outlet Size (Inches)	4		4		4		4		4	
Limits & Controls										
Thermal Sensor (°F)	300		300		300		300		300	
Limit Control	See Parts List		See Parts List		See Parts List		See Parts List		See Parts List	
Std. Pressure Sw. (Part No)	1014051		1014051		1014051		1014051		1014051	
Press (Close)	-0.57		-0.57		-0.57		-0.57		-0.57	
Press (Open)	-0.47		-0.47		-0.47		-0.47		-0.47	
Fan Control (Type)	HW ST9160		HW ST9160		HW ST9160		HW ST9160		HW ST9160	
Fan Control On	30		30		30		30		30	
(Timed-secs) Off	60,100,140,180		60,100,140,180		60,100,140,180		60,100,140,180		60,100,140,180	
Blower Data										
Type & Size	11-8		11-8		11-10		11-10		12-12	
Motor Amps/Rpm	10.3/1100		8/1050		8/900		10/1050		11.9/900	
Motor Type/H.p.	PSC ¹ / ₂		PSC ¹ / ₂		PSC ¹ / ₂		PSC ³ / ₄		PSC ³ / ₄	
Cap. Mfd/Volts	7.5/370		7.5/370		7.5/370		10/370		10/370	
Filter Type	Washable		Washable		Washable		Washable		Washable	
Filter Size (")	14x25x1		14x25x1		16x25x1		16x25x1 (2)		16x25x1 (2)	
Min. Cool Cap. (Tons)	1.5		1.5		2		3		3	
Max. Cool Cap. (Tons)	3		3		3.5		5		5	
+ Preliminary										
*Must be ordered from Service Parts										

2. Circulation Air Blower Data

H8UH5050B12, MUF050W3B, HL12H3TR

External Static Pressure Inches of W.C.	Air Delivery in Liters Per Second (L/S) (Furnace Rated @0.5" WC ESP)				
	TAP	LOW	MED L	MED H	HIGH
.10	454	672	1116	1335	
.30	351	609	1055	1237	
.50	278	550	991	1160	
.70	201	498	897	1029	
.90	---	422	783	903	
1.00	---	353	718	822	

H8UH5075B12, MUF075W3B, HL18H3TR

External Static Pressure Inches of W.C.	Air Delivery in Cubic Feet per Minute (C.F.M.) (Furnace Rated @0.5" WC ESP)				
	TAP	LOW	MED L	MED H	HIGH
.10	665	925	1171	1501	
.30	616	893	1136	1407	
.50	563	840	1074	1307	
.70	517	741	977	1200	
.90	442	650	866	1050	
1.00	394	593	804	963	

H8UH5100F14, MUF100W3B, HL25H3TR

External Static Pressure Inches of W.C.	Air Delivery in Cubic Feet per Minute (C.F.M.) (Furnace Rated @0.5" WC ESP)				
	TAP	LOW	MED L	MED H	HIGH
.10	742	916	1287	1723	
.30	625	845	1195	1638	
.50	525	747	1079	1515	
.70	440	662	1006	1371	
.90	348	553	868	1185	
1.00	297	490	787	1066	

H8UH5125J20, MUF125W3B, HL31H4TR

External Static Pressure Inches of W.C.	Air Delivery in Liters Per Second (L/S) (Furnace Rated @0.5" WC ESP)				
	TAP	LOW	MED L	MED H	HIGH
.10	839	1211	1584	2267	
.30	829	1188	1559	2151	
.50	798	1111	1553	2049	
.70	734	1079	1505	1912	
.90	651	1015	1400	1704	
1.00	595	897	1308	1585	

H8UH5140J20, MUF140W3B, HL34H5TR

External Static Pressure Inches of W.C.	Air Delivery in Cubic Feet per Minute (C.F.M.) (Furnace Rated @0.5" WC ESP)				
	TAP	LOW	MED L	MED H	HIGH
.10	1590	1827	2073	2283	
.30	1519	1708	1993	2262	
.50	1440	1623	1904	2150	
.70	1331	1525	1774	1991	
.90	1163	1381	1579	1813	
1.00	1079	1277	1494	1694	

4. Parts for H8UH5, MUF, HL

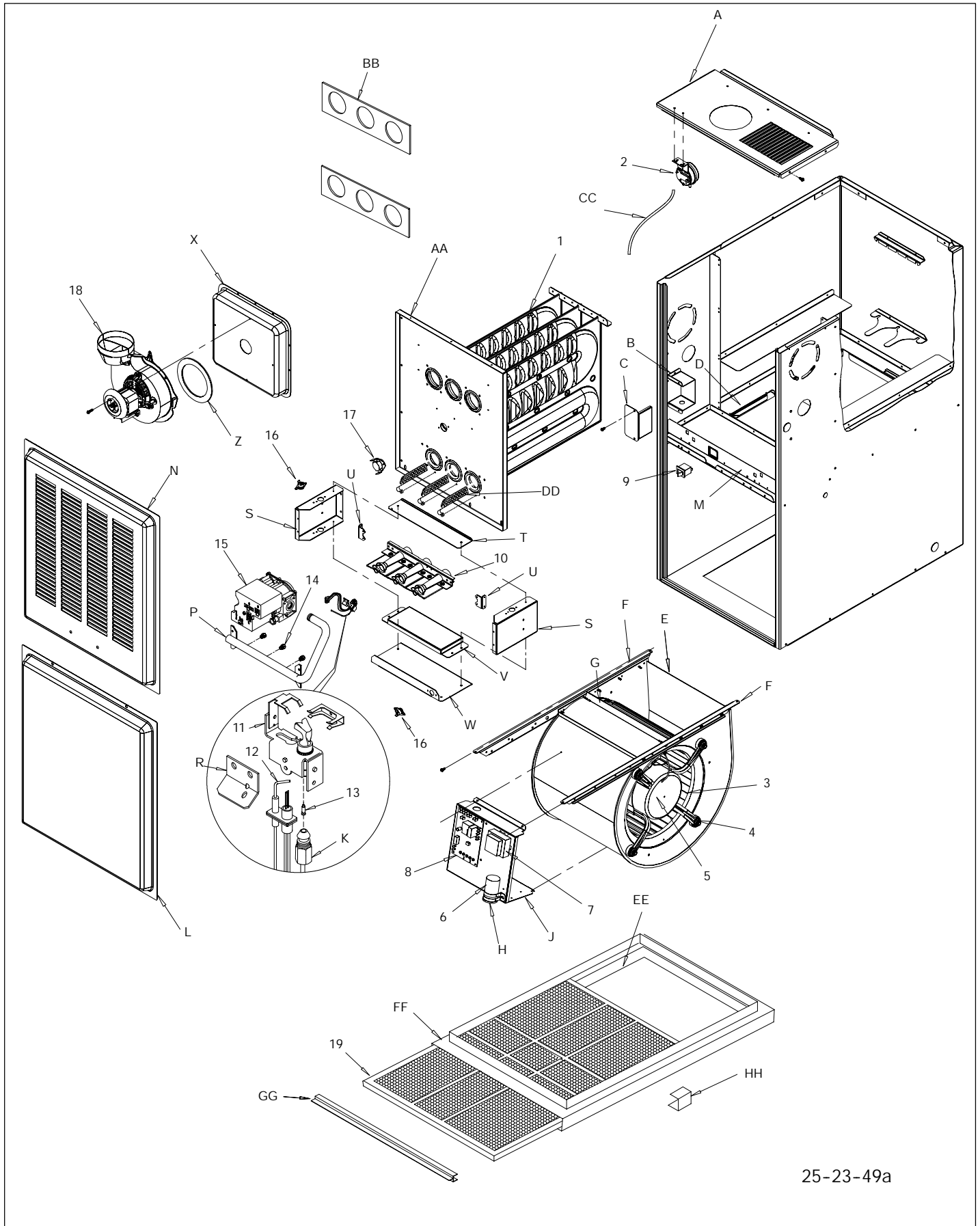

25-23-49a

Replacement Parts - H8UH5, MUF, HL (Natural Gas)

Models - H8UH5050B12A1, H8UH5075B12A1, H8UH5100F14A1, H8UH5125J20A1, H8UH5140J20A1
MUF050W3B, MUF075W3B, MUF100W3B, MUF125W3B, MUF140W3B
HL12H3TR, HL18H3TR, HL25H3TR, HL31H4TR, HL34H5TR

Replacement part supplied will be current active part. For parts not listed, consult place of purchase.

Key No.	Description Functional	Part Number	H8UH5050 B12A1	H8UH5075 B12A1	H8UH5100 F14A1	H8UH5125 J20A1	H8UH5150 J20A1
			MUF050W3B	MUF075W3B	MUF100W3B	MUF125W3B	MUF140W3B
			HL12H3TR	HL18H3TR	HL25H3TR	HL31H4TR	HL34H5TR
1	Heat Exchanger	1013551	1	-	-	-	-
		1013519	-	1	-	-	-
		1013552	-	-	1	-	-
		1013554	-	-	-	1	-
		1013555	-	-	-	-	1
2	Switch, Pressure	1014051	1	1	1	1	1
3	Wheel, Blower	1013011	1	1	-	-	-
		1011420	-	-	1	1	-
		1011433	-	-	-	-	1
4	Mount, Motor kit	1013379	1	1	-	-	-
		522020024	-	-	1	1	-
		1002804	-	-	-	-	1
5	Motor, Blower	1011567	1	1	1	-	-
		1011568	-	-	-	1	1
6	Capacitor	1171728	1	1	1	-	-
		1171729	-	-	-	1	1
7	Transformer	1011561	1	1	1	1	1
8	Control, Fan Timer	1014460	1	1	1	1	1
9	Switch, Interlock	1171981	1	1	1	1	1
10	Burner Assembly	1008723	1	-	-	-	-
		1008724	-	1	-	-	-
		1008725	-	-	1	-	-
		1008726	-	-	-	1	-
		1009179	-	-	-	-	1
11	Pilot/Igniter	1008731	1	1	1	1	1
12	Ignitor/Sensor with Clip	1009524	1	1	1	1	1
13	Orifice, Pilot .018	503211	1	1	1	1	1
14	Orifice, Burner # 42	1011351	2	3	4	5	6
15	Valve, Gas	1013350	1	1	1	1	1
16	Switch, Limit (Rollout)	1013102	2	2	2	2	2
17	Switch, Limit (Main)	1320362	1	1	-	-	-
		1065294	-	-	1	1	-
		1320364	-	-	-	-	1
18	Blower, Combustion	1014384	1	1	1	1	1
19	Filter	1010364	1	1	-	-	-
		1010365	-	-	1	2	2

Replacement Parts - H8UH5, MUF, HL (Natural Gas)

Models - H8UH5050B12A1, H8UH5075B12A1, H8UH5100F14A1, H8UH5125J20A1, H8UH5140J20A1
MUF050W3B, MUF075W3B, MUF100W3B, MUF125W3B, MUF140W3B
HL12H3TR, HL18H3TR, HL25H3TR, HL31H4TR, HL34H5TR

Replacement part supplied will be current active part. For parts not listed, consult place of purchase.

Key No.	Description Functional	Part Number	H8UH5050 B12A1	H8UH5075 B12A1	H8UH5100 F14A1	H8UH5125 J20A1	H8UH5150 J20A1
			MUF050W3B	MUF075W3B	MUF100W3B	MUF125W3B	MUF140W3B
			HL12H3TR	HL18H3TR	HL25H3TR	HL31H4TR	HL34H5TR
A	Panel, Top	1013982	1	1	-	-	-
		1013983	-	-	1	-	-
		1013984	-	-	-	1	1
B	Box, Junction	1012349	1	1	1	1	1
C	Cover, Junction box	1012350	1	1	1	1	1
D	Partition, Blower	1014009	1	1	-	-	-
		1014010	-	-	1	-	-
		1014011	-	-	-	1	-
		1014013	-	-	-	-	1
E	Housing, Blower	1012972	1	1	-	-	-
		1012888	-	-	1	1	-
		1012889	-	-	-	-	1
F	Hanger, Blower	1012328	2	2	2	2	2
G	Panel, Blower Cutoff	721020013	1	1	-	-	-
		721020008	-	-	1	1	-
		721020015	-	-	-	-	1
H	Clamp, Capacitor	1170643	1	1	1	1	1
J	Bracket, Control Mounting	1013677	1	1	1	1	1
K	Tube, Pilot	1013596	1	-	-	-	-
		1013597	-	1	-	-	-
		1013598	-	-	1	1	-
		1013599	-	-	-	-	1
L	Door, Blower	1014500	1	1	-	-	-
		1014501	-	-	1	-	-
		1014502	-	-	-	1	1
M	Bracket, Door	1014271	1	1	-	-	-
		1014272	-	-	1	-	-
		1014273	-	-	-	1	-
		1014274	-	-	-	-	1
N	Door, Louver	1014469	1	1	-	-	-
		1014470	-	-	1	-	-
		1014471	-	-	-	1	1
P	Manifold, Gas	1013478	1	-	-	-	-
		1013479	-	1	-	-	-
		1013480	-	-	1	-	-
		1013481	-	-	-	1	-
		1013482	-	-	-	-	1
R	Bracket, Pilot	1010901	1	1	1	1	1
S	Bracket, Manifold Support	1012377	2	2	2	2	2
T	Top, Burner Box	1013705	1	1	-	-	-
		1013015	-	-	1	-	-
		1013016	-	-	-	1	-
		1013859	-	-	-	-	1
U	Bracket, Burner Box Sides	1012532	2	2	2	2	2
V	Baffle, Burner Box	1012338	1	1	-	-	-
		1012339	-	-	1	-	-
		1012340	-	-	-	1	-
		1013533	-	-	-	-	1
W	Bottom, Burner Box	1012334	1	1	-	-	-
		1012335	-	-	1	-	-
		1012336	-	-	-	1	-
		1013691	-	-	-	-	1

Replacement Parts - H8UH5, MUF, HL (Natural Gas)

Models - H8UH5050B12A1, H8UH5075B12A1, H8UH5100F14A1, H8UH5125J20A1, H8UH5140J20A1
MUF050W3B, MUF075W3B, MUF100W3B, MUF125W3B, MUF140W3B
HL12H3TR, HL18H3TR, HL25H3TR, HL31H4TR, HL34H5TR

Replacement part supplied will be current active part. For parts not listed, consult place of purchase.

Key No.	Description Functional	Part Number	H8UH5050 B12A1	H8UH5075 B12A1	H8UH5100 F14A1	H8UH5125 J20A1	H8UH5150 J20A1
			MUF050W3B	MUF075W3B	MUF100W3B	MUF125W3B	MUF140W3B
			HL12H3TR	HL18H3TR	HL25H3TR	HL31H4TR	HL34H5TR
X	Collector Box	1013483	1	-	-	-	-
		1014387	-	1	-	-	-
		1014388	-	-	1	-	-
		1014389	-	-	-	1	-
		1014390	-	-	-	-	1
Z	Gasket, Combustion Blower	1014385	1	1	1	1	1
AA	Partition, Front Ht Exchanger	1013543	1	-	-	-	-
		1013521	-	1	-	-	-
		1013546	-	-	1	-	-
		1013548	-	-	-	1	-
		1013549	-	-	-	-	1
BB	Gaskets, Heat Exchanger	1013991	2	-	-	-	-
		1013992	-	2	-	-	-
		1013993	-	-	2	-	-
		1013994	-	-	-	2	-
		1012546	-	-	-	-	2
CC	Tubing, Silicone	1170886	1	1	1	1	1
EE	Wrapper, Filter Rack	741010042	1	1	-	-	-
		741010039	-	-	1	2	2
FF	Front, Filter Rack	741020004	1	1	-	-	-
		741020001	-	-	1	2	2
GG	Front, Filter Plastic	2791042	1	1	-	-	-
		2791043	-	-	1	2	2
HH	Clip, Filter	1008482	3	3	3	3	3
) (PART NOT ILLUSTRATED						
) (Fuse, 5 Amp	1083348	1	1	1	1	1
) (Harness, Wire	1013693	1	1	1	1	1
) (Manual, Installation	44101500200	1	1	1	1	1
) (Manual, Technical Support	44103500201	1	1	1	1	1
) (Manual, Users	44102500200	1	1	1	1	1