

**CRFLUEHD001A01**

**SMALL ROOFTOP UNITS  
GAS HEATING/ELECTRIC COOLING UNITS  
ACCESSORY FLUE SHIELD  
3 to 12–1/2 TONS**

## Installation Instructions

**IMPORTANT:** Read these instructions completely before attempting to install this accessory.

### PACKAGE CONTENTS

QTY	CONTENTS
1	Flue Shield
1	Adapter Plate
3	Screws

### SAFETY CONSIDERATIONS

Installation and servicing of air-conditioning equipment can be hazardous due to system pressure and electrical components. Only trained and qualified service personnel should install, repair, or service air-conditioning equipment.

Untrained personnel can perform the basic maintenance functions. All other operations should be performed by trained service personnel. When working on air-conditioning equipment, observe precautions in the literature, tags and labels attached to the unit, and other safety precautions that may apply.

Follow all safety codes. Wear safety glasses and work gloves.

Recognize safety information. This is the safety-alert symbol . When you see this symbol on the unit and in instructions or manuals, be alert to the potential for personal injury.

Understand the signal words DANGER, WARNING, and CAUTION. These words are used with the safety-alert symbol. DANGER identifies the most serious hazards which **will** result in severe personal injury or death. WARNING signifies a hazard which **could** result in personal injury or death. CAUTION is used to identify unsafe practices which **may** result in minor personal injury or product and property damage. NOTE is used to highlight suggestions which **will** result in enhanced installation, reliability, or operation.

### **WARNING**

#### **ELECTRICAL SHOCK HAZARD**

Failure to follow this warning could result in personal injury and/or death.

Before beginning any modification, be certain that the main-line electrical disconnect switch is in the OFF position. Close the main gas supply shutoff valve. Tag disconnect switch and gas valve with suitable warning labels.

### INSTALLATION

The flue shield serves as protection from the hot sides of the gas flue hood. It is shipped in a single flat piece that must be folded for installation. (See Fig. 1.) An adapter plate and screws (included) are required for units with serial number 1495G and later. Refer to the correct installation section based on the serial number of the unit.

#### **Units Produced Before April 3, 1995 (Serial Numbers 1395G and Earlier)**

If the flue hood is not yet installed on the unit, attach the hood to unit with screws provided. Do not tighten screws. Refer to the Installation, Start-Up and Service instructions provided with the unit for more detailed instructions.

If the flue hood has already been installed, loosen the screws.

Attach the flue shield as follows:

(See Fig. 1 and 2.):

1. Slide the center section slot under the flue hood top screw and tighten the screw.
2. Fold one side of the flue shield down over the flue hood and under one of the side screws. Tighten the screw.
3. Repeat Step 2 for other side of the flue shield.
4. Discard adapter plate and screws provided with accessory kit.

### Units Produced After April 3, 1995 (Serial Numbers 1495G and Earlier)

If the flue hood is not yet installed on the unit, attach the hood to unit with screws provided. Refer to the Installation, Start-Up and Service instructions provided with the unit for more detailed instructions.

If the flue hood has already been installed, perform procedure below.

Attach the flue shield as follows:

1. Fold the flue shield into the final 3-sided shape as shown in Fig. 2.
2. Fasten the flue shield to the adapter plate. (See Fig. 3.) Flue shield should be installed on flat side of adapter plate with large hole in bottom right corner.
3. Remove the second screw up from the bottom on the center post. (See Fig. 4.) Save screw.
4. Slide adapter plate and flue shield assembly over the flue hood, with large access hole in the adaptor plate at the bottom right-hand corner.
5. Fasten assembly to the center post using the screw removed in Step 3. Access is provided through hole in bottom right-hand corner.

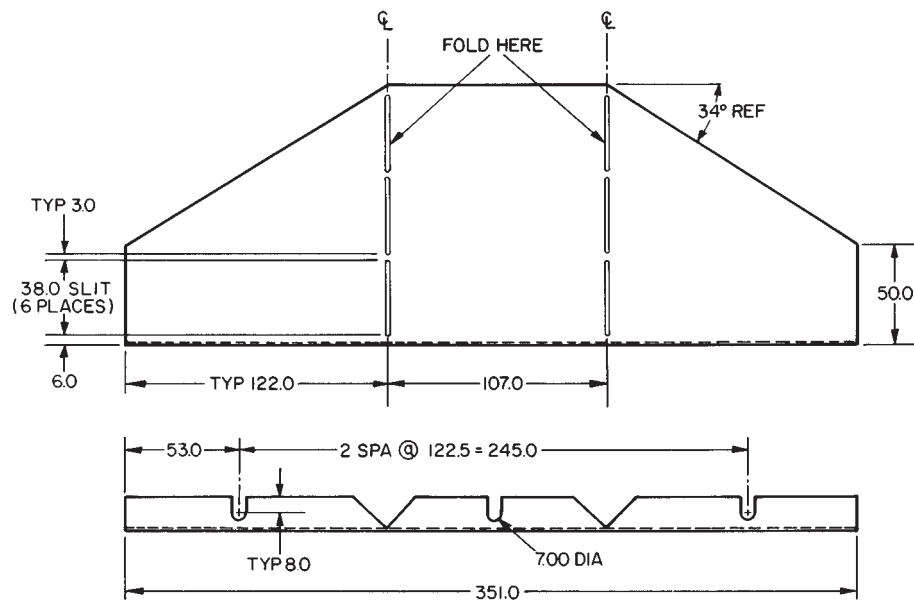

NOTE: Dimensions are in millimeters.

Fig. 1 - Flue Shield Dimensions

C08269

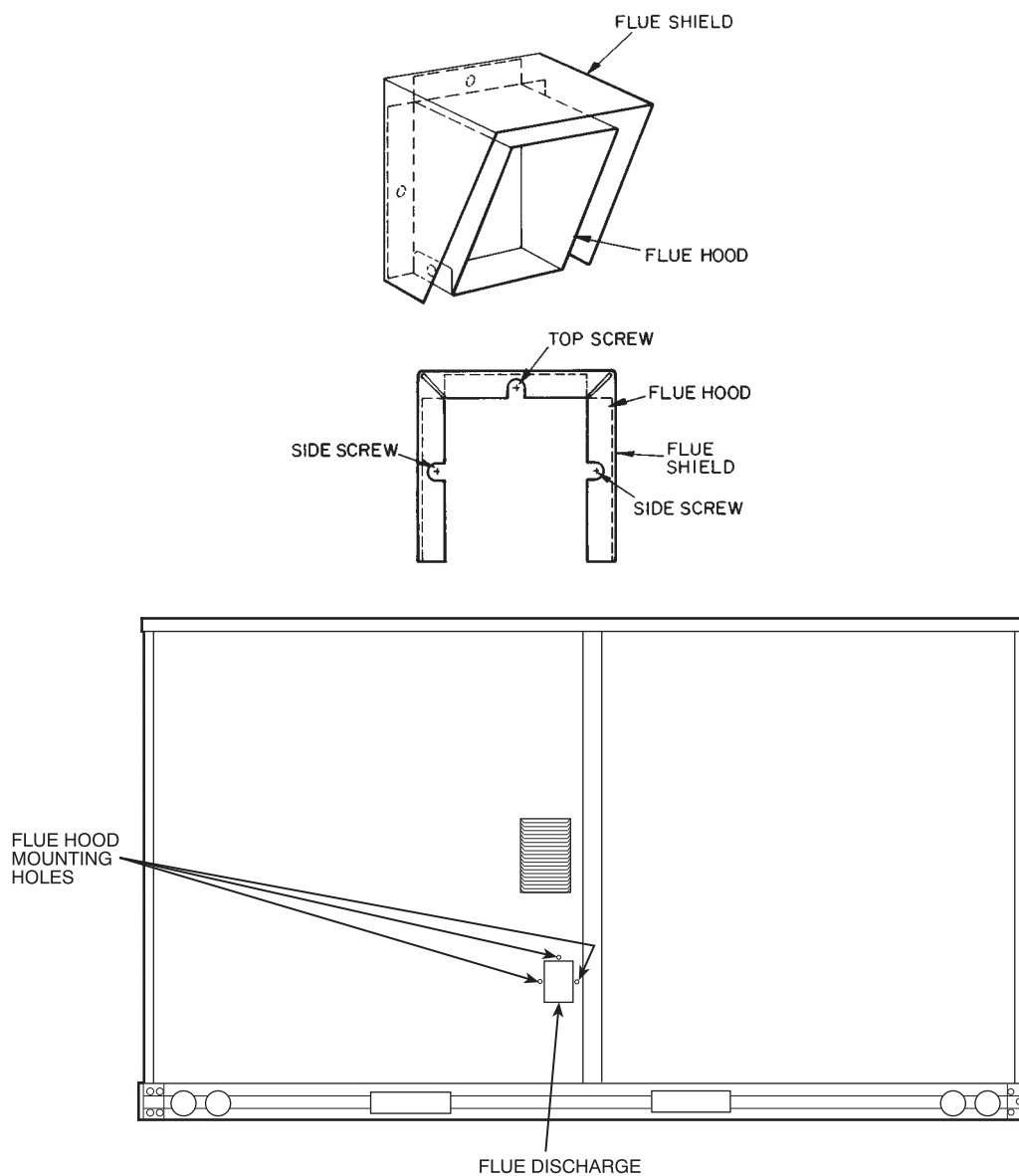

**Fig. 2 - Flue Shield Installation (Serial Numbers 1395G and Earlier)**

C08270

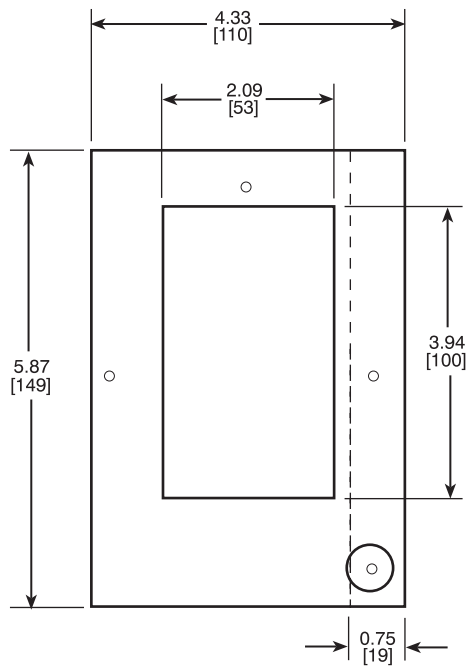

NOTES:

1. Dimensions are in inches.
2. Dimensions in [ ] are in millimeters.

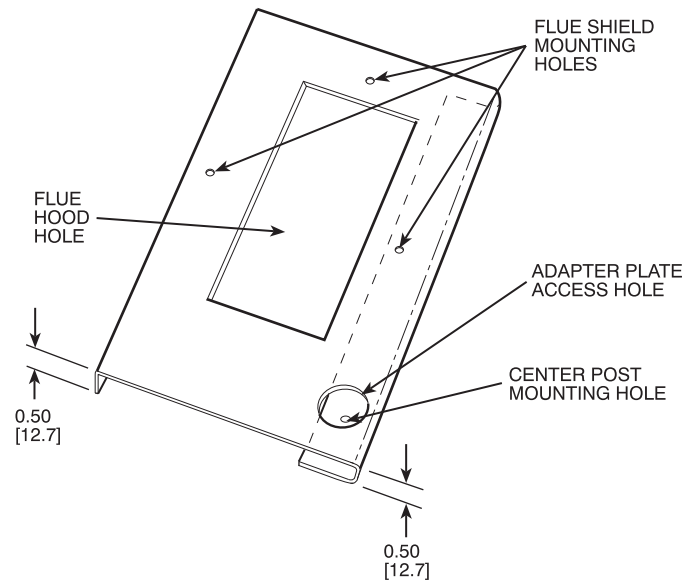

Fig. 3 - Adapter Plate

C08271

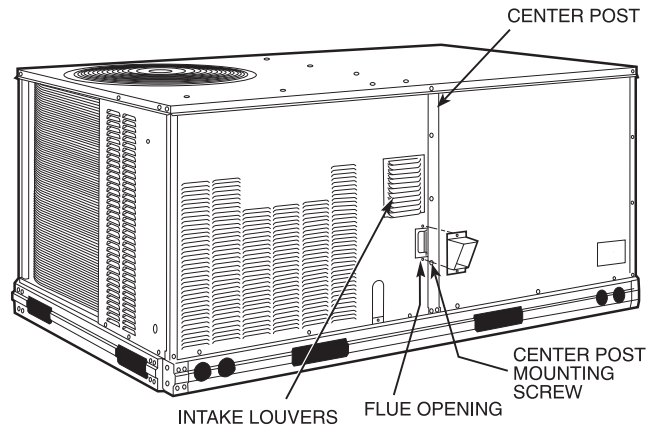

Fig. 4 - Flue Shield Installation (Serial Numbers 1495G and Later)

C08272